

CIF080421PW09

**Louisville Metro Council City Agency Request**  
**Neighborhood Development Fund (NDF)**  
 ■ **Capital Infrastructure Fund (CIF)**  
**Municipal Aid Program (MAP)**  
**Paving Fund (PAV)**

**Primary Sponsor:** Councilman Bill Hollander

**Amount:** \$37,000 **Date:** July 15, 2021

**Description of program/project including public purpose, additional funding sources, location of project/program and any external grantee(s):**

Grant to Metro Public Works for the Clifton and Payne intersection safety improvements, including new sidewalk, pavers, curb and gutter, pavement markings, and two marked crosswalks across Clifton and Payne Streets.

**City Agency:** Metro Public Works  
**Contact Person:** Steve Kurowsky  
**Agency Phone:** (502) 574-8743

**I have reviewed this request for an expenditure of city tax dollars, and have determined the funds will be used for a public purpose and have the attached documentation from the receiving department concerning the project/expenditure.**

<u>9</u>	<u>Bill Hollander</u>	<u>\$37,000</u>	<u>7/15/2021</u>
District #	Council Member Signature	Amount	Date

**Approved by:** \_\_\_\_\_  
 Appropriations Committee Chairman Date

**Clerk's Office & OMB Use Only:**

Request Amount: \_\_\_\_\_ Amended Amount: \_\_\_\_\_

Reference #: CIF080421PW09 To OMB: \_\_\_\_\_

Budget Revision #: \_\_\_\_\_

Account #: \_\_\_\_\_

To Project Manager: \_\_\_\_\_ Completion Date: \_\_\_\_\_

Actual Cost: \_\_\_\_\_ Funds Returned: \_\_\_\_\_

**NDF, CIF, MAP OR PAV INTERAGENCY CHECKLIST****Interagency Name:** Metro Public Works**Program/Project Name:** Clifton and Payne Intersection Safety Improvements**Yes/No/NA****Request Form:** Is the Request Signed by all Council Member(s) Appropriating Funding?

Yes

**Request Form:** If matching funds are to be used, are they disclosed with account numbers in the request form description?

NA

**Request Form:** If matching funds are to be used, does the amount of the request exclude the matching fund amount?

NA

**Request Form:** If other funds are to be used for this project, are they disclosed with account numbers in the request form description?

NA

**Funding Source:** If CIF is being requested, does Metro Louisville own/will own the real estate, building or equipment? If not, the funding source is probably NDF.

Yes

**Funding Source:** If CIF is being requested, does the project have a useful life of more than one year? If not, the funding source is probably NDF.

Yes

**Ordinance Required:** Is the NDF request to a Metro Agency greater than \$5,000? If so, an ordinance is required.

NA

**Ordinance Required:** Is the request a transfer from NDF to cost center? If so, is the amount given for the fiscal year \$25,000 or less?

NA

**Supporting Documentation:** Does the attachment include a valid estimate and description of cost?

Yes

**Submitted by:** Kyle Ethridge**Date:** 7/15/2021

## Ethridge, Kyle

---

**From:** Kurowsky, Steve M.  
**Sent:** Thursday, July 15, 2021 3:04 PM  
**To:** Ethridge, Kyle  
**Subject:** RE: Clifton/Payne Intersection Improvements Cost Estimate

Public Works will accept the funding for this project.

**From:** Ethridge, Kyle <Kyle.Ethridge@louisvilleky.gov>  
**Sent:** Thursday, July 15, 2021 2:46 PM  
**To:** Kurowsky, Steve M. <steve.kurowsky@louisvilleky.gov>  
**Subject:** RE: Clifton/Payne Intersection Improvements Cost Estimate

Steve,

Will MPW accept \$37,000 from D9 for the Clifton and Payne intersection improvement project?

Thanks,  
Kyle



Ms. Kyle Ethridge | Legislative Assistant  
Office of Councilman Bill Hollander  
601 W. Jefferson Street | Louisville, KY 40202  
d: (502) 574-3908 o: (502) 574-1109

Click [here](#) to sign up for the bi-weekly District 9 weekly eNews, and sign up for the D9 [blog](#) for the latest neighborhood news and alerts!

**From:** Kurowsky, Steve M. <steve.kurowsky@louisvilleky.gov>  
**Sent:** Wednesday, July 14, 2021 3:06 PM  
**To:** Ethridge, Kyle <Kyle.Ethridge@louisvilleky.gov>; Hollander, Bill H. <Bill.Hollander@louisvilleky.gov>  
**Subject:** Clifton/Payne Intersection Improvements Cost Estimate

CM Hollander / Kyle,

The cost for Public Works to re-do the curb on the SW corner of Payne and Clifton and put in 2 marked crosswalks is \$37,000. It would take about 2 weeks to complete and since there isn't a good detour option, the MOT cost is the highest line item cost (\$8,750) within this cost.

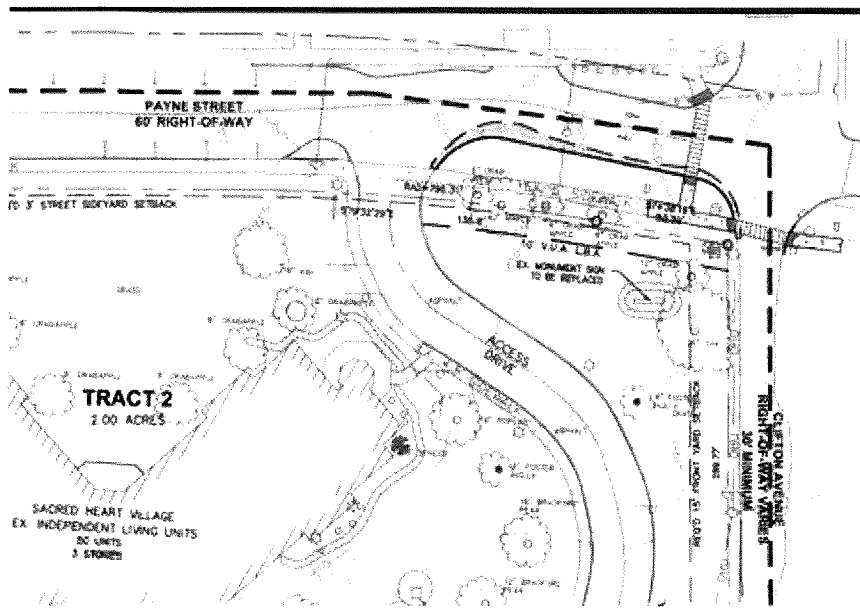

**SITE DATA**

TOTAL SITE AREA	15.9 (694)
EXISTING ZONING	R-6
EXISTING FORM DISTRICT	TNTI
EXISTING USE	NUR
EXISTING BUILDING AREA	226
EXISTING F.A.R.	0.33
PROPOSED BUILDING AREA	322
PROPOSED CHAPEL	11,028 SQ.F
PROPOSED ASSISTED LIVING	130,856 SQ.F
PROPOSED F.A.R.	0.47
MAXIMUM BUILDING HEIGHT	45'
FRONT YARD SETBACK	15'
STREET SIDE YARD SETBACK	15'
SIDE YARD SETBACK	3'
REAR YARD SETBACK	20'

**PARKING CALCULATIONS**

EX. INDEPENDENT LIVING (TRACTS 2 & 3)	
100 BEDS & 4 EMPLOYEES MAX. SHIFT	
MINIMUM REQUIRED	
0.8 SP./BED	80 SPACES
1 SP./2 EMPLOYEES	2 SPACES
MAXIMUM ALLOWED	
1 SP./BED	100 SPACES
1 SP./EMPLOYEE	4 SPACES
EX. ASSISTED LIVING & NURSING FACILITY (TR)	
90 BEDS & 45 EMPLOYEES MAX. SHIFT	
MINIMUM REQUIRED	
1.5 SP./BED	45 SPACES
1 SP./2 EMPLOYEES	22 SPACES

**From:** Ethridge, Kyle <Kyle.Ethridge@louisvilleky.gov>

**Sent:** Thursday, July 1, 2021 9:23 AM

**To:** Gowin, Dirk L <Dirk.Gowin@louisvilleky.gov>; Graham, James <James.Graham@louisvilleky.gov>; Dutrow, Mark B <Mark.Dutrow@louisvilleky.gov>

**Cc:** Hollander, Bill H. <Bill.Hollander@louisvilleky.gov>; Kurowsky, Steve M. <steve.kurowsky@louisvilleky.gov>; Sparks, Stuart <Stuart.Sparks@louisvilleky.gov>

**Subject:** RE: Clifton/Payne Intersection Improvements

Good Morning,

Since the construction at Nazareth is on hold indefinitely is there anyway Metro could review the proposed plans by Nazareth for the intersection improvements and provide a cost estimate to our office, so we could continue with the plan for stop signs?

MARK, would you have a copy of the plans you could send to MPW?

Thanks,  
Kyle



**Ms. Kyle Ethridge** | Legislative Assistant  
 Office of Councilman Bill Hollander  
 601 W. Jefferson Street | Louisville, KY 40202  
 d: (502) 574-3908 o: (502) 574-1109

Click [here](#) to sign up for the bi-weekly District 9 weekly eNews, and sign up for the D9 [blog](#) for the latest neighborhood news and alerts!

**From:** Gowin, Dirk L <Dirk.Gowin@louisvilleky.gov>

**Sent:** Tuesday, November 17, 2020 4:34 PM

**To:** Ethridge, Kyle <Kyle.Ethridge@louisvilleky.gov>; Graham, James <James.Graham@louisvilleky.gov>

**Cc:** Hollander, Bill H. <Bill.Hollander@louisvilleky.gov>

**Subject:** RE: Clifton/Payne Intersection Question and Concern