

22-DDP-0009

ORELL MINI WAREHOUSES

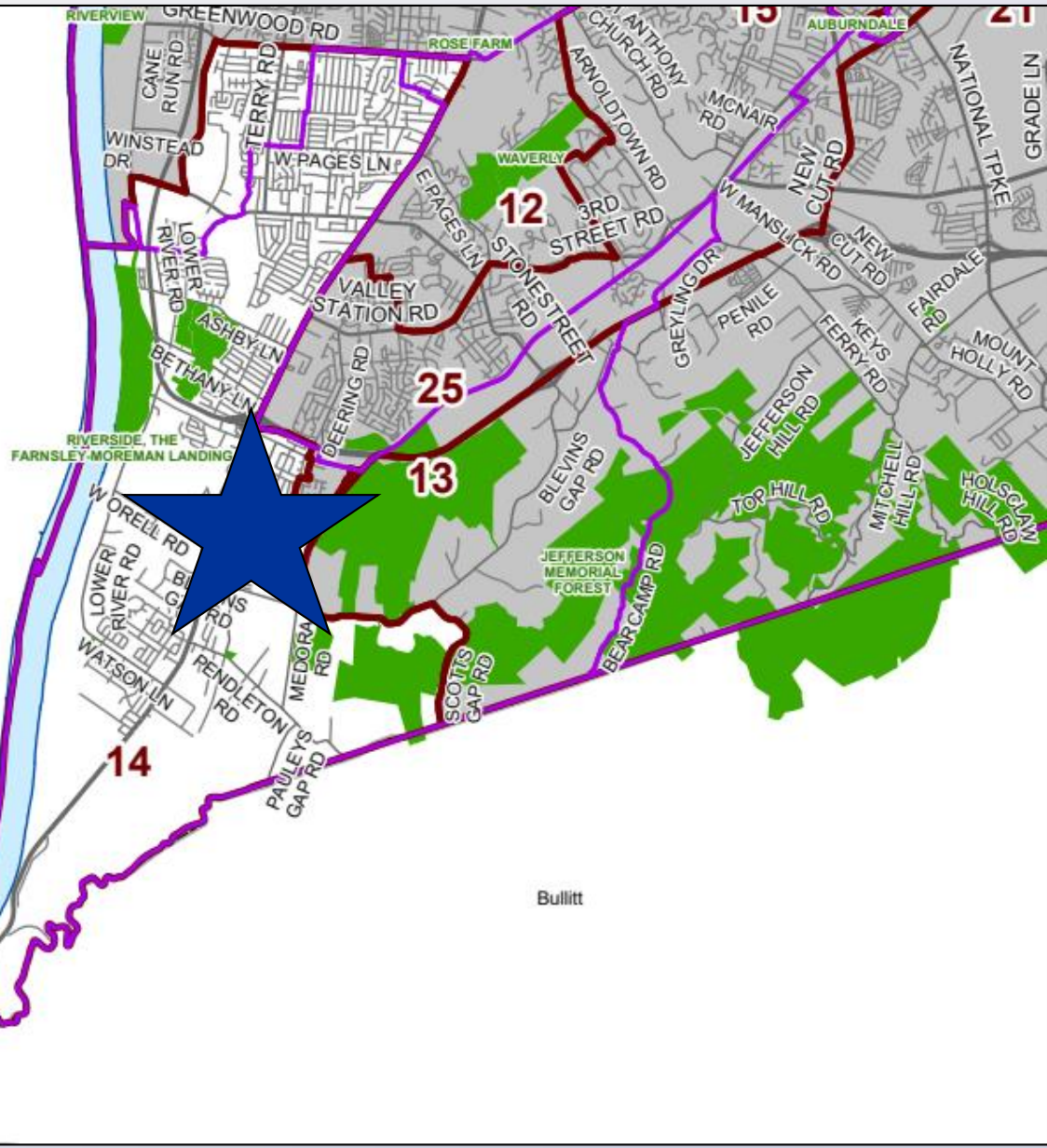

Planning & Zoning Committee
June 14, 2022

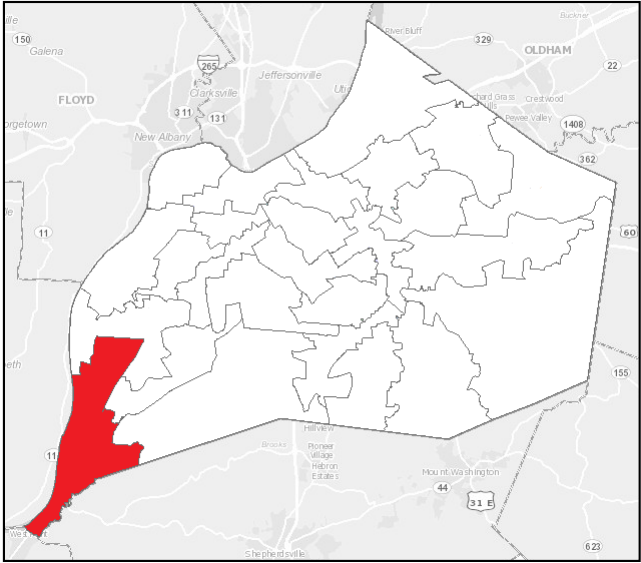

Requests

- Revised Detailed District Development plan

Project Summary

- The applicant is proposing to revise the approved development plan for a mini-warehouse facility currently under construction in southwestern Louisville Metro.
- The site was rezoned to CM with an approved development plan and binding elements under docket 17ZONE1022.
- Subject site is approximately 2.19 acres in the Suburban Marketplace Corridor form district.

Proposed Plan

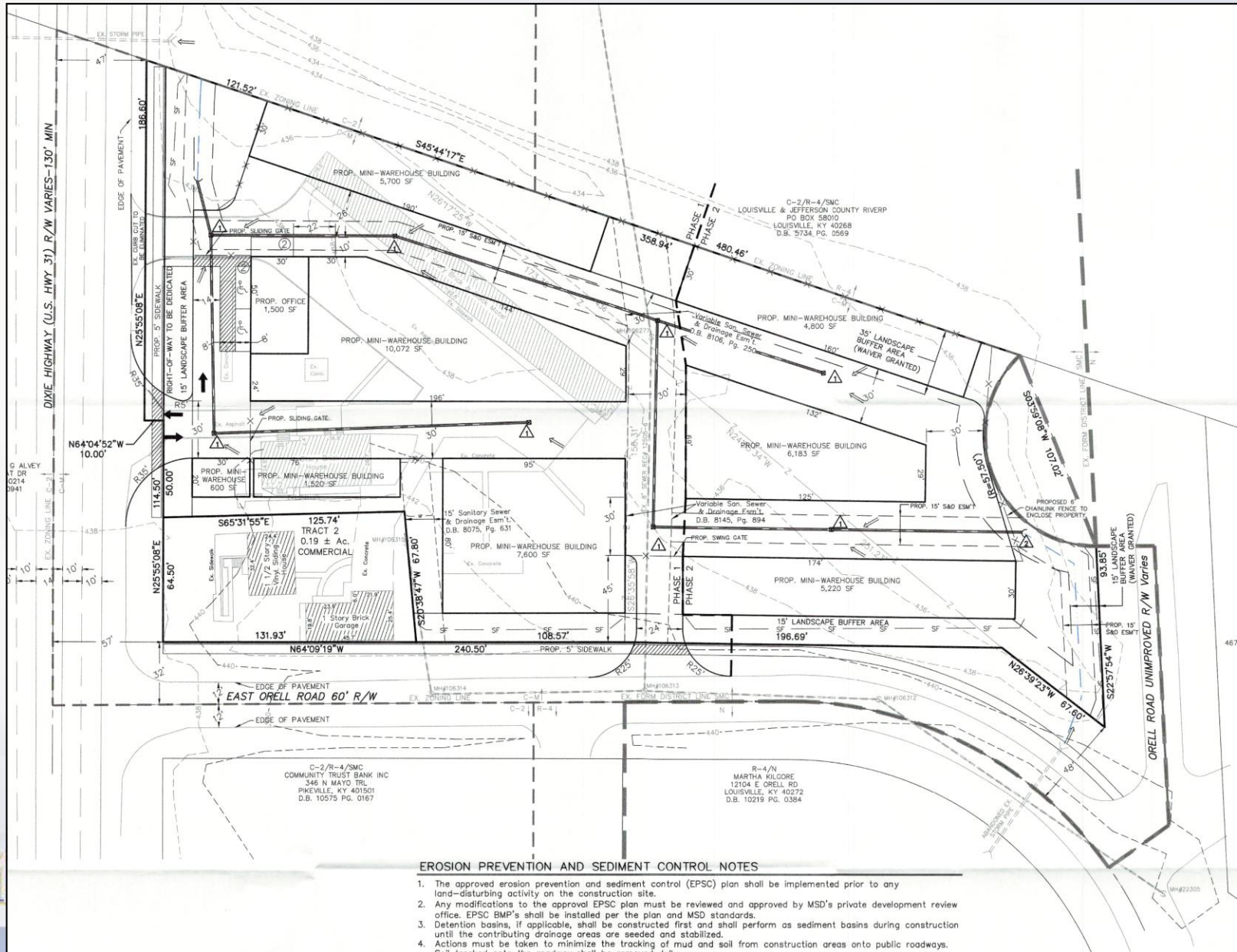

EROSION PREVENTION AND SEDIMENT CONTROL NOTES

1. The approved erosion prevention and sediment control (EPSC) plan shall be implemented prior to any land-disturbing activity on the construction site.
2. Any modifications to the approval EPSC plan must be reviewed and approved by MSD's private development review office. EPSC BMP's shall be installed per the plan and MSD standards.
3. Detention basins, if applicable, shall be constructed first and shall perform as sediment basins during construction until the contributing drainage areas are seeded and stabilized.
4. Actions must be taken to minimize the tracking of mud and soil from construction areas onto public roadways. Soil tracked onto the roadway shall be removed daily.



Structure Built under plan approved in error.



Public Meetings

- Planning Commission public hearing on 5/12/2022
 - No one spoke in opposition.
 - Motion to recommend approval of the revised plan by a vote of 7-0.