

ORDINANCE NO. 198, SERIES 2017

AN ORDINANCE CHANGING THE STREET NAME OF A PORTION OF DAVENPORT DRIVE TO MALONE PLACE AND BEING IN LOUISVILLE METRO (CASE NO. 17STREETS1008).

SPONSORED BY: COUNCILWOMAN MADONNA FLOOD

WHEREAS, the Louisville Metro Planning Commission, as set forth in the minutes and records of Case No. 17STREETS1008, has recommended to the Legislative Council of the Louisville/Jefferson County Metro Government (the "Council") that changing the name of a portion of Davenport Drive to Malone Place and being in Louisville Metro be approved since the name change complies with the applicable guidelines of Cornerstone 2020 and the Land Development Code; and

WHEREAS, the Council concurs in and adopts the findings of the Planning Commission in Case No. 17STREETS1008 and approves and accepts the recommendation of the Planning Commission as set out in said minutes and records.

NOW THEREFORE BE IT ORDAINED BY THE LEGISLATIVE COUNCIL OF THE LOUISVILLE/JEFFERSON COUNTY METRO GOVERNMENT AS FOLLOWS:

SECTION I: That changing the street name of a portion of Davenport Drive to Malone Place as shown on the attached street name change exhibit is approved.

SECTION II: This Ordinance shall take effect upon its passage and approval.



H. Stephen Ott
Metro Council Clerk



Greg Fischer
Mayor



David Yates
President of the Council

10/30/17

Approved Date

APPROVED AS TO FORM AND LEGALITY:
Michael J. O'Connell
Jefferson County Attorney

LOUISVILLE METRO COUNCIL
READ AND PASSED
October 26, 2017

By: *John H. Cannell*

O-360-17 (jc)

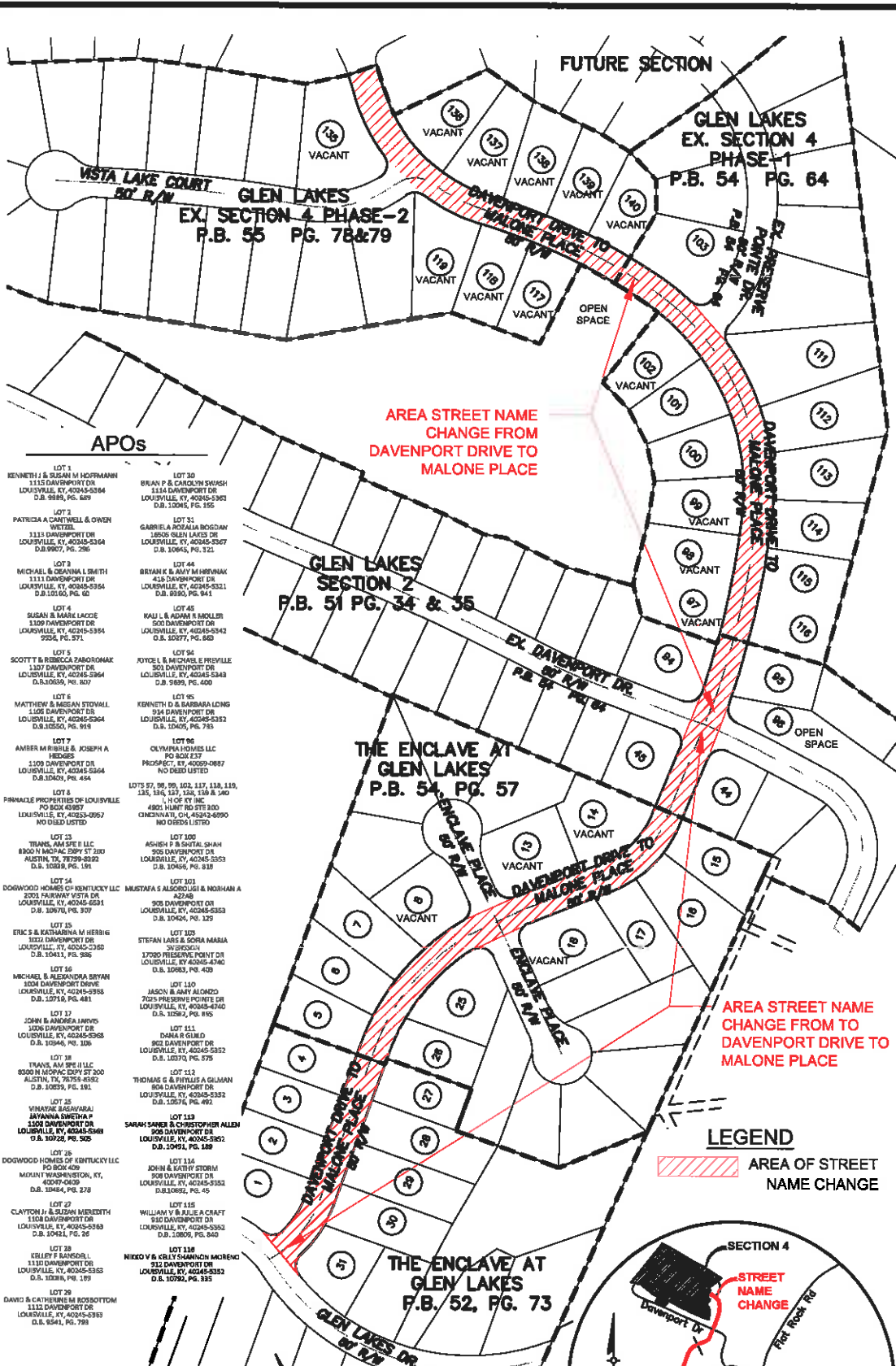

- APOS**
- LOT 1 KENNETH J & SUSAN M MOYBAMANN
1115 DAVENPORT DR
LOUISVILLE, KY, 40245-5364
D.B. 5818, PG. 489
 - LOT 2 PATRICIA A CANTWELL & OWEN WETZEL
1115 DAVENPORT DR
LOUISVILLE, KY, 40245-5364
D.B. 5817, PG. 286
 - LOT 3 MICHAEL & CEANNA L SMITH
1111 DAVENPORT DR
LOUISVILLE, KY, 40245-5364
D.B. 10160, PG. 60
 - LOT 4 SUSAN & MARIE LACZE
1109 DAVENPORT DR
LOUISVILLE, KY, 40245-5364
5934, PG. 571
 - LOT 5 SCOTT Y & REBECCA ZABORONAK
1107 DAVENPORT DR
LOUISVILLE, KY, 40245-5364
D.S. 10529, PG. 807
 - LOT 6 MATTHEW & MEGAN STOWALL
1105 DAVENPORT DR
LOUISVILLE, KY, 40245-5364
D.B. 10250, PG. 918
 - LOT 7 AMBER M BRIDLE & JOSEPH A HEDGES
1103 DAVENPORT DR
LOUISVILLE, KY, 40245-5364
D.B. 10403, PG. 454
 - LOT 8 PINKALE PROPERTIES OF KENTUCKY LLC
PO BOX 43857
LOUISVILLE, KY, 40253-0557
NO 1032 LISTED
 - LOT 9 TRAVIS AM SPE II LLC
8300 N MOPEC CDPY ST 300
AUSTIN, TX, 78759-8392
D.B. 10889, PG. 191
 - LOT 14 DOWWOOD HOMES OF KENTUCKY LLC
2003 FAIRWAY WEST DR
LOUISVILLE, KY, 40245-5361
D.B. 10670, PG. 307
 - LOT 15 ERIC S & KATHARINA M HERBIG
1021 DAVENPORT DR
LOUISVILLE, KY, 40245-5360
D.B. 10411, PG. 586
 - LOT 16 MICHAEL & ALEXANDRA BRYAN
1008 DAVENPORT DRIVE
LOUISVILLE, KY, 40245-5363
D.B. 10710, PG. 481
 - LOT 17 JOHN & ANGELA LAMBUS
1006 DAVENPORT DR
LOUISVILLE, KY, 40245-5368
D.B. 10346, PG. 316
 - LOT 18 TRAVIS AM SPE II LLC
8300 N MOPEC CDPY ST 300
AUSTIN, TX, 78759-8392
D.B. 10859, PG. 191
 - LOT 25 VINAYAK BAGWARI/ARAJAVANNA SURETHA P
1502 DAVENPORT DR
LOUISVILLE, KY, 40245-5368
D.B. 10926, PG. 505
 - LOT 26 DOWWOOD HOMES OF KENTUCKY LLC
PO BOX 409
MOUNTAIN VIEWSTON, KY, 40347-0409
D.B. 10944, PG. 278
 - LOT 27 CLAYTON J & SUZAN MEREDETH
1108 DAVENPORT DR
LOUISVILLE, KY, 40245-5363
D.B. 10421, PG. 26
 - LOT 28 TERRY F LANGRILL
1110 DAVENPORT DR
LOUISVILLE, KY, 40245-5363
D.B. 10384, PG. 189
 - LOT 29 DAVID & CATHERINE M ROZBOTTOM
1112 DAVENPORT DR
LOUISVILLE, KY, 40245-5363
D.B. 6541, PG. 790
 - LOT 30 BRIAN P & CAROLYN SWASH
1114 DAVENPORT DR
LOUISVILLE, KY, 40245-5361
D.B. 10045, PG. 155
 - LOT 31 GABRIEL & ROSARIA RODRIGUEZ
1806 GLEN LAKES DR
LOUISVILLE, KY, 40245-5367
D.B. 10640, PG. 312
 - LOT 44 BRIAN K & AMY M HRRVNAK
415 DAVENPORT DR
LOUISVILLE, KY, 40245-5321
D.B. 9930, PG. 941
 - LOT 45 KALI L & ADAM R BOLLER
500 DAVENPORT DR
LOUISVILLE, KY, 40245-5342
D.B. 10077, PG. 869
 - LOT 94 JOYCE L & MICHAEL E PREVILLE
301 DAVENPORT DR
LOUISVILLE, KY, 40245-5348
D.B. 5899, PG. 400
 - LOT 95 KENNETH D & BARBARA LONG
934 DAVENPORT DR
LOUISVILLE, KY, 40245-5352
D.B. 10405, PG. 783
 - LOT 96 OLYMPIA 103000 LLC
PO BOX 237
MORGANTOWN, KY, 40520-0237
NO 1032 LISTED
 - LOTS 97, 98, 99, 102, 117, 118, 119, 125, 136, 137, 138, 139 & 140
4801 HUNT RD STE 300
CHENOWETH, OH, 43024-0990
NO 1032 LISTED
 - LOT 100 ASHISH P & SHITAL SHAH
505 DAVENPORT DR
LOUISVILLE, KY, 40245-5351
D.B. 10406, PG. 818
 - LOT 101 MUSTAFA S ALQADIRI & NOORHAN A
A2348
908 DAVENPORT DR
LOUISVILLE, KY, 40245-5353
D.B. 10426, PG. 129
 - LOT 102 STEFAN LARS & SOREN MARINA
ONKESCH
1750 PRESERVE POINTE DR
LOUISVILLE, KY 40245-4740
D.B. 10683, PG. 409
 - LOT 110 JASON & AMY ALONZO
7025 PRESERVE POINTE DR
LOUISVILLE, KY, 40245-4340
D.B. 10582, PG. 815
 - LOT 111 DARA R GUMD
802 DAVENPORT DR
LOUISVILLE, KY, 40245-5352
D.B. 10570, PG. 575
 - LOT 112 THOMAS G & PHYLLIS A GILMAN
804 DAVENPORT DR
LOUISVILLE, KY, 40245-5352
D.B. 10576, PG. 492
 - LOT 113 SARAH SANDA & CHRISTOPHER ALLEN
806 DAVENPORT DR
LOUISVILLE, KY, 40245-5352
D.B. 10674, PG. 438
 - LOT 114 JOHN & KATHY STORM
508 DAVENPORT DR
LOUISVILLE, KY, 40245-5352
D.B. 810692, PG. 45
 - LOT 115 WILLIAM V & JULIE R CRAFT
230 DAVENPORT DR
LOUISVILLE, KY, 40245-5352
D.B. 10805, PG. 840
 - LOT 116 NIKKO V & KELLY SHANNON MORGAN
112 DAVENPORT DR
LOUISVILLE, KY, 40245-5352
D.B. 10590, PG. 355

STREET NAME CHANGE EXHIBIT
AUGUST 30, 2017
GLEN LAKES

