

ORDINANCE No. 054, SERIES 2015

AN ORDINANCE CHANGING THE STREET NAME CHANGE OF ROCK BLUFF DRIVE TO RIVER ROCK DRIVE AND BEING IN LOUISVILLE METRO (CASE NO. 15STREETS1004).

Sponsored by: COUNCILWOMAN MADONNA FLOOD

WHEREAS, the Louisville Metro Planning Commission, as set forth in the minutes and records of Case No. 15STREETS1004, has recommended to the Legislative Council of the Louisville/Jefferson County Metro Government (the "Council") that the street name change of Rock Bluff Drive to River Rock Drive and being in Louisville Metro be approved due to street changes on revised preliminary subdivision plans; and

WHEREAS, the Council concurs in and adopts the findings of the Planning Commission in Case No. 15STREETS1004 and approves and accepts the recommendation of the Planning Commission as set out in said minutes and records;

NOW THEREFORE BE IT ORDAINED BY THE LEGISLATIVE COUNCIL OF THE LOUISVILLE/JEFFERSON COUNTY METRO GOVERNMENT AS FOLLOWS:

**Section I:** That the street name change of Rock Bluff Drive to River Rock Drive as shown on the attached exhibit is approved.

**Section II:** This Ordinance shall take effect upon its passage and approval.



H. Stephen Ott  
Metro Council Clerk



David W. Tandy  
President of the Council

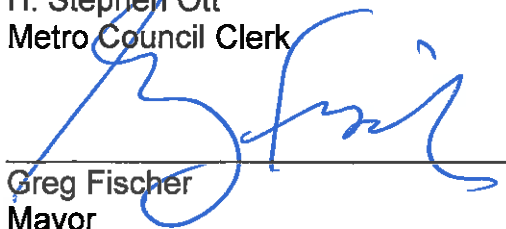

Greg Fischer  
Mayor

Approved: 4/29/15  
Date

APPROVED AS TO FORM AND LEGALITY:  
Michael J. O'Connell  
Jefferson County Attorney

By: 



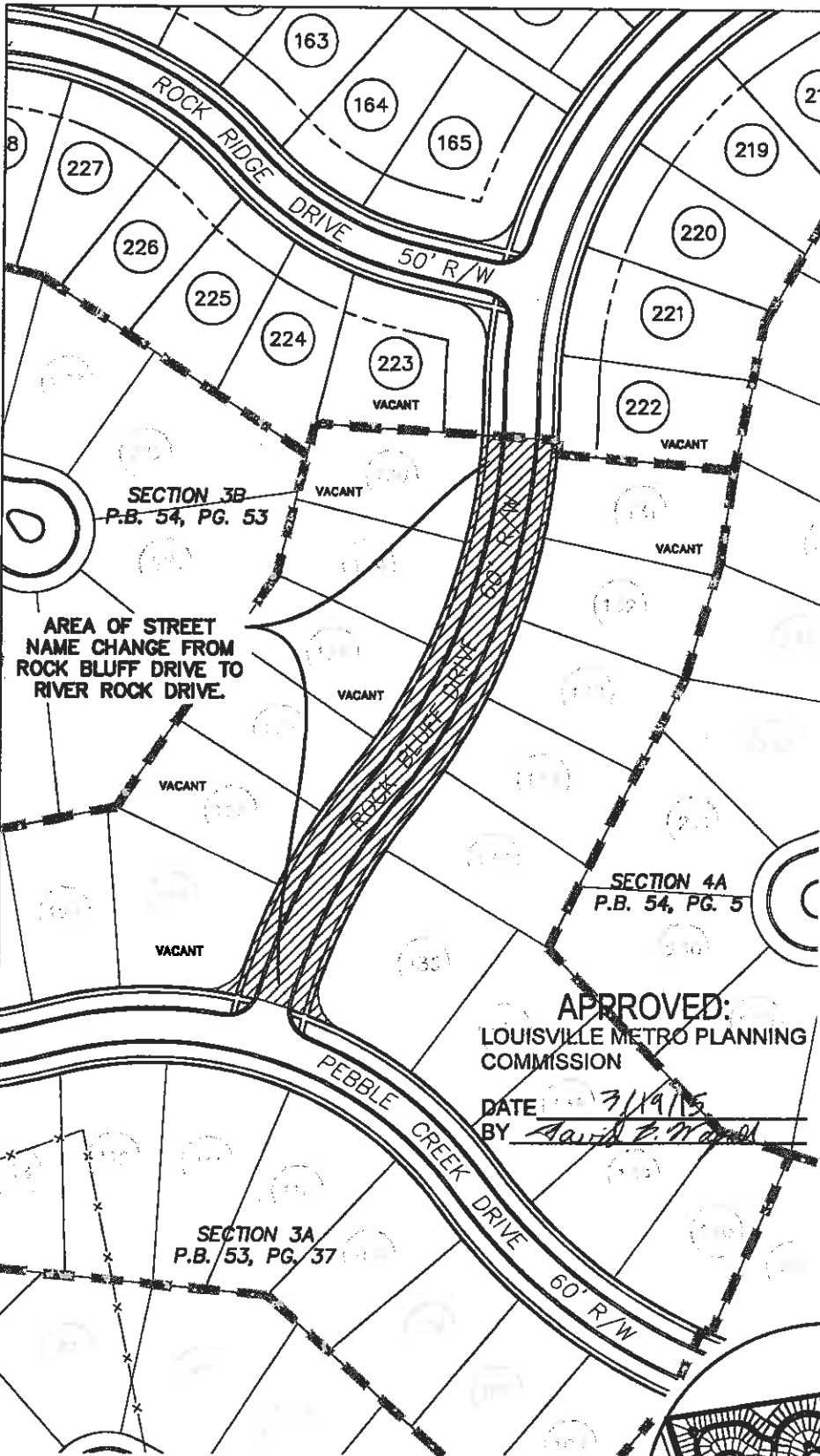

- APOs**
- LOT 125  
ROCK SPRINGS FARMS, LLC  
12488 LA GRANGE RD  
LOUISVILLE, KY, 40245-1901
  - LOT 126  
ROCK SPRINGS FARMS, LLC  
12488 LA GRANGE RD  
LOUISVILLE, KY, 40245-1901
  - LOT 127  
KRISTIE DOAM & DAVID NGUYEN  
5509 ROCK BLUFF DR  
LOUISVILLE, KY, 40241-1485
  - LOT 128  
ROCK SPRINGS FARMS, LLC  
12488 LA GRANGE RD  
LOUISVILLE, KY, 40245-1901
  - LOT 129  
RYAN & BRANDI WEST  
5505 ROCK BLUFF DR  
LOUISVILLE, KY, 40241-1485
  - LOT 130  
STEPHEN & CHRISTINE SIEBEL  
5503 ROCK BLUFF DRIVE  
LOUISVILLE, KY 40241
  - LOT 131  
ROCK SPRINGS FARMS, LLC  
12488 LA GRANGE RD  
LOUISVILLE, KY, 40245-1901
  - LOT 132  
KELLY ALLGEIER LYONS & CHRISTOPHER LYONS  
5504 ROCK BLUFF DR  
LOUISVILLE, KY, 40241-1484
  - LOT 133  
JASON & CARRIE WILLIS  
5506 ROCK BLUFF DR  
LOUISVILLE, KY, 40241-1484
  - LOT 134  
DREW & KRISTIN LAMASTER  
5508 ROCK BLUFF DR  
LOUISVILLE, KY, 40241-1484
  - LOT 135  
LALIT & GEETA PAREBA  
5510 ROCK BLUFF DR  
LOUISVILLE, KY, 40241-1484
  - LOT 136  
ROCK SPRINGS FARMS, LLC  
12488 LA GRANGE RD  
LOUISVILLE, KY, 40245-1901
  - LOT 222  
ROCK SPRINGS FARMS, LLC  
12488 LA GRANGE RD  
LOUISVILLE, KY, 40245-1901
  - LOT 223  
ROCK SPRINGS FARMS, LLC  
12488 LA GRANGE RD  
LOUISVILLE, KY, 40245-1901

SECTION 3B  
P.B. 54, PG. 53

AREA OF STREET  
NAME CHANGE FROM  
ROCK BLUFF DRIVE TO  
RIVER ROCK DRIVE.

SECTION 4A  
P.B. 54, PG. 5

SECTION 3A  
P.B. 53, PG. 37

APPROVED:  
LOUISVILLE METRO PLANNING  
COMMISSION

DATE: 3/19/15  
BY: David B. Marshall



**STREET NAME  
CHANGE EXHIBIT**  
FEBRUARY 26, 2015  
**ROCK SPRINGS  
FARM**

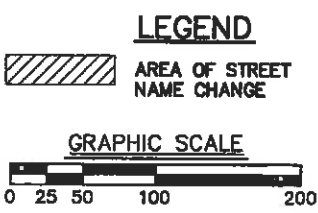

**SABAK, WILSON & LINGO, INC.**  
ENGINEERS, LANDSCAPE ARCHITECTS & PLANNERS  
THE HENRY CLAY 808 S. THIRD STREET, LOUISVILLE, KENTUCKY 40202 (502) 584-6271

**LOCATION MAP**  
NO SCALE

15210 PETSINDA