

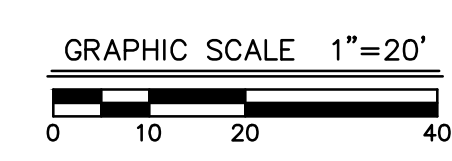

Plan for  
Detailed Shoulder  
Improvements

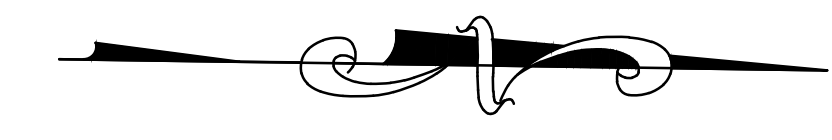
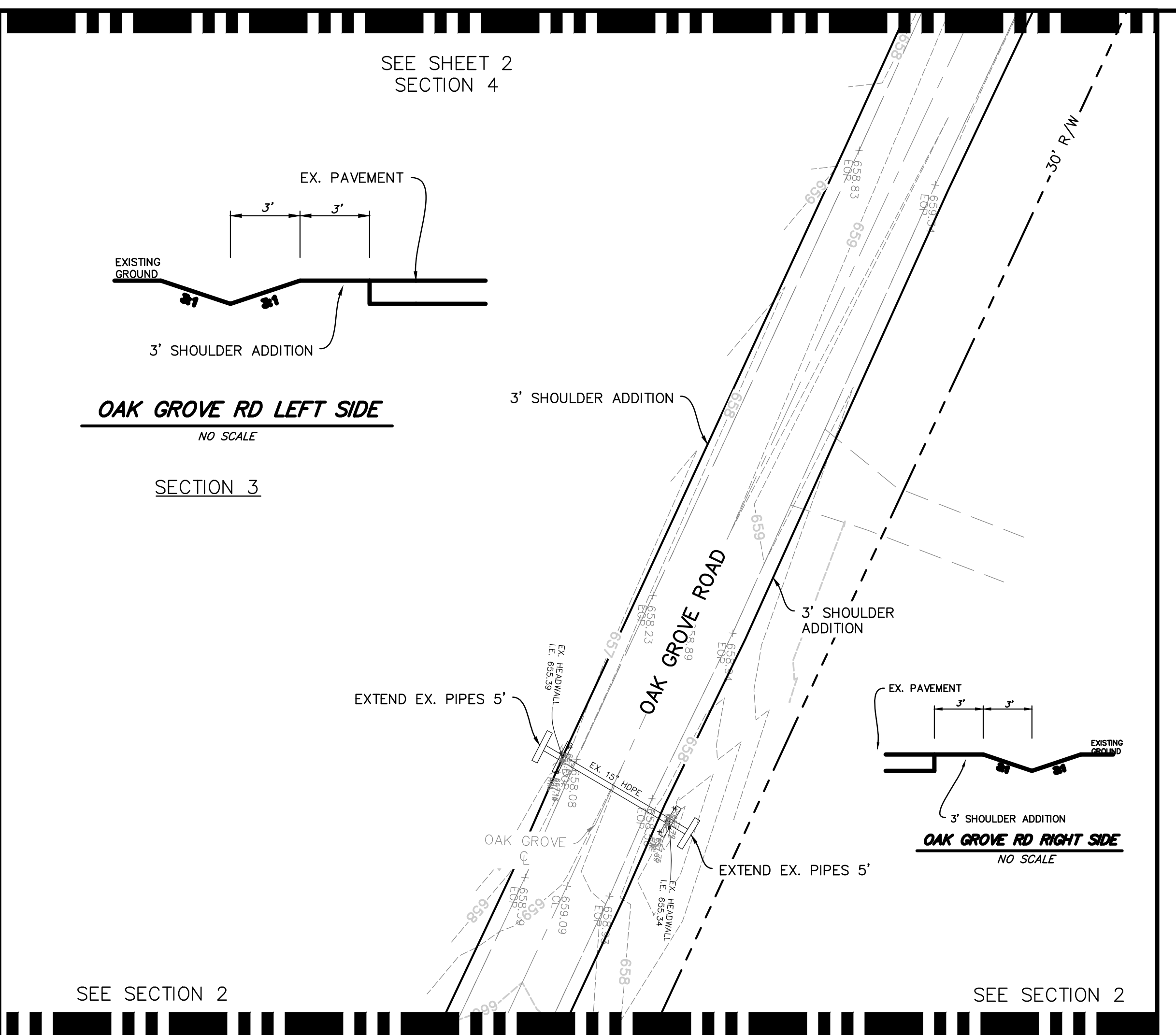
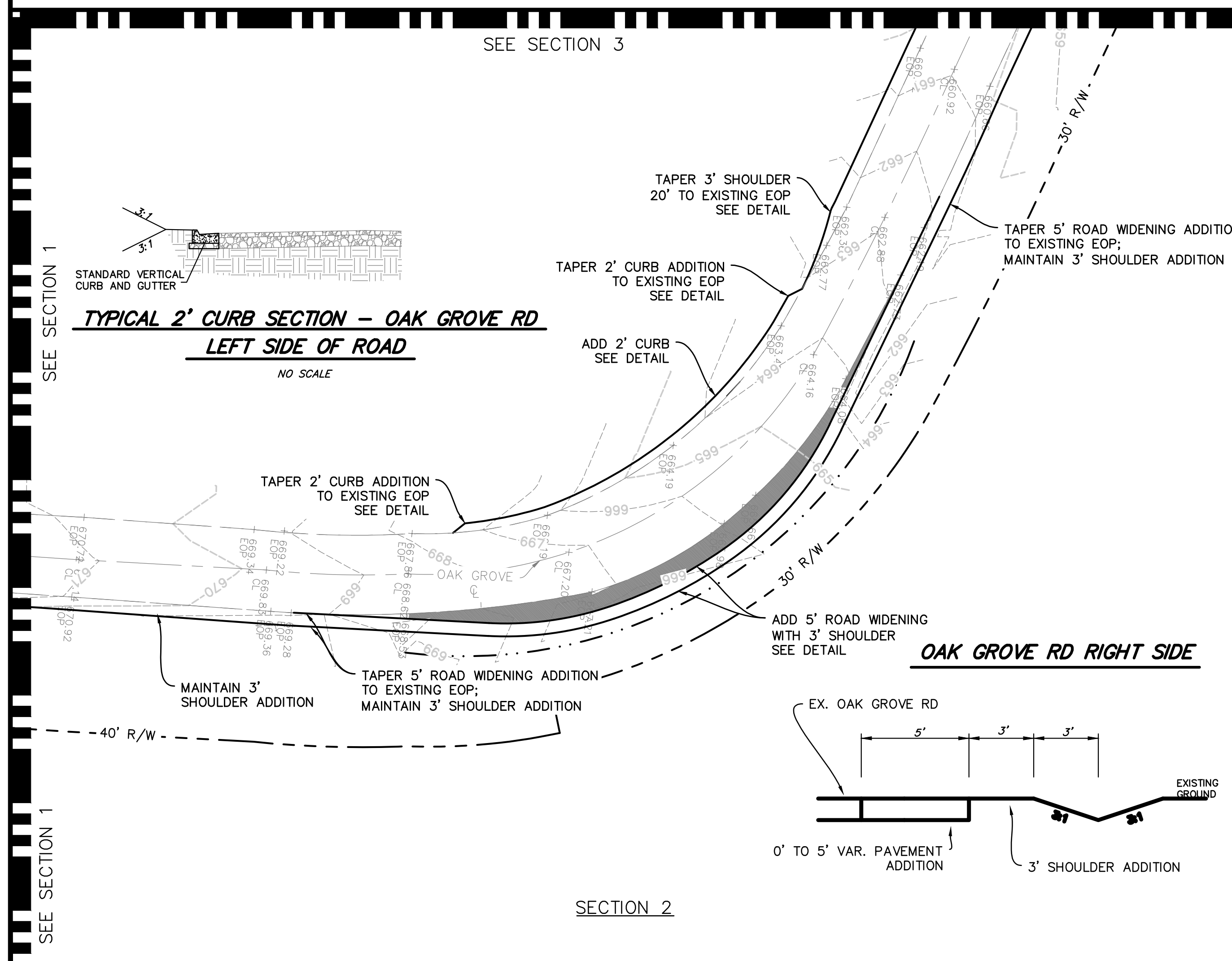
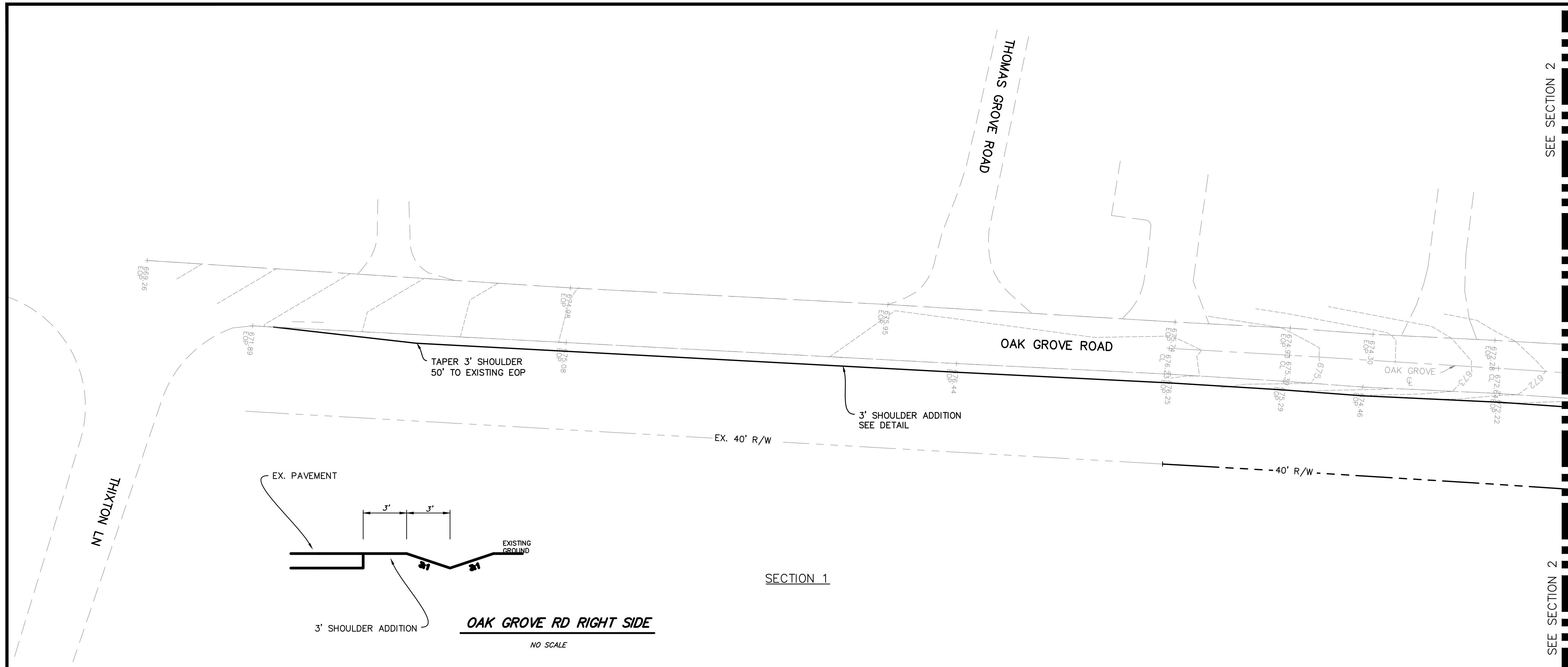

FOR AGENCY REVIEW

Vertical Scale: N/A

Horizontal Scale: 1"=20'

Date: 5/26/22  
Job Number: 3694

Sheet

1

of 7

PROFESSIONAL ENGINEER'S SEAL

**MINDEL SCOTT**  
ENGINEERING & SURVEYING & PLANNING & LANDSCAPE ARCHITECTURE  
5131 Jefferson Blvd. Louisville, KY 40219  
502-485-1508 > MindelScott.com

DEVELOPER  
**JOHN SCHULTE**  
C/O S ACQUISITIONS, LLC  
9707 SHELBYVILLE ROAD  
LOUISVILLE, KY 40223

OWNER  
**THE PARKER LIVING TRUST**  
10302 OAK GROVE RD  
LOUISVILLE, KY 40291

OWNER  
**THE ESTATE OF DORIS ANN PARKER**  
1702 EASTBRIDGE CT  
LOUISVILLE, KY 40223

ROAD IMPROVEMENT CONCEPT  
**OAK GROVE ROAD AND INDEPENDENCE SCHOOL ROAD**

Revisions

SEE SECTION 5

SEE SECTION 5

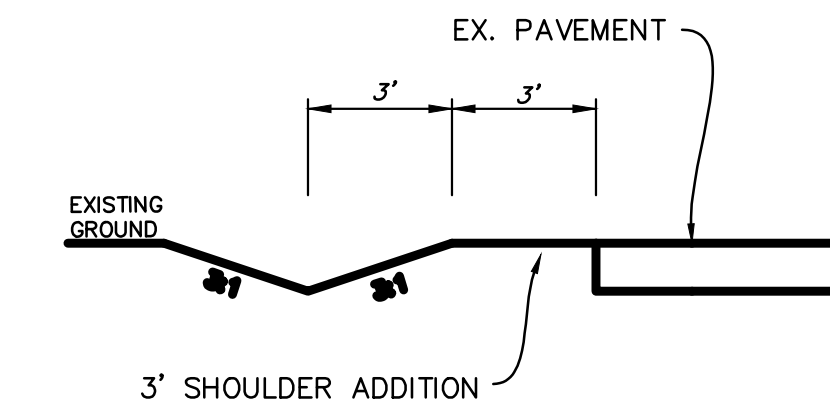

**OAK GROVE RD LEFT SIDE**  
NO SCALE

SECTION 4

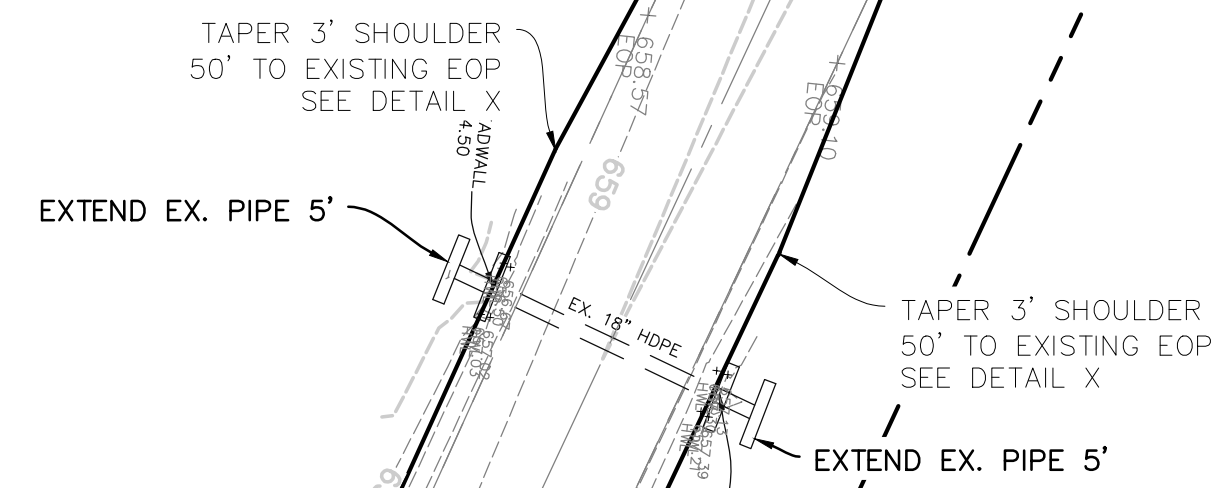

SEE SHEET 1  
SECTION 3

SEE SHEET 1  
SECTION 3

SEE SECTION 6

SECTION 5

SEE SECTION 4

SEE SECTION 4

SECTION 6

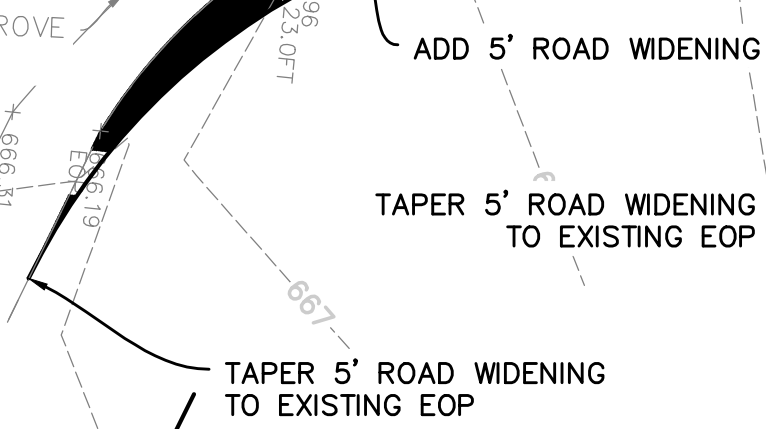

SEE SECTION 5

SEE SECTION 6

SEE SECTION 7

SEE SECTION 6

SECTION 7

SEE SHEET 3  
SECTION 8

**TYPICAL 2' CURB SECTION**  
NO SCALE

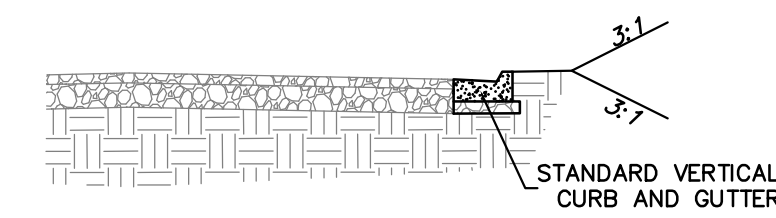

TAPER 2' CURB ADDITION  
TO EXISTING EOP  
SEE DETAIL

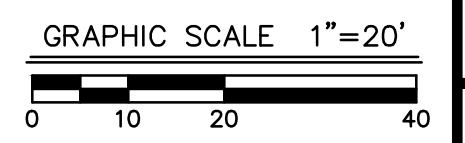
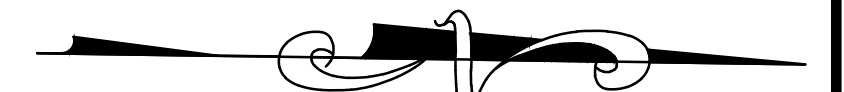

FOR AGENCY REVIEW

PROFESSIONAL ENGINEER'S SEAL

Revisions

Vertical Scale: N/A

Horizontal Scale: 1"=20'

Date: 5/26/22  
Job Number: 3694

Sheet

2

of 7

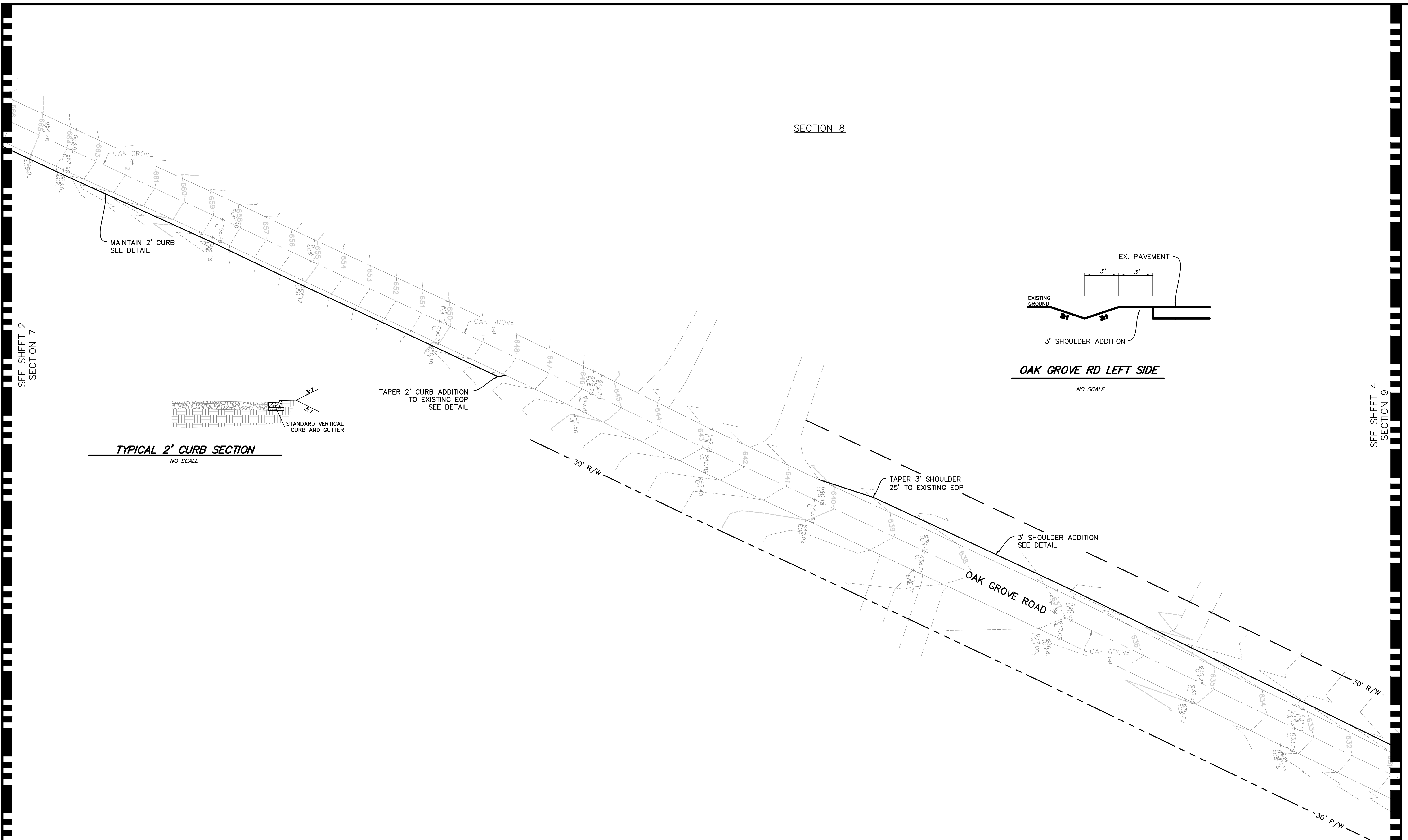

SEE SHEET 2  
SECTION 7

SECTION 8

MAINTAIN 2' CURB  
SEE DETAIL

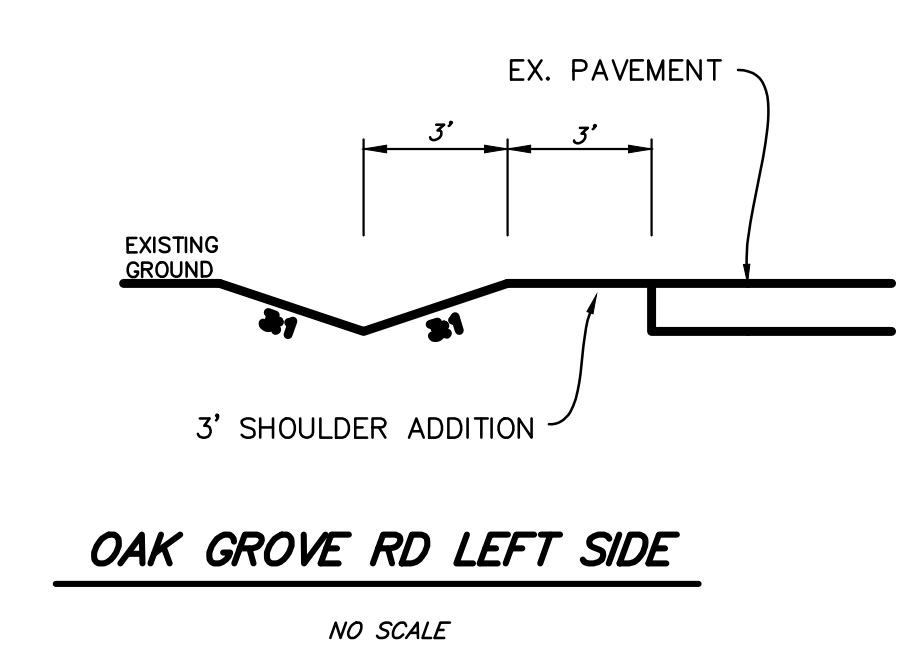
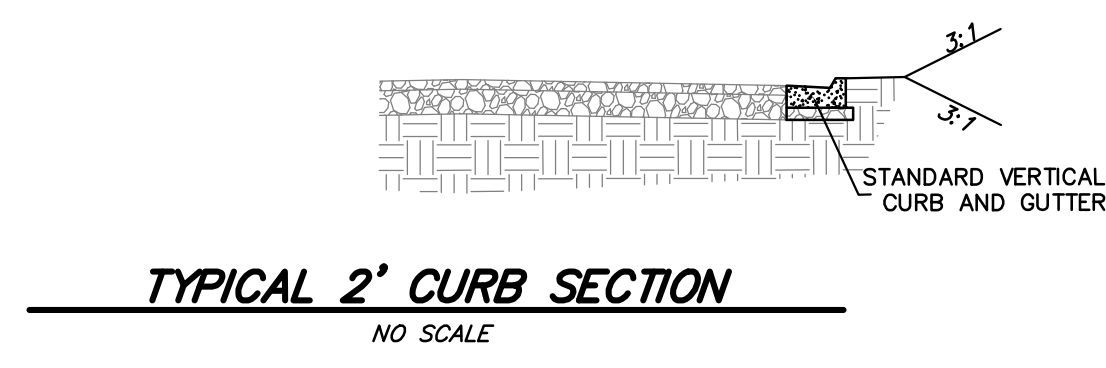

SEE SHEET 4  
SECTION 9

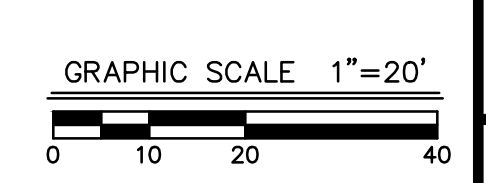
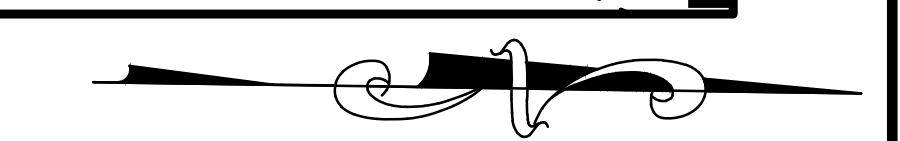

FOR AGENCY REVIEW

Revisions

Vertical Scale: N/A

Horizontal Scale: 1"=20'

Date: 5/26/22  
Job Number: 3694

Sheet  
**3**  
of 7

**MINDEL SCOTT**  
ENGINEERING & PLANNING  
5111 Jefferson Blvd. Louisville, KY 40219  
502-485-1508

DEVELOPER  
**JOHN SCHULTE**  
C/O. S. ACQUISITIONS, LLC  
9707 SHELBYVILLE ROAD  
LOUISVILLE, KY 40223

OWNER  
**THE PARKER LIVING TRUST**  
10302 OAK GROVE RD  
LOUISVILLE, KY 40291

OWNER  
**THE ESTATE OF DORIS ANN PARKER**  
1702 EASTBRIDGE CT  
LOUISVILLE, KY 40223

ROAD IMPROVEMENT CONCEPT  
**OAK GROVE ROAD AND INDEPENDENCE SCHOOL ROAD**

PROFESSIONAL ENGINEER'S SEAL

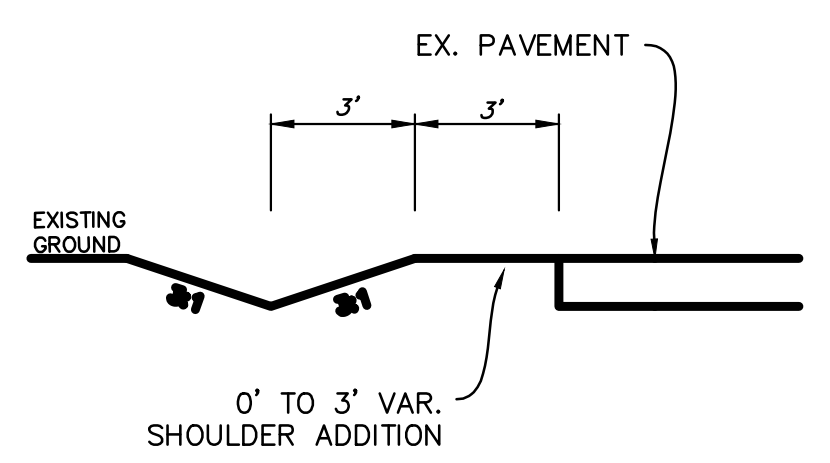
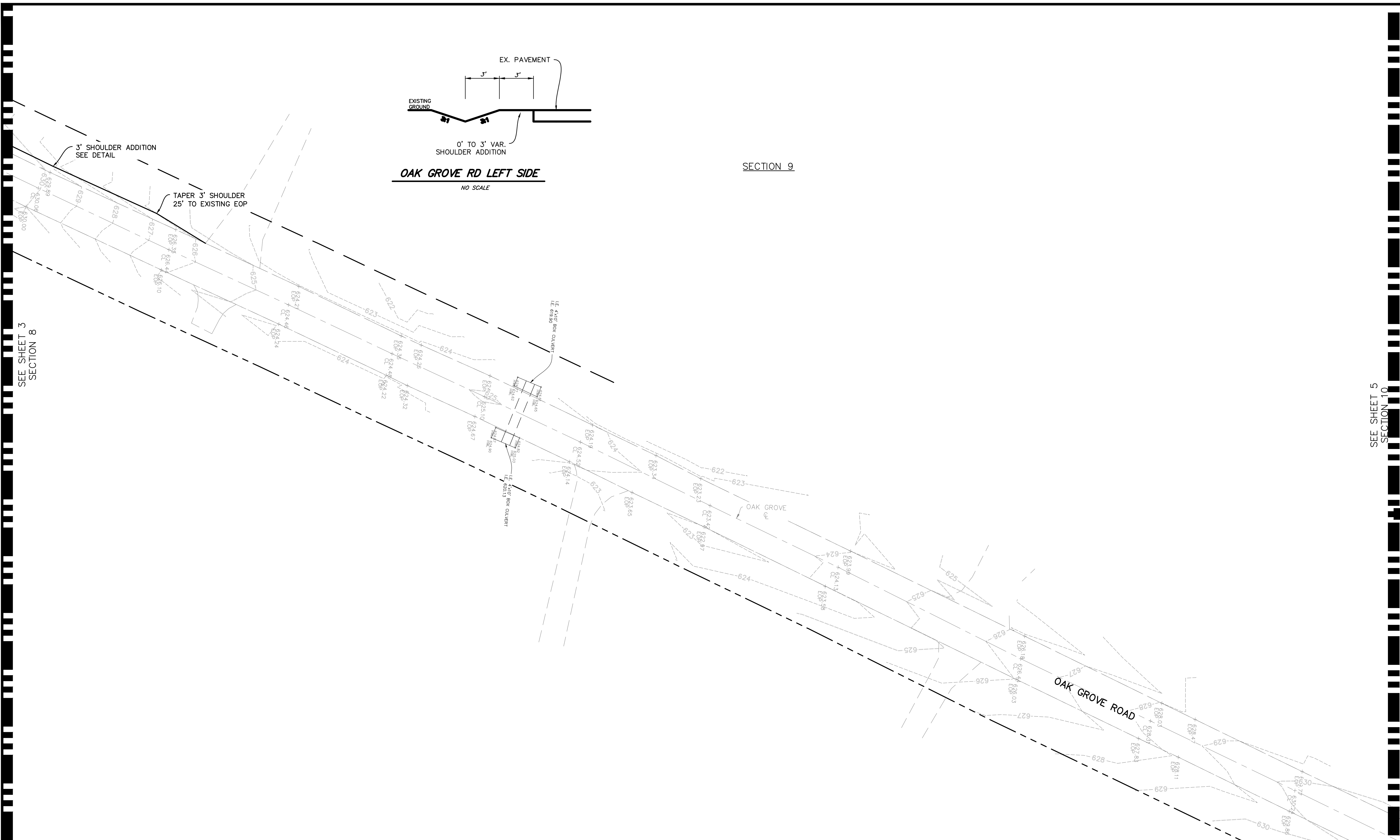

SECTION 9

SEE SHEET 3  
SECTION 8

SEE SHEET 5  
SECTION 10

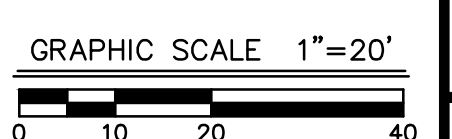

FOR AGENCY REVIEW

PROFESSIONAL ENGINEER'S SEAL

Revisions

Vertical Scale: N/A

Horizontal Scale: 1"=20'

Date: 5/26/22

Job Number: 3694

Sheet

**4**

of 7

**MINDEL SCOTT**  
 ENGINEERING > SURVEYING > PLANNING > LANDSCAPE ARCHITECTURE  
 5131 Jefferson Blvd. Louisville, KY, 40219  
 502-485-1588 > [MindelScott.com](http://MindelScott.com)

DEVELOPER  
**JOHN SCHULTE**  
 C/O. S. ACQUISITIONS, LLC  
 9707 SHELBYVILLE ROAD  
 LOUISVILLE, KY 40223

OWNER  
**THE PARKER LIVING TRUST**  
 10302 OAK GROVE RD  
 LOUISVILLE, KY 40291

OWNER  
**THE ESTATE OF DORIS ANN PARKER**  
 1702 EASTBRIDGE CT  
 LOUISVILLE, KY 40223

ROAD IMPROVEMENT CONCEPT  
**OAK GROVE ROAD AND INDEPENDENCE SCHOOL ROAD**

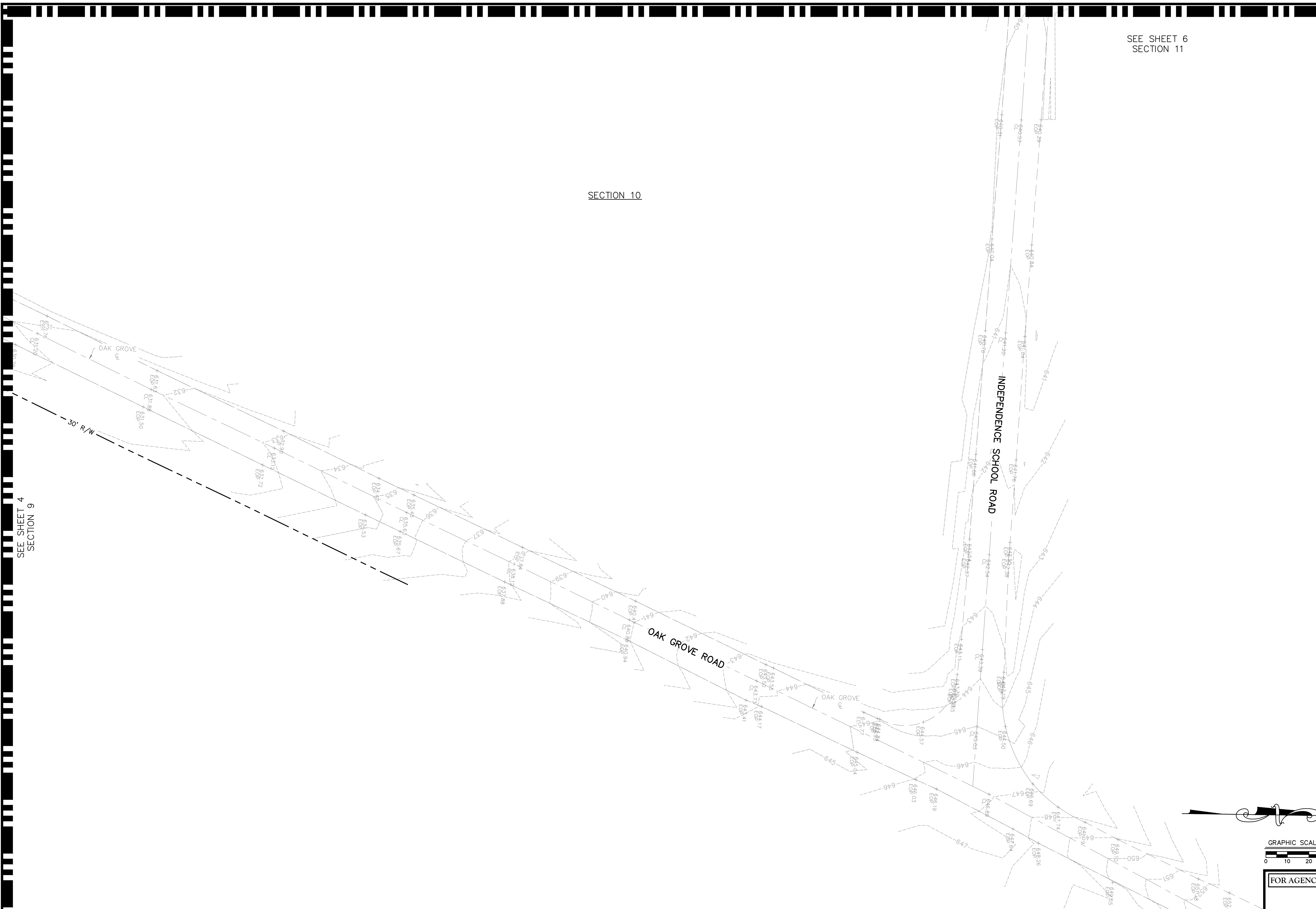

SEE SHEET 6  
SECTION 11

SECTION 10.

SEE SHEET 4  
SECTION 9

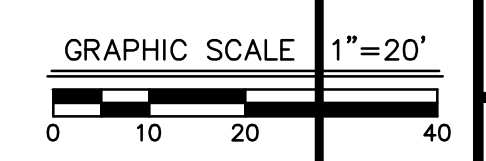

FOR AGENCY REVIEW

Date: 5/26/22  
Job Number: 3694

Sheet  
**5**  
of 7

PROFESSIONAL ENGINEER'S SEAL

Revisions

Vertical Scale: N/A

Horizontal Scale: 1"=20'

ROAD IMPROVEMENT CONCEPT  
OAK GROVE ROAD AND  
INDEPENDENCE SCHOOL ROAD

OWNER  
THE ESTATE OF  
DORIS ANN PARKER  
1702 EASTBRIDGE CT  
LOUISVILLE, KY 40223

OWNER  
THE PARKER LIVING  
TRUST  
10302 OAK GROVE RD  
LOUISVILLE, KY 40291

DEVELOPER  
JOHN SCHULTE  
C/O S ACQUISITIONS LLC  
9707 SHELBYVILLE ROAD  
LOUISVILLE, KY 40223

**MINDEL SCOTT**  
ENGINEERING ► SURVEYING ► PLANNING ► LANDSCAPE ARCHITECTURE  
5131 Jefferson Blvd. Louisville, KY 40219  
502-485-1588 ► MindelScott.com

SEE SECTION 12

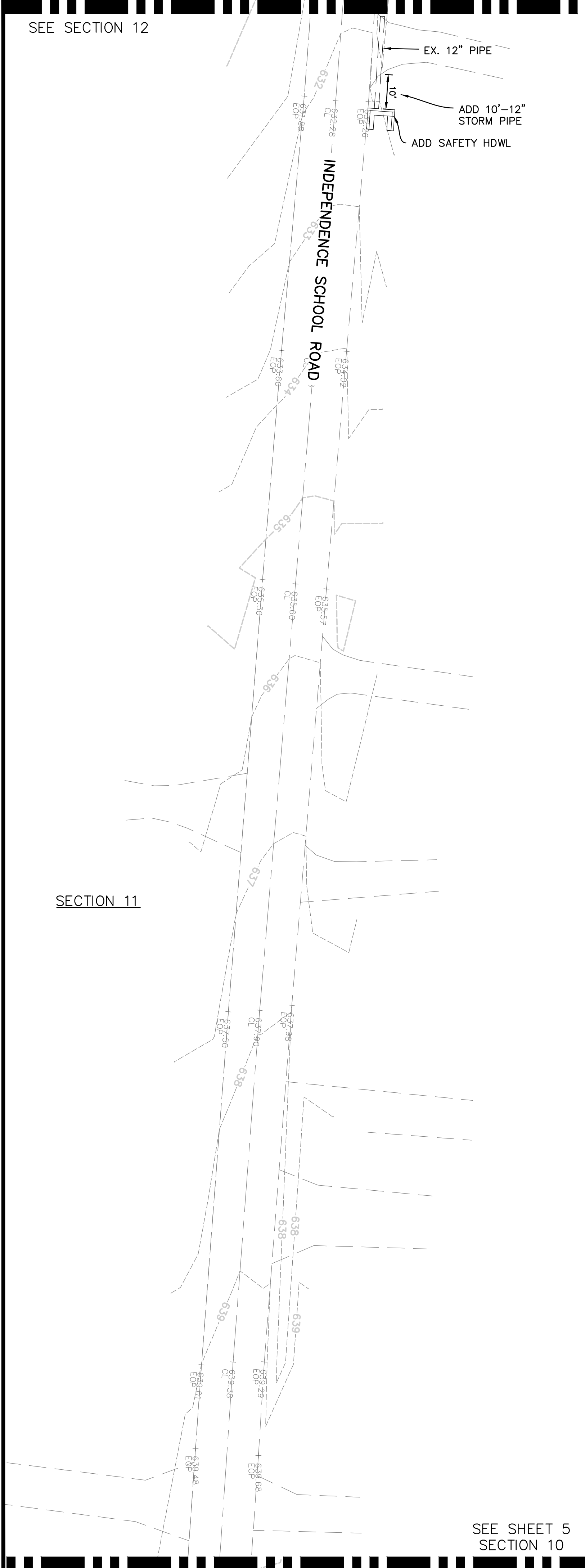

SEE SHEET 5  
SECTION 10

SECTION 12

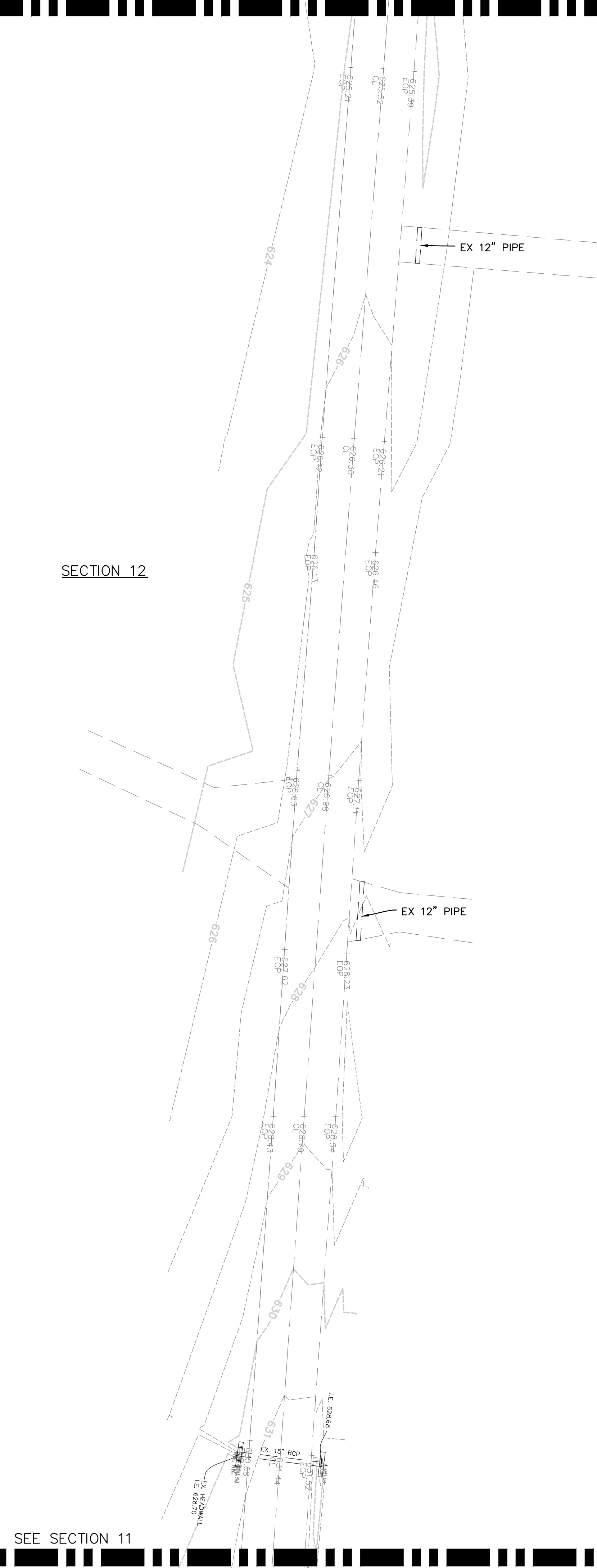

SEE SECTION 11

SEE SHEET 7  
SECTION 14

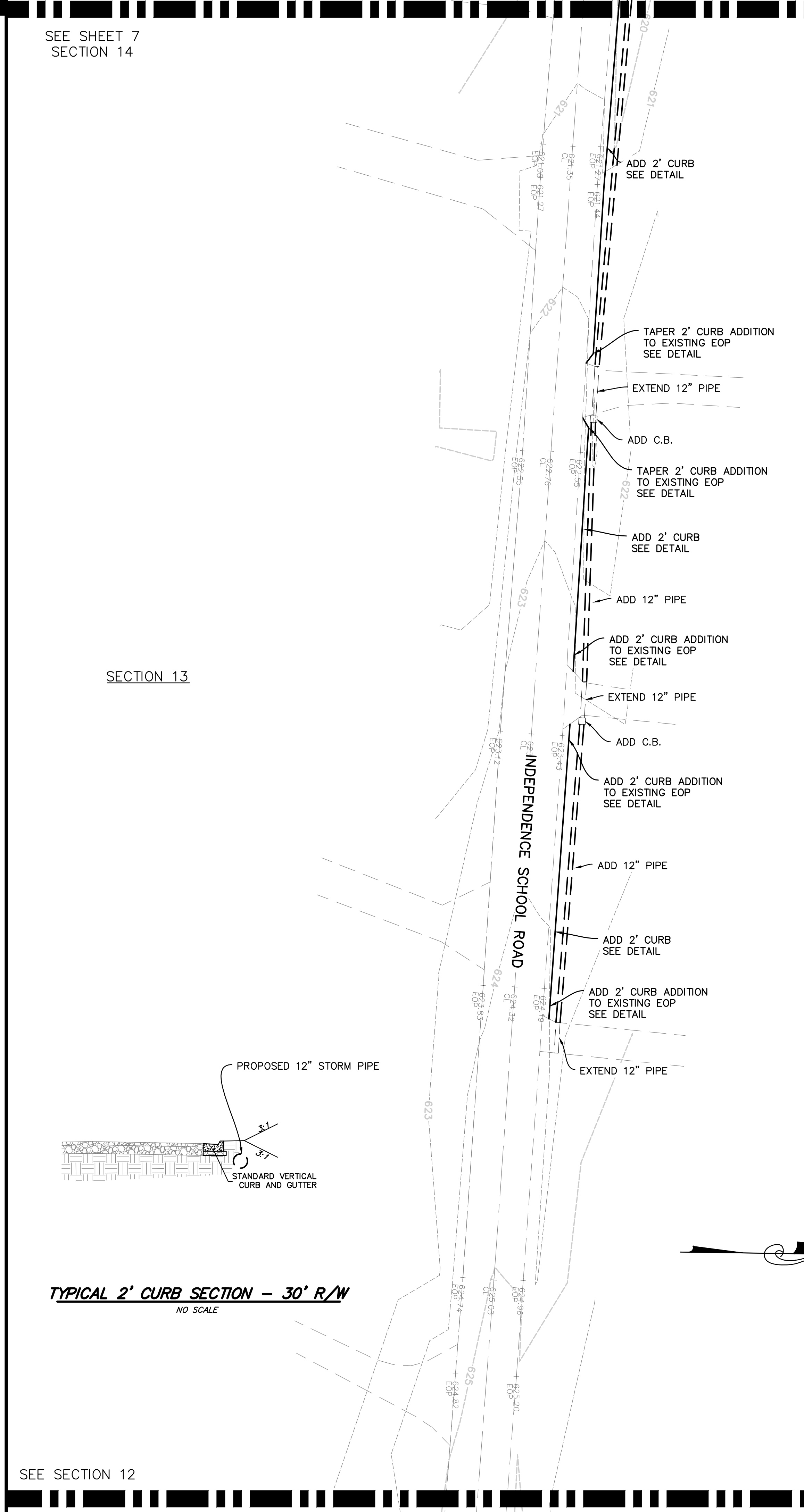

SEE SECTION 12

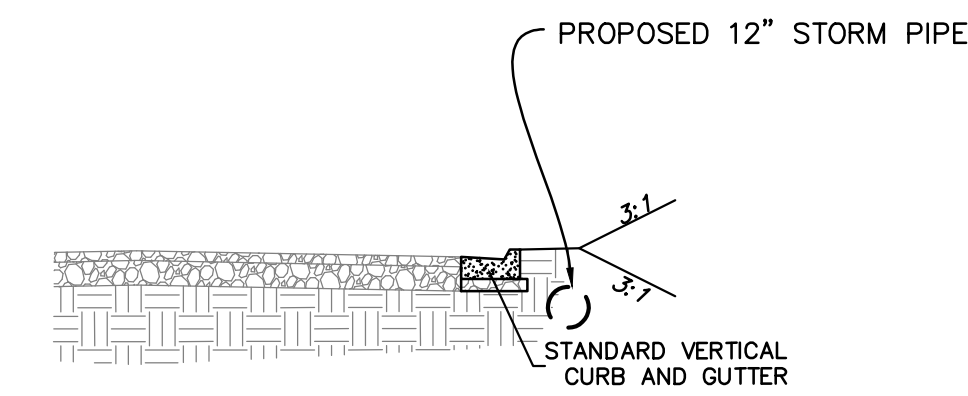

**TYPICAL 2' CURB SECTION - 30' R/W**  
NO SCALE



GRAPHIC SCALE 1"=20'

0 10 20 40

FOR AGENCY REVIEW

Vertical Scale: N/A

Horizontal Scale: 1"=20'

Date: 5/26/22  
Job Number: 3694

Sheet

**6**

of 7

PROFESSIONAL ENGINEER'S SEAL

Revisions

Vertical Scale: N/A

Horizontal Scale: 1"=20'

Date: 5/26/22  
Job Number: 3694

Sheet

**6**

of 7

ROAD IMPROVEMENT CONCEPT  
**OAK GROVE ROAD AND  
INDEPENDENCE SCHOOL ROAD**

OWNER  
**THE ESTATE OF  
DORIS ANN PARKER**  
1702 EASTBRIDGE CT  
LOUISVILLE, KY 40223

OWNER  
**THE PARKER LIVING  
TRUST**  
10302 OAK GROVE RD  
LOUISVILLE, KY 40291

DEVELOPER  
**JOHN SCHULTE  
C/O. S. ACQUISITIONS, LLC**  
9707 SHELBYVILLE ROAD  
LOUISVILLE, KY 40223



**MINDEL SCOTT**  
ENGINEERING & SURVEYING > PLANNING > LANDSCAPE ARCHITECTURE  
5131 Jefferson Blvd. Louisville, KY 40219  
502-485-1508 > MindelScott.com

SECTION 14

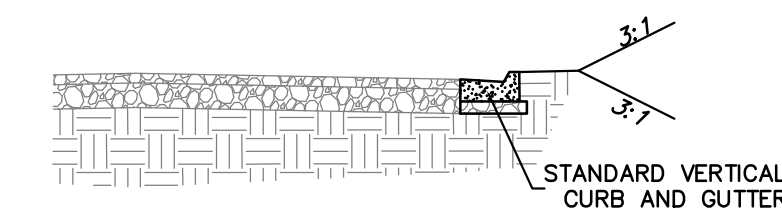
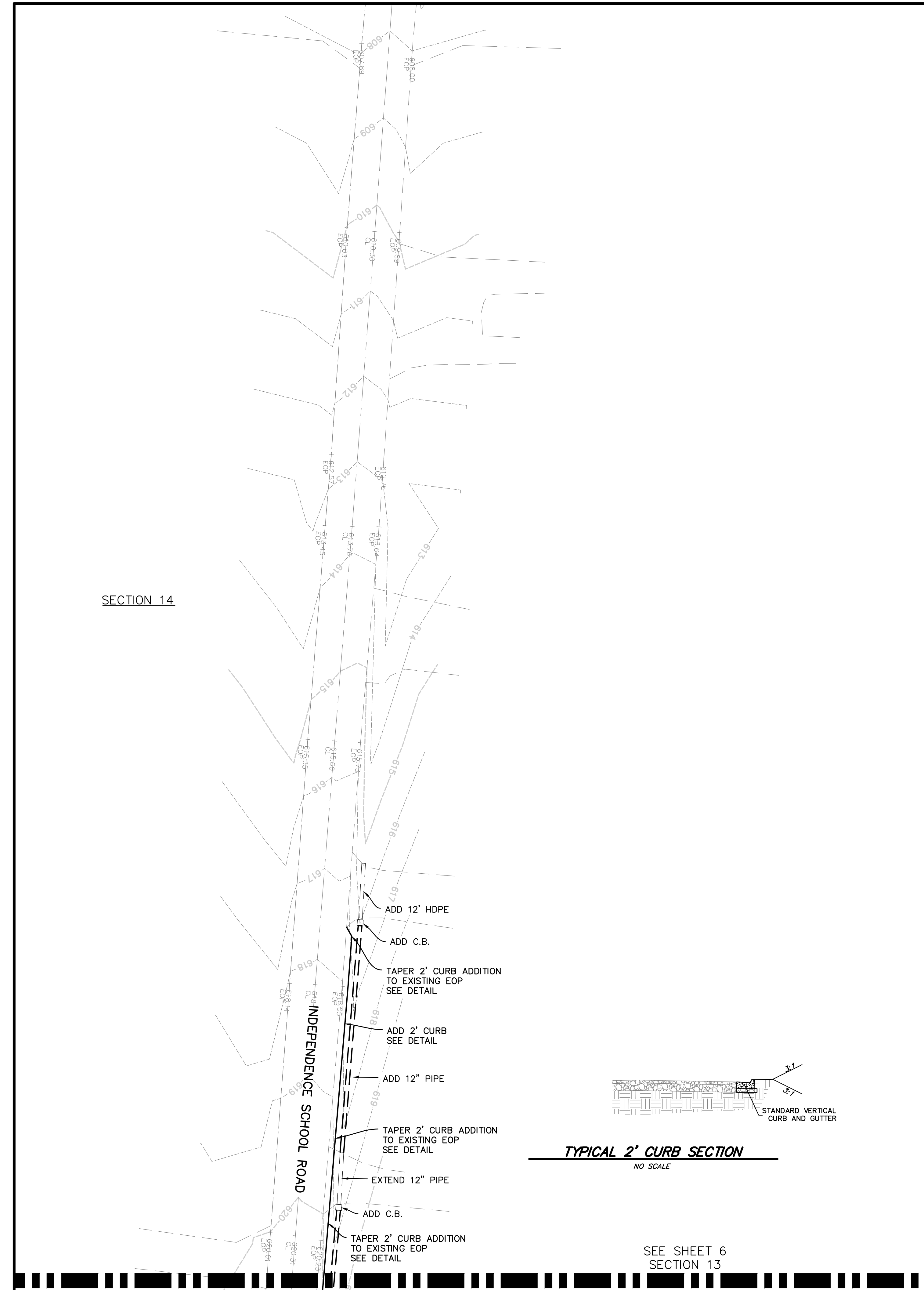

**TYPICAL 2' CURB SECTION**  
NO SCALE

SEE SHEET 6  
SECTION 13

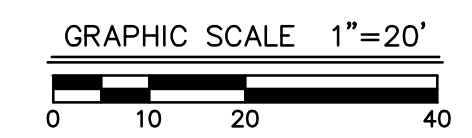
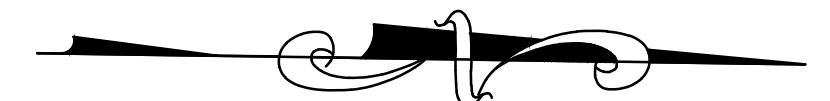

FOR AGENCY REVIEW

Date: 5/26/22  
Job Number: 3694

Sheet

7

PROFESSIONAL ENGINEER'S SEAL

Revisions

Vertical Scale: N/A

Horizontal Scale: 1"=20'

of 7

ROAD IMPROVEMENT CONCEPT  
**OAK GROVE ROAD AND  
INDEPENDENCE SCHOOL ROAD**

OWNER  
**THE ESTATE OF  
DORIS ANN PARKER**  
1702 EASTBRIDGE CT  
LOUISVILLE, KY 40223

OWNER  
**THE PARKER LIVING  
TRUST**  
10302 OAK GROVE RD  
LOUISVILLE, KY 40291

DEVELOPER  
**JOHN SCHULTE  
C/O. S. ACQUISITIONS, LLC**  
9707 SHELBYVILLE ROAD  
LOUISVILLE, KY 40223

**MINDEL SCOTT**  
ENGINEERING ► SURVEYING ► PLANNING ► LANDSCAPE ARCHITECTURE  
5131 Jefferson Blvd. Louisville, KY 40219  
502-485-1588 ► MindelScott.com