

Huber Book Enterprises

W.D. B. & Erma D. O'Heefe W.D. N. & Verna M. Mitchell Edward C. Greenwald Earl & Josephine Whitlow Josephine Whitlow Carlene Moore Jesse L. Redman John Thomas Gannon

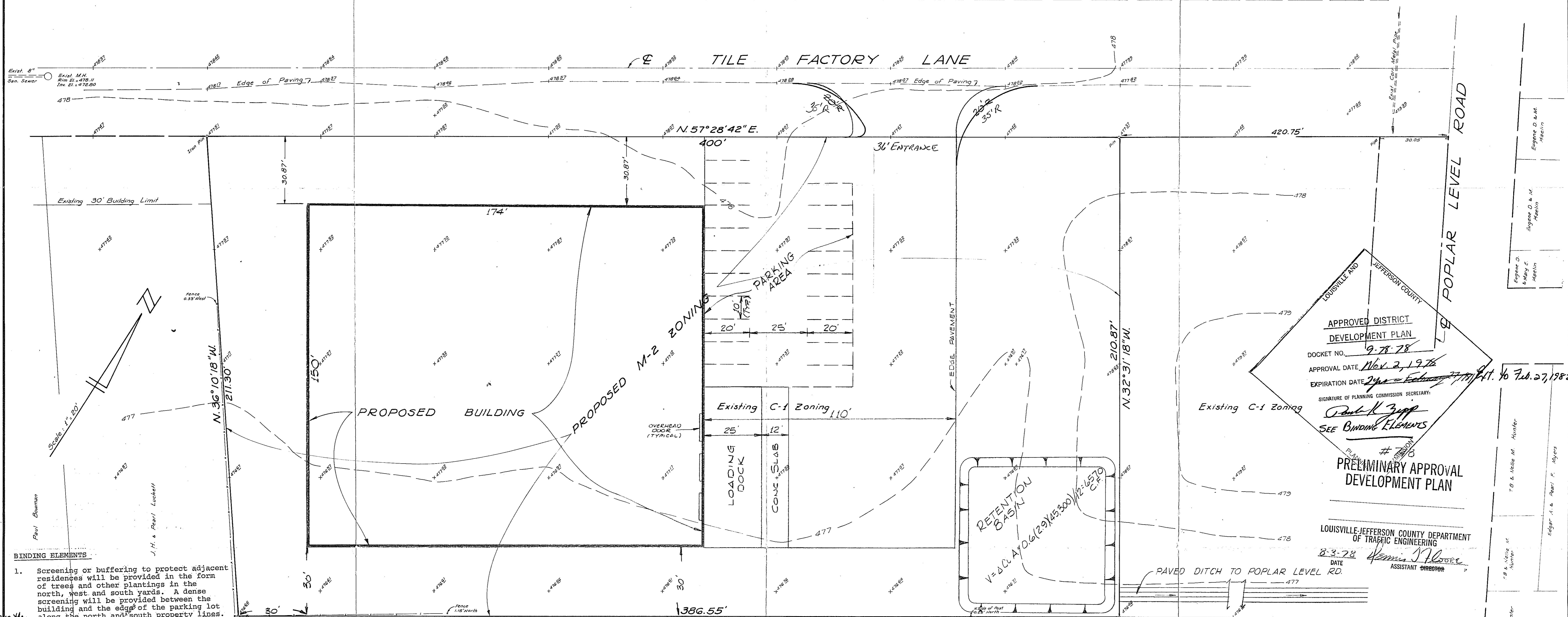
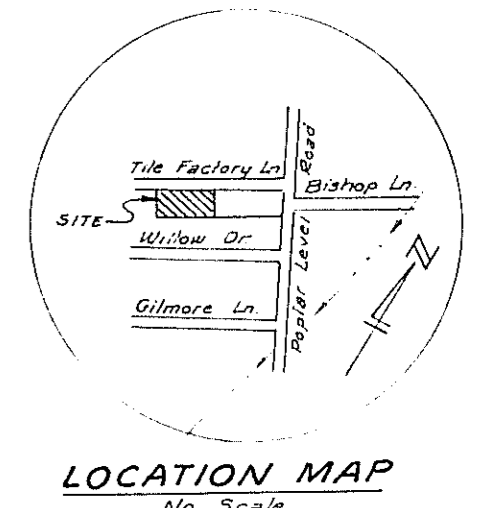

APPROVED DISTRICT DEVELOPMENT PLAN
DOCKET NO. 9-78-78
APPROVAL DATE Nov. 2, 1978
EXPIRATION DATE 2 yrs - February 27, 1981, or Feb. 27, 1982

LOUISVILLE AND JEFFERSON COUNTY
PLANNING COMMISSION SECRETARY: *Robert H. Zupp*
SEE BINDING ELEMENTS
78-1013
PRELIMINARY APPROVAL DEVELOPMENT PLAN
LOUISVILLE-JEFFERSON COUNTY DEPARTMENT OF TRAFFIC ENGINEERING
DATE 8-3-78 *Herman J. Blawie*
ASSISTANT DIRECTOR

RECEIVED SEP 14 1978
LOUISVILLE AND JEFFERSON COUNTY PLANNING COMMISSION
WATER MANAGEMENT ENGINEER
JEFFERSON COUNTY
PROPOSED ZONING PLAN

For ROARK MECHANICAL CONTRACTORS INC.

NOTICE
BUILDING PERMITS SHALL BE ISSUED ONLY IN CONFORMANCE WITH THE BINDING ELEMENTS OF THIS DISTRICT DEVELOPMENT PLAN

NOTE: A title examination may reveal roads and easements of record not shown herein.

- BINDING ELEMENTS**
- Screening or buffering to protect adjacent residences will be provided in the form of trees and other plantings in the north, west and south yards. A dense screening will be provided between the building and the edge of the parking lot along the north and south property lines. A detailed planting plan will be submitted for approval by the Planning Commission staff prior to construction.
 - Drainage improvements required by the Water Management Section of the Jefferson County Works Department will be provided by the developer.
 - There will be no outside storage of materials or equipment and no fabrication of materials outside of the building.
 - The plan must be reapproved by the Water Management Section of the Jefferson County Works Department and the Traffic Engineering Department before building permits are issued.
 - Unless use in accordance with the approved plan and binding elements has been substantially established within two years from the date of approval of the plan or rezoning whichever is later, the property may not be used in any manner until such time as a district development plan has been approved by the Planning Commission.

Outside storage of material and finished product in parking lot shall not exceed a height of 8 feet. No fabrication of materials shall occur outside of the building.

*See L.O.T. minutes of April 14, 1983.
Plantings along the southeasterly property line shall be a minimum of 6 feet at the time of planting.*