

Case No. 13STREETS1003

Donna Blvd Street Closure



Planning/Zoning, Land Design & Development
May 13, 2014

Case Summary / Background

- Street Closure of portions of Donna Blvd., Claire Dee Dr., Canto Ln., Vondine Dr., Aria Dr., Glenwood Cir., and Unnamed Rights-of-Way within the Renaissance South Business Park for the Louisville Renaissance Zone Corporation
 - Areawide Rezoning – Case 15567
 - Renaissance South Business Park

Location

- Louisville Renaissance Zone
- Council District 13 - Vicki Aubrey Welch

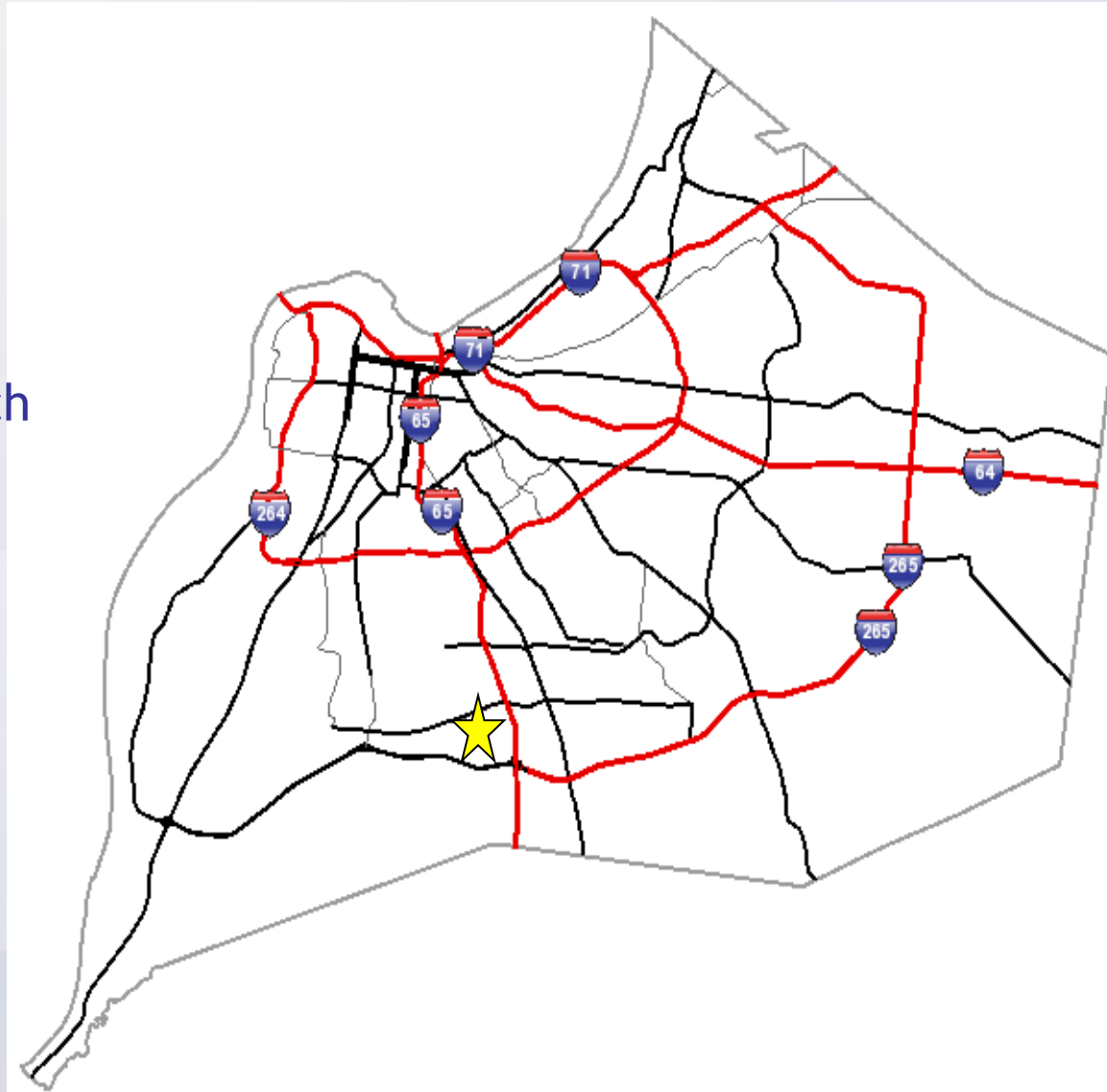

Renaissance South Business Park

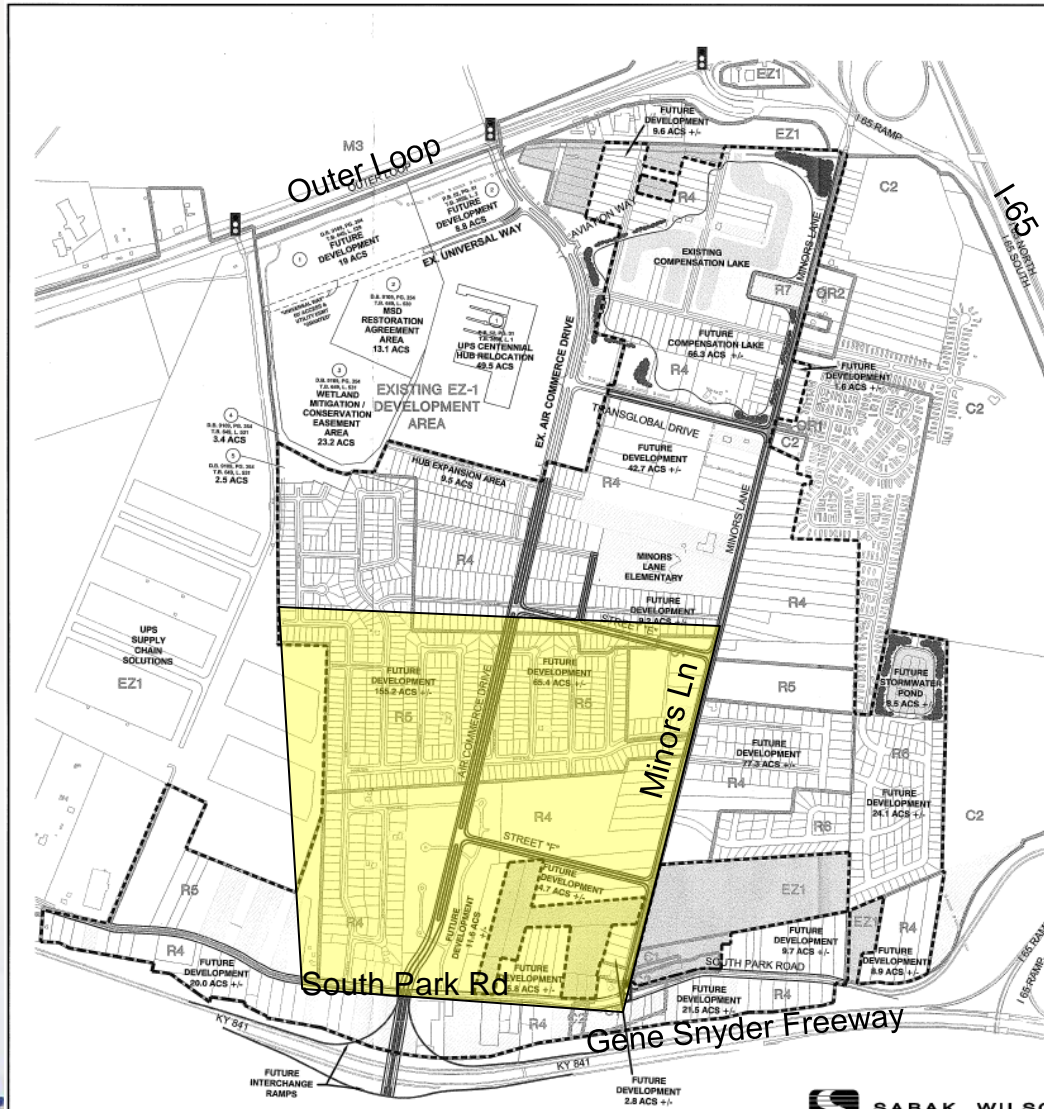

LEGEND

- AREA TO BE RE-ZONED
- MARATHON GAS PIPELINE
- ZONING DISTRICT BOUNDARIES
- NOT A PART OF AREA TO BE RE-ZONED
- PROPERTY OWNED BY UNRELATED THIRD PARTIES*

* PROPERTY OWNERSHIP IS BASED ON JANUARY 31, 2011 ACQUISITION MAP BY THE CORRADINO GROUP

LAND USE TABLE

EXISTING EZ-1 DEVELOPMENT AREA	141.7 ACRES
AREA TO BE RE-ZONED	600.8 ACRES
POTENTIAL PUBLIC RIGHTS-OF-WAY	36.8 ACRES
MINORS LANE ELEMENTARY	9.6 ACRES
POTENTIAL STORMWATER MANAGEMENT AREA	74.8 ACRES
POTENTIAL NET DEVELOPMENT AREA	479.6 ACRES

METRO
APPROVED DISTRICT
DEVELOPMENT PLAN
PROJECT NO. 1256.7
APPROVAL DATE: 2/15/11
EXPIRATION DATE:
SIGNATURE OF PLANNING COMMISSION: [Signature]
PLANNING

RECEIVED
JPN 2/22/11
PLANNING & DESIGN SERVICES



RENAISSANCE SOUTH BUSINESS PARK
Louisville Renaissance Zone Corporation
LAND USE / RE-ZONING EXHIBIT

SABAK, WILSON & LINGO, INC.
ENGINEERS, LANDSCAPE ARCHITECTS & PLANNERS
315 WEST MARKET STREET, LOUISVILLE, KENTUCKY 40202 (502) 584-8271

Scale: 1" = 400'
Date: 02/15/11
By: [Signature]

Plan: 200-3-101
Sheet: 1 of 1



Zoning/Form Districts

- **Subject Property:**
 - Existing: EZ-1 / SW
- **Adjacent Properties:**
 - North: EZ-1 / SW
 - South: EZ-1 / SW
 - East: EZ-1 / SW
 - West: EZ-1 / SW

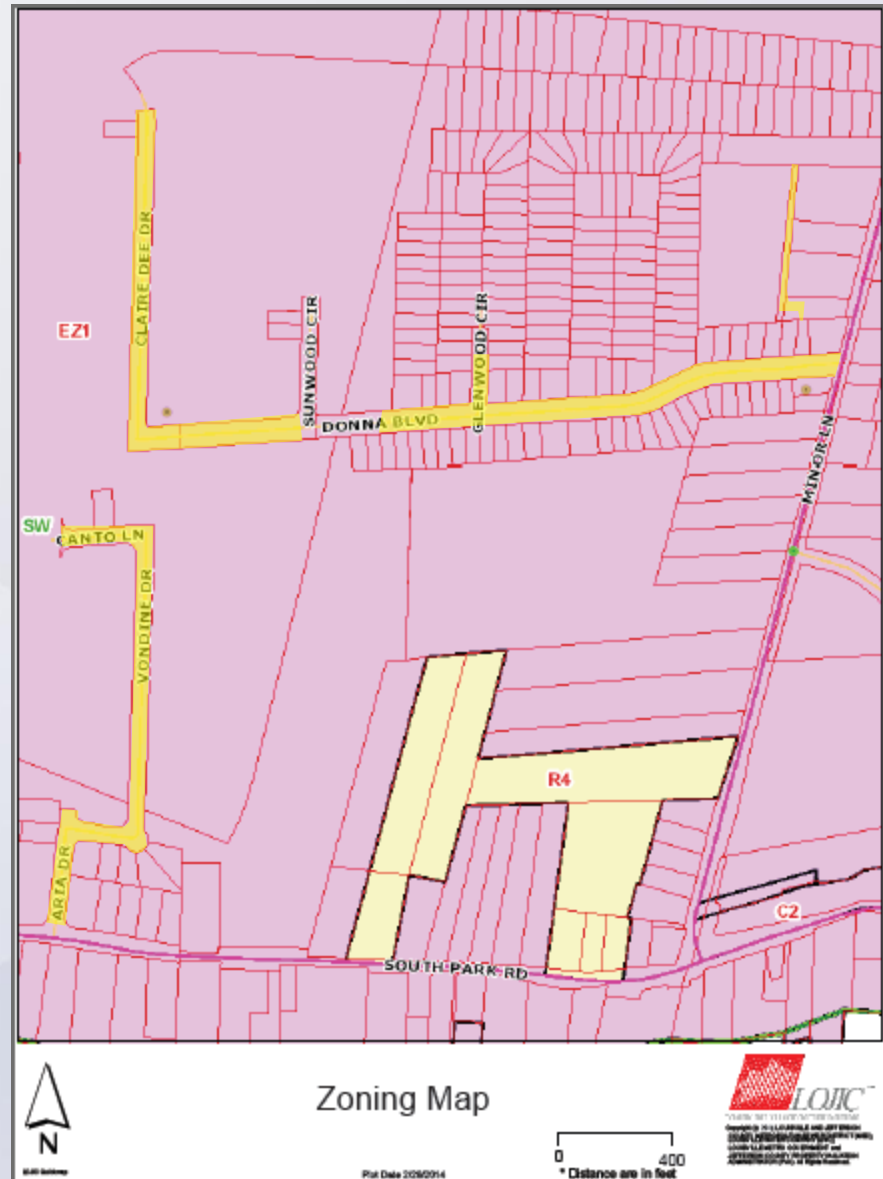

Aerial Photo/Land Use

- Subject Property:
 - Existing: Vacant
- Adjacent Properties:
 - North: Vacant
 - South: Vacant
 - East: Vacant
 - West: Vacant



Applicant's Closure Plat

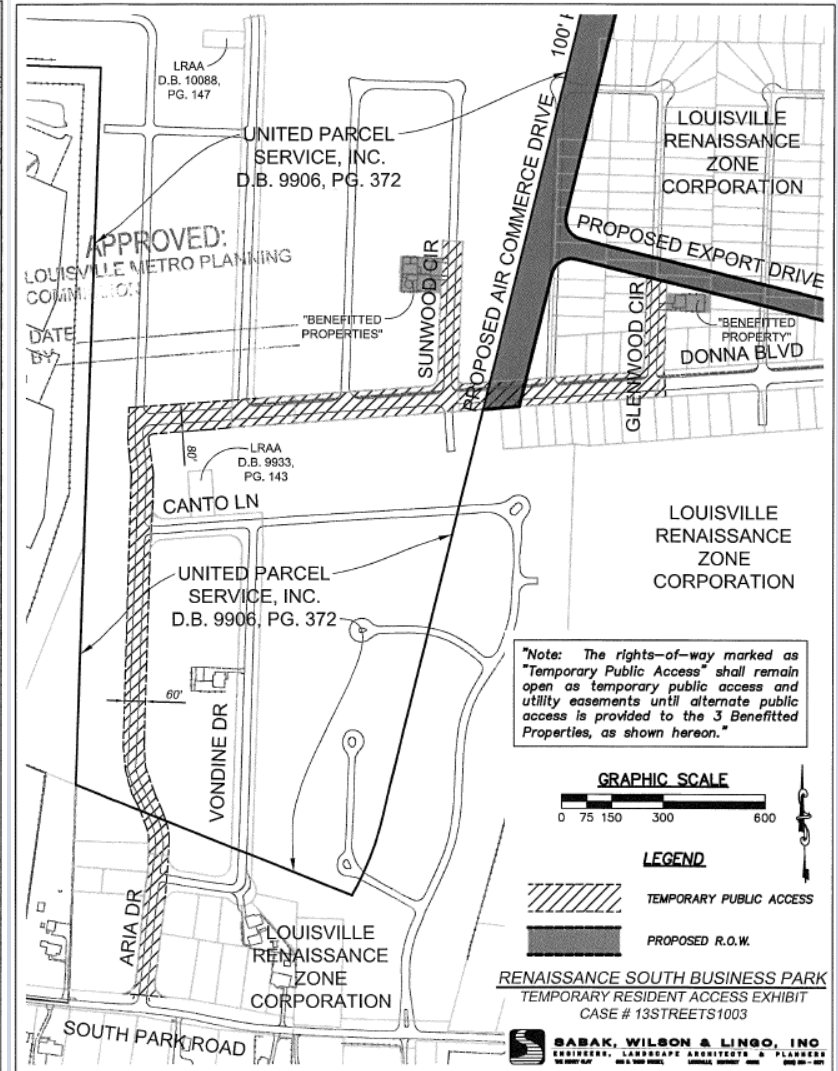
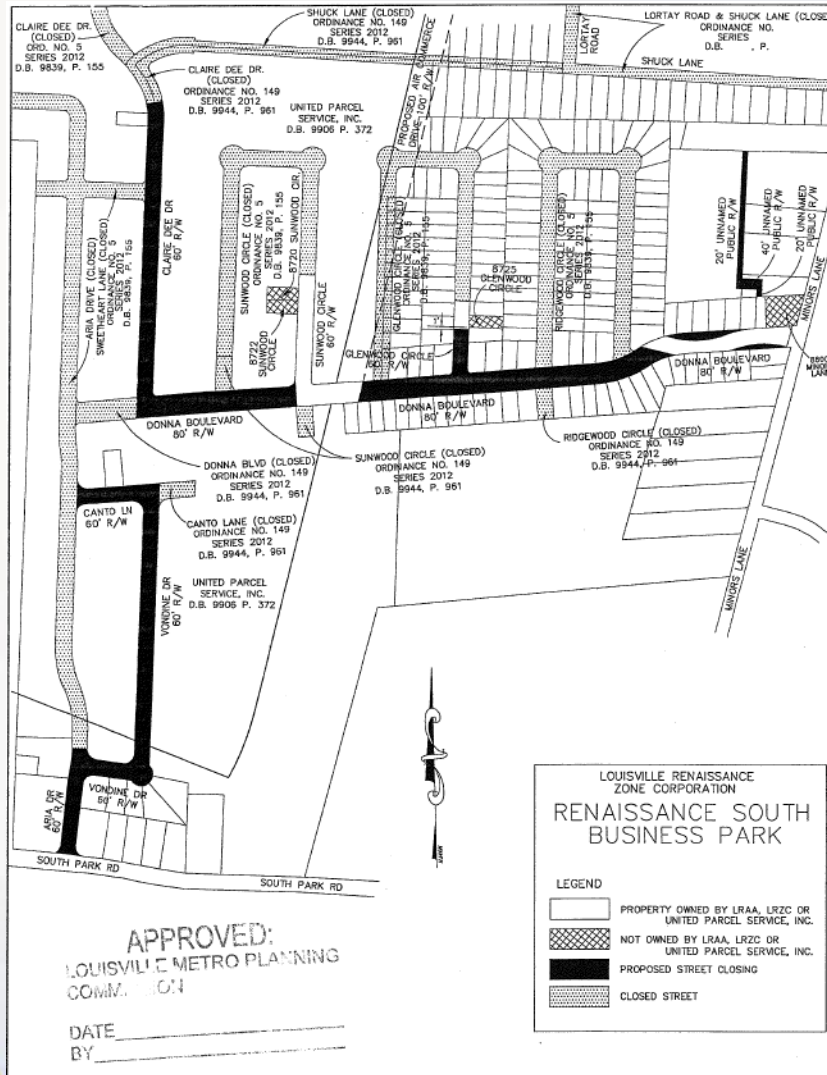

PC Recommendation

- Public Hearing was held on 4/17/14
- No one spoke in opposition at the Planning Commission public hearing.
- The Commission made sufficient findings that the proposal complies with the Comprehensive Plan-Cornerstone 2020
- The Commission unanimously recommended approval of the street closure to Louisville Metro Council (8 members voted)