

PROJECT LOCATION MAP:

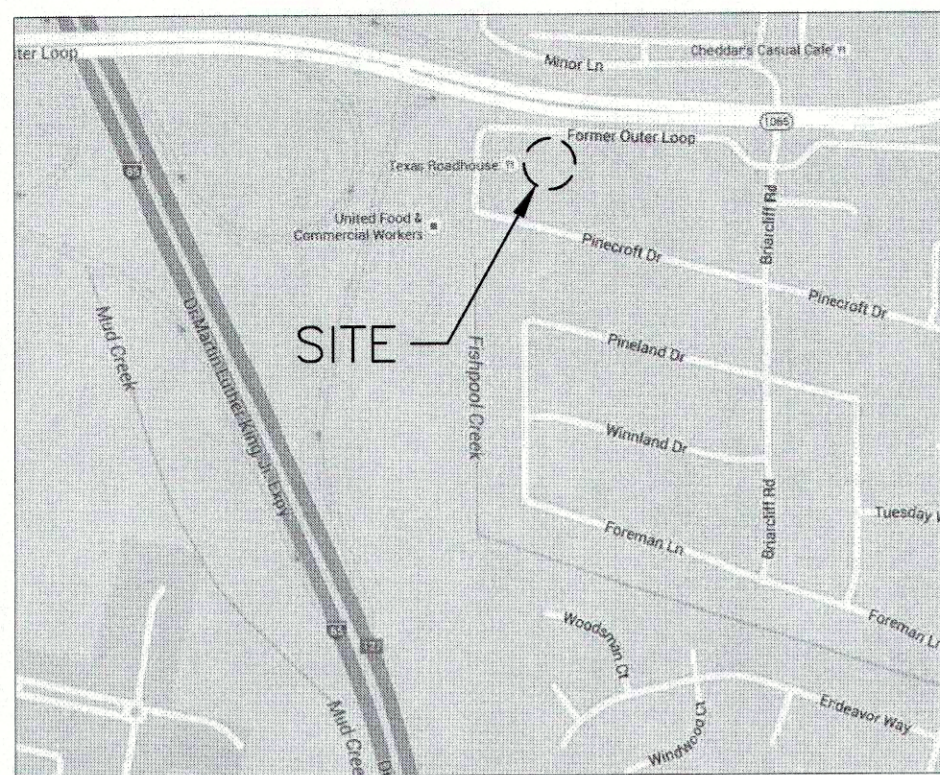

- SITE PLAN NOTES:**
1. REFER TO THE GEOTECHNICAL ENGINEERING REPORT PREPARED BY TERRACON CONSULTANTS, INC. AND DATED AUGUST 20TH, 2014 FOR ADDITIONAL INFORMATION REGARDING THE EXISTING SOIL CONDITIONS AND SUBGRADE PREPARATION REQUIREMENTS AND PROPOSED PAVEMENT RECOMMENDATIONS (TERRACON PROJECT NO. 57145048).
 2. SEE CONSTRUCTION DETAILS SHEET C7.0 FOR PAVEMENT SECTION DETAILS.
 3. SEE GENERAL NOTES SHEET C1.0 FOR EXISTING LEGEND.
 4. NO FILL IN FLOODPLAIN AS A RESULT OF THIS PROJECT.
 5. KDOV APPROVAL REQUIRED PRIOR TO MSD CONSTRUCTION PLAN APPROVAL.
 6. PROPOSED PARKING AREAS BELOW FLOODPLAIN TO HAVE SIGNS PER FLOODPLAIN ORDINANCE.
 7. BIKE PARKING WILL BE PROVIDED.
 8. SITE LIGHTING TO BE PROVIDED BY CODE.

STORMWATER SUMMARY TABLE:

TOTAL SITE AREA:	33,968 SQ. FT./0.78 ACRES
EXISTING CONDITIONS:	
EXISTING IMPERVIOUS AREA:	31,786 SQ. FT./0.73 ACRES
EXISTING PERVIOUS AREA:	2,182 SQ. FT./0.05 ACRES
33,968	
PROPOSED CONDITIONS:	
PROPOSED IMPERVIOUS AREA:	26,023 SQ. FT./0.60 ACRES
PROPOSED PERVIOUS AREA:	7,945 SQ. FT./0.18 ACRES
33,968	

OWNER/DEVELOPER:

TEXAS ROADHOUSE
CONTACT: CRAIG COTTON
TEXAS ROADHOUSE HOLDINGS, LLC
8040 DUTCHMAN'S LANE, SUITE 400
LOUISVILLE, KENTUCKY 40205

ENGINEER:

GREENBERGFARROW
CONTACT: BRIAN OLESEN, P.E.
21 S. EVERGREEN AVENUE, SUITE 200
ARLINGTON HEIGHTS, IL 60005

PRELIMINARY APPROVAL DEVELOPMENT PLAN

CONDITIONS:

BY: *[Signature]*
DATE: 1/13/16
LOUISVILLE/JEFFERSON COUNTY METRO PUBLIC WORKS

PRELIMINARY APPROVAL
Condition of Approval:

[Signature] 1/13/16
LOUISVILLE & JEFFERSON COUNTY METROPOLITAN SEWER DISTRICT

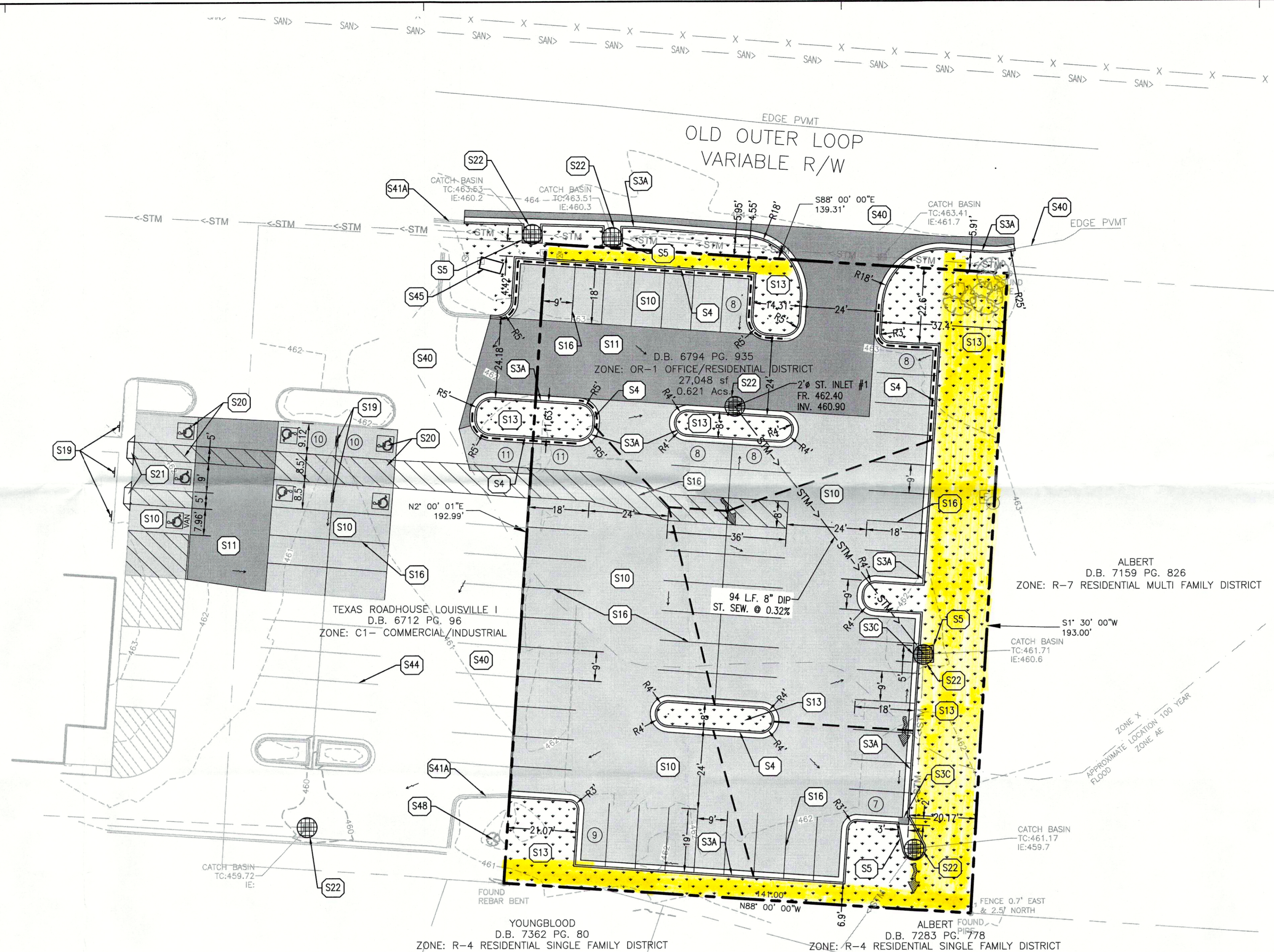

SWPPP / SESC NOTES:

1. COPIES OF THE APPROVED SOIL EROSION AND SEDIMENT CONTROL (SESC) PLANS OR STORMWATER POLLUTION PREVENTION PLANS (SWPPP) SHALL BE MAINTAINED ON THE SITE AT ALL TIMES ALONG WITH ANY NECESSARY PERMITS AND INSPECTION FORMS.
2. ALL EROSION AND SEDIMENTATION CONTROL MEASURES AND DEVICES SHALL BE INSTALLED AND FUNCTIONAL BEFORE THE SITE IS OTHERWISE DISTURBED. THEY SHALL BE KEPT OPERATIONAL AND MAINTAINED CONTINUOUSLY THROUGHOUT THE PERIOD OF LAND DISTURBANCE UNTIL PERMANENT SITE STABILIZATION HAS BEEN ACHIEVED.
3. CONTRACTOR SHALL IMPLEMENT SITE SPECIFIC BEST MANAGEMENT PRACTICES (BMPs) AS SHOWN AND REQUIRED BY THE SWPPP/SESC. ADDITIONAL BEST MANAGEMENT PRACTICES SHALL BE IMPLEMENTED BY THE CONTRACTOR AS DICTATED BY SITE CONDITIONS OR THE PROJECT GOVERNING AUTHORITIES AT NO ADDITIONAL COST TO THE OWNER THROUGHOUT ALL PHASES OF CONSTRUCTION.
4. ALL BEST MANAGEMENT PRACTICES AND CONTROLS SHALL CONFORM TO THE APPLICABLE FEDERAL, STATE, OR LOCAL REQUIREMENTS, STANDARDS, AND SPECIFICATIONS OR MANUAL OF PRACTICE.
5. IF AFTER REPEATED FAILURE ON THE PART OF THE CONTRACTOR TO PROPERLY CONTROL SOIL EROSION, SEDIMENT AND/OR POLLUTION FROM THE PROJECT SITE, THE GOVERNING AUTHORITIES RESERVE THE RIGHT TO EFFECT NECESSARY CORRECTIVE MEASURES AND CHARGE ANY COSTS TO THE CONTRACTOR.
6. INLET PROTECTION SHALL BE INSTALLED AROUND EACH INLET OR CATCH BASIN WITHIN THE VICINITY OF THE DISTURBED AREA LIMITS AS SHOWN ON THE PLANS. THESE SHALL BE MAINTAINED UNTIL THE TRIBUTARY DRAINAGE AREAS HAVE ADEQUATE GRASS COVER AND/OR APPROPRIATE GROUND STABILIZATION.
7. ALL STREETS ADJACENT TO THE PROJECT SITE SHALL BE KEPT FREE OF DIRT, MUD AND DEBRIS. CONTRACTOR SHALL CLEAN ADJACENT PAVEMENTS AT THE END OF EACH WORKING DAY WHEN NECESSARY.
8. CONTRACTORS SHALL MINIMIZE BARE EARTH SURFACES DURING CONSTRUCTION TO THE EXTENT PRACTICABLE.
9. ALL DISTURBED AREAS SHALL BE SEEDED OR SODDED AS SOON AS IS PRACTICABLE.
10. IF DURING CONSTRUCTION OPERATIONS ANY LOOSE MATERIALS ARE DEPOSITED IN THE FLOW LINE OF GUTTERS, DRAINAGE STRUCTURES, OR DITCHES SUCH THAT THE NATURAL FLOW LINE OF WATER IS OBSTRUCTED, THIS LOOSE MATERIAL SHALL BE REMOVED.
11. ALL SEDIMENT SHALL BE PREVENTED FROM ENTERING ANY EXISTING STORM DRAINAGE SYSTEMS BY THE USE OF INLET PROTECTION OR OTHER APPROVED FUNCTIONAL METHODS. THE CONTRACTOR SHALL BE RESPONSIBLE FOR REMOVING SEDIMENT RESULTING FROM CONSTRUCTION ACTIVITIES ASSOCIATED WITH THIS PROJECT.
12. CONSTRUCTION ACCESS POINTS TO THE SITE SHALL BE PROTECTED IN SUCH A WAY AS TO PREVENT TRACKING OF MUD OR SOIL ONTO PUBLIC THOROUGHFARES. ALL SEDIMENT SPILLED, DROPPED, WASHED OR TRACKED ONTO PUBLIC RIGHTS-OF-WAY MUST BE REMOVED IMMEDIATELY BY THE CONTRACTOR.
13. SUFFICIENT OIL AND GREASE ABSORBING MATERIALS AND FLotation BOOMS SHALL BE MAINTAINED ON SITE OR READILY AVAILABLE TO CLEAN-UP FUEL OR CHEMICAL SPILLS AND LEAKS.
14. MITIGATION MEASURES FOR DUST CONTROL SHALL BE IN PLACE DURING CONSTRUCTION TO PREVENT FUGITIVE PARTICULATE EMISSIONS FROM REACHING EXISTING ROADS AND NEIGHBORING PROPERTIES.
15. RUBBISH, TRASH, GARBAGE, LITTER, OR OTHER SUCH MATERIALS SHALL BE DEPOSITED INTO SEALED TRASH CONTAINERS. MATERIALS SHALL BE PREVENTED FROM LEAVING THE PREMISES THROUGH THE ACTION OF WIND OR STORMWATER DISCHARGE INTO DRAINAGE DITCHES OR WATERS OF THE STATE.
16. DURING DEWATERING OPERATIONS, WATER SHALL BE PUMPED OR OTHERWISE DISCHARGED FROM THE SITE INTO SEDIMENT BASINS, SILT TRAPS, DEWATERING BAGS OR POLYMER MIXING SWALES. DEWATERING DIRECTLY INTO FIELD TILES OR STORMWATER SYSTEMS IS PROHIBITED.
17. ALL DISTURBED AREAS SHALL BE SEEDED OR SODDED WITHIN THREE (3) DAYS OF FINAL DISTURBANCE.
18. ALL SOIL STOCKPILES SHALL BE STABILIZED WITHIN THREE (3) DAYS OF FORMING THE STOCKPILE.
19. STABILIZATION MEASURES SHALL BE INITIATED AS SOON AS PRACTICABLE IN PORTIONS OF THE SITE WHERE CONSTRUCTION ACTIVITIES HAVE TEMPORARILY OR PERMANENTLY CEASED, BUT IN NO CASE MORE THAN SEVEN (7) DAYS AFTER THE CONSTRUCTION ACTIVITY IN THAT PORTION OF THE SITE HAS TEMPORARILY OR PERMANENTLY CEASED AS FOLLOWS:
 - 19.1. WHEN THE INITIATION OF STABILIZATION MEASURES BY THE 7TH DAY AFTER CONSTRUCTION ACTIVITY TEMPORARILY OR PERMANENTLY CEASES IS PRECLUDED BY SNOW COVER, STABILIZATION MEASURES SHALL BE INITIATED AS SOON AS PRACTICABLE.
 - 19.2. WHEN CONSTRUCTION ACTIVITY WILL RESUME ON A PORTION OF THE SITE WITHIN 14 DAYS FROM WHEN ACTIVITIES CEASED (I.E. THE TOTAL TIME PERIOD THAT CONSTRUCTION ACTIVITY IS TEMPORARILY CEASED IS LESS THAN 14 DAYS), THEN STABILIZATION MEASURES DO NOT HAVE TO BE INITIATED ON THAT PORTION OF THE SITE BY THE 7TH DAY AFTER CONSTRUCTION ACTIVITY TEMPORARILY CEASES.
20. PRE-QUALIFIED PERSONNEL (PROVIDED BY THE CONTRACTOR) SHALL INSPECT DISTURBED AREAS OF THE CONSTRUCTION SITE THAT HAVE NOT BEEN FINALLY STABILIZED, STRUCTURAL CONTROL MEASURES, AND LOCATIONS WHERE VEHICLES ENTER OR EXIT THE SITE AT LEAST ONCE EVERY SEVEN (7) CALENDAR DAYS AND WITHIN TWENTY-FOUR (24) HOURS OF THE END OF A RAINFALL EVENT THAT IS 0.5 INCH OR GREATER (OR EQUIVALENT SNOWFALL). REQUIRED REPAIRS SHOULD BE COMPLETED WITHIN FORTY-EIGHT (48) HOURS OF THE INSPECTION.
21. EROSION CONTROL BLANKETS SHALL BE USED IN AREAS OF 4:1 SLOPE OR STEEPER.
22. ALL TEMPORARY EROSION CONTROL AND SEDIMENT CONTROL MEASURES SHALL BE REMOVED THIRTY (30) DAYS AFTER FINAL SITE STABILIZATION IS ACHIEVED OR AFTER THE TEMPORARY MEASURES ARE NO LONGER NEEDED. TRAPPED SEDIMENT SHALL BE PROPERLY STABILIZED OR DISPOSED OF OFF SITE BY THE CONTRACTOR. PRIOR TO COMMENCING LAND DISTURBING ACTIVITIES IN AREAS OTHER THAN THOSE INDICATED ON THESE PLANS (INCLUDING BUT NOT LIMITED TO ADDITIONAL PHASES OF DEVELOPMENT AND OFF-SITE BORROW OR WASTE AREAS) A SUPPLEMENTARY STORM WATER POLLUTION PREVENTION PLAN SHALL BE SUBMITTED TO THE OWNER AND ENGINEER FOR REVIEW.
23. ALL CONSTRUCTION VEHICLE TRAFFIC MUST REMAIN WITHIN THE LIMITS OF CONSTRUCTION.

TREE CANOPY CALCULATIONS:

GROSS SITE AREA: 28,822 SF
CANOPY COVERAGE CLASS: CLASS C (20%)
TREE CANOPY REQUIRED: 20%
TREE CANOPY PLANTED: 10,944 SF (37%)

LANDSCAPE DATA:

BUFFER YARD: AREA TYPE C
SOUTH BUFFER TREES REQUIRED: 4 TREES
SOUTH BUFFER TREES PROVIDED: 4 TREES AND 8' TALL CONTINUOUS HEDGE
EAST BUFFER TREES REQUIRED: 6 TREES
EAST BUFFER TREES PROVIDED: 6 TREES AND 8' TALL CONTINUOUS HEDGE

VEHICULAR USE BUFFER YARD REQUIRED: 3' HEDGE ROW
VEHICULAR USE BUFFER YARD PROVIDED: 3' HEDGE ROW
VEHICULAR USE AREA INTERIOR LANDSCAPE TREES REQUIRED: 5 TREES
VEHICULAR USE AREA INTERIOR LANDSCAPE TREES PROVIDED: 5 TREES
VEHICULAR USE AREA INTERIOR LANDSCAPE TREES REQUIRED: 1,635 SF
VEHICULAR USE AREA INTERIOR LANDSCAPE TREES PROVIDED: 2,382 SF

WAVEN TO REDUCE THE REQUIRED LBA ALONG THE SOUTH PROPERTY LINE FROM 25 FEET TO 6.9 FEET
WAVEN TO REDUCE THE REQUIRED LBA ALONG THE EAST PROPERTY LINE FROM 25 FEET TO 20 FEET
WAVEN TO REDUCE THE REQUIRED LBA ALONG THE NORTH PROPERTY LINE FROM 10 FEET TO 4.4 FEET

PROPOSED LEGEND:

- PROPERTY LINE
- ===== PROPOSED CONCRETE CURB AND GUTTER
- PROPOSED REVERSE PITCH CURB AND GUTTER
- ===== PROPOSED DEPRESSED CURB AND GUTTER
- ⑦ PROPOSED PARKING STALL COUNT
- ☐☐☐ PROPOSED LIGHT POLE
- ☐ PROPOSED SIGN
- ☉ PROPOSED STORM SEWER STRUCTURES
- STM --- PROPOSED STORM SEWER
- PROPOSED GRADING RIDGE LINE
- PROPOSED DRAINAGE FLOW DIRECTION
- PROPOSED OVERLAND FLOOD ROUTE
- ☉ PROPOSED INLET PROTECTION INSERT

NOTE: SEE SHEET C1.0 FOR EXISTING LEGEND

SITE KEY NOTES:

- S3A PROPOSED CONCRETE CURB AND GUTTER
- S3C PROPOSED DEPRESSED CONCRETE CURB AND GUTTER
- S4 PROPOSED REVERSE PITCH CONCRETE CURB AND GUTTER
- S5 EXTEND CONCRETE CURB AND GUTTER AROUND EXISTING STORM STRUCTURES
- S10 PROPOSED ASPHALT PAVEMENT
- S11 PROPOSED HEAVY DUTY ASPHALT PAVEMENT
- S13 PROPOSED LANDSCAPE AREA (SEE LANDSCAPE PLANS FOR ADDITIONAL INFORMATION AND DETAILS)
- S16 PROPOSED 4" PAVEMENT STRIPING PER LOCAL CODE
- S19 PROPOSED HANDICAP ACCESSIBLE PARKING SIGN PER LOCAL CODE (TYP. OF 6)
- S20 PROPOSED HANDICAP ACCESSIBLE PARKING STALL STRIPING AND SYMBOL PER LOCAL CODE (TYP.)
- S21 PROPOSED HANDICAP ACCESSIBLE CURB RAMP AT 12:1 MAXIMUM SLOPE PER LOCAL CODES
- S22 PROPOSED INLET PROTECTION
- S40 EXISTING ASPHALT PAVEMENT TO REMAIN
- S41A EXISTING CONCRETE CURB AND GUTTER TO REMAIN
- S44 EXISTING PAVEMENT STRIPING TO REMAIN
- S45 EXISTING CONCRETE PAVEMENT TO REMAIN
- S48 EXISTING TREE TO REMAIN AND BE PROTECTED

PAVEMENT HATCH LEGEND:

- S10 PROPOSED ASPHALT PAVEMENT
1-1/2" HMA SURFACE COURSE
2" HMA BASE COURSE
8" DENSE GRADED AGGREGATE BASE COURSE
- S11 PROPOSED HEAVY DUTY ASPHALT PAVEMENT
1-1/2" HMA SURFACE COURSE
2-1/2" HMA BASE COURSE
8" DENSE GRADED AGGREGATE BASE COURSE
- S13 PROPOSED LANDSCAPE AREA
(SEE LANDSCAPE PLANS FOR ADDITIONAL INFORMATION AND DETAILS)

PROJECT INFORMATION:

EXISTING TEXAS ROADHOUSE SITE AREA:	±0.62 ACRES
REQUIRED MINIMUM PARKING:	63 STALLS
REQUIRED MAXIMUM PARKING:	155 STALLS
EXISTING ON-SITE PARKING:	93 STALLS
	(INCLUDING 4 ADA STALLS)
ADDITIONAL PARKING PROVIDED:	58 STALLS (NET)
TOTAL PARKING PROVIDED:	151 STALLS
	(INCLUDING 7 ADA STALLS)

RECEIVED
DEC 24 2015
PLANNING & DESIGN SERVICES

GRAPHIC SCALE
1 inch = 20 ft

GreenbergFarrow
1430 W. Peachtree St. NW
Suite 200
Atlanta, GA 30309
T: 404 601 4000 F: 404 601 3970

PROJECT TEAM

ISSUE/REVISION RECORD

DATE	DESCRIPTION
10-16-15	PRE-APPLICATION PERMIT
12-23-15	CONDITIONAL USE PLAN

PROFESSIONAL IN CHARGE
JOHN NOURZAD
PROFESSIONAL ENGINEER
LICENSE NO. 23783

PROJECT MANAGER
BRIAN OLESEN

QUALITY CONTROL
LARRY DIEHL

DRAWN BY
MITCH HEFFERNAN

PROJECT NAME
TEXAS ROADHOUSE

LOUISVILLE KENTUCKY
SEQ FORMER OUTER LOOP ROAD AND BRIARCLIFF ROAD

PROJECT NUMBER
201507060

SHEET TITLE
CONDITIONAL USE SITE PLAN

SHEET NUMBER
C1.0

MSD WM NO. 5074