

BASIS OF BEARINGS  
MAGNETIC READING  
CENTERLINE OF GARFIELD  
TAKEN 11/30/18

RIGHT-OF-WAY LINE

CURB

CURB

CENTERLINE

30' PVMT. WIDTH

CURB

CURB

# GARFIELD AVE.

60' RIGHT-OF-WAY WIDTH

OVERHEAD ELECTRIC

6' WIDE CONC. SIDEWALK

N81°31'16"W 217.00' TO EAST  
R/W LINE OF N. 30th STREET

S81°31'16"E 162.00' TO WEST  
R/W LINE OF N. 29th STREET

RIGHT-OF-WAY LINE

2916

2914

2910

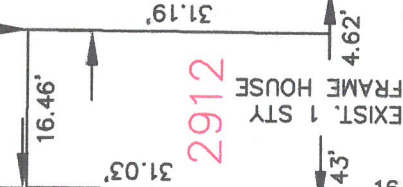

THOMAS C. WEST, JR  
D.B. 6282, PG. 181  
PARCEL ID: 003A00620000

SUSAN K. GRUBE  
D.B. 8031, PG. 949  
PARCEL ID: 003A00640000

SITE PLAN  
12/10/2018

VARIANCE FOR SIDE YARD SETBACK  
REQUIRED: \_\_\_\_\_  
REQUESTING: \_\_\_\_\_

SITE ADDRESS:  
2912 GARFIELD AVE.  
LOUISVILLE, KY 40212  
PARCEL ID: 003A00630000  
KEITH NELSON  
DEED BOOK 10823 PAGE 243



SCALE: 1"=20 FEET

TRADITIONAL NEIGHBORHOOD FORM DISTRICT  
URBAN/PLANNED AREA URBAN

JAN 22 2019

N81°31'16"W 25.00'

10'

20" WIDE ALLEY

CENTERLINE

DESIGN SERVICES

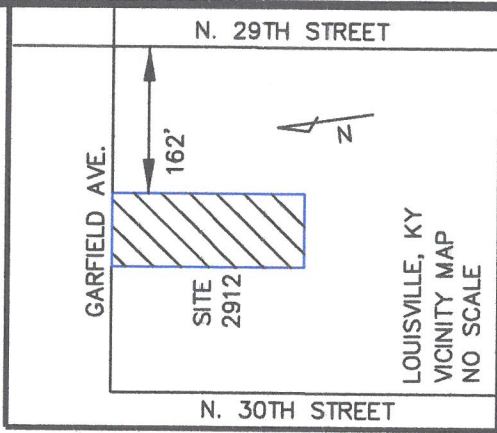

LOUISVILLE, KY