

**The Order of Promise, LLC**  
**Site Address: 3502 Garland Ave Louisville, KY 40211**  
**Zoning: R-5 Single Family Residential**  
**Scale: 1 inch=20 feet**

Original Submission Date: April 4, 2016

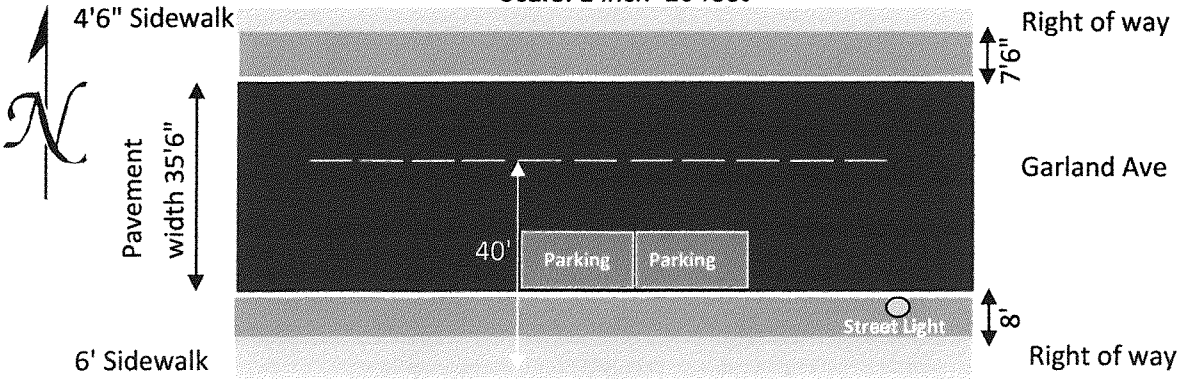
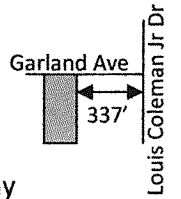

.1722 Acres  
 1732 sq ft home  
**Bldg Height: 19'6"**  
 2 story brick and wood structure  
**No site work being done**  
**No additional landscaping**  
**No lights will be added**

3504 Garland Ave  
 Carl Williams  
 DB/pg 10011 0958  
 R-5 TN

3500 Garland Ave  
 Crystal Carter  
 DB/pg 8884 0365  
 R-5 TN

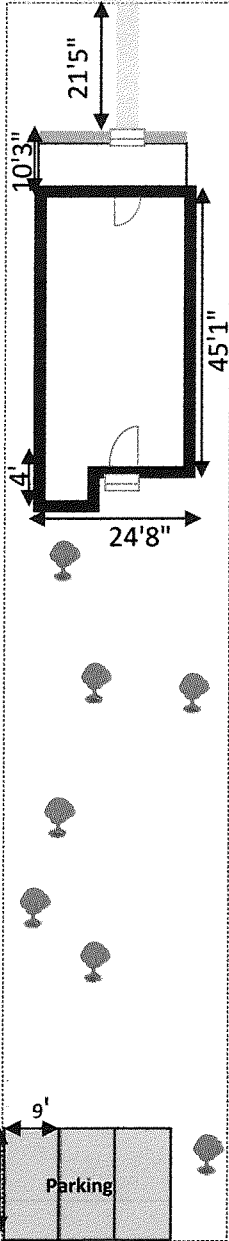

**PRELIMINARY APPROVAL DEVELOPMENT PLAN**  
 CONDITIONS:  
 BY: *Jimmy Mackley*  
 DATE: *6-1-16*  
 LOUISVILLE/JEFFERSON COUNTY METRO PUBLIC WORKS

**RECEIVED**  
 MAY 16 2016  
 PLANNING & DESIGN SERVICES

**PRELIMINARY APPROVAL**  
 Condition of Approval:  
 Surface material is turf and dirt  
 Date: *6/1/16*  
 Development Review  
 LOUISVILLE & JEFFERSON COUNTY METROPOLITAN SEWER DISTRICT

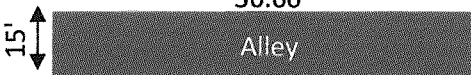

3501 W. Kentucky St  
 Phyllis Anderson  
 DB/pg 10132 0667  
 R-5 TN

3425 W. Kentucky St  
 Mirage Properties, LLC  
 DB/pg 9940 0405  
 R-5 TN