

**EZ-1 SW**  
 T.B. 649, LOT 529  
 LOUISVILLE RENAISSANCE ZONE CORP.  
 P.O. BOX 9129  
 LOUISVILLE, KY 40209  
 D.B. 9109, PG. 352

**EZ-1 SW**  
 T.B. 3898, LOT 1  
 BT, OH, LLC.  
 55 GLENLAKE PARKWAY NE  
 ATLANTA, GA 30328  
 D.B. 9166, PG. 594

**EZ-1 SW**  
 T.B. 649, LOT 529  
 LOUISVILLE RENAISSANCE ZONE CORP.  
 P.O. BOX 9129  
 LOUISVILLE, KY 40209  
 D.B. 9109, PG. 352

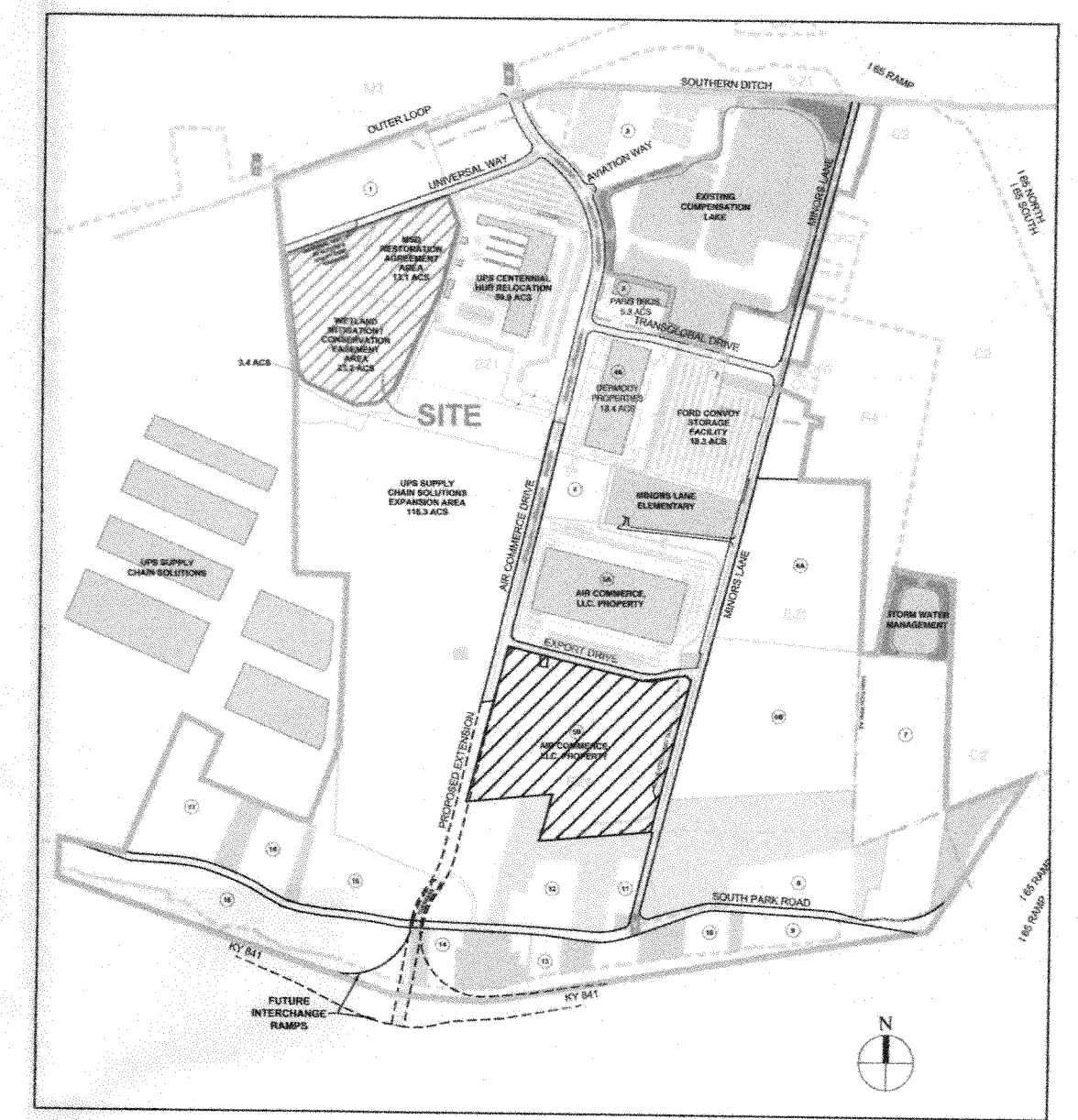

LOCATION MAP

**SITE DATA**

EXISTING ZONING:	EZ-1
FORM DISTRICT:	SUBURBAN WORKPLACE
EXISTING USE:	CONSERVATION/RESTORATION
PROPOSED USE:	CONSERVATION/RESTORATION
GROSS SITE AREA:	36.279 AC
CONSERVATION EASEMENT AREA:	23.178 AC
RESTORATION AGREEMENT AREA:	13.101 AC

**TREE CANOPY CALCULATIONS**

EXISTING TREE CANOPY	757,944 SF
TREE CANOPY USED	603,560 SF
(56,603 SF AT CONVOY LOT - 13LSCAPE1020)	
(16,742 SF AT TRACT 3 - 13LSCAPE1025)	
(32,619 SF AT TRACT 4 - 14LSCAPE1036)	
(89,307 SF AT TRACT 5A - 14LSCAPE1183)	
(269,368 SF AT TRACT 6 - NORTHPOINT)	
(138,921 SF AT TRACT 5B - VERUS SOUTH)	
AVAILABLE TREE CANOPY REMAINING	154,384 SF

**NOTES:**

- QUANTITIES FOR TREES PRESERVED AND PLANTED WERE TAKEN DIRECTLY FROM THE APPLICATION FOR SECTION 404 INDIVIDUAL PERMIT AND SECTION 401 WATER QUALITY CERTIFICATION PROVIDED TO THE U.S.A.C.O.E. & THE KENTUCKY DIVISION OF WATER IN AUGUST OF 2006.
- EXACT AMOUNT OF BORROWED TREE CANOPY MAY FLUCTUATE BETWEEN THE PRELIMINARY PLAN AND CONSTRUCTION PLANS. EXACT NUMBERS TO BE DETERMINED AT THE TIME OF LANDSCAPE PLAN APPROVAL.

**LEGEND**

	Ex. Sanitary Sewer W/ Manhole
	Ex. Major Contour
	Ex. Minor Contour
	Conservation Easement Area
	Restoration Agreement Area
	Existing Trees

**RECEIVED**  
 JUN 29 2015  
 LANDSCAPE &  
 DESIGN SERVICES

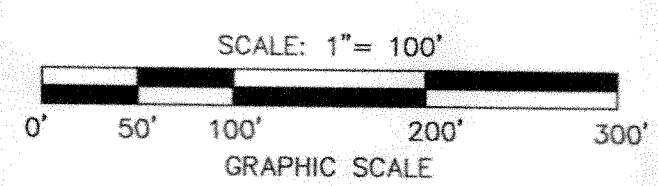

**SABAK, WILSON & LINGO, INC**  
 ENGINEERS, LANDSCAPE ARCHITECTS & PLANNERS  
 LOUISVILLE, KENTUCKY 40202 (502) 984-6271  
 THE HENRY CLAY 608 S. THIRD STREET,

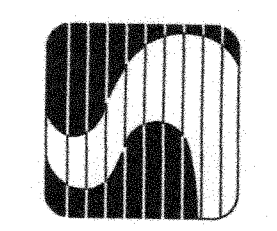

NO.	REVISION	DATE

SHEET TITLE: ALTERNATIVE COMPLIANCE LANDSCAPE PLAN  
 PROJECT TITLE: CONSERVATION EASEMENT & RESTORATION AGREEMENT AREA RENAISSANCE SOUTH BUSINESS PARK

JOB NO. 2504-VER  
 SCALE: 1" = 100'  
 DATE: 06/29/15  
 DRAWING NO.: **LAND**  
 SHEET 1 OF 1

K:\JOBS\DDP\2504-VERUS-SOUTH-CAT3.dwg, CONSERVATION AREA, 6/29/2015 11:34:53 AM, HP Designnet T920