

18VARIANCE1028

842 Franklin Street Addition



**Louisville Metro Board of Zoning Adjustment
Public Hearing**

Dante St. Germain, Planner I

April 30, 2018

Requests

- **Variance:** from Land Development Code section 5.4.1.D.2 to allow a private yard area to be less than the required 30% of the area of a lot.

Location	Requirement	Request	Variance
Private Yard Area	30% (2,934.2 sf)	4.2% (408 sf)	25.8% (2,526.2 sf)

Case Summary / Background

- The subject property is located in the Butchertown neighborhood.
- The applicant proposes to construct a new two-story addition on the rear of the principal structure, decreasing the existing private yard area located between the principal structure and the garage.
- The detached garage is situated far off the alley, with the front approximately 73 feet from the alley, making the private yard area small.

Case Summary / Background

- A Certificate of Appropriateness for the addition was granted by Historic Landmarks and Preservation Districts Commission staff on March 23, 2018, under case number 18COA1042.

Zoning/Form Districts

Subject Property:

- Existing: R-6/Traditional Neighborhood

Adjacent Properties:

- North: R-6/Traditional Neighborhood
- South: R-6/Traditional Neighborhood
- East: R-6/Traditional Neighborhood
- West: R-6/Traditional Neighborhood

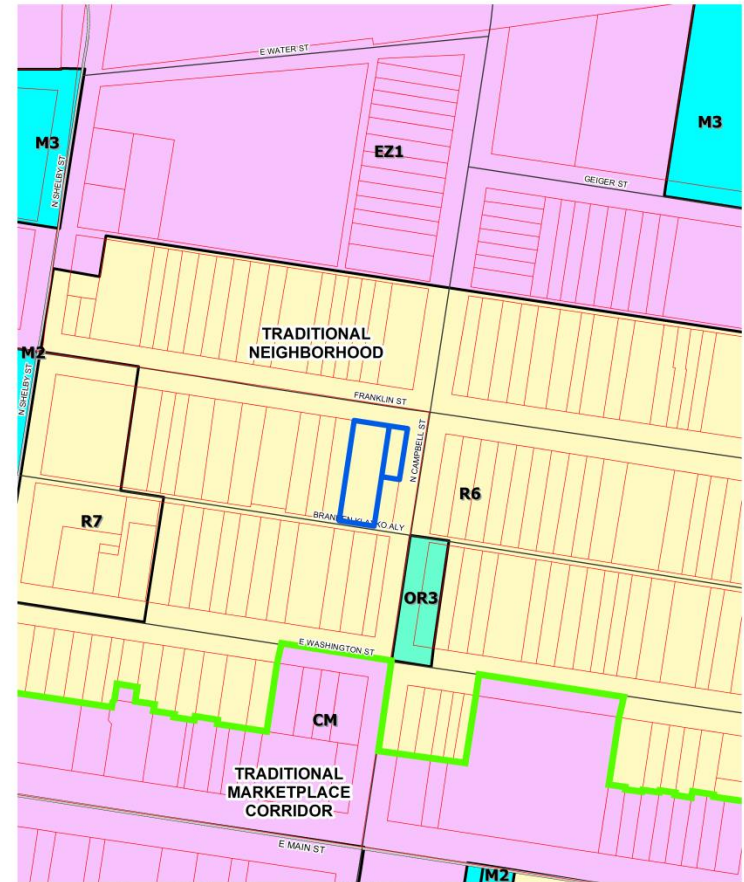

842 Franklin Street
feet



Map Created: 4/16/2018



Copyright (c) 2018, LOUISVILLE AND JEFFERSON COUNTY METROPOLITAN SEWER DISTRICT (MSD), LOUISVILLE WATER COMPANY (LWC), LOUISVILLE METRO GOVERNMENT and JEFFERSON COUNTY PROPERTY VALUATION ADMINISTRATOR (PVA). All Rights Reserved.

Aerial Photo/Land Use

Subject Property:

- Existing: Single Family Residential

Adjacent Properties:

- North: Single Family Residential & Multi Family Residential
- South: Single Family Residential & Multi Family Residential
- East: Multi Family Residential
- West: Single Family Residential



842 Franklin Street
feet

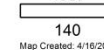

Map Created: 4/16/2018



Copyright (c) 2018, LOUISVILLE AND JEFFERSON COUNTY METROPOLITAN SEWER DISTRICT (MSD), LOUISVILLE WATER COMPANY (LWC), LOUISVILLE METRO GOVERNMENT and JEFFERSON COUNTY PROPERTY VALUATION ADMINISTRATOR (PVA). All Rights Reserved.

Site Photos-Subject Property



The front of the subject property.

Site Photos-Subject Property



The properties across Franklin Street.

Site Photos-Subject Property



The property to the left of the subject property across N Campbell Street.

Site Photos-Subject Property



The existing private yard area to be reduced.

Site Plan



LESAK RES.
842 Franklin
Louisville, KY 40202

DISCLAIMERS AND NON-DISCLOSURES:
The information, data, and drawings included in this document are for informational purposes only and are supplied with the understanding that they will not be used, copied, or reproduced in any form without the prior written consent of the design professional, L.L.C. All information, illustrations, screen captures, and other content contained herein are the property of Eldridge Company, L.L.C. All Rights Reserved.

DESIGNED AND
BUILT BY:



1437 Bury Ave
Louisville, KY 40206
502.625.5885

18 VARIANCE 1028

RECEIVED
MAR 23 2018
PLANNING &
DESIGN SERVICES

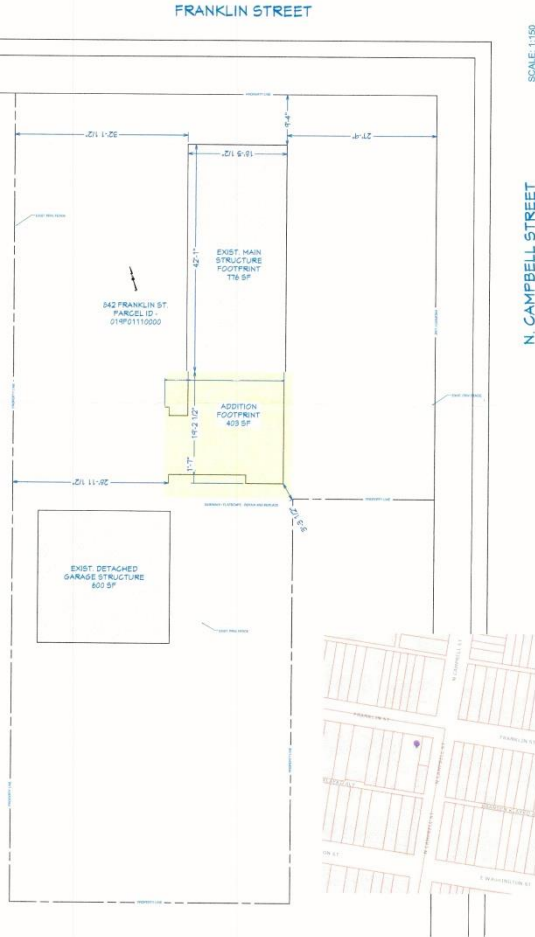

Elevations



LESAK RES.
842 Franklin
Louisville, KY 40202

DISCLAIMERS AND NON- DISCLOSURES:

The information, data, and drawings embodied in this document are for presentation purposes only and are supplied with the understanding that they will not be used, altered or built by third parties without the prior written consent of Eldridge Company, LLC. All information, illustrations, screen shots, and data contained herein copyright © 2017 Eldridge Company, LLC. All Rights Reserved.

DESIGNED AND BUILT BY:



1437 Story Ave
Louisville, KY 40206
502.625.5565

18 VARIANCE 1028

Conclusions

- The variance request appears to be adequately justified and meets the standard of review.
- Must determine if the proposal meets the standard of review for granting a variance as established in the Land Development Code, from section 5.4.1.D.2 to allow a private yard area to be less than the required 30% of the area of a lot.

Required Actions

- **Variance:** from Land Development Code section 5.4.1.D.2 to allow a private yard area to be less than the required 30% of the area of a lot. Approve/Deny

Location	Requirement	Request	Variance
Private Yard Area	30% (2,934.2 sf)	4.2% (408 sf)	25.8% (2,526.2 sf)