

**19-CUP-0115**  
**4212 Roosevelt Avenue**



**Louisville Metro Board of Zoning Adjustment**  
**Public Hearing**

**Jon E. Crumbie, Planning & Design Coordinator**  
**October 21, 2019**

# Request(s)

- Conditional Use Permit to allow short term rental of a dwelling unit that is not the primary residence of the host.

# Case Summary/Background

- The applicant requests approval to conduct short term rentals at the subject property. The subject property is developed with one structure. The applicant states that the residence has three bedrooms that will allow a maximum number of eight guests. The site has credit for one on-street parking space and the applicant states that there are three parking spaces.

# Site Location

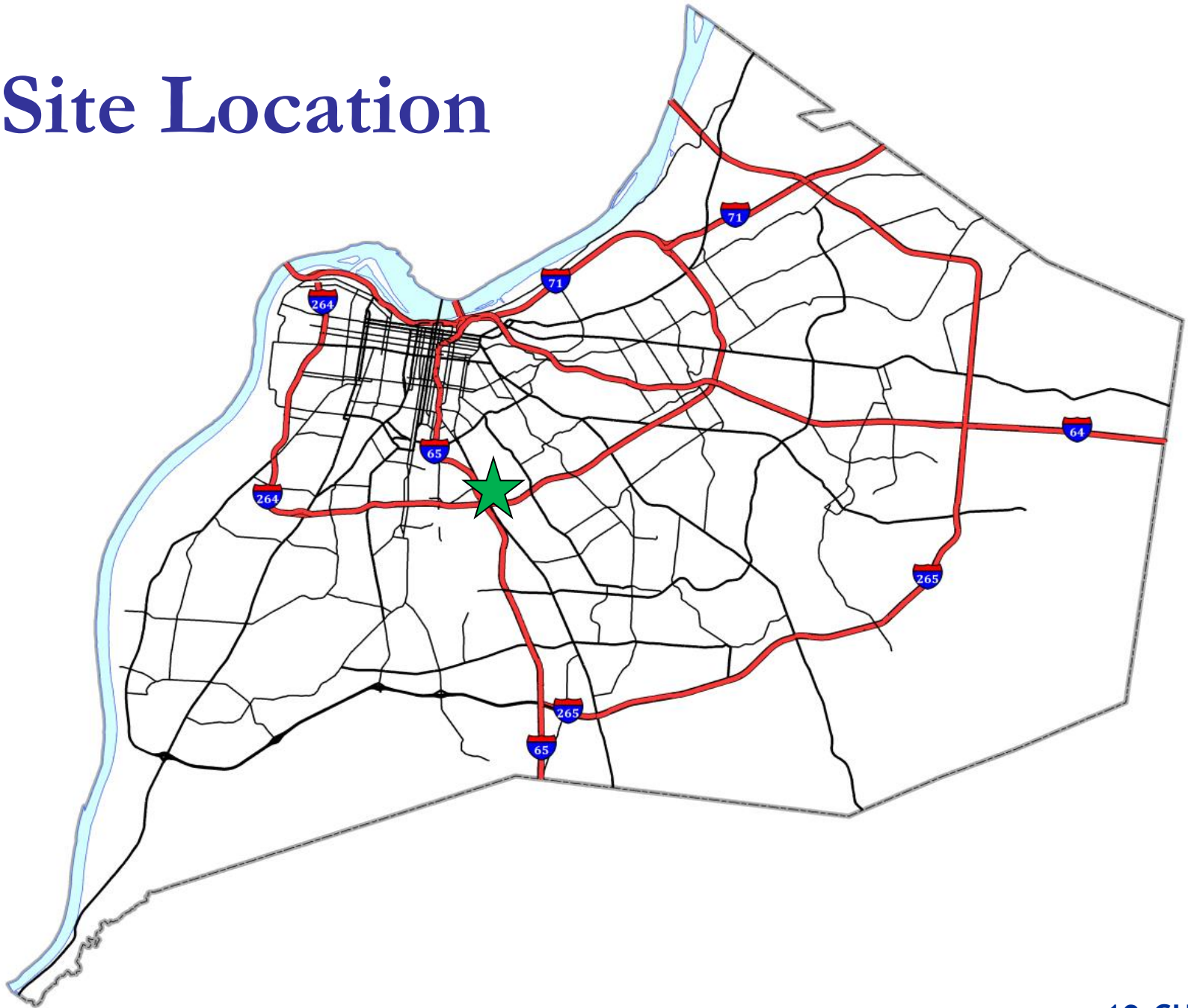

# Zoning/Form Districts

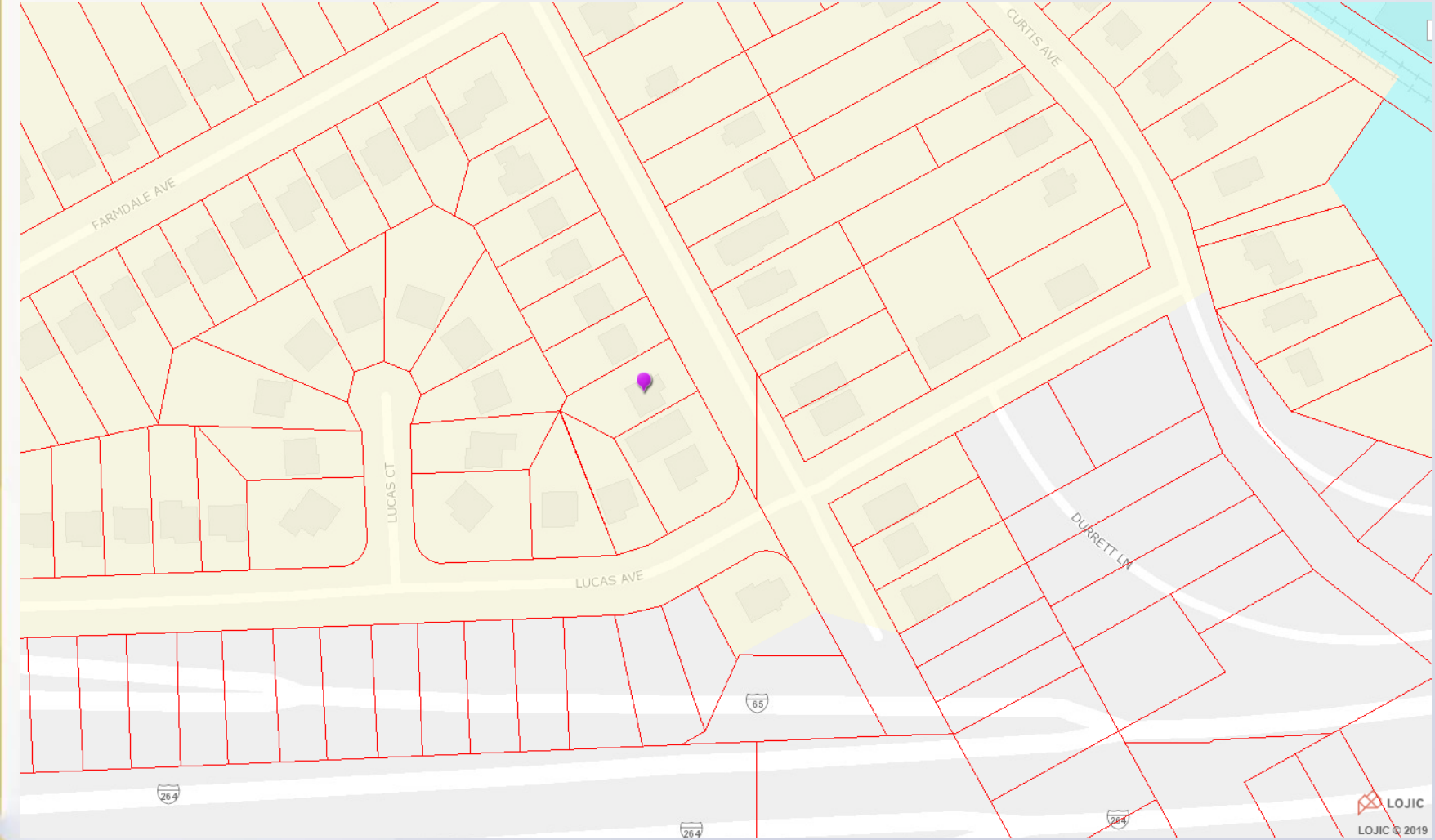

LOJIC  
LOJIC © 2019

# Aerial Photo/Land Use





# Short Term Rentals Within 600 Feet

0 Approved Short Term Rentals Within 600'

Map Created: 10/14/2019

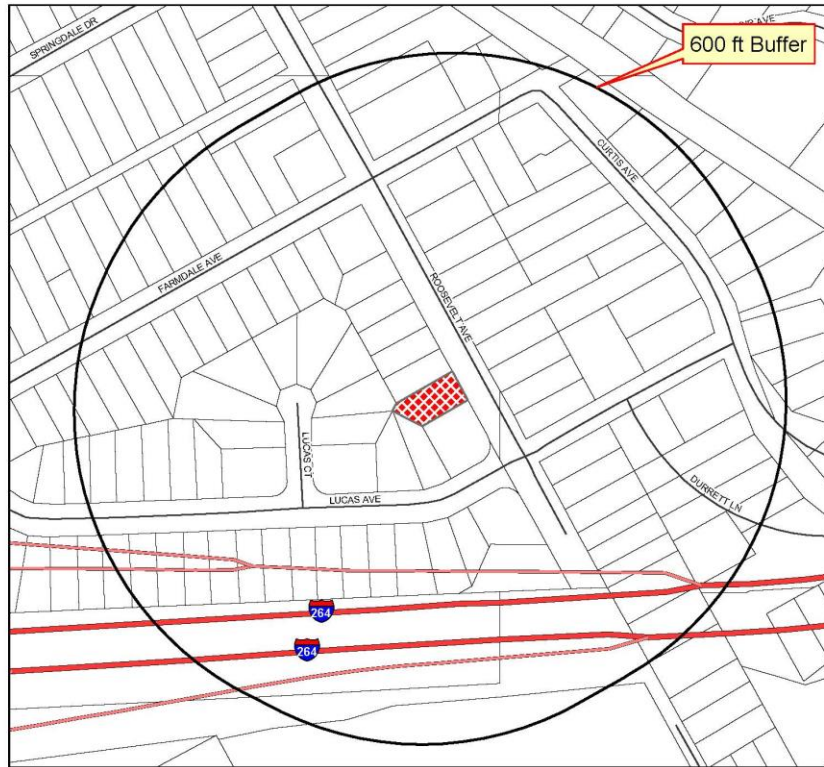

### Legend

- Buffer
- Subject Site

### Proximity Map #19-CUP-0115

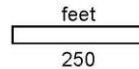

This map is subject to change upon the Board of Zoning Adjustment granting approvals to other Short Term Rental Conditional Use Permits.



Copyright (c) 2018, LOUISVILLE AND JEFFERSON COUNTY METROPOLITAN SEWER DISTRICT (MSD), LOUISVILLE WATER COMPANY (LWC), LOUISVILLE METRO GOVERNMENT and JEFFERSON COUNTY PROPERTY VALUATION ADMINISTRATOR (PVVA). All Rights Reserved.



# Front



# Property to the Right



# Property across the street



10/04/2019 12:52

# Staff Findings

- Based upon the information in the staff report and the testimony and evidence provided at the public hearing, the Board of Zoning Adjustment must determine if the proposal meets the standards established in the LDC for a Conditional Use Permit.

# Required Actions

## Approve or Deny:

- Conditional Use Permit to allow short term rental of a dwelling unit that is not the primary residence of the host.