

**Planning Commission  
Staff Report**

September 15, 2016



<b>Case No:</b>	<b>15zone1039</b>
<b>Request:</b>	<b>R-4 to OR and C-1</b>
<b>Project Name:</b>	<b>Osa Medical Office Park</b>
<b>Location:</b>	<b>4524-4528 Cane Run Road</b>
<b>Owner:</b>	<b>Nustreams LLC</b>
<b>Applicant:</b>	<b>Nustreams LLC</b>
<b>Representative:</b>	<b>Milestone Design Group; Dinsmore and Shohl LLP</b>
<b>Jurisdiction:</b>	<b>Louisville Metro</b>
<b>Council District:</b>	<b>1-Jessica Green</b>
<b>Case Manager:</b>	<b>Julia Williams, RLA, AICP, Planning Supervisor</b>

**REQUEST**

- Change in zoning from R-4 to OR and C-1
- Variance from Table 5.3.2 to permit parking to encroach into the 50' and 15' setbacks along the north property line
- Waiver from Chapter 10.2.4 to eliminate the required 5' LBA where the proposed C-1 is adjacent to the proposed OR on the site.
- Detailed District Development plan

**CASE SUMMARY/BACKGROUND/SITE CONTEXT**

The proposal is for a commercial retail structure and 3 medical office buildings. 212 Parking spaces are provided on the site. The medical office buildings proposed are mainly 2 stories. The site is heavily treed with 6% of the existing trees remaining on the site.

**LAND USE/ZONING DISTRICT/FORM DISTRICT TABLE**

	<b>Land Use</b>	<b>Zoning</b>	<b>Form District</b>
<b><i>Subject Property</i></b>			
<b>Existing</b>	Single Family Residential	R-4	Neighborhood
<b>Proposed</b>	Office and Commercial	OR/C-1	Neighborhood
<b><i>Surrounding Properties</i></b>			
<b>North</b>	Single Family Residential	R-4/C-2	Neighborhood
<b>South</b>	Church	R-4	Neighborhood
<b>East</b>	Single Family Residential	R-4	Neighborhood
<b>West</b>	Single Family Residential	R-4	Neighborhood

**PREVIOUS CASES ON SITE**

None found.

**INTERESTED PARTY COMMENTS**

None received.

## APPLICABLE PLANS AND POLICIES

Cornerstone 2020  
Land Development Code

### STANDARD OF REVIEW FOR REZONING

Criteria for granting the proposed form district change/rezoning: KRS Chapter 100.213

1. The proposed form district/rezoning change complies with the applicable guidelines and policies Cornerstone 2020; OR
2. The existing form district/zoning classification is inappropriate and the proposed classification is appropriate; OR
3. There have been major changes of an economic, physical, or social nature within the area involved which were not anticipated in Cornerstone 2020 which have substantially altered the basic character of the area.

### STAFF ANALYSIS FOR REZONING

Following is staff's analysis of the proposed rezoning against the Guidelines and Policies of Cornerstone 2020.

The site is located in the Neighborhood Form District

The Neighborhood Form is characterized by predominantly residential uses that vary from low to high density and that blend compatibly into the existing landscape and neighborhood areas. High-density uses will be limited in scope to minor or major arterials and to areas that have limited impact on the low to moderate density residential areas.

The Neighborhood Form will contain diverse housing types in order to provide housing choice for differing ages and incomes. New neighborhoods are encouraged to incorporate these different housing types within a neighborhood as long as the different types are designed to be compatible with nearby land uses. These types may include, but not be limited to large lot single family developments with cul-de-sacs, neo-traditional neighborhoods with short blocks or walkways in the middle of long blocks to connect with other streets, villages and zero lot line neighborhoods with open space, and high density multi-family condominium-style or rental housing.

The Neighborhood Form may contain open space and, at appropriate locations, civic uses and neighborhood centers with a mixture of uses such as offices, retail shops, restaurants and services. These neighborhood centers should be at a scale that is appropriate for nearby neighborhoods. The Neighborhood Form should provide for accessibility and connectivity between adjacent uses and neighborhoods by automobile, pedestrian, bicycles and transit.

Neighborhood streets may be either curvilinear, rectilinear or in a grid pattern and should be designed to invite human interaction. Streets are connected and easily accessible to each other, using design elements such as short blocks or bike/walkways in the middle of long blocks to connect with other streets. Examples of design elements that encourage this interaction include narrow street widths, street trees, sidewalks, shaded seating/gathering areas and bus stops. Placement of utilities should permit the planting of shade trees along both sides of the streets.

A compensation basin is proposed to deal with any floodplain issues. 6% of the existing tree canopy will remain, where more than 76% of the site is in existing canopy.

The proposal is within a mixed use corridor that has been created along Cane Run Road. The proposal is for high intensity zoning but is located along a major arterial and will have little impact on adjacent residential

uses. The proposal will be a part of an existing center that has been established along the Cane Run Road corridor. The proposal is for new construction. The proposal is compact and located adjacent to other similar and more intense uses making the proposal a cost effective investment. The proposal is part of a non-residential corridor that has been established along Cane Run Road. The zoning is similar to other zoning in the area, which encourages a sense of place. The proposal is for the construction of office and commercial uses. The proposal is mixed use and is located in a mixed use area. The development is multi-purpose. The proposal could be made more compact with the construction of a larger multi-story medical building.

All other agency comments should be addressed to demonstrate compliance with the remaining Guidelines and Policies of Cornerstone 2020.

A checklist is attached to the end of this staff report with a more detailed analysis. The Louisville Metro Planning Commission is charged with making a recommendation to the Louisville Metro Council regarding the appropriateness of this zoning map amendment. The Louisville Metro Council has zoning authority over the property in question.

### STANDARD OF REVIEW AND STAFF ANALYSIS FOR DDDP

- a. The conservation of natural resources on the property proposed for development, including: trees and other living vegetation, steep slopes, water courses, flood plains, soils, air quality, scenic views, and historic sites;

STAFF: A compensation basin is proposed to deal with any floodplain issues. 6% of the existing tree canopy will remain, where more than 76% of the site is in existing canopy. Minimum tree canopy requirements of the Land Development Code will be provided on the subject site.

- b. The provisions for safe and efficient vehicular and pedestrian transportation both within the development and the community;

STAFF: Provisions for safe and efficient vehicular and pedestrian transportation within and around the development and the community has been provided, and Metro Public Works has approved the preliminary development plan.

- c. The provision of sufficient open space (scenic and recreational) to meet the needs of the proposed development;

STAFF: There are no open space requirements pertinent to the current proposal. Open space is provided in buffers and the detention area shown on the plan.

- d. The provision of adequate drainage facilities on the subject site in order to prevent drainage problems from occurring on the subject site or within the community;

STAFF: The Metropolitan Sewer District has approved the preliminary development plan and will ensure the provision of adequate drainage facilities on the subject site in order to prevent drainage problems from occurring on the subject site or within the community.

- e. The compatibility of the overall site design (location of buildings, parking lots, screening, landscaping) and land use or uses with the existing and projected future development of the area;

STAFF: The overall site design and land uses are compatible with the existing and future development of the area. Appropriate landscape buffering and screening will be provided to screen adjacent properties and roadways. Buildings and parking lots will meet all required setbacks adjacent to single family uses.

- f. Conformance of the development plan with the Comprehensive Plan and Land Development Code.

STAFF: The development plan conforms to applicable guidelines and policies of the Comprehensive Plan and to requirements of the Land Development Code.

**STANDARD OF REVIEW AND STAFF ANALYSIS FOR VARIANCE**

- (a) The requested variance will not adversely affect the public health, safety or welfare.

STAFF: The requested variance will not adversely affect the public health, safety or welfare since the encroachment is adjacent to property that is zoned both residential and commercial where the residential use on the site is located in the commercial portion of the site.

- (b) The requested variance will not alter the essential character of the general vicinity.

STAFF: The requested variance will not alter the essential character of the general vicinity since the encroachment is adjacent to property that is zoned both residential and commercial where the residential use on the site is located in the commercial portion of the site.

- (c) The requested variance will not cause a hazard or nuisance to the public.

STAFF: The requested variance will not cause a hazard or nuisance to the public since the encroachment is adjacent to property that is zoned both residential and commercial where the residential use on the site is located in the commercial portion of the site.

- (d) The requested variance will not allow an unreasonable circumvention of the zoning regulations.

STAFF: The requested variance will not allow an unreasonable circumvention of the zoning regulations since the encroachment is adjacent to property that is zoned both residential and commercial where the residential use on the site is located in the commercial portion of the site.

**ADDITIONAL CONSIDERATIONS:**

1. The requested variance arises from special circumstances which do not generally apply to land in the general vicinity or the same zone.

STAFF: The encroachment is adjacent to property that is zoned both residential and commercial where the residential use on the site is located in the commercial portion of the site.

2. The strict application of the provisions of the regulation would deprive the applicant of the reasonable use of the land or create an unnecessary hardship on the applicant.

STAFF: The strict application of the provision would deprive the applicant of reasonable use of the land since the encroachment is adjacent to property that is zoned both residential and commercial where the residential use on the site is located in the commercial portion of the site.

3. The circumstances are the result of actions of the applicant taken subsequent to the adoption of the zoning regulation from which relief is sought.

STAFF: The circumstances are the result of action of the applicant taken subsequent to the adoption of the zoning regulations from which relief is sought.

## STANDARD OF REVIEW AND STAFF ANALYSIS FOR WAIVER

- (a) The waiver will not adversely affect adjacent property owners; and

STAFF: The waiver will not adversely affect adjacent property owners since buffer is internal to the site and between two non-residential uses.

- (b) The waiver will not violate specific guidelines of Cornerstone 2020; and

STAFF: Guideline 3, policy 9 of Cornerstone 2020 calls for the protection of the character of residential areas, roadway corridors and public spaces from visual intrusions and mitigate when appropriate. Guideline 3, policies 21 and 22 calls for appropriate transitions between uses that are substantially different in scale and intensity or density, and to mitigate the impact caused when incompatible developments occur adjacent to one another through the use of landscaped buffer yards, vegetative berms and setback requirements to address issues such as outdoor lighting, lights from automobiles, illuminated signs, loud noise, odors, smoke, automobile exhaust or other noxious smells, dust and dirt, litter, junk, outdoor storage, and visual nuisances. Guideline 3, policy 24 states that parking, loading and delivery areas located adjacent to residential areas should be designed to minimize the impacts from noise, lights and other potential impacts, and that parking and circulation areas adjacent to streets should be screened or buffered. Guideline 13, policy 4 calls for ensuring appropriate landscape design standards for different land uses within urbanized, suburban, and rural areas. Guideline 13, Policy 6 calls for screening and buffering to mitigate adjacent incompatible uses. The intent of landscape buffer areas is to create suitable transitions where varying forms of development adjoin, to minimize the negative impacts resulting from adjoining incompatible land uses, to decrease storm water runoff volumes and velocities associated with impervious surfaces, and to filter air borne and water borne pollutants. Not providing an LBA and landscaping where the waiver is being requested won't violate the comprehensive plan because the location of the buffer is internal to the site and between two non-residential uses.

- (c) The extent of the waiver of the regulation is the minimum necessary to afford relief to the applicant; and

STAFF: The extent of the waiver of the regulation is the minimum necessary to afford relief to the applicant since the location of the buffer is internal to the site and between two non-residential uses.

- (d) Either:

(i) The applicant has incorporated other design measures that exceed the minimums of the district and compensate for non-compliance with the requirements to be waived (net beneficial effect); OR  
(ii) The strict application of the provisions of the regulation would deprive the applicant of the reasonable use of the land or would create an unnecessary hardship on the applicant.

STAFF: The strict application of the provisions of the regulation would deprive the applicant of the reasonable use of the land or would create an unnecessary hardship on the applicant since the location of the buffer is internal to the site and between two non-residential uses.

## TECHNICAL REVIEW

- The legal description and boundary survey do not account for the two zoning districts proposed.
- KYTC is requesting a Traffic Impact Study for the proposal. Trip generation and distribution numbers have been submitted.

**STAFF CONCLUSIONS**

A compensation basin is proposed to deal with any floodplain issues. 6% of the existing tree canopy will remain, where more than 76% of the site is in existing canopy.

The proposal is within a mixed use corridor that has been created along Cane Run Road. The proposal is for high intensity zoning but is located along a major arterial and will have little impact on adjacent residential uses. The proposal will be a part of an existing center that has been established along the Cane Run Road corridor. The proposal is for new construction. The proposal is compact and located adjacent to other similar and more intense uses making the proposal a cost effective investment. The proposal is part of a non-residential corridor that has been established along Cane Run Road. The zoning is similar to other zoning in the area, which encourages a sense of place. The proposal is for the construction of office and commercial uses. The proposal is mixed use and is located in a mixed use area. The development is multi-purpose. The proposal could be made more compact with the construction of a larger multi-story medical building.

Based upon the information in the staff report, the testimony and evidence provided at the public hearing, the Planning Commission must determine if the proposal is in conformance with the Comprehensive Plan; OR the existing form district/zoning classification is inappropriate and the proposed classification is appropriate; OR if there have been major changes of an economic, physical, or social nature within the area involved which were not anticipated in Cornerstone 2020 which have substantially altered the basic character of the area.

**NOTIFICATION**

Date	Purpose of Notice	Recipients
7/1/16	Hearing before LD&T	1 <sup>st</sup> and 2 <sup>nd</sup> tier adjoining property owners Subscribers of Council District 1 Notification of Development Proposals
8/31/16	Hearing before PC	1 <sup>st</sup> and 2 <sup>nd</sup> tier adjoining property owners Subscribers of Council District 1 Notification of Development Proposals
9/2/16	Hearing before PC	Sign Posting on property
	Hearing before PC	Legal Advertisement in the Courier-Journal

**ATTACHMENTS**

1. Zoning Map
2. Aerial Photograph
3. Cornerstone 2020 Staff Checklist
4. Proposed Binding Elements

1. **Zoning Map**

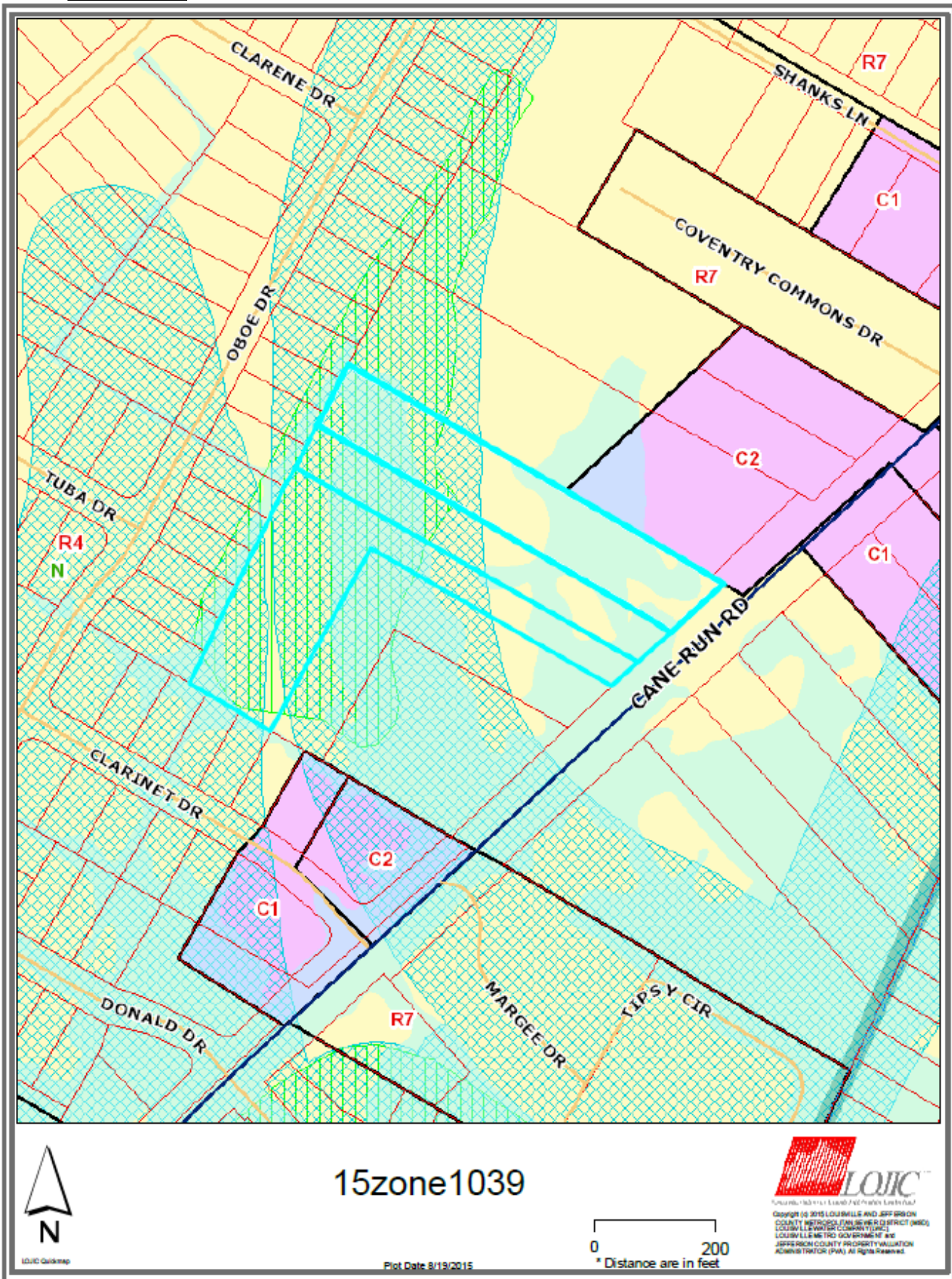



2. Aerial Photograph





### 3. Cornerstone 2020 Staff Checklist

- + Exceeds Guideline
- ✓ Meets Guideline
- Does Not Meet Guideline
- +/- More Information Needed
- NA Not Applicable

#### Neighborhood: Non-Residential

#	Cornerstone 2020 Guidelines & Policies	Cornerstone 2020 Plan Element	Plan Element or Portion of Plan Element	Staff Finding	Staff Comments
1	Form Districts Goals C1-C4, Objectives C1.1-1.2, C2.1-2.7, C3.1-3.7, C4.1.-4.7	Community Form/Land Use Guideline 1: Community Form	B.3: The proposal is a neighborhood center with a mixture of uses such as offices, retail shops, restaurants and services at a scale that is appropriate for nearby neighborhoods.	✓	The proposal is within a mixed use corridor that has been created along Cane Run Road
2	Form Districts Goals C1-C4, Objectives C1.1-1.2, C2.1-2.7, C3.1-3.7, C4.1.-4.7	Community Form/Land Use Guideline 1: Community Form	B.3: If the proposal is high intensity, it is located on a major or minor arterial or an area with limited impact on low to moderate intensity residential uses.	✓	The proposal is for high intensity zoning but is located along a major arterial and will have little impact on adjacent residential uses.
3	Form Districts Goals C1-C4, Objectives C1.1-1.2, C2.1-2.7, C3.1-3.7, C4.1.-4.7	Community Form/Land Use Guideline 2: Centers	A.1/7: The proposal, which will create a new center, is located in the Neighborhood Form District, and includes new construction or the reuse of existing buildings to provide commercial, office and/or residential use.	✓	The proposal will be a part of an existing center that has been established along the Cane Run Road corridor. The proposal is for new construction.
4	Form Districts Goals C1-C4, Objectives C1.1-1.2, C2.1-2.7, C3.1-3.7, C4.1.-4.7	Community Form/Land Use Guideline 2: Centers	A.3: The proposed retail commercial development is located in an area that has a sufficient population to support it.	✓	Commercial zoning in this area would be supported by the local population.
5	Form Districts Goals C1-C4, Objectives C1.1-1.2, C2.1-2.7, C3.1-3.7, C4.1.-4.7	Community Form/Land Use Guideline 2: Centers	A.4: The proposed development is compact and results in an efficient land use pattern and cost-effective infrastructure investment.	✓	The proposal is compact and located adjacent to other similar and more intense uses making the proposal a cost effective investment.
6	Form Districts Goals C1-C4, Objectives C1.1-1.2, C2.1-2.7, C3.1-3.7, C4.1.-4.7	Community Form/Land Use Guideline 2: Centers	A.5: The proposed center includes a mix of compatible land uses that will reduce trips, support the use of alternative forms of transportation and encourage vitality and sense of place.	✓	The proposal is part of a non-residential corridor that has been established along Cane Run Road. The zoning is similar to other zoning in the area, which encourages a sense of place.
7	Form Districts Goals C1-C4, Objectives C1.1-1.2, C2.1-2.7, C3.1-3.7, C4.1.-4.7	Community Form/Land Use Guideline 2: Centers	A.6: The proposal incorporates residential and office uses above retail and/or includes other mixed-use, multi-story retail buildings.	✓	The proposal is for the construction of office and commercial uses. The proposal is mixed use and is located in a mixed use area.
8	Form Districts Goals C1-C4, Objectives C1.1-1.2, C2.1-2.7, C3.1-3.7, C4.1.-4.7	Community Form/Land Use Guideline 2: Centers	A.12: If the proposal is a large development in a center, it is designed to be compact and multi-purpose, and is oriented around a central feature such as a public square or plaza or landscape element.	✓	The development is multi-purpose. The proposal could be made more compact with the construction of a larger multi-story medical building.

#	Cornerstone 2020 Guidelines & Policies	Cornerstone 2020 Plan Element	Plan Element or Portion of Plan Element	Staff Finding	Staff Comments
9	Form Districts Goals C1-C4, Objectives C1.1-1.2, C2.1-2.7, C3.1-3.7, C4.1.-4.7	Community Form/Land Use Guideline 2: Centers	A.13/15: The proposal shares entrance and parking facilities with adjacent uses to reduce curb cuts and surface parking, and locates parking to balance safety, traffic, transit, pedestrian, environmental and aesthetic concerns.	✓	The proposal has its own entrance off of Cane Run Road. In front of the structure, which is consistent with the other uses in the area.
10	Form Districts Goals C1-C4, Objectives C1.1-1.2, C2.1-2.7, C3.1-3.7, C4.1.-4.7	Community Form/Land Use Guideline 2: Centers	A.14: The proposal is designed to share utility hookups and service entrances with adjacent developments, and utility lines are placed underground in common easements.	✓	Utilities could be shared with the proposal.
11	Form Districts Goals C1-C4, Objectives C1.1-1.2, C2.1-2.7, C3.1-3.7, C4.1.-4.7	Community Form/Land Use Guideline 2: Centers	A.16: The proposal is designed to support easy access by bicycle, car and transit and by pedestrians and persons with disabilities.	✓	The proposal supports access by all types of transportation due to its sidewalk, driveway, and parking facilities.
12	Form Districts Goals C1-C4, Objectives C1.1-1.2, C2.1-2.7, C3.1-3.7, C4.1.-4.7	Community Form/Land Use Guideline 3: Compatibility	A.2: The proposed building materials increase the new development's compatibility.	✓	The building materials will be similar to what is found in the area.
13	Form Districts Goals C1-C4, Objectives C1.1-1.2, C2.1-2.7, C3.1-3.7, C4.1.-4.7	Community Form/Land Use Guideline 3: Compatibility	A.4/5/6/7: The proposal does not constitute a non-residential expansion into an existing residential area, or demonstrates that despite such an expansion, impacts on existing residences (including traffic, parking, signs, lighting, noise, odor and stormwater) are appropriately mitigated.	✓	The proposal is not a non-residential expansion into a residential area.
14	Form Districts Goals C1-C4, Objectives C1.1-1.2, C2.1-2.7, C3.1-3.7, C4.1.-4.7	Community Form/Land Use Guideline 3: Compatibility	A.5: The proposal mitigates any potential odor or emissions associated with the development.	✓	APCD had no issues with the proposal.
15	Form Districts Goals C1-C4, Objectives C1.1-1.2, C2.1-2.7, C3.1-3.7, C4.1.-4.7	Community Form/Land Use Guideline 3: Compatibility	A.6: The proposal mitigates any adverse impacts of its associated traffic on nearby existing communities.	✓	Transportation Planning has not indicated any issues with traffic.
16	Form Districts Goals C1-C4, Objectives C1.1-1.2, C2.1-2.7, C3.1-3.7, C4.1.-4.7	Community Form/Land Use Guideline 3: Compatibility	A.8: The proposal mitigates adverse impacts of its lighting on nearby properties, and on the night sky.	✓	Lighting will meet LDC requirements.
17	Form Districts Goals C1-C4, Objectives C1.1-1.2, C2.1-2.7, C3.1-3.7, C4.1.-4.7	Community Form/Land Use Guideline 3: Compatibility	A.11: If the proposal is a higher density or intensity use, it is located along a transit corridor AND in or near an activity center.	✓	The proposal is not high intensity but is located along a transit corridor and along an activity corridor.
18	Form Districts Goals C1-C4, Objectives C1.1-1.2, C2.1-2.7, C3.1-3.7, C4.1.-4.7	Community Form/Land Use Guideline 3: Compatibility	A.21: The proposal provides appropriate transitions between uses that are substantially different in scale and intensity or density of development such as landscaped buffer yards, vegetative berms, compatible building design and materials, height restrictions, or setback requirements.	✓	Buffers and setbacks are being complied with where they are adjacent to single family residential uses.

#	Cornerstone 2020 Guidelines & Policies	Cornerstone 2020 Plan Element	Plan Element or Portion of Plan Element	Staff Finding	Staff Comments
19	Form Districts Goals C1-C4, Objectives C1.1-1.2, C2.1-2.7, C3.1-3.7, C4.1.-4.7	Community Form/Land Use Guideline 3: Compatibility	A.22: The proposal mitigates the impacts caused when incompatible developments unavoidably occur adjacent to one another by using buffers that are of varying designs such as landscaping, vegetative berms and/or walls, and that address those aspects of the development that have the potential to adversely impact existing area developments.	✓	Buffers and setbacks are being complied with where they are adjacent to single family residential uses.
20	Form Districts Goals C1-C4, Objectives C1.1-1.2, C2.1-2.7, C3.1-3.7, C4.1.-4.7	Community Form/Land Use Guideline 3: Compatibility	A.23: Setbacks, lot dimensions and building heights are compatible with those of nearby developments that meet form district standards.	✓	Buffers and setbacks are being complied with where they are adjacent to single family residential uses.
21	Form Districts Goals C1-C4, Objectives C1.1-1.2, C2.1-2.7, C3.1-3.7, C4.1.-4.7	Community Form/Land Use Guideline 3: Compatibility	A.24: Parking, loading and delivery areas located adjacent to residential areas are designed to minimize adverse impacts of lighting, noise and other potential impacts, and that these areas are located to avoid negatively impacting motorists, residents and pedestrians.	✓	The buffering and screening requirements will be met along the property lines.
22	Form Districts Goals C1-C4, Objectives C1.1-1.2, C2.1-2.7, C3.1-3.7, C4.1.-4.7	Community Form/Land Use Guideline 3: Compatibility	A.24: The proposal includes screening and buffering of parking and circulation areas adjacent to the street, and uses design features or landscaping to fill gaps created by surface parking lots. Parking areas and garage doors are oriented to the side or back of buildings rather than to the street.	✓	Parking will be screened from the roadway.
23	Form Districts Goals C1-C4, Objectives C1.1-1.2, C2.1-2.7, C3.1-3.7, C4.1.-4.7	Community Form/Land Use Guideline 3: Compatibility	A.25: Parking garages are integrated into their surroundings and provide an active, inviting street-level appearance.	NA	A parking garage is not proposed.
24	Form Districts Goals C1-C4, Objectives C1.1-1.2, C2.1-2.7, C3.1-3.7, C4.1.-4.7	Community Form/Land Use Guideline 3: Compatibility	A.28: Signs are compatible with the form district pattern and contribute to the visual quality of their surroundings.	✓	Signs will meet LDC requirements.
25	Livability Goals H3 and H5, all related objectives	Community Form/Land Use Guideline 4: Open Space	A.2/3/7: The proposal provides open space that helps meet the needs of the community as a component of the development and provides for the continued maintenance of that open space.	✓	The open space for the site is within the LBAs.
26	Livability Goals H3 and H5, all related objectives	Community Form/Land Use Guideline 4: Open Space	A.4: Open space design is consistent with the pattern of development in the Neighborhood Form District.	✓	The open space for the site is within the LBAs.
27	Livability Goals H3 and H5, all related objectives	Community Form/Land Use Guideline 4: Open Space	A.5: The proposal integrates natural features into the pattern of development.	-	A compensation basin is proposed to deal with any floodplain issues. 6% of the existing tree canopy will remain, where more than 76% of the site is in existing canopy.

#	Cornerstone 2020 Guidelines & Policies	Cornerstone 2020 Plan Element	Plan Element or Portion of Plan Element	Staff Finding	Staff Comments
28	Livability Goals H3 and H5, all related objectives	Community Form/Land Use Guideline 5: Natural Areas and Scenic and Historic Resources	A.1: The proposal respects the natural features of the site through sensitive site design, avoids substantial changes to the topography and minimizes property damage and environmental degradation resulting from disturbance of natural systems.	-	A compensation basin is proposed to deal with any floodplain issues. 6% of the existing tree canopy will remain, where more than 76% of the site is in existing canopy.
29	Livability Goals H3 and H5, all related objectives	Community Form/Land Use Guideline 5: Natural Areas and Scenic and Historic Resources	A.2/4: The proposal includes the preservation, use or adaptive reuse of buildings, sites, districts and landscapes that are recognized as having historical or architectural value, and, if located within the impact area of these resources, is compatible in height, bulk, scale, architecture and placement.	✓	The site has no historical or cultural value.
30	Livability Goals H3 and H5, all related objectives	Community Form/Land Use Guideline 5: Natural Areas and Scenic and Historic Resources	A.6: Encourage development to avoid wet or highly permeable soils, severe, steep or unstable slopes with the potential for severe erosion.	✓	A compensation basin is proposed to deal with any floodplain/wetland issues
31	People, Jobs and Housing Goal K4, Objective K4.1	Marketplace Guideline 6: Economic Growth and Sustainability	A.3: Encourage redevelopment, reinvestment and rehabilitation in the downtown where it is consistent with the form district pattern.	NA	The proposal is not located within a downtown.
32	Marketplace Strategy Goal A1, Objectives A1.3, A1.4, A1.5	Marketplace Guideline 6: Economic Growth and Sustainability	A.4: Encourage industries to locate in industrial subdivisions or adjacent to existing industry to take advantage of special infrastructure needs.	NA	The proposal is not for industrial.
33	Land Use and Transportation Connection Goal E1, Objectives E1.1 and E1.3	Marketplace Guideline 6: Economic Growth and Sustainability	A.6: Locate retail commercial development in activity centers. Locate uses generating large amounts of traffic on a major arterial, at the intersection of two minor arterials or at locations with good access to a major arterial and where the proposed use will not adversely affect adjacent areas.	✓	The commercial component of the development is located directly along the major arterial, Cane Run Road.
34	Land Use and Transportation Connection Goal E1, Objectives E1.1 and E1.3	Marketplace Guideline 6: Economic Growth and Sustainability	A.8: Require industrial development with more than 100 employees to locate on or near an arterial street, preferably in close proximity to an expressway interchange. Require industrial development with less than 100 employees to locate on or near an arterial street.	NA	The proposal is not for industrial.
35	Mobility Goals A1-A6, B1, C1, D1, E1, E2, F1, G1, H1-H4, I1-I7, all related Objectives	Mobility/Transportation Guideline 7: Circulation	A.1/2: The proposal will contribute its proportional share of the cost of roadway improvements and other services and public facilities made necessary by the development through physical improvements to these facilities, contribution of money, or other means.	✓	ROW will be dedicated along Cane Run Road. Potential roadway improvements may be required at construction pending KTC requirements.



#	Cornerstone 2020 Guidelines & Policies	Cornerstone 2020 Plan Element	Plan Element or Portion of Plan Element	Staff Finding	Staff Comments
36	Mobility Goals A1-A6, B1, C1, D1, E1, E2, F1, G1, H1-H4, I1-I7, all related Objectives	Mobility/Transportation Guideline 7: Circulation	A.3/4: The proposal promotes mass transit, bicycle and pedestrian use and provides amenities to support these modes of transportation.	✓	A sidewalk is located along Cane Run Road to address pedestrian and transit traffic.
37	Mobility Goals A1-A6, B1, C1, D1, E1, E2, F1, G1, H1-H4, I1-I7, all related Objectives	Mobility/Transportation Guideline 7: Circulation	A.6: The proposal's transportation facilities are compatible with and support access to surrounding land uses, and contribute to the appropriate development of adjacent lands. The proposal includes at least one continuous roadway through the development, adequate street stubs, and relies on cul-de-sacs only as short side streets or where natural features limit development of "through" roads.	✓	A crossover access agreement will be issued if the adjacent properties ever redevelop.
38	Mobility Goals A1-A6, B1, C1, D1, E1, E2, F1, G1, H1-H4, I1-I7, all related Objectives	Mobility/Transportation Guideline 7: Circulation	A.9: The proposal includes the dedication of rights-of-way for street, transit corridors, bikeway and walkway facilities within or abutting the development.	✓	ROW will be dedicated along Cane Run Road. Potential roadway improvements may be required at construction pending KTC requirements.
39	Mobility Goals A1-A6, B1, C1, D1, E1, E2, F1, G1, H1-H4, I1-I7, all related Objectives	Mobility/Transportation Guideline 7: Circulation	A.10: The proposal includes adequate parking spaces to support the use.	✓	Adequate parking is provided.
40	Mobility Goals A1-A6, B1, C1, D1, E1, E2, F1, G1, H1-H4, I1-I7, all related Objectives	Mobility/Transportation Guideline 7: Circulation	A.13/16: The proposal provides for joint and cross access through the development and to connect to adjacent development sites.	✓	Joint access will be provided if the adjacent properties ever redevelop.
41	Mobility Goals A1-A6, B1, C1, D1, E1, E2, F1, G1, H1-H4, I1-I7, all related Objectives	Mobility/Transportation Guideline 8: Transportation Facility Design	A.8: Adequate stub streets are provided for future roadway connections that support and contribute to appropriate development of adjacent land.	NA	No new roadways are proposed.
42	Mobility Goals A1-A6, B1, C1, D1, E1, E2, F1, G1, H1-H4, I1-I7, all related Objectives	Mobility/Transportation Guideline 8: Transportation Facility Design	A.9: Avoid access to development through areas of significantly lower intensity or density if such access would create a significant nuisance.	✓	Access to the site is from a major arterial.
43	Mobility Goals A1-A6, B1, C1, D1, E1, E2, F1, G1, H1-H4, I1-I7, all related Objectives	Mobility/Transportation Guideline 8: Transportation Facility Design	A.11: The development provides for an appropriate functional hierarchy of streets and appropriate linkages between activity areas in and adjacent to the development site.	NA	No new roadways are proposed.
44	Mobility Goals A1-A6, B1, C1, D1, E1, E2, F1, G1, H1-H4, I1-I7, all related Objectives	Mobility/Transportation Guideline 9: Bicycle, Pedestrian and Transit	A.1/2: The proposal provides, where appropriate, for the movement of pedestrians, bicyclists and transit users around and through the development, provides bicycle and pedestrian connections to adjacent developments and to transit stops, and is appropriately located for its density and intensity.	✓	Pedestrians and transit users are being provided for with the sidewalk along Cane Run Road.

#	Cornerstone 2020 Guidelines & Policies	Cornerstone 2020 Plan Element	Plan Element or Portion of Plan Element	Staff Finding	Staff Comments
45	Livability, Goals B1, B2, B3, B4, Objectives B1.1-1.8, B2.1-2.7, B3.1-3.4, B4.1-4.3	Livability/Environment Guideline 10: Flooding and Stormwater	The proposal's drainage plans have been approved by MSD, and the proposal mitigates negative impacts to the floodplain and minimizes impervious area. Solid blue-line streams are protected through a vegetative buffer, and drainage designs are capable of accommodating upstream runoff assuming a fully-developed watershed. If streambank restoration or preservation is necessary, the proposal uses best management practices.	✓	MSD has no issues with the proposal.
46	Livability Goals C1, C2, C3, C4, all related Objectives	Livability/Environment Guideline 12: Air Quality	The proposal has been reviewed by APCD and found to not have a negative impact on air quality.	✓	APCD has no issues with the proposal.
47	Livability, Goals F1 and F2, all related objectives	Livability/Environment Guideline 13: Landscape Character	A.3: The proposal includes additions and connections to a system of natural corridors that can provide habitat areas and allow for migration.	-	A compensation basin is proposed to deal with any floodplain issues. 6% of the existing tree canopy will remain, where more than 76% of the site is in existing canopy.
48	Quality of Life Goal J1, Objectives J1.1-1.2	Community Facilities Guideline 14: Infrastructure	A.2: The proposal is located in an area served by existing utilities or planned for utilities.	✓	Existing utilities will serve the site.
49	Quality of Life Goal J1, Objectives J1.1-1.2	Community Facilities Guideline 14: Infrastructure	A.3: The proposal has access to an adequate supply of potable water and water for fire-fighting purposes.	✓	An adequate water supply is available to the site.
50	Livability Goal B1, Objective B1.3	Community Facilities Guideline 14: Infrastructure	A.4: The proposal has adequate means of sewage treatment and disposal to protect public health and to protect water quality in lakes and streams.	✓	The Health Department has no issues with the proposal.

#### 4. **Proposed Binding Elements**

1. The development shall be in accordance with the approved district development plan, all applicable sections of the Land Development Code (LDC) and agreed upon binding elements unless amended pursuant to the Land Development Code. Any changes/additions/alterations of any binding element(s) shall be submitted to the Planning Commission or the Planning Commission's designee for review and approval; any changes/additions/alterations not so referred shall not be valid.
2. The development shall not exceed 11,500 square feet of gross floor area for Lot 1. The development shall not exceed 45,630 square feet of gross floor area for Lot 2.
3. No outdoor advertising signs, small freestanding signs, pennants, balloons, or banners shall be permitted on the site.
4. Construction fencing shall be erected when off-site trees or tree canopy exists within 3' of a common property line. Fencing shall be in place prior to any grading or construction to protect the existing root systems from compaction. The fencing shall enclose the entire area beneath the tree canopy and shall remain in place until all construction is completed. No parking, material storage or construction activities are permitted within the protected area.

5. Before any permit (including but not limited to building, parking lot, change of use, site disturbance, alteration permit) is requested:
  - a. The development plan must receive full construction approval from Develop Louisville, Louisville Metro Public Works and the Metropolitan Sewer District.
  - b. Encroachment permits must be obtained from the Kentucky Department of Transportation, Bureau of Highways.
  - c. A minor subdivision plat or legal instrument shall be recorded creating the lot lines as shown on the development plan. A copy of the recorded instrument shall be submitted to the Division of Planning and Design Services; transmittal of approved plans to the office responsible for permit issuance will occur only after receipt of said instrument.
  - d. The property owner/developer must obtain approval of a detailed plan for screening (buffering/landscaping) as described in Chapter 10 prior to requesting a building permit. Such plan shall be implemented prior to occupancy of the site and shall be maintained thereafter.
  - e. A minor plat or legal instrument shall be recorded consolidating the property into one lot. A copy of the recorded instrument shall be submitted to the Division of Planning and Design Services; transmittal of the approved plans to the office responsible for permit issuance will occur only after receipt of said instrument.
  - f. A Tree Preservation Plan in accordance with Chapter 10 of the LDC shall be reviewed and approved prior to obtaining approval for site disturbance.
6. A certificate of occupancy must be received from the appropriate code enforcement department prior to occupancy of the structure or land for the proposed use. All binding elements requiring action and approval must be implemented prior to requesting issuance of the certificate of occupancy, unless specifically waived by the Planning Commission.
7. There shall be no outdoor music (live, piped, radio or amplified) or outdoor entertainment or outdoor PA system audible beyond the property line.
8. The applicant, developer, or property owner shall provide copies of these binding elements to tenants, purchasers, contractors, subcontractors and other parties engaged in development of this site and shall advise them of the content of these binding elements. These binding elements shall run with the land and the owner of the property and occupant of the property shall at all times be responsible for compliance with these binding elements. At all times during development of the site, the applicant and developer, their heirs, successors; and assignees, contractors, subcontractors, and other parties engaged in development of the site, shall be responsible for compliance with these binding elements.
9. The property owner shall provide a cross over access easement if the property to the north is ever developed for a nonresidential use and to the south if the property is ever redeveloped. A copy of the signed easement agreement shall be provided to Planning Commission staff upon request.
10. The materials and design of proposed structures shall be substantially the same as depicted in the rendering as presented at the September 15, 2016 Planning Commission meeting.
11. No idling of trucks shall take place within 200 feet of single-family residences. No overnight idling of trucks shall be permitted on-site.
12. The applicant shall not be issued a building permit for Building D until it has conducted an abbreviated traffic study with a scope satisfactory to KYTC, submitted same to KYTC and has reached an agreement with KYTC on any improvements to Cane Run Road.