

Louisville Metro Council City Agency Request

- Neighborhood Development Fund (NDF)
- Capital Infrastructure Fund (CIF)
- Municipal Aid Program (MAP)
- Paving Fund (PAV)

Primary Sponsor: Councilwoman Cheri Bryant Hamilton - D5

Amount: \$ 6300.00 Date: 5-18-16

Description of program/project including public purpose, additional funding sources, location of project/program and any external grantee(s):
Speed hump and related work for Sa. Shawnee Terr. between Market St + Duncan Street.
2 Speed humps, 2 Speed hump signs

City Agency: Public Works
 Contact Person: Gregory Dow
 Agency Phone: 574-3882

I have reviewed this request for an expenditure of city tax dollars, and have determined the funds will be used for a public purpose.

5 District # Cheri B. Hamilton Council Member Signature \$ 6300.00 Amount 5-18-16 Date

Approved by: _____ Date _____
 Appropriations Committee Chairman

Clerk's Office & OMB Use Only:

Request Amount: _____ Amended Amount: _____
 Reference #: _____ To OMB: _____
 Budget Revision #: _____
 Account #: _____
 To Project Manager: _____ Completion Date: _____
 Actual Cost: _____ Funds Returned: _____

CIF, NDF, MAP OR PAV INTERAGENCY CHECKLIST

Interagency Name:

Program/Project Name:

	Yes/No/NA
Request Form: Is the Request Signed by all Council Member(s) Appropriating Funding?	✓
Request Form: If matching funds are to be used, are they disclosed with account numbers in the request form description?	--- No
Request Form: If matching funds are to be used, does the amount of the request exclude the matching fund amount?	--- No
Request Form: If other funds are to be used for this project, are they disclosed with account numbers in the request form description?	--- No
Funding Source: If CIF is being requested, does Metro Louisville own/will own the real estate, building or equipment? If not, the funding source is probably NDF.	✓
Funding Source: If CIF is being requested, does the project have a useful life of more than one year? If not, the funding source is probably NDF.	✓
Ordinance Required: Is the NDF request to a Metro Agency greater than \$5,000? If so, an ordinance is required.	--- No
Ordinance Required: Is the request a transfer from NDF to cost center? If so, is the amount given for the fiscal year \$25,000 or less?	--- No
Supporting Documentation: Does the attachment include a valid estimate and description of cost?	✓

Prepared by:

W. J. ...

Date: 5/18/16



DEPARTMENT OF PUBLIC WORKS AND ASSETS

LOUISVILLE, KENTUCKY

GREG FISCHER

MAYOR

VANESSA D. BURNS

Director

TO: Councilwoman Cheri Bryant Hamilton
District 5

FROM: Gregory A. Dow
Traffic Engineering

DATE: May 12, 2016

RE: Cost of Speed Humps for S. Shawnee Terrace
SR # 4349512
Two (2) Speed Humps x \$2,950.00 = \$5,900.00
Two (2) Speed Hump signs x \$200.00 = \$400.00
Total = \$6,300.00

Please consider this letter as our official Statement of Cost for all speed hump related work. Each speed hump, including markings is \$2,950.00 and each sign is \$200.00. Based on our Engineering Studies, a total of two (2) speed humps and two (2) speed hump signs have been proposed for S. Shawnee Terrace, between W. Market Street and Duncan Street. The total "not to exceed" cost is \$6,300.00, and as I understand it, you have offered to fund the entire amount.

Upon funding approval, the speed humps will be installed as schedule and weather permits.

Please let me know if you have any questions. You may contact me at 574-3882.

Sincerely,

Gregory A. Dow
Traffic Engineering

March 19, 2015

S. Shawnee Terrace (2-Speed Humps)

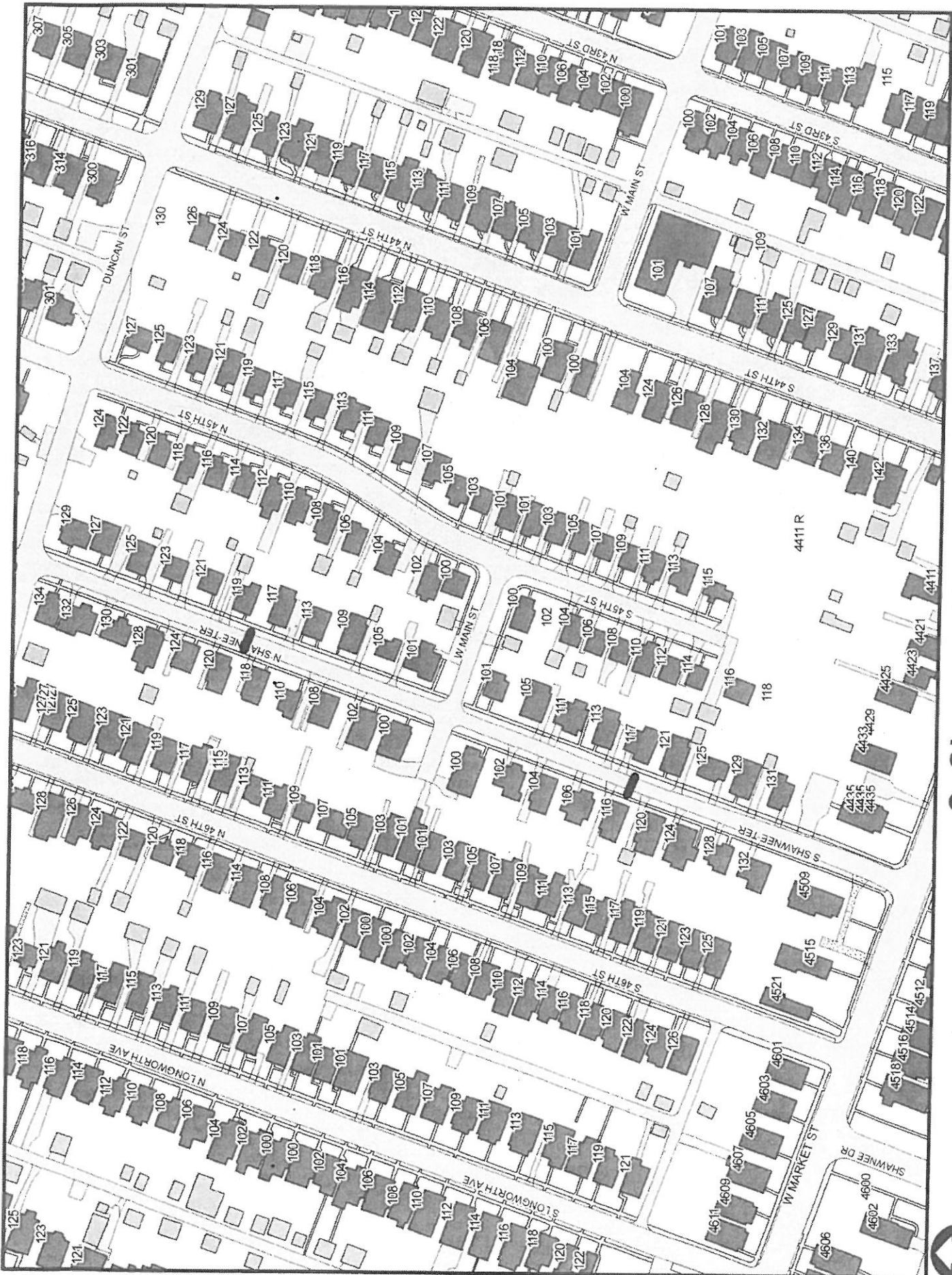

NOT TO SCALE