

# DESIGN PACKAGE



**Taylorville Rd  
Louisville, KY 40299**

**STORE #4703312**

BRANDING LEVEL: **B**  
 BU: **N/A**  
 FUEL BRAND: **CIRCLE K**  
 CASE #: **21555**  
 ARCHETYPE: **N/A**  
 DATE: **09/05/18**

*This is for presentation only.*

*Detailed fuel branding specifications provided as supplementary attachment.*

## Project ID

DB5-21555

Date: 09/05/18  
 Scale: as noted  
 Sales: A. Nabors  
 Designer: J. Piquero

Rev. #: xx  
 Date: xx-xx-xxxx

Revision Note:

## Conceptual

Information Required:

## Master

Electrical

120V  347V  
 Other \_\_\_\_\_

## Customer Approval

Signature \_\_\_\_\_

MM/DD/YYYY

It is the Customer's responsibility to ensure that the structure of the building is designed and constructed to accept the installation of the signs being ordered. Please ask PSG to provide further details if required.

All rights reserved. The artwork depicted herein are copyright and are the exclusive property of Pattison Sign Group and as such cannot be reproduced in whole or in part without written permission by Pattison Sign Group.

CK #4703312  
 Taylorville Rd  
 Louisville, KY 40299

Sign Item

Cover Page



520 West Summit Hill Drive, Suite 702, Knoxville TN, USA 37902  
 (Toll Free) 1.866.635.1110 (Fax) 1.888.694.1106  
[www.pattisonsign.com](http://www.pattisonsign.com)



This sign to be installed in accordance with the requirements of Article 600 of the National Electrical Code and/or other applicable local codes. This includes proper grounding and bonding of the sign.



Fluorescent, Neon and HID lamps contain Mercury (HG). Dispose of the lamps according to Local, Provincial, State or Federal Laws.

SCOPE OF WORK	
<b>A BUILDING</b>	<ul style="list-style-type: none"> <li>*Remove existing fascia sign</li> <li>*Remediate building prior to install of new signs</li> <li>*Install new Circle K illuminated box sign; 2' x 5'</li> <li>* Replace trash cans to Circle K Specifications</li> <li>* Nuthatch – 1x per store front entrance for a total of 10 Option 2</li> <li>*473396399; 42 gallon Waste Container with Ashtray/Dome Lid Nuthatch 1x per store front entrance for a total of 1</li> <li>*Paint bollards to Circle K specifications; SW #4081 Safety Red - Paint entire bollard</li> <li>*The building will not be painted</li> </ul>
<b>B LIGHT POLES</b>	<ul style="list-style-type: none"> <li>*Paint Light poles RAL9016 Shell Warm White - preferred.</li> <li>Duranodic Bronze - Only for existing light poles. Silver - Only for existing light poles</li> </ul>
<b>C CANOPY</b>	<ul style="list-style-type: none"> <li>*Remove existing canopy signs and repair the canopy if applicable</li> <li>*Install 48" tri color non illuminated ACM on all elevations. 344 linear ft.</li> <li>*Install (2) new illuminated Circle K channel letter canopy signs on canopy</li> <li>New Canopy channel letters will go in same place as existing</li> <li>*If the existing canopy does not have electricity to the existing wordmarks; Circle K to install electricity prior to installation of new canopy material</li> <li>*Install new blue unleaded face on existing price changer with red digits.</li> <li>*Install new green diesel face on existing price changer with green digits.</li> <li>*Install with toggle on the unleaded panels using flat faces on both price changers.</li> <li>*Paint retainers and cabinets white</li> </ul>
<b>D DISPENSER &amp; FORECOURT FOR CANOPY</b>	<ul style="list-style-type: none"> <li>*Reimage 8 unleaded dispensers to fuel brand specifications</li> <li>*Install 16 pump flags and graphics to fuel brand specifications</li> <li>*Replace 4 trash cans to fuel brand specifications;</li> <li>Circle K - Gray #758703- Double-sided Waste 'N Wipe Service Center, 40-gallon – 1x per dispenser*Paint 8 bollards to fuel brand specifications; SW #6236 Grays Harbor *Paint 8 columns to fuel brand specifications; SW #6236 Grays Harbor ; from grade to 24" above grade and RAL9016 Shell Warm White ; from gray to bottom of canopy</li> <li>*Paint 4 islands to fuel brand specifications;</li> <li>SW #6236 Grays Harbor</li> </ul>
<b>E ADDITIONAL</b>	<ul style="list-style-type: none"> <li>*Remove any existing Circle K logos and repair any existing area where the logos were installed if needed (ie: ghosting or glue residue)</li> <li>*Install new Circle K ID decals over existing Circle K logos</li> <li>*Paint the dumpster enclosures to the Circle K building paint specifications</li> <li>*Paint the storage building to the Circle K building paint specifications</li> <li>*Install new Circle K ID decals on the AIR/VAC machine, propane enclosure and ice coolers</li> </ul>

COLOR SPECIFICATIONS:								
Sample	Description	Applied to	Sample	Description	Applied to	Sample	Description	Applied to
	<b>Primary Red</b> Pantone 485 3M 3630-33 Red Vinyl	<ul style="list-style-type: none"> <li>- MID Sign</li> <li>- Building Sign</li> <li>- Canopy Fascia</li> <li>- Dispenser Door Skirt</li> <li>- Car Wash Sign Copy</li> </ul>		<b>Nuthatch</b> Sherwin Williams - SW 6088 <small>(ALL REGIONS EXCEPT SE) Neutral Ground Sherwin Williams SW 7148</small>	<ul style="list-style-type: none"> <li>- 30" above grade to top of fascia.</li> <li>- Light poles</li> </ul>		<b>Green</b> Pantone 355 3M 3630-156 "Vivid Green" Vinyl	<ul style="list-style-type: none"> <li>- Diesel Door Skin</li> <li>- CK Pricer (Diesel) if Applicable</li> </ul>
	<b>Primary Orange</b> Pantone 144 3M 3630-3540 Tangerine Vinyl	<ul style="list-style-type: none"> <li>- MID Sign</li> <li>- Building Sign</li> <li>- Canopy Fascia</li> <li>- Dispenser Valance</li> <li>- Column Flags</li> </ul>		<b>Grays Harbor</b> SW 6236 "Grays Harbor" Semi-gloss finish	<ul style="list-style-type: none"> <li>- Main Building 30" to grade</li> <li>- Car Wash Building 30" to grade</li> </ul>		<b>Blue</b> Pantone 287 3M 3630-157 "Sultan Blue" Vinyl	<ul style="list-style-type: none"> <li>- Car Wash Panel</li> <li>- CK Pricer (Unleaded) if Applicable</li> </ul>
	<b>Safety Red</b> SW #4081	<ul style="list-style-type: none"> <li>- Bollards near store front</li> </ul>			<ul style="list-style-type: none"> <li>- Canopy Column Base (24" from ground)</li> <li>- Canopy Bollards</li> </ul>		<b>Shell Warm White</b> RAL9016	<ul style="list-style-type: none"> <li>- Columns</li> </ul>



SCALE: NTS

RECEIVED  
DEC 07 2018  
PLANNING &  
DESIGN SERVICES



520 West Summit Hill Drive, Suite 702, Knoxville TN, USA 37902  
(Toll Free) 1.866.635.1110 (Fax) 1.888.694.1106  
www.pattisonsign.com



This sign to be installed in accordance with the requirements of Article 600 of the National Electrical Code and/or other applicable local codes. This includes proper grounding and bonding of the sign.



Fluorescent, Neon and HID lamps contain Mercury (HG). Dispose of the lamps according to Local, Provincial, State or Federal Laws.

Project ID

DB5-21555

Date: 09/05/18  
Scale: as noted  
Sales: A. Nabors  
Designer: J. Piquero

Rev. #: xx  
Date: xx-xx-xxxx

Revision Note:

Conceptual

Information Required:

Master

Electrical

120V  347V  
 Other \_\_\_\_\_

Customer Approval

Signature \_\_\_\_\_

MM/DD/YYYY

It is the Customer's responsibility to ensure that the structure of the building is designed and constructed to accept the installation of the signs being ordered. Please ask PSG to provide further details if required.

All rights reserved. The artwork depicted herein are copyright and are the exclusive property of Pattison Sign Group and as such cannot be reproduced in whole or in part without written permission by Pattison Sign Group.

CK #4703312  
Taylorsville Rd  
Louisville, KY 40299

Sign Item

Scope of Work

**STOREFRONT | SHOP SIGNS**

**EXISTING**

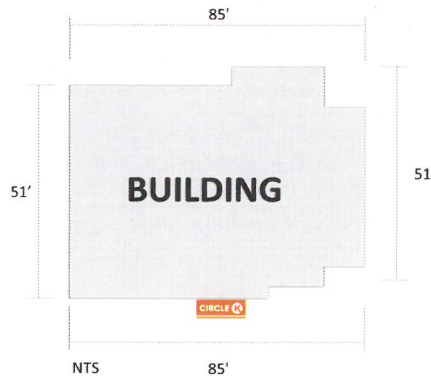

**SCOPE OF WORK**

- A BUILDING**
  - \* Remove existing fascia sign
  - \* Remediate building prior to install of new signs
  - \* Install new Circle K illuminated box sign: 2' x 5'
  - \* Replace trash cans to Circle K Specifications
  - \* Nuthatch - 1x per store front entrance for a total of 1 Option 2
  - \* #73396399; 42 gallon Waste Container with Ashtray/Dome Lid Nuthatch 1x per store front entrance for a total of 1
  - \* Paint bollards to Circle K specifications; SW #4081 Safety Red - Paint entire bollard
  - \* The building will not be painted
- B LIGHT POLES**
  - \* Paint Light poles RAL9016 Shell Warm White - preferred.
  - Duranodic Bronze - Only for existing light poles. Silver - Only for existing light poles

**RECEIVED**  
 DEC 07 2018  
 PLANNING &  
 DESIGN SERVICES

**PROPOSED**



Note: Size of signage in relation to the building is approximate. This photo mock-up is intended for location purposes only and may not accurately represent the scale of the proposed signage to the building. A site survey is required.

**BUILDING**

**Project ID**  
 DB5-21555

Date: 09/05/18  
 Scale: as noted  
 Sales: A. Nabors  
 Designer: J. Piquero

Rev. #: xx  
 Date: xx-xx-xxxx

Revision Note:

---

**Conceptual**

Information Required:

---

**Master**

**Electrical**

120V  347V  
 Other \_\_\_\_\_

**Customer Approval**

Signature \_\_\_\_\_  
 MM/DD/YYYY \_\_\_\_\_

It is the Customer's responsibility to ensure that the structure of the building is designed and constructed to accept the installation of the signs being ordered. Please ask PSG to provide further details if required.

All rights reserved. The artwork depicted herein are copyright and are the exclusive property of Pattison Sign Group and as such cannot be reproduced in whole or in part without written permission by Pattison Sign Group.

---

CK #4703312  
 Taylorsville Rd  
 Louisville, KY 40299

**Sign Item**  
 Building Signage



520 West Summit Hill Drive, Suite 702, Knoxville TN, USA 37902  
 (Toll Free) 1.866.635.1110 (Fax) 1.888.694.1106  
 www.pattisonsign.com



This sign to be installed in accordance with the requirements of Article 600 of the National Electrical Code and/or other applicable local codes. This includes proper grounding and bonding of the sign.



Fluorescent, Neon and HID lamps contain Mercury (HG). Dispose of the lamps according to Local, Provincial, State or Federal Laws.

18 DEVPLAN 1207

PROPOSED SIGNS PENDING CODE AND PERMITTING  
**CANOPY**

**RECEIVED**  
 DEC 07 2018  
 PLANNING &  
 DESIGN SERVICES

**SCOPE OF WORK**

**C CANOPY**

- \*Remove existing canopy signs and repair the canopy if applicable
- \*Install 48" tri color non illuminated ACM on all elevations. 344 linear ft.
- \*Install (2) new illuminated Circle K channel letter canopy signs
- \* Wordmark 1 on the Front elevation Left justified
- \* Wordmark 2 on Left elevation Left justified
- \*If the existing canopy does not have electricity to the existing wordmarks; Circle K to install electricity prior to installation of new canopy material
- \*Install new blue unleaded face on existing price changer with red digits.
- \*Install new green diesel face on existing price changer with green digits.
- \*Install with toggle on the unleaded panels using flat faces on both price changers.
- \*Paint retainers and cabinets white

**EXISTING**



NOTE: CANOPY MATERIAL IS 48". CORNERS OF THE ACM SHOULD BE WRAPPED WHILE INSTALLING.

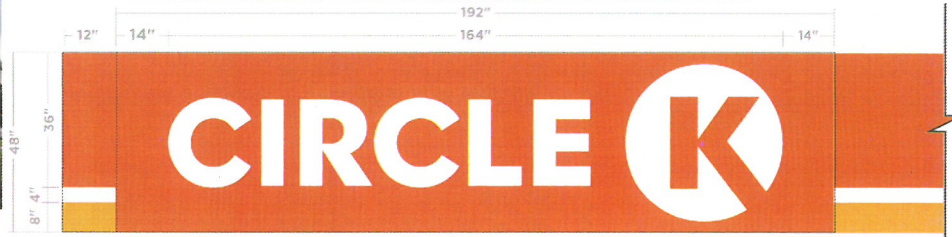

42" Wordmark on center canopy  
 48" Tall Panel

Scale: 3/8" = 1'-0"  
 64.0 SQ. FT.

**PROPOSED**



TOTAL OF 344 LINEAR FT. OF ACM PANELS

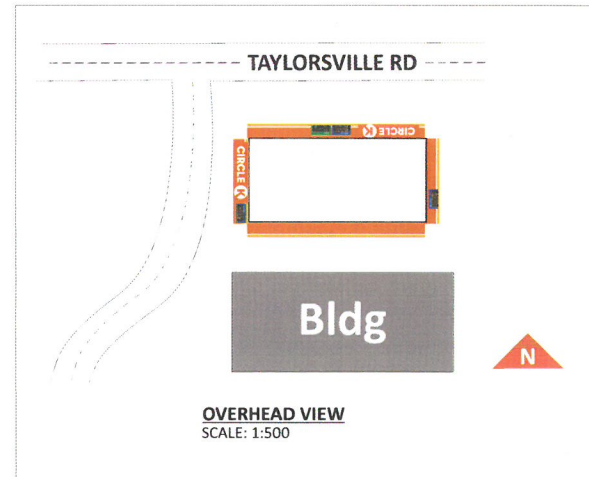

Note: Size of signage in relation to the building is approximate. This photo mock-up is intended for location purposes only and may not accurately represent the scale of the proposed signage to the building. A site survey is required.

**Project ID**  
 DB5-21555

Date: 09/05/18  
 Scale: as noted  
 Sales: A. Nabors  
 Designer: J. Piquero

Rev. #: xx  
 Date: xx-xx-xxxx

Revision Note:

---

**Conceptual**

Information Required:

---

**Master**

**Electrical**

120V  347V  
 Other

---

**Customer Approval**

Signature \_\_\_\_\_  
 MM/DD/YYYY

It is the Customer's responsibility to ensure that the structure of the building is designed and constructed to accept the installation of the signs being ordered. Please ask PSG to provide further details if required.

All rights reserved. The artwork depicted herein are copyright and are the exclusive property of Pattison Sign Group and as such cannot be reproduced in whole or in part without written permission by Pattison Sign Group.

---

CK #4703312  
 Taylorsville Rd  
 Louisville, KY 40299

---

**Sign Item**  
 Canopy

18 DEVPLAN 1207

PROPOSED SIGNS PENDING CODE AND PERMITTING

CANOPY

EXISTING



RECEIVED  
 DEC 07 2018  
 PLANNING &  
 DESIGN SERVICES

PROPOSED



TOTAL OF 344 LINEAR FT. OF ACM PANELS

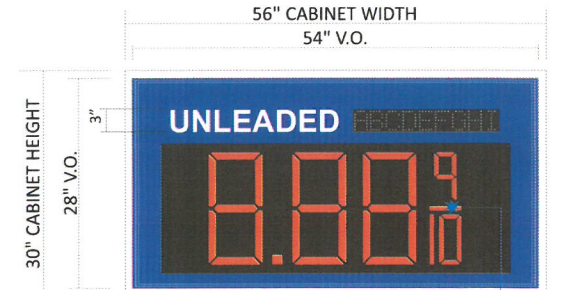

SCALE: 3/4"=1'  
 FLAT FACE  
 11.67 SQ.FT.

15" ABLE LED'S  
 1" RETAINERS

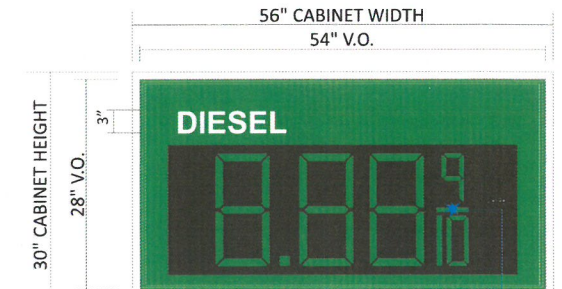

SCALE: 3/4"=1'  
 FLAT FACE  
 11.67 SQ.FT.

15" ABLE LED'S  
 1" RETAINERS

Project ID

DB5-21555

Date: 09/05/18  
 Scale: as noted  
 Sales: A. Nabors  
 Designer: J. Piquero

Rev. #: xx  
 Date: xx-xx-xxxx

Revision Note:

Conceptual

Information Required:

Master

Electrical

120V  347V

Other \_\_\_\_\_

Customer Approval

Signature \_\_\_\_\_

MM/DD/YYYY \_\_\_\_\_

It is the Customer's responsibility to ensure that the structure of the building is designed and constructed to accept the installation of the signs being ordered. Please ask PSG to provide further details if required.

All rights reserved. The artwork depicted herein are copyright and are the exclusive property of Pattison Sign Group and as such cannot be reproduced in whole or in part without written permission by Pattison Sign Group.

CK #4703312  
 Taylorsville Rd  
 Louisville, KY 40299

Sign Item

Canopy



520 West Summit Hill Drive, Suite 702, Knoxville TN, USA 37902  
 (Toll Free) 1.866.635.1110 (Fax) 1.888.694.1106  
 www.pattisonsign.com



This sign to be installed in accordance with the requirements of Article 600 of the National Electrical Code and/or other applicable local codes. This includes proper grounding and bonding of the sign.



Fluorescent, Neon and HID lamps contain Mercury (HG). Dispose of the lamps according to Local, Provincial, State or Federal Laws.

18 DEVPLAN 1207

# PROPOSED SIGNS PENDING CODE AND PERMITTING

## PUMPS

### EXISTING

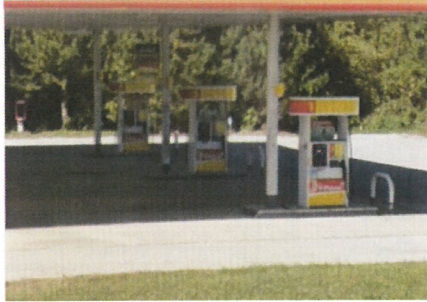

M060\_Column Flag Kit



M061\_Pump Skirt Door Skin



Dashed Line Indicates Visual Area of 30"W x 38"H  
Logo Size: 18.71"W x 7.5"H  
.97 Sq. Ft.

M063\_Decal Pump Spreaders/Valence



# of Unleaded pumps on site: 5  
.97 Sq. Ft.

**SCOPE OF WORK**

**D DISPENSER & FORECOURT FOR CANOPY**

- \*Reimage 8 unleaded dispensers to fuel brand specifications
- \*Install 16 pump flags and graphics to fuel brand specifications
- \*Replace 4 trash cans to fuel brand specifications;
- Circle K - Gray #758703- Double-sided Waste 'N Wipe Service Center, 40-gallon - 1x per dispenser \*Paint 8 bollards to fuel brand specifications;
- SW #6236 Grays Harbor \*Paint 8 columns to fuel brand specifications;
- SW #6236 Grays Harbor \* from grade to 24" above grade and RAL9016 Shell Warm White ; from gray to bottom of canopy
- \*Paint 4 Islands to fuel brand specifications;
- SW #6236 Grays Harbor



## DISPENSER

### Project ID

DB5-21555

Date: 09/05/18  
Scale: as noted  
Sales: A. Nabors  
Designer: J. Piquero

Rev. #: xx  
Date: xx-xx-xxxx

Revision Note:

### Conceptual

Information Required:

### Master

### Electrical

120V  347V  
 Other \_\_\_\_\_

### Customer Approval

Signature \_\_\_\_\_  
MM/DD/YYYY

It is the Customer's responsibility to ensure that the structure of the building is designed and constructed to accept the installation of the signs being ordered. Please ask PSG to provide further details if required.

All rights reserved. The artwork depicted herein are copyright and are the exclusive property of Pattison Sign Group and as such cannot be reproduced in whole or in part without written permission by Pattison Sign Group.

CK #4703312  
Taylorsville Rd  
Louisville, KY 40299

### Sign Item

Note: Size of signage in relation to the surrounding area is approximate. This photo mock-up is intended for location purposes only. A site survey is required.



520 West Summit Hill Drive, Suite 702, Knoxville TN, USA 37902  
(Toll Free) 1.866.635.1110 (Fax) 1.888.694.1106  
www.pattisongroup.com



This sign to be installed in accordance with the requirements of Article 600 of the National Electrical Code and/or other applicable local codes. This includes proper grounding and bonding of the sign.



Fluorescent, Neon and HID lamps contain Mercury (HG). Dispose of the lamps according to Local, Provincial, State or Federal Laws.

18 DEVPLAN 12 07

PROPOSED SIGNS PENDING CODE AND PERMITTING  
**ADDITIONAL SIGNAGE**

**EXISTING**

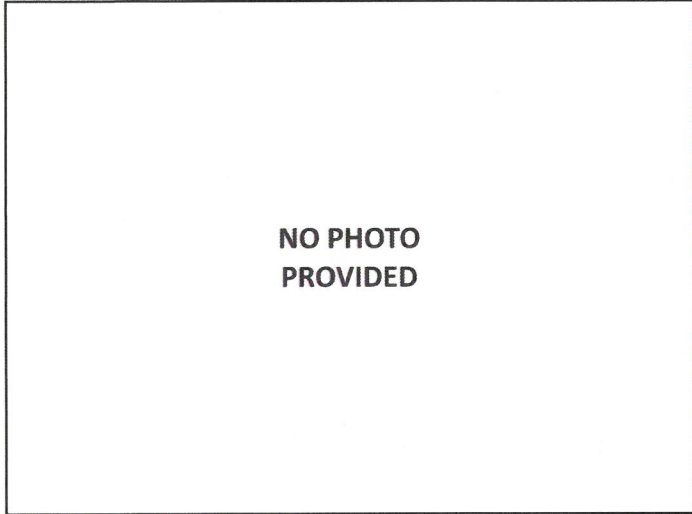

SCOPE OF WORK	
E Additional	*Remove any existing Circle K logos and repair any existing area where the logos were installed if needed (ie: ghosting or glue residue) *Install new Circle K ID decals over existing Circle K logos *Paint the dumpster enclosures to the Circle K building paint specifications *Paint the storage building to the Circle K building paint specifications *Install new Circle K ID decals on the AIR/VAC machine, propane

<b>Project ID</b>	
DB5-21555	
Date:	09/05/18
Scale:	as noted
Sales:	A. Nabors
Designer:	J. Piquero
Rev. #:	xx
Date:	XX-XX-XXXX
Revision Note:	
<input checked="" type="checkbox"/> <b>Conceptual</b> Information Required:	
<input type="checkbox"/> <b>Master</b> <input checked="" type="checkbox"/> <b>Electrical</b> 120V <input type="checkbox"/> 347V Other _____	

RECEIVED  
 DEC 07 2018  
 PLANNING &  
 DESIGN SERVICES

<b>Customer Approval</b>	
Signature _____	
MM/DD/YYYY _____	

It is the Customer's responsibility to ensure that the structure of the building is designed and constructed to accept the installation of the signs being ordered. Please ask PSG to provide further details if required.

All rights reserved. The artwork depicted herein are copyright and are the exclusive property of Pattison Sign Group and as such cannot be reproduced in whole or in part without written permission by Pattison Sign Group.

Note: Size of signage in relation to the surrounding area is approximate. This photo mock-up is intended for location purposes only. A site survey is required.

**ADDITIONAL**

CK #4703312 Taylorsville Rd Louisville, KY 40299
<b>Sign Item</b>
Additional



520 West Summit Hill Drive, Suite 702, Knoxville TN, USA 37902  
 (Toll Free) 1.866.635.1110 (Fax) 1.888.694.1106  
 www.pattisonsign.com



This sign to be installed in accordance with the requirements of Article 600 of the National Electrical Code and/or other applicable local codes. This includes proper grounding and bonding of the sign.



Fluorescent, Neon and HID lamps contain Mercury (HG). Dispose of the lamps according to Local, Provincial, State or Federal Laws.

18 DEVPLAN 1207