

PETER & NORMA DAKIN

15111 Abington Ridge Place, Lake Forest, Louisville Kentucky 40245-5269 U.S.A.

Peter@Dakin.US Cel: 502-232-5090

Norma@Dakin.US Cel: 502-245-1195

David Wagner & Tammy Markert.
Department of Planning & Design Services,
Louisville, Jefferson County,
444 South 5th Street,
Louisville KY 40202-2343

22nd July 2015

Tel: 502-574-6230

e-mail: david.wagner@louisvilleky.gov
e-mail: Tammy.Markert@LouisvilleKY.gov

Good morning:

Project 15DEVPLAN 1042 - Bush Farm Retirement Community, Lake Forest Location.

On attending your Planning Meeting on the 7/15/2015 at 514 West Liberty I heard ideas on the project access and the difference between Arnold Palmer or Bush Farm main access.

I also heard a traffic study was suggested.

Well I know one can count traffic volume passing on a road, but I am ignorant if such surveys record the standing time of traffic and how it blocks access.

At 9 AM this morning I drove the open down Bush Farm Road to the Old Henry Stop light and one car came up behind me just as the light changed. No Bush Farm traffic problem.

Yesterday 7:45 AM to 8:00 AM I took a series of photographs to show the standing traffic on Bush Farm (east to west) Road that shows like other rush hour times of the day how impossible it is for a vehicle to turn into the standing traffic until an opening is made for the drive to turn North on to the planned Community Center Lot, or the difficulty of exiting from the Community Center Lot during these high traffic load times.

From the photographer position a full view of the first 150+/- yards of Arnold Palmer junction onto Old Henry, at no time did any of the one or two vehicles approaching Old Henry on Arnold Palmer have any delay other than the formal stop and immediate movement on to Old Henry.

I am sure your formal traffic study will show volume, and I trust times, but I thought you may wish to have these advance photos. Showing how the Bush Farm Traffic comes over the hill down to Old Henry Stop Light.

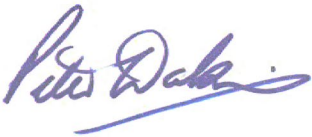

Peter@Dakin.US

Cel: +1-502-232-5090

Copy: J. Kent Gootee, A.S.L.A.
Mindel Scott & Associates Inc.
5151 Jefferson Boulevard,
Louisville, KY 40219-3209

Four Photos Bush Farm Road included.

Tel: 502-485-1508
e-mail: KGootee@MindelScott.com

15 DEL RAN 1042
Photo A

BUSH KAREN ROAD
7.45-8.00 AM *

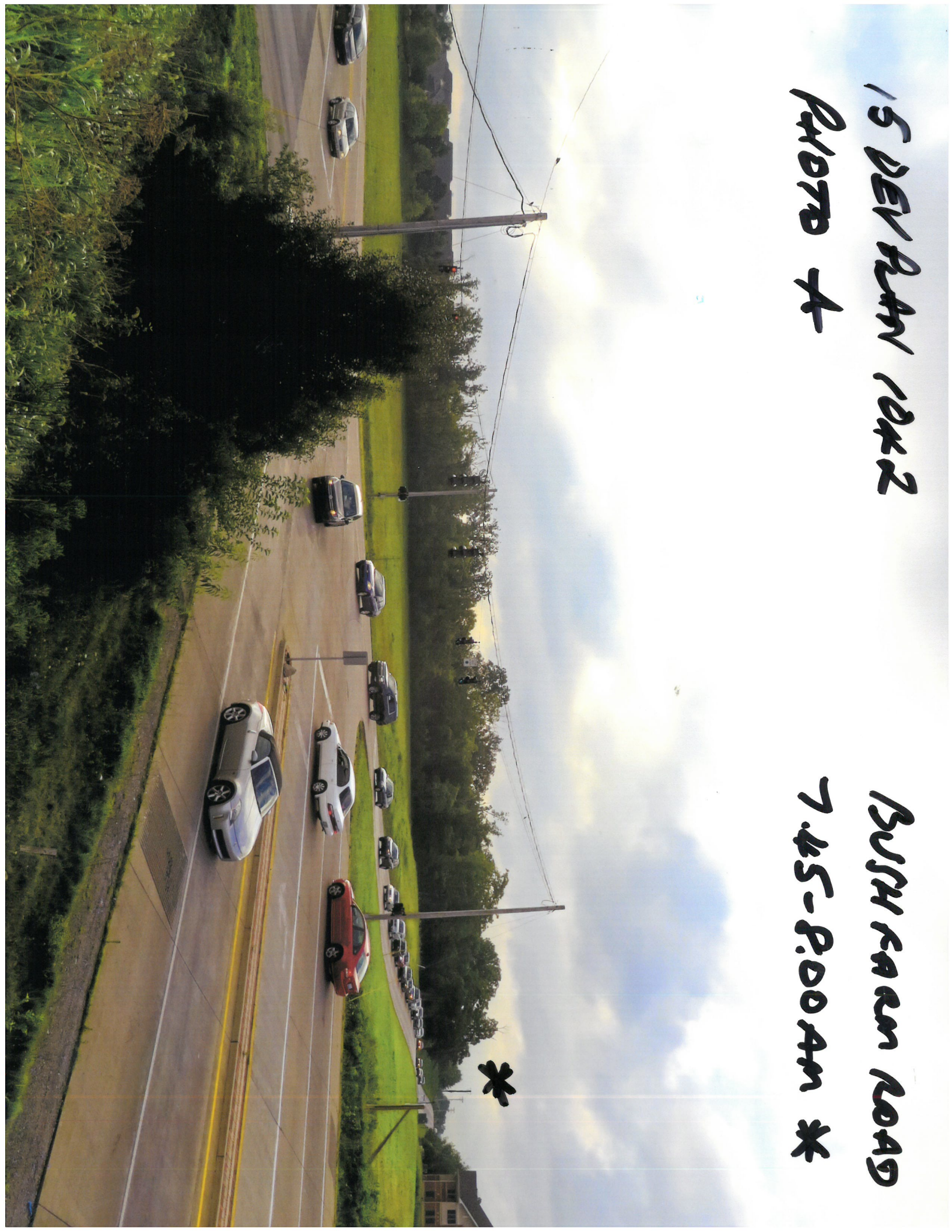

15 DEVLIN 1042
PHOTO B

7.45-8.00 BUS 4
FARM ROAD

EMERSON

OKT HENRY

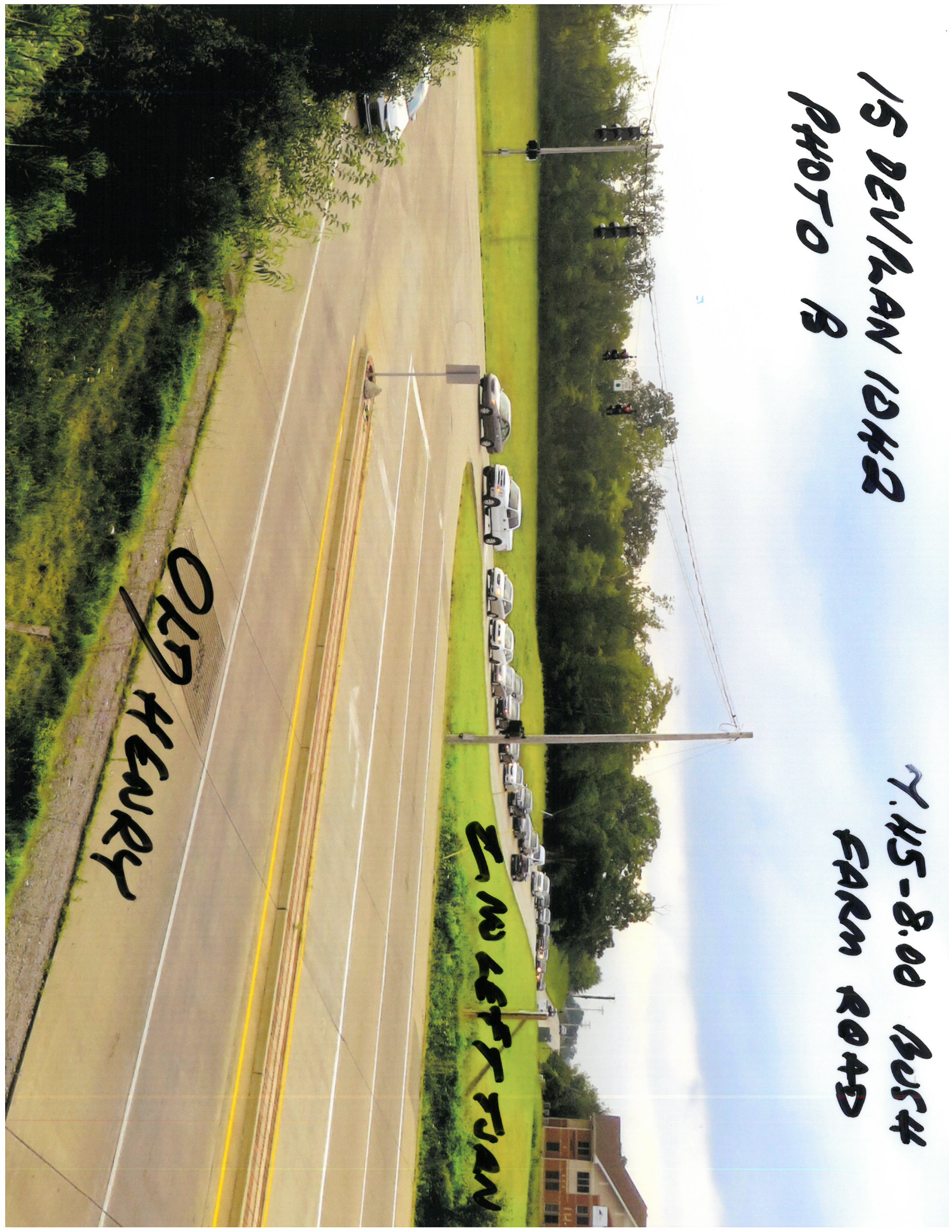

15 DEER HORN 10412
P41070 C

7.45-8.00 AM BUSH
FARM ROAD CONSTRUCTION
TRAFFIC FLOOD

ARNOLO PALMER
NO DEER FOR
ONE OR TWO
CARS EXITS
ARNOLO PALMER

OKO HENRY

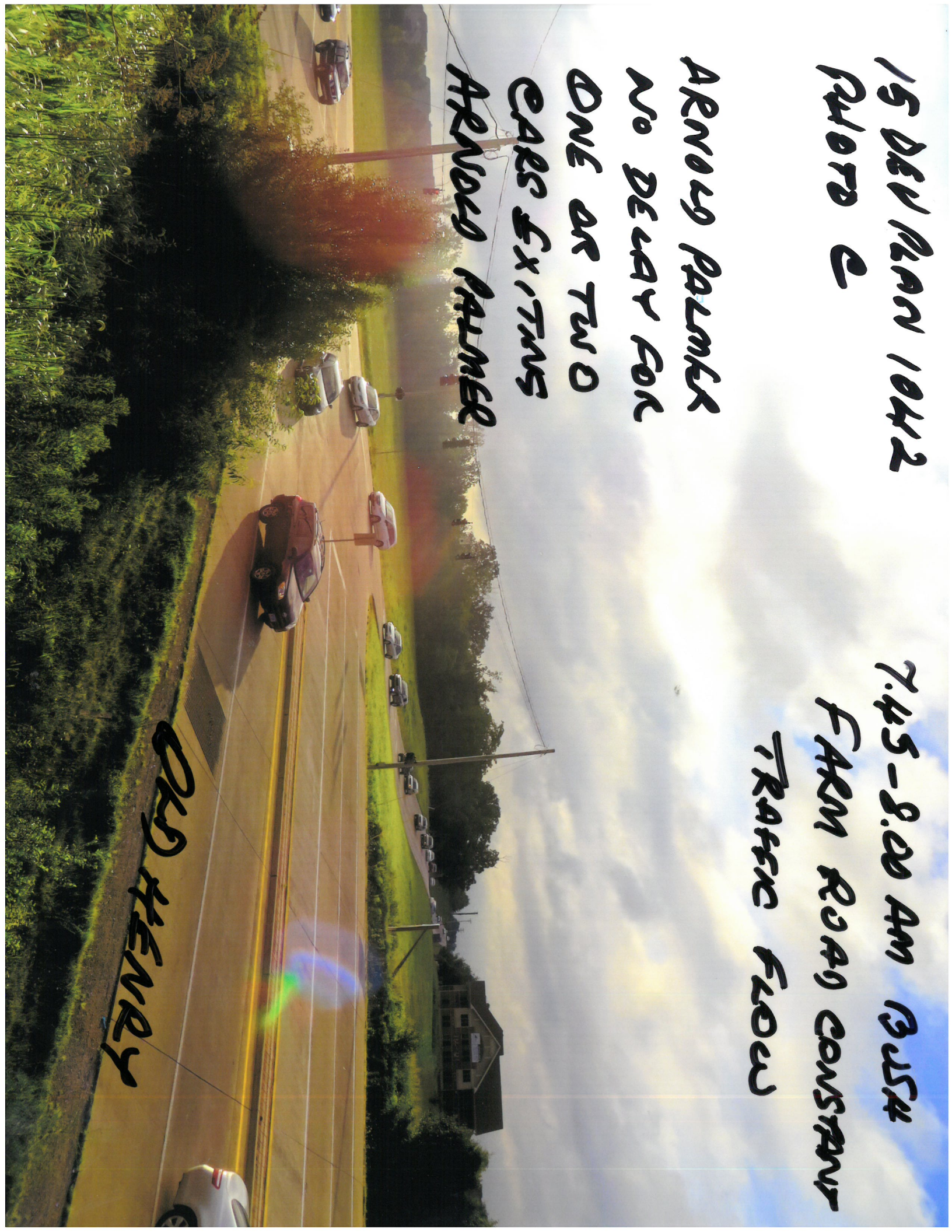

TAKE MORE THAN
ONE CAR HERE

7.45-8.00 AM OLD HENRY
JUNCTIONS AROUND PALMER
AND BUSH FARM ROAD

HENRY PALMER

PHOTO D. 15 SEPTEMBER 1942.

BUSH FARM RD

OLD HENRY

