

Planning Commission

Staff Report

August 21st, 2014



Case No:	14ZONE1011
Request:	Rezoning from C-1 to C-2 and a Detailed District Development Plan
Project Name:	Derby LLC Auto
Location:	5010 Poplar Level Road
Owner(s):	Derby LLC
Applicant:	Derby LLC
Representative(s):	John Miller, Miller Wihry
Jurisdiction:	Louisville Metro
Council District:	2 – Barbara Shanklin
Case Manager:	Christopher Brown, Planner II

REQUEST

- Change in zoning from C-1 to C-2
- Variance #1: Variance from Chapter 5.3.2.C.2.b of the Land Development Code to allow pavement to encroach 10' into the required 25' setback along the rear property adjacent to residential use
- Waiver #1: Waiver from Chapter 10.2.4 of the Land Development Code to allow pavement to encroach 10' into the required 25' landscape buffer area adjacent to residential use
- Detailed District Development plan

CASE SUMMARY/BACKGROUND/SITE CONTEXT

Existing Zoning District: C-1
Proposed Zoning District: C-2
Existing Form District: Suburban Marketplace Corridor
Existing Use: Auto Repair
Proposed Use: Auto Repair and Automobile Sales
Minimum Parking Spaces Required: 9
Maximum Parking Spaces Required: 15
Parking Spaces Proposed: 9
Plan Certain Docket #: None

The proposal is for a change in zoning of the existing lot on the west side of Poplar Level Road to expand the uses to include automobile sales. The existing use on the site is an automobile repair shop. The existing structures and parking area will be utilized on the site. The property is in a mixed commercial portion of the Poplar Level Road corridor containing C-2 to the north and C-1 to the south, east and west. The C-1 zoned property to the west is a residentially used property. The residential use of this commercial property along the rear property perimeter requires a 25' non-residential to residential setback as well as a 25' landscape buffer area. Existing pavement currently encroaches in these areas and will be utilized for the proposed uses on the site.

LAND USE/ZONING DISTRICT/FORM DISTRICT TABLE

	Land Use	Zoning	Form District
Subject Property			
Existing	Auto Repair	C-1	SMC
Proposed	Auto Repair & Automobile Sales	C-2	SMC
Surrounding Properties			
North	Entrance to Apartments	C-1	SMC
South	Convenience Store	C-1	SMC
East	Liquor Store	C-1	SMC
West	Apartments	C-1	SMC

PREVIOUS CASES ON SITE

There are no previous related cases or open code enforcement cases.

INTERESTED PARTY COMMENTS

None received.

APPLICABLE PLANS AND POLICIES

- Cornerstone 2020
- Land Development Code

STANDARD OF REVIEW FOR REZONING AND FORM DISTRICT CHANGES

Criteria for granting the proposed form district change/rezoning: KRS Chapter 100.213

1. The proposed form district/rezoning change complies with the applicable guidelines and policies Cornerstone 2020; **OR**
2. The existing form district/zoning classification is inappropriate and the proposed classification is appropriate; **OR**
3. There have been major changes of an economic, physical, or social nature within the area involved which were not anticipated in Cornerstone 2020 which have substantially altered the basic character of the area.

STAFF ANALYSIS FOR REZONING AND FORM DISTRICT CHANGES

Following is staff's analysis of the proposed rezoning against the Guidelines and Policies of Cornerstone 2020.

The site is located in the Suburban Marketplace Corridor Form District

Suburban Marketplace Corridors: Suburban Marketplace Corridors are generally located along major roadways with well-defined beginning and ending points and established depths along the length of the corridor. The pattern of development is distinguished by a mixture of medium to high intensity uses. Accommodations for transit users, bicyclists and pedestrians are encouraged in an effort to attract a variety of users as well as to minimize automobile dependency and traffic congestion. Connectivity to nearby uses should be encouraged. Developers should be encouraged to design new commercial development in compact groups of buildings, which use the same curb cut, share parking, have a common freestanding sign identifying the uses and have a common buffering or streetscape plan with

respect to any abutting uses of lower density or intensity. This form may include medium to high-density residential uses that are designed to be compatible with both the non-residential uses along the corridor and the lower density residential uses in adjacent form districts. Medium density residential uses may serve as a transition area from lower to higher density residential uses and should be encouraged in this form.

Proposed new commercial uses are encouraged, to locate within the boundaries of existing corridors. Reuse of locations within existing corridors is preferred over expansion of a corridor. Proposals to expand defined corridors represent significant policy decisions. When considering proposals that result in an extension of suburban marketplace corridors, particular emphasis should be placed on: (a) use or reuse of land within existing corridors; (b) potential for disruption of established residential neighborhoods; and (c) compliance with the site and community design standards of the Land Development Code.

The proposal to rezone the subject site from C-1 to C-2, Commercial, will allow the proposed uses to be accommodated on the existing subject site. The existing commercial site is in a corridor of existing mixed commercial uses along Poplar Level Road. The applicant has demonstrated that the proposed C-2 zoning district will comply with **Guideline 1, Community Form**, since the proposal is an existing use with existing structures on the site in the area of mixed commercial along this portion of the Poplar Level Road corridor and it is fully located within the boundaries of the existing form district.

The applicant has demonstrated that the proposed C-2 zoning district will comply with **Guideline 3, Compatibility** with the appropriate transitions and buffering being provided adjacent to surrounding street frontages and the residential use to the rear. The reduced buffer and setback will utilize existing pavement on the site while providing code complaint screening and plantings to meet the intent of the landscape buffer and setback. It is a compatible use to the area by locating the higher density zoning along a major arterial corridor with existing activity.

The proposal complies with the natural areas guidelines of the Comprehensive Plan under **Guideline 5, Natural Areas and Scenic and Historic Resources** by not affecting any known historical resources, adding plantings along the western property perimeter to create a more natural area and reuse of the existing structures on the site.

The proposal complies with the guidelines of the Comprehensive Plan under **Guideline 6, Economic Growth and Sustainability** since it is located in an area of commercial activity with direct connectivity to a major arterial.

The proposal provides for appropriate multi-modal transportation facilities following the Comprehensive Plan under **Guidelines 7 and 8, Circulation and Transportation Facility Design** with pedestrian connectivity from the existing sidewalk network along Poplar Level Road. The applicant needs to address cross access and connectivity to the adjacent commercial use to the south. The proposal meets the parking needs of the proposed use and utilizes a portion of the existing curb cut and a second existing curb cut to be removed to allow better access management along the Poplar Level Road corridor.

All other agency comments should be addressed to demonstrate compliance with the remaining Guidelines and Policies of Cornerstone 2020.

A checklist is attached to the end of this staff report with a more detailed analysis. The Louisville Metro Planning Commission is charged with making a recommendation to the Louisville Metro Council regarding the appropriateness of this zoning map amendment. The Louisville Metro Council has zoning authority over the property in question.

STANDARD OF REVIEW AND STAFF ANALYSIS FOR DDDP and BINDING ELEMENTS

- a. The conservation of natural resources on the property proposed for development, including: trees and other living vegetation, steep slopes, water courses, flood plains, soils, air quality, scenic views, and historic sites;

STAFF: The site will reduce portions of existing pavement along the west property perimeter and add tree plantings to address the issue of natural resources.

- b. The provisions for safe and efficient vehicular and pedestrian transportation both within the development and the community;

STAFF: The provisions for safe and efficient vehicular and pedestrian transportation both within the development and the community are addressed by the reduction of a curb cut, restoring sidewalk and connection from the existing sidewalk into the site. The applicant needs to address issues of cross access and vehicular connectivity between the commercial uses to the south.

- c. The provision of sufficient open space (scenic and recreational) to meet the needs of the proposed development;

STAFF: Open space is not required for the development.

- d. The provision of adequate drainage facilities on the subject site in order to prevent drainage problems from occurring on the subject site or within the community;

STAFF: The Metropolitan Sewer District has approved the preliminary development plan and will ensure the provisions of adequate drainage facilities on the subject site in order to prevent drainage problems from occurring on the subject site or within the community.

- e. The compatibility of the overall site design (location of buildings, parking lots, screening, landscaping) and land use or uses with the existing and projected future development of the area;

STAFF: The overall site design and land uses are compatible with the existing and future development of the area. Appropriate landscape buffering and screening will be provided to screen adjacent properties and roadways. Buildings and parking lots will meet all required setbacks with the exception of the non-residential to residential setback to the rear which follows the existing built pattern on the subject site.

- f. Conformance of the development plan with the Comprehensive Plan and Land Development Code. Revised plan certain development plans shall be evaluated for conformance with the non-residential and mixed-use intent of the form districts and comprehensive plan.

STAFF: The development plan conforms to applicable guidelines and policies of the Comprehensive Plan and to requirements of the Land Development Code with the exception of the requested waiver and variance which follow the guidelines of Cornerstone 2020.

STANDARD OF REVIEW AND STAFF ANALYSIS FOR VARIANCES

- (a) The requested variance will not adversely affect the public health, safety or welfare.

STAFF: The requested variance will not adversely affect the public health, safety or welfare since it follows the existing pattern established on the site and along the commercial corridor.

- (b) The requested variance will not alter the essential character of the general vicinity.

STAFF: The requested variance will not alter the essential character of the general vicinity since it will maintain the existing setback on the site.

- (c) The requested variance will not cause a hazard or nuisance to the public.

STAFF: The requested variance will not cause a hazard or nuisance to the public since screening and planting material will mitigate the encroachment of the auto storage area along the western property perimeter adjacent to the residential use.

- (d) The requested variance will not allow an unreasonable circumvention of the zoning regulations.

STAFF: The requested variance will not allow an unreasonable circumvention of the zoning regulations since the pattern of encroachment existed on the site prior to the current request.

ADDITIONAL CONSIDERATIONS:

1. The requested variance arises from special circumstances which do not generally apply to land in the general vicinity or the same zone.

STAFF: The requested variance arises from special circumstances which do not generally apply to land in the general vicinity or the same zone since the adjacent properties are both commercially zoned and the areas are both for vehicular parking or storage.

2. The strict application of the provisions of the regulation would deprive the applicant of the reasonable use of the land or create an unnecessary hardship on the applicant.

STAFF: The strict application of the provisions of the regulation would deprive the applicant of the reasonable use of the land or create an unnecessary hardship on the applicant by reducing the area needed for automobile storage associated with the auto repair garage.

3. The circumstances are the result of actions of the applicant taken subsequent to the adoption of the zoning regulation from which relief is sought.

STAFF: The circumstances are not the result of actions of the applicant taken subsequent to the adoption of the zoning regulation from which relief is sought since it existed prior to the current request.

STANDARD OF REVIEW AND STAFF ANALYSIS FOR WAIVERS

- (a) The waiver will not adversely affect adjacent property owners; and

STAFF: The waiver will not adversely affect adjacent property owners since the required screening and planting materials will be provided along the rear property perimeter.

- (b) The waiver will not violate specific guidelines of Cornerstone 2020; and

STAFF: Guideline 3, policy 9 of Cornerstone 2020 calls for the protection of the character of residential areas, roadway corridors and public spaces from visual intrusions and mitigate when appropriate. Guideline 3, policies 21 and 22 calls for appropriate transitions between uses that are substantially different in scale and intensity or density, and to mitigate the impact caused when incompatible developments occur adjacent to one another through the use of landscaped buffer yards, vegetative berms and setback requirements to address issues such as outdoor lighting, lights from automobiles,

illuminated signs, loud noise, odors, smoke, automobile exhaust or other noxious smells, dust and dirt, litter, junk, outdoor storage, and visual nuisances. Guideline 3, policy 24 states that parking, loading and delivery areas located adjacent to residential areas should be designed to minimize the impacts from noise, lights and other potential impacts, and that parking and circulation areas adjacent to streets should be screened or buffered. Guideline 13, policy 4 calls for ensuring appropriate landscape design standards for different land uses within urbanized, suburban, and rural areas. Guideline 13, Policy 6 calls for screening and buffering to mitigate adjacent incompatible uses. The intent of landscape buffer areas is to create suitable transitions where varying forms of development adjoin, to minimize the negative impacts resulting from adjoining incompatible land uses, to decrease storm water runoff volumes and velocities associated with impervious surfaces, and to filter air borne and water borne pollutants. The intent of the buffer will be met with area as shown on the development plan by providing the required screening and planting materials to create appropriate separation between the uses; therefore, the waiver will not violate specific guidelines of Cornerstone 2020.

- (c) The extent of the waiver of the regulation is the minimum necessary to afford relief to the applicant; and

STAFF: The extent of the waiver of the regulation is the minimum necessary to afford relief to the applicant since to allow the needed automobile storage area while providing sufficient buffering between the uses.

- (d) Either:

(i) The applicant has incorporated other design measures that exceed the minimums of the district and compensate for non-compliance with the requirements to be waived (net beneficial effect); OR
(ii) The strict application of the provisions of the regulation would deprive the applicant of the reasonable use of the land or would create an unnecessary hardship on the applicant.

STAFF: The strict application of the provisions of the regulation would deprive the applicant of the reasonable use of the land or would create an unnecessary hardship on the applicant by requiring extensive pavement removal along the rear of the existing buildings and extensive reduction of the area needed for automobile storage.

TECHNICAL REVIEW

No technical review comments need to be addressed.

STAFF CONCLUSIONS

The proposed change in zoning from C-1 to C-2 meets the majority of the guidelines of the Comprehensive Plan. The issue of cross access and connectivity between commercial properties needs to be addressed. The variance meets the standard of review as proposed. The landscape waiver allows for adequate storage area to be provided while meeting the intent of the buffer with the required planting and screening materials. Based upon the information in the staff report, the testimony and evidence provided at the public hearing, the Planning Commission must determine if the proposal is in conformance with the Comprehensive Plan; OR the existing form district/zoning classification is inappropriate and the proposed classification is appropriate; OR if there have been major changes of an economic, physical, or social nature within the area involved which were not anticipated in Cornerstone 2020 which have substantially altered the basic character of the area. Based upon the information in the staff report, the testimony and evidence provided at the public hearing, the Planning Commission must determine if the proposal meets the standards for granting a Landscape Waiver, Variance and Detailed District Development Plan as established in the Land Development Code.

NOTIFICATION

Date	Purpose of Notice	Recipients
7/10/14	Hearing before LD&T	1 st and 2 nd tier adjoining property owners Speakers at Planning Commission public hearing Subscribers of Council District 2 Notification of Development Proposals
8/8/2014	Hearing before PC / BOZA	1 st and 2 nd tier adjoining property owners Speakers at Planning Commission public hearing Subscribers of Council District 2 Notification of Development Proposals
	Hearing before PC / BOZA	Sign Posting on property
	Hearing before PC / BOZA	Legal Advertisement in the Courier-Journal

ATTACHMENTS

1. Zoning Map
2. Aerial Photograph
3. Cornerstone 2020 Checklist
4. Proposed Binding Elements

1. Zoning Map

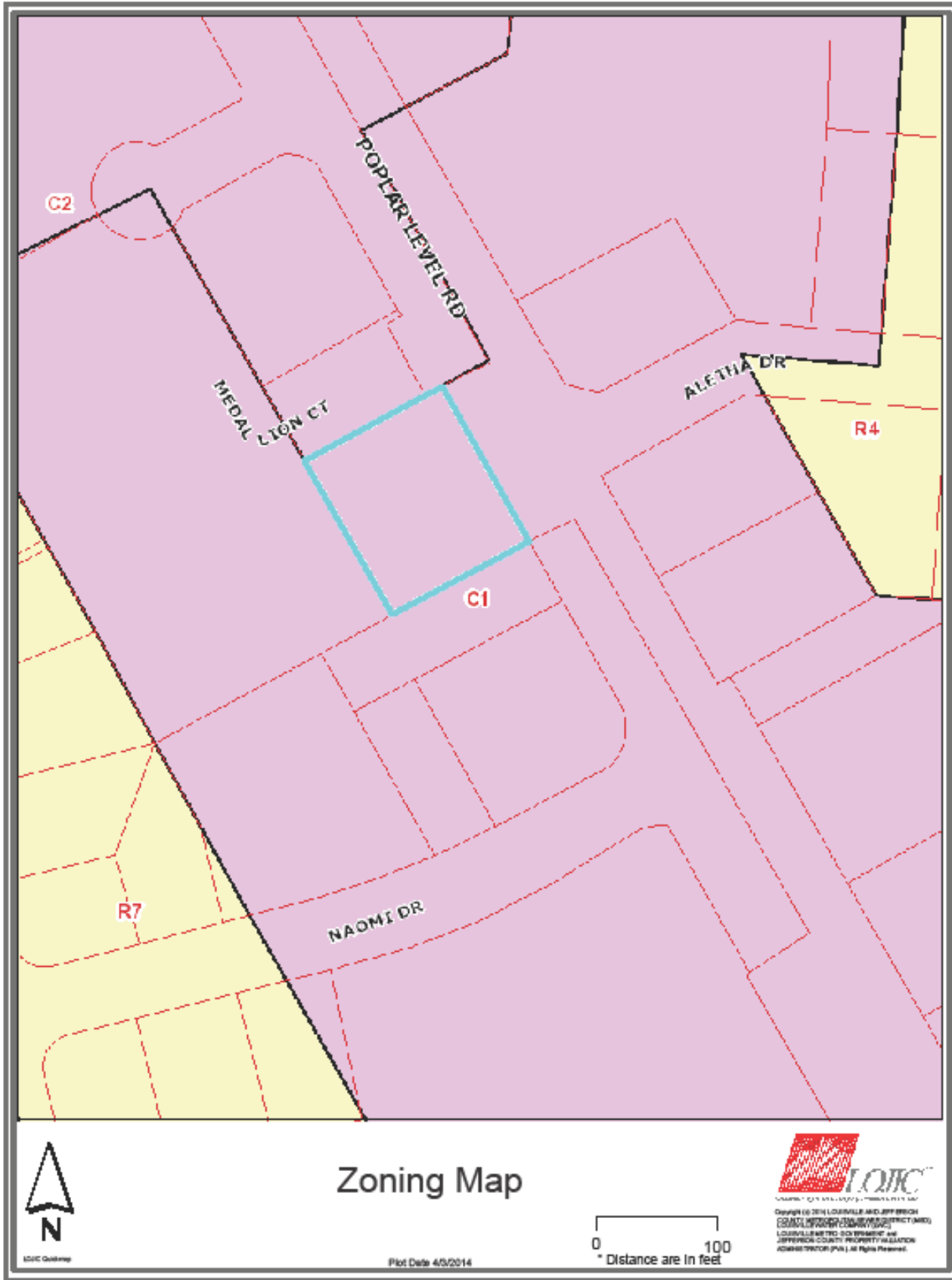

2. Aerial Photograph



3. Cornerstone 2020 Staff Checklist

- + Meets Guideline
- √ Meets Guideline
- +/- More Information Needed
- NA Not Applicable

#	Cornerstone 2020 Guidelines & Policies	Cornerstone 2020 Plan Element	Plan Element or Portion of Plan Element	Final Finding	Final Comments
1	Form District Goals F1, F2, F3, F4, Objectives F1.1, F2.1-2.5, F3.1-3.2, F4.1-4.5	Community Form/Land Use Guideline 1: Community Form	B.8: The proposal integrates into the existing pattern of development, which includes a mixture of medium-to high-density uses.	√	The proposal is an existing use with existing structures on the site in the area of mixed commercial along this portion of the Poplar Level Road corridor.
2	Form District Goals F1, F2, F3, F4, Objectives F1.1, F2.1-2.5, F3.1-3.2, F4.1-4.5	Community Form/Land Use Guideline 1: Community Form	B.8: The proposal provides accommodations for transit users, pedestrians and bicyclists and provides connectivity to adjacent developments.	√	There are existing sidewalks along the property frontage that accommodate pedestrian traffic through the area and a connection to be provided that allows connectivity into the site. No transit routes exist along this portion of Poplar Level Road.
3	Form District Goals F1, F2, F3, F4, Objectives F1.1, F2.1-2.5, F3.1-3.2, F4.1-4.5	Community Form/Land Use Guideline 1: Community Form	B.8: The proposal includes a compact group of buildings using the same curb cut, parking and signs, and that have a common buffering or streetscape plan with respect to any abutting lower density or intensity uses.	√	The proposal utilizes existing structures on the site as well as the same access and parking area. The curb cuts will be reduced from two to one. Buffering and screening will be provided along the street frontage.
4	Form District Goals F1, F2, F3, F4, Objectives F1.1, F2.1-2.5, F3.1-3.2, F4.1-4.5	Community Form/Land Use Guideline 1: Community Form	B.8: The proposal is of a medium to high density designed to be compatible with both non-residential development in the corridor and adjacent low density residential development in other form districts.	√	The proposal is higher density commercial in an area of mixed commercial along the corridor. A 15' LBA and setback will be provided along the residential to the west with appropriate planting and screening to mitigate the reduction.
5	Form District Goals F1, F2, F3, F4, Objectives F1.1, F2.1-2.5, F3.1-3.2, F4.1-4.5	Community Form/Land Use Guideline 1: Community Form	B.8: The proposal is located within the boundaries of the existing form district, and if the proposal is to expand an existing corridor, the justification for doing so addresses the use or reuse of land within the existing corridor, the potential for disruption of established residential neighborhoods, and compliance with the site and community design standards of the Land Development Code.	√	The proposal is within the boundaries of the existing form district.
6	Form District Goals F1, F2, F3, F4, Objectives F1.1, F2.1-2.5, F3.1-3.2, F4.1-4.5	Community Form/Land Use Guideline 2: Centers	A.1/7: The proposal, which will create a new center, is located in the Suburban Marketplace Corridor Form District, and includes new construction or the reuse of existing buildings to provide commercial, office and/or residential use.	√	The proposal will not create a new center but is for the reuse of an existing structure.
7	Form District Goals F1, F2, F3, F4, Objectives F1.1, F2.1-2.5, F3.1-3.2, F4.1-4.5	Community Form/Land Use Guideline 2: Centers	A.3: The proposed retail commercial development is located in an area that has a sufficient population to support it.	√	The proposal is located the SMC which has enough local and regional connections to support it.

#	Cornerstone 2020 Guidelines & Policies	Cornerstone 2020 Plan Element	Plan Element or Portion of Plan Element	Final Finding	Final Comments
8	Form District Goals F1, F2, F3, F4, Objectives F1.1, F2.1-2.5, F3.1-3.2, F4.1-4.5	Community Form/Land Use Guideline 2: Centers	A.4: The proposed development is compact and results in an efficient land use pattern and cost-effective infrastructure investment.	√	The proposed commercial zoning adjacent to M-2 is an efficient land use pattern as the infrastructure is already established.
9	Form District Goals F1, F2, F3, F4, Objectives F1.1, F2.1-2.5, F3.1-3.2, F4.1-4.5	Community Form/Land Use Guideline 2: Centers	A.5: The proposed center includes a mix of compatible land uses that will reduce trips, support the use of alternative forms of transportation and encourage vitality and sense of place.	NA	The proposal is not for a center.
10	Form District Goals F1, F2, F3, F4, Objectives F1.1, F2.1-2.5, F3.1-3.2, F4.1-4.5	Community Form/Land Use Guideline 2: Centers	A.6: The proposal incorporates residential and office uses above retail and/or includes other mixed-use, multi-story retail buildings.	-	The proposal does not include residential.
11	Form District Goals F1, F2, F3, F4, Objectives F1.1, F2.1-2.5, F3.1-3.2, F4.1-4.5	Community Form/Land Use Guideline 2: Centers	A.12: If the proposal is a large development in a center, it is designed to be compact and multi-purpose, and is oriented around a central feature such as a public square or plaza or landscape element.	NA	The proposal is not a large development.
12	Form District Goals F1, F2, F3, F4, Objectives F1.1, F2.1-2.5, F3.1-3.2, F4.1-4.5	Community Form/Land Use Guideline 2: Centers	A.13/15: The proposal shares entrance and parking facilities with adjacent uses to reduce curb cuts and surface parking, and locates parking to balance safety, traffic, transit, pedestrian, environmental and aesthetic concerns.	-	The proposal does not share entrances with adjacent uses.
13	Form District Goals F1, F2, F3, F4, Objectives F1.1, F2.1-2.5, F3.1-3.2, F4.1-4.5	Community Form/Land Use Guideline 2: Centers	A.14: The proposal is designed to share utility hookups and service entrances with adjacent developments, and utility lines are placed underground in common easements.	√	The proposal utilizes existing utilities in the area.
14	Form District Goals F1, F2, F3, F4, Objectives F1.1, F2.1-2.5, F3.1-3.2, F4.1-4.5	Community Form/Land Use Guideline 2: Centers	A.16: The proposal is designed to support easy access by bicycle, car and transit and by pedestrians and persons with disabilities.	√	The proposal provides a marked pedestrian connection from the street frontage to the use to allow easy access from the existing sidewalk network.
15	Form District Goals F1, F2, F3, F4, Objectives F1.1, F2.1-2.5, F3.1-3.2, F4.1-4.5	Community Form/Land Use Guideline 3: Compatibility	A.2: The proposed building materials increase the new development's compatibility.	√	No new building is proposed.
16	Form District Goals F1, F2, F3, F4, Objectives F1.1, F2.1-2.5, F3.1-3.2, F4.1-4.5	Community Form/Land Use Guideline 3: Compatibility	A.4/5/6/7: The proposal does not constitute a non-residential expansion into an existing residential area, or demonstrates that despite such an expansion, impacts on existing residences (including traffic, parking, signs, lighting, noise, and odor and storm water) are appropriately mitigated.		The proposal is an existing site within the existing non-residential area along the mixed commercial corridor of Poplar Level Road. There is an existing residential area to the west which will be appropriately buffered and the location of existing pavement mitigated through planting and screening materials to be provided.

#	Cornerstone 2020 Guidelines & Policies	Cornerstone 2020 Plan Element	Plan Element or Portion of Plan Element	Final Finding	Final Comments
17	Form District Goals F1, F2, F3, F4, Objectives F1.1, F2.1-2.5, F3.1-3.2, F4.1-4.5	Community Form/Land Use Guideline 3: Compatibility	A.5: The proposal mitigates any potential odor or emissions associated with the development.	√	APCD has approved the proposal.
18	Form District Goals F1, F2, F3, F4, Objectives F1.1, F2.1-2.5, F3.1-3.2, F4.1-4.5	Community Form/Land Use Guideline 3: Compatibility	A.6: The proposal mitigates any adverse impacts of its associated traffic on nearby existing communities.	√	The proposal mitigates any adverse impacts of its associated traffic on nearby existing communities.
19	Form District Goals F1, F2, F3, F4, Objectives F1.1, F2.1-2.5, F3.1-3.2, F4.1-4.5	Community Form/Land Use Guideline 3: Compatibility	A.8: The proposal mitigates adverse impacts of its lighting on nearby properties, and on the night sky.	√	Lighting will comply with the Land Development Code.
20	Form District Goals F1, F2, F3, F4, Objectives F1.1, F2.1-2.5, F3.1-3.2, F4.1-4.5	Community Form/Land Use Guideline 3: Compatibility	A.11: If the proposal is a higher density or intensity use, it is located along a transit corridor AND in or near an activity center.	√	The proposal is located within an activity center along the Poplar Level Road major arterial corridor.
21	Form District Goals F1, F2, F3, F4, Objectives F1.1, F2.1-2.5, F3.1-3.2, F4.1-4.5	Community Form/Land Use Guideline 3: Compatibility	A.21: The proposal provides appropriate transitions between uses that are substantially different in scale and intensity or density of development such as landscaped buffer yards, vegetative berms, compatible building design and materials, height restrictions, or setback requirements.	√	There is an existing residential area to the west which will be appropriately buffered and the location of existing pavement mitigated through planting and screening materials to be provided.
22	Form District Goals F1, F2, F3, F4, Objectives F1.1, F2.1-2.5, F3.1-3.2, F4.1-4.5	Community Form/Land Use Guideline 3: Compatibility	A.22: The proposal mitigates the impacts caused when incompatible developments unavoidably occur adjacent to one another by using buffers that are of varying designs such as landscaping, vegetative berms and/or walls, and that address those aspects of the development that have the potential to adversely impact existing area developments.	√	There is an existing residential area to the west which will be appropriately buffered and the location of existing pavement mitigated through planting and screening materials to be provided.
23	Form District Goals F1, F2, F3, F4, Objectives F1.1, F2.1-2.5, F3.1-3.2, F4.1-4.5	Community Form/Land Use Guideline 3: Compatibility	A.23: Setbacks, lot dimensions and building heights are compatible with those of nearby developments that meet form district standards.	√	The existing pavement is located within the required non-residential to residential setback along the rear but it follows the established pattern along the commercial corridor of reduced rear yard setbacks.
24	Form District Goals F1, F2, F3, F4, Objectives F1.1, F2.1-2.5, F3.1-3.2, F4.1-4.5	Community Form/Land Use Guideline 3: Compatibility	A.24: Parking, loading and delivery areas located adjacent to residential areas are designed to minimize adverse impacts of lighting, noise and other potential impacts, and that these areas are located to avoid negatively impacting motorists, residents and pedestrians.	√	The auto storage areas adjacent to the residential use along the western property perimeter will be mitigated using planting and screening materials.

#	Cornerstone 2020 Guidelines & Policies	Cornerstone 2020 Plan Element	Plan Element or Portion of Plan Element	Final Finding	Final Comments
25	Form District Goals F1, F2, F3, F4, Objectives F1.1, F2.1-2.5, F3.1-3.2, F4.1-4.5	Community Form/Land Use Guideline 3: Compatibility	A.24: The proposal includes screening and buffering of parking and circulation areas adjacent to the street, and uses design features or landscaping to fill gaps created by surface parking lots. Parking areas and garage doors are oriented to the side or back of buildings rather than to the street.	√	Buffering is proposed along the street frontage but no interior landscaping is incorporated into the lot. Interior landscaping is not required per the Land Development Code due to the minimal changes on the site.
26	Form District Goals F1, F2, F3, F4, Objectives F1.1, F2.1-2.5, F3.1-3.2, F4.1-4.5	Community Form/Land Use Guideline 3: Compatibility	A.25: Parking garages are integrated into their surroundings and provide an active, inviting street-level appearance.	NA	A parking garage is not proposed.
27	Form District Goals F1, F2, F3, F4, Objectives F1.1, F2.1-2.5, F3.1-3.2, F4.1-4.5	Community Form/Land Use Guideline 3: Compatibility	A.28: Signs are compatible with the form district pattern and contribute to the visual quality of their surroundings.	√	Non LDC compliant signage is to be removed on the site.
28	Livability Goals H3 and H5, all related objectives	Community Form/Land Use Guideline 4: Open Space	A.2/3/7: The proposal provides open space that helps meet the needs of the community as a component of the development and provides for the continued maintenance of that open space.	NA	No open space requirements.
29	Livability Goals H3 and H5, all related objectives	Community Form/Land Use Guideline 4: Open Space	A.4: Open space design is consistent with the pattern of development in the Neighborhood Form District.	NA	No open space requirements.
30	Livability Goals H3 and H5, all related objectives	Community Form/Land Use Guideline 4: Open Space	A.5: The proposal integrates natural features into the pattern of development.	√	There are no natural features evident on the redeveloped site.
31	Livability Goals H3 and H5, all related objectives	Community Form/Land Use Guideline 5: Natural Areas and Scenic and Historic Resources	A.1: The proposal respects the natural features of the site through sensitive site design, avoids substantial changes to the topography and minimizes property damage and environmental degradation resulting from disturbance of natural systems.	√	There are no natural features evident on the redeveloped site.
32	Livability Goals H3 and H5, all related objectives	Community Form/Land Use Guideline 5: Natural Areas and Scenic and Historic Resources	A.2/4: The proposal includes the preservation, use or adaptive reuse of buildings, sites, districts and landscapes that are recognized as having historical or architectural value, and, if located within the impact area of these resources, is compatible in height, bulk, scale, architecture and placement.	√	The proposed Zone Change will not affect any known cultural or historic resources

#	Cornerstone 2020 Guidelines & Policies	Cornerstone 2020 Plan Element	Plan Element or Portion of Plan Element	Final Finding	Final Comments
33	Livability Goals H3 and H5, all related objectives	Community Form/Land Use Guideline 5: Natural Areas and Scenic and Historic Resources	A.6: Encourage development to avoid wet or highly permeable soils, severe, steep or unstable slopes with the potential for severe erosion.	√	Soils are not an issue with the site.
34	People, Jobs and Housing Goal K4, Objective K4.1	Marketplace Guideline 6: Economic Growth and Sustainability	A.3: Encourage redevelopment, reinvestment and rehabilitation in the downtown where it is consistent with the form district pattern.	NA	The proposal is not located within a downtown.
35	Marketplace Strategy Goal A1, Objectives A1.3, A1.4, A1.5	Marketplace Guideline 6: Economic Growth and Sustainability	A.4: Encourage industries to locate in industrial subdivisions or adjacent to existing industry to take advantage of special infrastructure needs.	NA	The proposal is not for industrial.
36	Land Use and Transportation Connection Goal E1, Objectives E1.1 and E1.3	Marketplace Guideline 6: Economic Growth and Sustainability	A.6: Locate retail commercial development in activity centers. Locate uses generating large amounts of traffic on a major arterial, at the intersection of two minor arterials or at locations with good access to a major arterial and where the proposed use will not adversely affect adjacent areas.	√	The proposal is located along a major arterial.
37	Land Use and Transportation Connection Goal E1, Objectives E1.1 and E1.3	Marketplace Guideline 6: Economic Growth and Sustainability	A.8: Require industrial development with more than 100 employees to locate on or near an arterial street, preferably in close proximity to an expressway interchange. Require industrial development with less than 100 employees to locate on or near an arterial street.	NA	The proposal is not for industrial.
38	Mobility Goals A1-A6, B1, C1, D1, E1, E2, F1, G1, H1-H4, I1-I7, all related Objectives	Mobility/Transportation Guideline 7: Circulation	A.1/2: The proposal will contribute its proportional share of the cost of roadway improvements and other services and public facilities made necessary by the development through physical improvements to these facilities, contribution of money, or other means.	√	The proposal will reduce the number of curb cuts and restore the entrance to sidewalk with curb.
39	Mobility Goals A1-A6, B1, C1, D1, E1, E2, F1, G1, H1-H4, I1-I7, all related Objectives	Mobility/Transportation Guideline 7: Circulation	A.3/4: The proposal promotes mass transit, bicycle and pedestrian use and provides amenities to support these modes of transportation.	√	The proposal has existing sidewalks along the street frontage and will provide a marked pedestrian connection from the street frontage to the building being used on the site. No transit corridors exist along the street frontage.
40	Mobility Goals A1-A6, B1, C1, D1, E1, E2, F1, G1, H1-H4, I1-I7, all related Objectives	Mobility/Transportation Guideline 7: Circulation	A.6: The proposal's transportation facilities are compatible with and support access to surrounding land uses, and contribute to the appropriate development of adjacent lands. The proposal includes at least one continuous roadway through the development, adequate street stubs, and relies on cul-de-sacs only as short side streets or where natural features limit	-	The proposal needs to support better access to the commercial property along the southern property perimeter.

#	Cornerstone 2020 Guidelines & Policies	Cornerstone 2020 Plan Element	Plan Element or Portion of Plan Element	Final Finding	Final Comments
			development of "through" roads.		
41	Mobility Goals A1-A6, B1, C1, D1, E1, E2, F1, G1, H1-H4, I1-I7, all related Objectives	Mobility/Transportation Guideline 7: Circulation	A.9: The proposal includes the dedication of rights-of-way for street, transit corridors, bikeway and walkway facilities within or abutting the development.	√	The proposal includes the removal of an entrance.
42	Mobility Goals A1-A6, B1, C1, D1, E1, E2, F1, G1, H1-H4, I1-I7, all related Objectives	Mobility/Transportation Guideline 7: Circulation	A.10: The proposal includes adequate parking spaces to support the use.	√	The proposal provides adequate parking for the proposed use.
43	Mobility Goals A1-A6, B1, C1, D1, E1, E2, F1, G1, H1-H4, I1-I7, all related Objectives	Mobility/Transportation Guideline 7: Circulation	A.13/16: The proposal provides for joint and cross access through the development and to connect to adjacent development sites.	-	The proposal needs to provide cross access.
44	Mobility Goals A1-A6, B1, C1, D1, E1, E2, F1, G1, H1-H4, I1-I7, all related Objectives	Mobility/Transportation Guideline 8: Transportation Facility Design	A.8: Adequate stub streets are provided for future roadway connections that support and contribute to appropriate development of adjacent land.	NA	A new road is not proposed.
45	Mobility Goals A1-A6, B1, C1, D1, E1, E2, F1, G1, H1-H4, I1-I7, all related Objectives	Mobility/Transportation Guideline 8: Transportation Facility Design	A.9: Avoid access to development through areas of significantly lower intensity or density if such access would create a significant nuisance.	√	Access to the development is from a major arterial.
46	Mobility Goals A1-A6, B1, C1, D1, E1, E2, F1, G1, H1-H4, I1-I7, all related Objectives	Mobility/Transportation Guideline 8: Transportation Facility Design	A.11: The development provides for an appropriate functional hierarchy of streets and appropriate linkages between activity areas in and adjacent to the development site.	NA	A new road is not proposed.
47	Mobility Goals A1-A6, B1, C1, D1, E1, E2, F1, G1, H1-H4, I1-I7, all related Objectives	Mobility/Transportation Guideline 9: Bicycle, Pedestrian and Transit	A.1/2: The proposal provides, where appropriate, for the movement of pedestrians, bicyclists and transit users around and through the development, provides bicycle and pedestrian connections to adjacent developments and to transit stops, and is appropriately located for its density and intensity.	√	The proposal has existing sidewalks along the street frontage and will provide a marked pedestrian connection from the street frontage to the building being used on the site. No transit corridors exist along the street frontage.

#	Cornerstone 2020 Guidelines & Policies	Cornerstone 2020 Plan Element	Plan Element or Portion of Plan Element	Final Finding	Final Comments
48	Livability, Goals B1, B2, B3, B4, Objectives B1.1-1.8, B2.1-2.7, B3.1-3.4, B4.1-4.3	Livability/Environment Guideline 10: Flooding and Stormwater	The proposal's drainage plans have been approved by MSD, and the proposal mitigates negative impacts to the floodplain and minimizes impervious area. Solid blue line streams are protected through a vegetative buffer, and drainage designs are capable of accommodating upstream runoff assuming a fully-developed watershed. If streambank restoration or preservation is necessary, the proposal uses best management practices.	√	MSD has preliminarily approved the proposal.
49	Livability Goals C1, C2, C3, C4, all related Objectives	Livability/Environment Guideline 12: Air Quality	The proposal has been reviewed by APCD and found to not have a negative impact on air quality.	√	APCD has approved the proposal.
50	Livability, Goals F1 and F2, all related objectives	Livability/Environment Guideline 13: Landscape Character	A.3: The proposal includes additions and connections to a system of natural corridors that can provide habitat areas and allow for migration.	√	There are no natural features evident on the redeveloped site.
51	Quality of Life Goal J1, Objectives J1.1-1.2	Community Facilities Guideline 14: Infrastructure	A.2: The proposal is located in an area served by existing utilities or planned for utilities.	√	Existing utilities are available to the site.
52	Quality of Life Goal J1, Objectives J1.1-1.2	Community Facilities Guideline 14: Infrastructure	A.3: The proposal has access to an adequate supply of potable water and water for fire-fighting purposes.	√	Water is available to the site.
53	Quality of Life Goal J1, Objectives J1.1-1.2	Community Facilities Guideline 14: Infrastructure	A.4: The proposal has adequate means of sewage treatment and disposal to protect public health and to protect water quality in lakes and streams.	√	MSD has preliminarily approved the proposal.

4. Proposed Binding Elements

1. The development shall be in accordance with the approved district development plan, all applicable sections of the Land Development Code (LDC) and agreed upon binding elements unless amended pursuant to the Land Development Code. Any changes/additions/alterations of any binding element(s) shall be submitted to the Planning Commission or the Planning Commission's designee for review and approval; any changes/additions/alterations not so referred shall not be valid.
2. No outdoor advertising signs, small freestanding signs, pennants, balloons, or banners shall be permitted on the site.
3. Construction fencing shall be erected when off-site trees or tree canopy exists within 3' of a common property line. Fencing shall be in place prior to any grading or construction to protect the existing root systems from compaction. The fencing shall enclose the entire area beneath the tree canopy and shall

remain in place until all construction is completed. No parking, material storage or construction activities are permitted within the protected area.

4. Before any permit (including but not limited to building, parking lot, change of use, site disturbance, alteration permit or demolition permit) is requested:
 - a. The development plan must receive full construction approval from Louisville Metro Construction Permit Review, Transportation Planning and the Metropolitan Sewer District.
 - b. Encroachment permits must be obtained from the Kentucky Department of Transportation, Bureau of Highways.
 - e. The property owner/developer must obtain approval of a detailed plan for screening (buffering/landscaping) as described in Chapter 10 prior to requesting a building permit. Such plan shall be implemented prior to occupancy of the site and shall be maintained thereafter.
5. A certificate of occupancy must be received from the appropriate code enforcement department prior to occupancy of the structure or land for the proposed use. All binding elements requiring action and approval must be implemented prior to requesting issuance of the certificate of occupancy, unless specifically waived by the Planning Commission.
6. The applicant, developer, or property owner shall provide copies of these binding elements to tenants, purchasers, contractors, subcontractors and other parties engaged in development of this site and shall advise them of the content of these binding elements. These binding elements shall run with the land and the owner of the property and occupant of the property shall at all times be responsible for compliance with these binding elements. At all times during development of the site, the applicant and developer, their heirs, successors; and assignees, contractors, subcontractors, and other parties engaged in development of the site, shall be responsible for compliance with these binding elements.