

GENERAL INFORMATION

SITE ADDRESS:
1938 BONNYCASTLE AVE.
LOUISVILLE, KY 40205



OWNER:
1938 BONNYCASTLE, LLC.
615 BRECKENRIDGE LANE
LOUISVILLE, KY 40207

TAX BLOCK AND LOT NUMBER: 766 018

ZONING: RESIDENTIAL

EXISTING USE: RESIDENTIAL

LEGEND

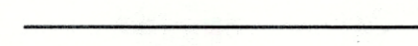
-  PROPERTY LINE
-  BUILDING FOOTPRINT FOR PROJECT
-  ADJACENT BUILDINGS AND STREETS

PROJECT LOCATION



VICINITY MAP

SCALE: NTS

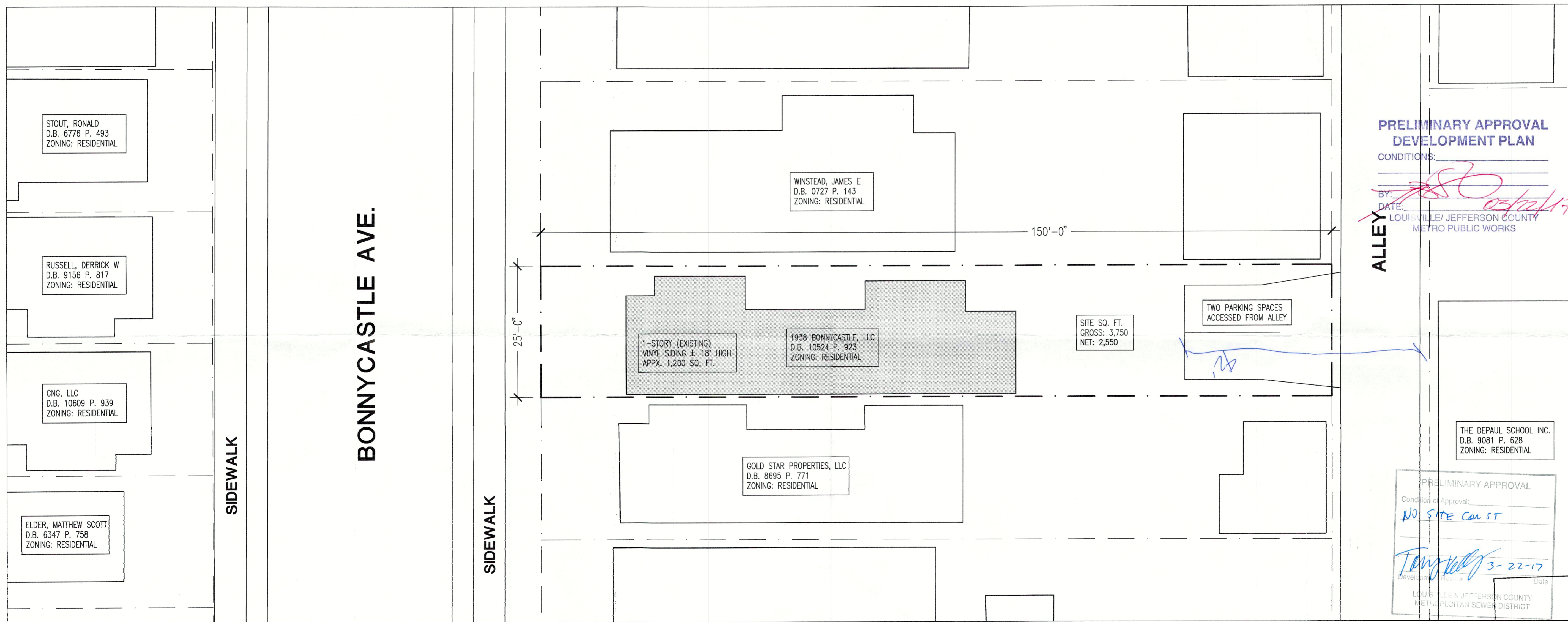
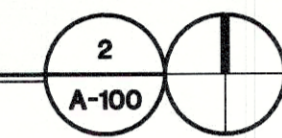

PRELIMINARY APPROVAL DEVELOPMENT PLAN

CONDITIONS:

BY: *[Signature]*
DATE: *08/22/17*
LOUISVILLE/JEFFERSON COUNTY METRO PUBLIC WORKS

ALLEY

THE DEPAUL SCHOOL INC.
D.B. 9081 P. 628
ZONING: RESIDENTIAL

PRELIMINARY APPROVAL
Condition of Approval:
NO SITE CANT
Tangley 3-22-17
LOUISVILLE & JEFFERSON COUNTY METROPOLITAN SEWER DISTRICT

1938 BONNYCASTLE AVE.
LOUISVILLE, KY 40205

| ISSUES AND REVISIONS | MARK | DATE | DESCRIPTION |
|----------------------|------|-------------|----------------------------|
| | | | RECEIVED |
| | | AUG 28 2016 | PLANNING & DESIGN SERVICES |

| | |
|----------------------------|------------------|
| PROJECT NUMBER: | 041-106 |
| DATE: | August 5th, 2016 |
| DRAWN BY: | |
| CHECKED BY: | |
| COPYRIGHT © 2016 PPA, PLLC | |

SITE PLAN
A-100