

# Planning Commission

## Staff Report

May 9, 2019



<b>Case No:</b>	18STREETS1029
<b>Project Name:</b>	2070 Eastern Pky Alley Closure
<b>Location:</b>	Alley south of Eastern Parkway
<b>Owner(s):</b>	Louisville Metro
<b>Applicant:</b>	Laura Jones, Eagle Glen LLC
<b>Jurisdiction:</b>	Louisville Metro
<b>Council District:</b>	8 – Brandon Coan
<b>Case Manager:</b>	Lacey Gabbard, AICP, Planner I

### REQUEST(S)

- Closure of Public Alley

### CASE SUMMARY/BACKGROUND

The applicant is seeking to close an unnamed, approximately 15 foot wide alley. The alley is located behind both 2070 Eastern Parkway and 2081 Sherwood Avenue. There is an existing concrete block garage owned by the applicant that is located in the alley.

### STAFF FINDING

This alley closure request was heard before the Land Development & Transportation Committee on April 25, 2019. The street/alley closure plat is in order and 100% consent from abutting property owners has been received.

### TECHNICAL REVIEW

Louisville Metro Fire District – Louisville Fire Department has no objections to the proposed closure.

E-911/Metro Safe Addressing – MetroSafe has no objections to the proposed closure.

AT&T – PDS staff has not received any formal comments.

MSD – MSD has no objections to the proposed closure.

Louisville Metro Health Department – PDS staff has not received any formal comments.

Louisville Gas & Electric – LG&E has no objections to the proposed closure.

Louisville Water Company – LWC has no objections to the proposed closure.

Louisville Metro Public Works – DPW has no objections to the proposed closure.

Historic Preservation – PDS staff has not received any formal comments.

TARC – PDS staff has not received any formal comments.

KYTC – KYTC provided no comment as the closure does not affect a state road.

Louisville Parks and Recreation - We see no reason this alley should not be closed. The intention in the 1900's was to design a parallel alleyway with Eastern Parkway in order to eliminate the need for driveways. The alley design standard for this stretch of Eastern Parkway was abandoned at some point in time for unknown reasons, which leads us to the small sliver we are left with today.

**INTERESTED PARTY COMMENTS**

Staff has received no comments from interested parties concerning this request.

**REQUIRED ACTIONS**

- **RECOMMEND** that Louisville Metro Council **APPROVE** or **DENY** the closure request.

**NOTIFICATION**

<b>Date</b>	<b>Purpose of Notice</b>	<b>Recipients</b>
<b>4-25-19</b>	Hearing before LD&T	Registered Neighborhood Groups in Council District 8 Notice sent to adjoining property owners.
<b>5-9-19</b>	Hearing before Planning Commission	Registered Neighborhood Groups in Council District 8 Notice sent to adjoining property owners.

**ATTACHMENTS**

1. Zoning Map
2. Aerial Photograph

1. Zoning Map

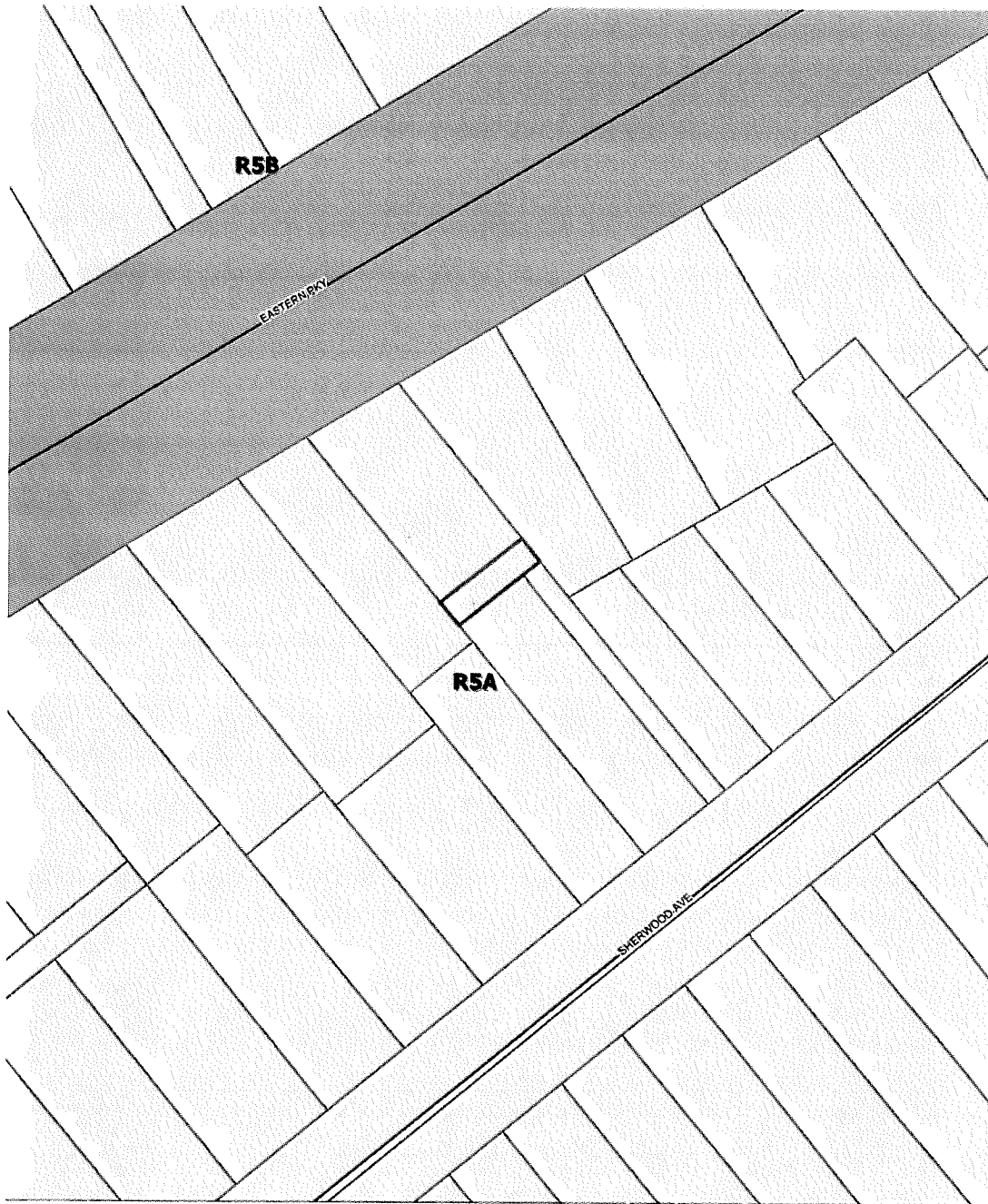

2070 EASTERN PARKWAY

feet

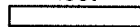

60

Map Created: 4/18/2019



Copyright (c) 2019, LOUISVILLE AND JEFFERSON COUNTY METROPOLITAN SEWER DISTRICT (MSD), LOUISVILLE WATER COMPANY (LWC), LOUISVILLE METRO GOVERNMENT and JEFFERSON COUNTY PROPERTY VALUATION ADMINISTRATOR (PVA). All Rights Reserved.

2. Aerial Photograph



2070 EASTERN PARKWAY

feet



60

Map Created: 4/18/2019



Copyright (c) 2019, LOUISVILLE AND JEFFERSON COUNTY METROPOLITAN SEWER DISTRICT (MSD), LOUISVILLE WATER COMPANY (LWC), LOUISVILLE METRO GOVERNMENT and JEFFERSON COUNTY PROPERTY VALUATION ADMINISTRATOR (PVA). All Rights Reserved

# Land Development and Transportation Committee Staff Report

April 25, 2019



<b>Case No:</b>	18STREETS1029
<b>Project Name:</b>	2070 Eastern Pky Alley Closure
<b>Location:</b>	Alley south of Eastern Parkway
<b>Owner(s):</b>	Louisville Metro
<b>Applicant:</b>	Laura Jones, Eagle Glen LLC
<b>Jurisdiction:</b>	Louisville Metro
<b>Council District:</b>	8 – Brandon Coan
<b>Case Manager:</b>	Lacey Gabbard, AICP, Planner I

## REQUEST(S)

- Closure of Public Alley

## CASE SUMMARY/BACKGROUND

The applicant is seeking to close an unnamed, approximately 15 foot wide alley. The alley is located behind both 2070 Eastern Parkway and 2081 Sherwood Avenue. There is an existing concrete block garage owned by the applicant that is located in the alley.

## STAFF FINDING

The street/alley closure plat is in order and 100% consent from abutting property owners has been received. It is ready to be docketed for the next available Consent Agenda of the Planning Commission.

## TECHNICAL REVIEW

All affected government agencies have been given the opportunity to review the plat. All either gave assent or declined to comment.

## INTERESTED PARTY COMMENTS

Staff has received no comments from interested parties concerning this request.

## REQUIRED ACTIONS

Based upon the information in the staff report, the testimony and evidence provided at the public meeting, the Land Development and Transportation Committee must decide whether this case is ready to be scheduled for a Planning Commission **PUBLIC HEARING, BUSINESS SESSION, or CONSENT AGENDA.**

**NOTIFICATION**

Date	Purpose of Notice	Recipients
4-25-19	Hearing before LD&T	Registered Neighborhood Groups in Council District 8 Notice sent to adjoining property owners.

**ATTACHMENTS**

1. Zoning Map
2. Aerial Photograph

1. Zoning Map

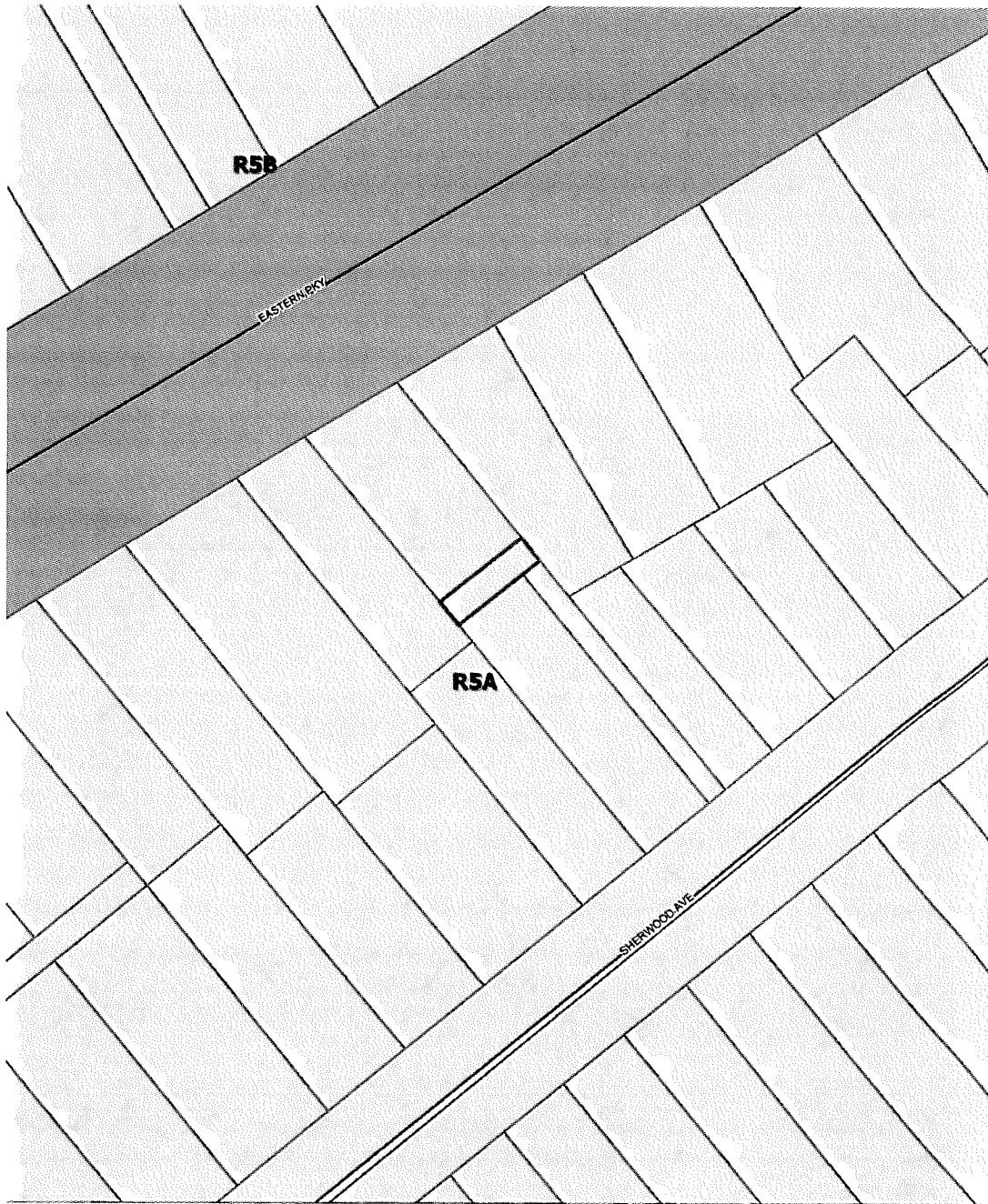

2070 EASTERN PARKWAY

feet

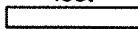

60

Map Created: 4/18/2019



Copyright (c) 2019, LOUISVILLE AND JEFFERSON COUNTY METROPOLITAN SEWER DISTRICT (MSD), LOUISVILLE WATER COMPANY (LWC), LOUISVILLE METRO GOVERNMENT and JEFFERSON COUNTY PROPERTY VALUATION ADMINISTRATOR (PVA). All Rights Reserved.



2. Aerial Photograph



2070 EASTERN PARKWAY  
feet

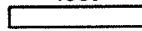

60

Map Created: 4/18/2019



Copyright (c) 2019, LOUISVILLE AND JEFFERSON COUNTY METROPOLITAN SEWER DISTRICT (MSD), LOUISVILLE WATER COMPANY (LWC), LOUISVILLE METRO GOVERNMENT and JEFFERSON COUNTY PROPERTY VALUATION ADMINISTRATOR (PVA). All Rights Reserved