

ISWATHVETK1249

RECEIVED  
MAY 09 2015  
PLANNING &  
DESIGN SERVICES

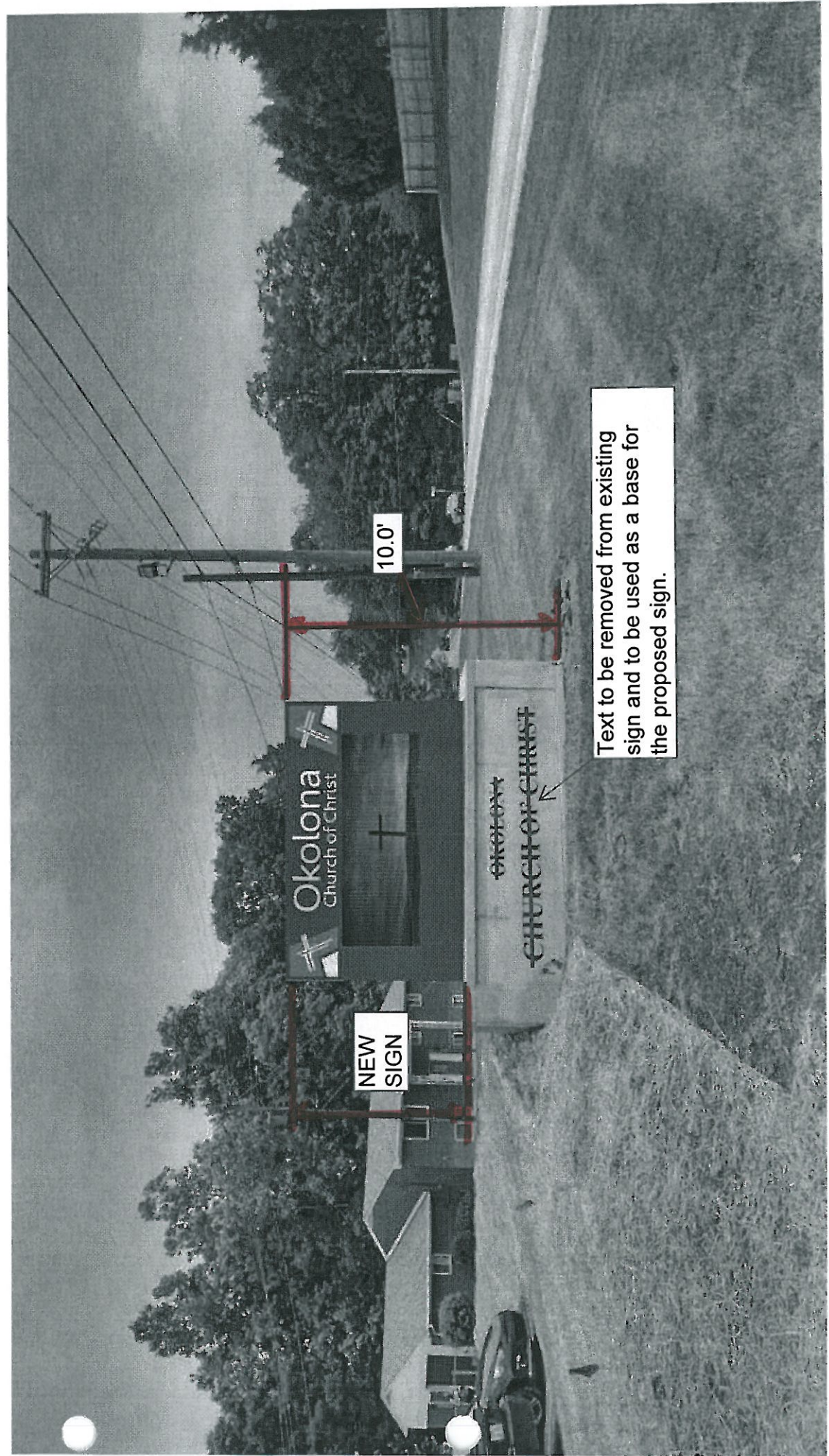

NEW  
SIGN

10.0'

Text to be removed from existing sign and to be used as a base for the proposed sign.

Okolona  
Church of Christ

~~CHURCH OF CHRIST~~

78.75 sqft total

LED SIGN - 23.63 sqft total (30%)

RECEIVED

NCT 09 2015  
PLANNING &  
DESIGN SERVICE

135.00"

26.96"

84.00"

36.95"

20.07"

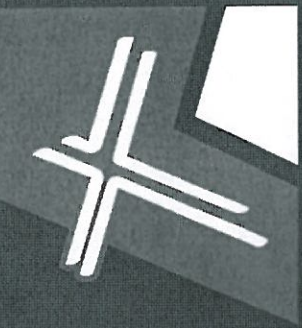

Okolona  
Church of Christ

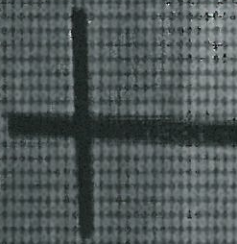

ISMAHVERI029

RECEIVED  
 OCT 09 2015  
 PLANNING &  
 DESIGN SERVICES

SMARTER 2015

- \* MANUFACTURER - GOLDEN RULE SIGNS
- \* 2013 KY STATE BLDG. CODE (2012 IBC)
- \* 115 MPH WIND SPEED, EXP C
- \* (2) POLES, (1) FOOTING

NOTES

1. See manufacturers drawings for additional detail and dimensions.
2. Sign cabinet and connection by others.
3. Design is based on 115 mph 3 sec gust design wind speed per 2013 KY State Bldg. Code (2012 IBC) Exposure C.
4. Spread foundation analysis is based on a safe vertical soil bearing pressure minimum of 2000 psf.  
Soil report was not furnished.  
Allowable bearing pressure should be verified prior to placement of concrete.  
Do not place foundation in fill.
5. Concrete shall be mixed to attain a minimum compressive strength of 3500 psi in 28 days.
6. Support member shall be free from defects and shall meet ASTM A500 grade B with a minimum yield strength of 46000 psi for tube. ASTM A53 grade B with a minimum yield strength of 35000 psi for pipe. Plate and angle shall meet ASTM A36.
7. Structural bolts shall be zinc coated A325 unless otherwise noted.
8. Welds shall be made with E70xx electrodes by persons qualified in accordance with AWS standards within the past two years.
9. Steel reinforcing bars shall conform to ASTM 615 grade 60 with deformations in accordance with ASTM A-305. Welding of reinforcing bars is prohibited.
10. This design is intended to be installed at the location shown below and should not be used at other locations unless deemed suitable by a competent Professional Engineer.

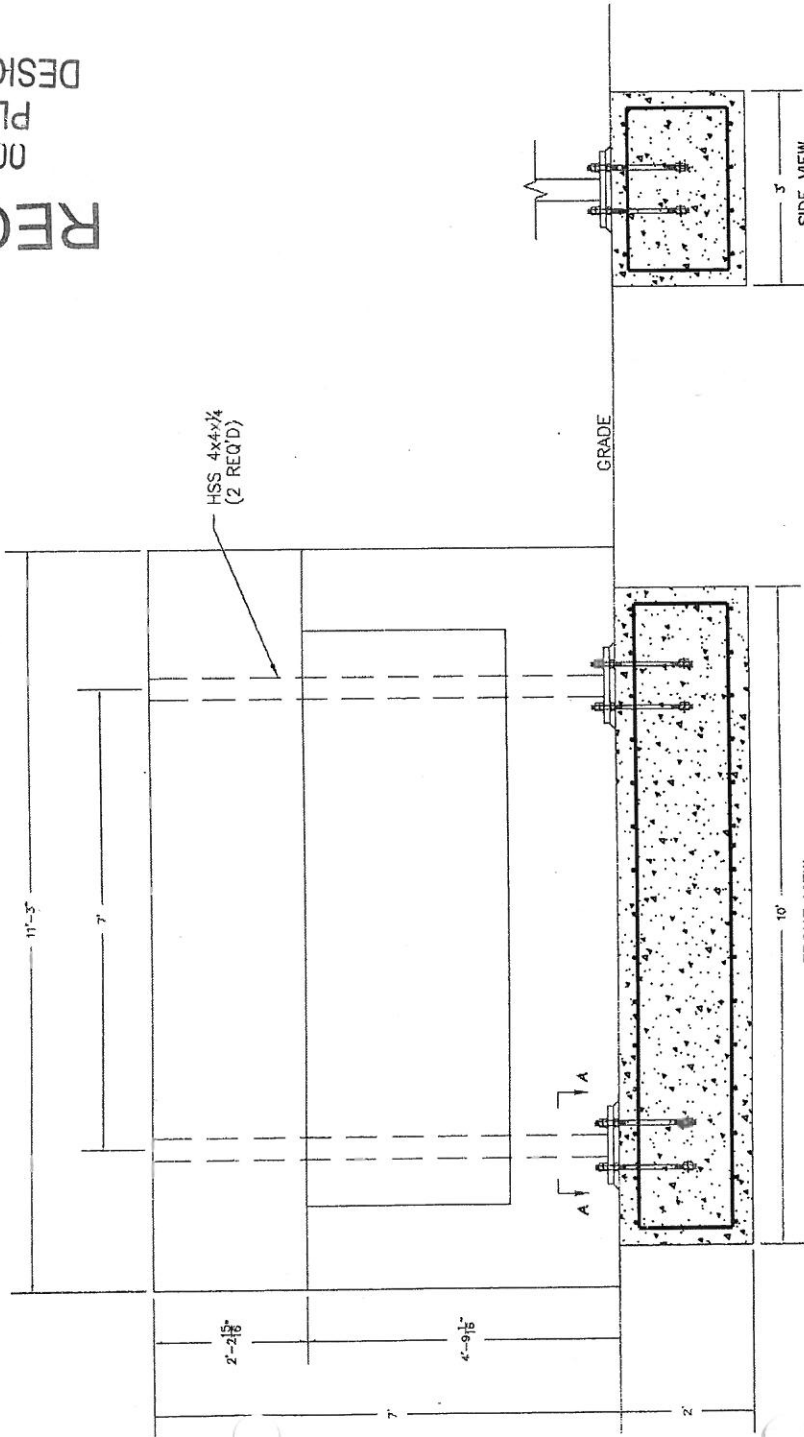

REQUIRED REINFORCEMENT

- #5 BAR VERT. AS REQ'D TO HOLD REBAR MATS IN PLACE
- (15) #5 S.W. T&B
- (4) #5 L.W. T&B

PROJECT NAME: Louisville, KY	DRAWN BY: D.J.B.	PROJECT NO. 150010.01	DATE: 10/8/15	SHT. 1	
DRAWING TITLE: Okolona Church of Christ			REV. # DATE		

9405 - JARROLD Drive  
 Knoxville, TN 37953  
 PHONE: 615 728-8882