

Department/Project:
Department of Public Works/ Bardstown Road LED Streetlight Conversion

Additional Signatures

I have reviewed this request for an expenditure of city tax dollars, and have determined the funds will be used for a public purpose.

Council Member Signature and Amount

District 1	_____	\$ _____
District 2	_____	\$ _____
District 3	_____	\$ _____
District 4	_____	\$ _____
District 5	_____	\$ _____
District 6	_____	\$ _____
District 7	_____	\$ _____
District 8	_____	\$ _____
District 9	_____	\$ _____
District 10	_____	\$ _____
District 11	_____	\$ _____
District 12	_____	\$ _____
District 13	_____	\$ _____
District 14	_____	\$ _____
District 15	_____	\$ _____
District 16	_____	\$ _____
District 17	_____	\$ _____
District 18	_____	\$ _____
District 19	_____	\$ _____
District 20	_____	\$ _____
District 21	_____	\$ _____
District 22	_____	\$ _____
District 23	_____	\$ _____
District 24	_____	\$ _____
District 25	_____	\$ _____
District 26	_____	\$ _____

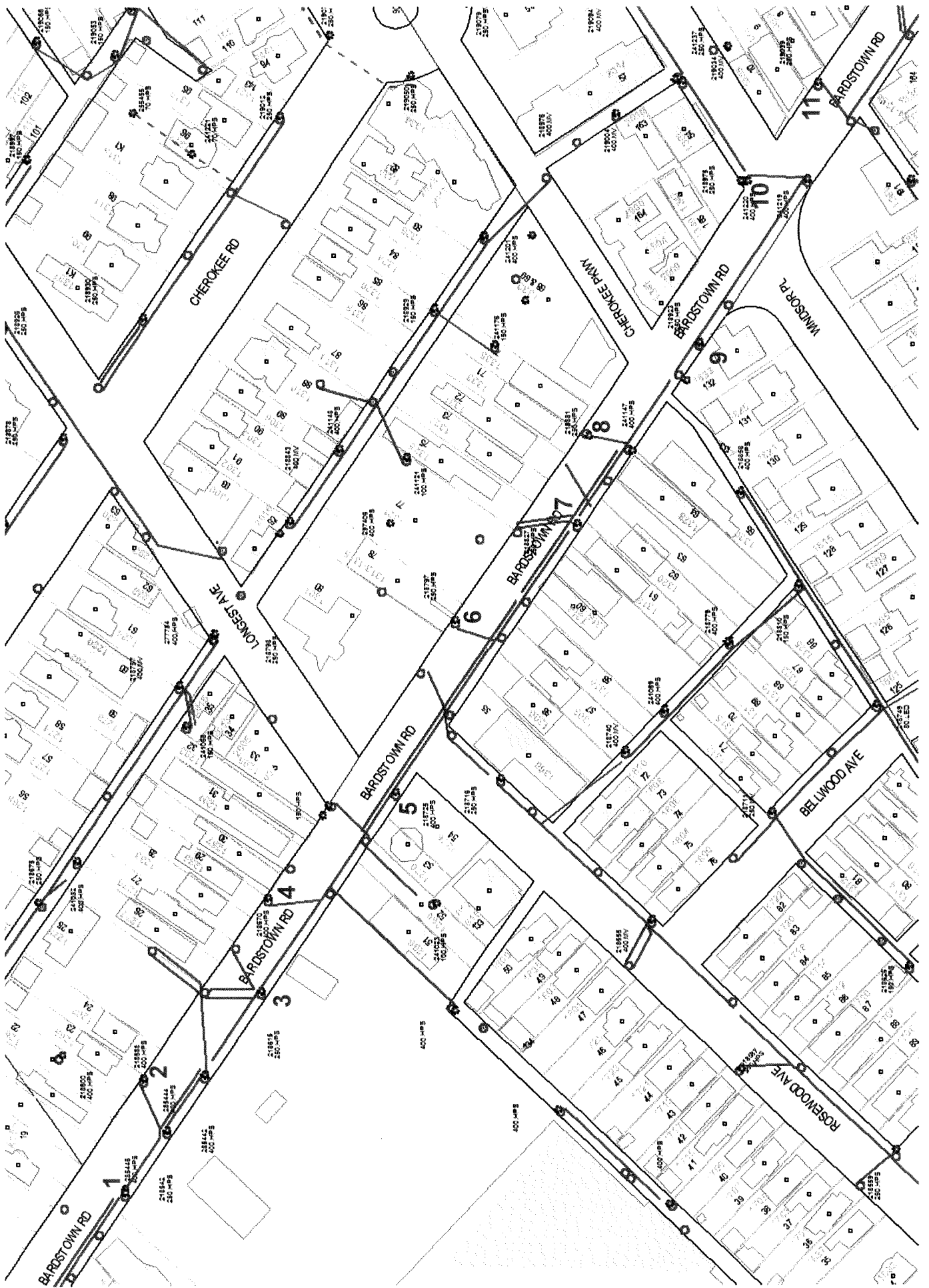

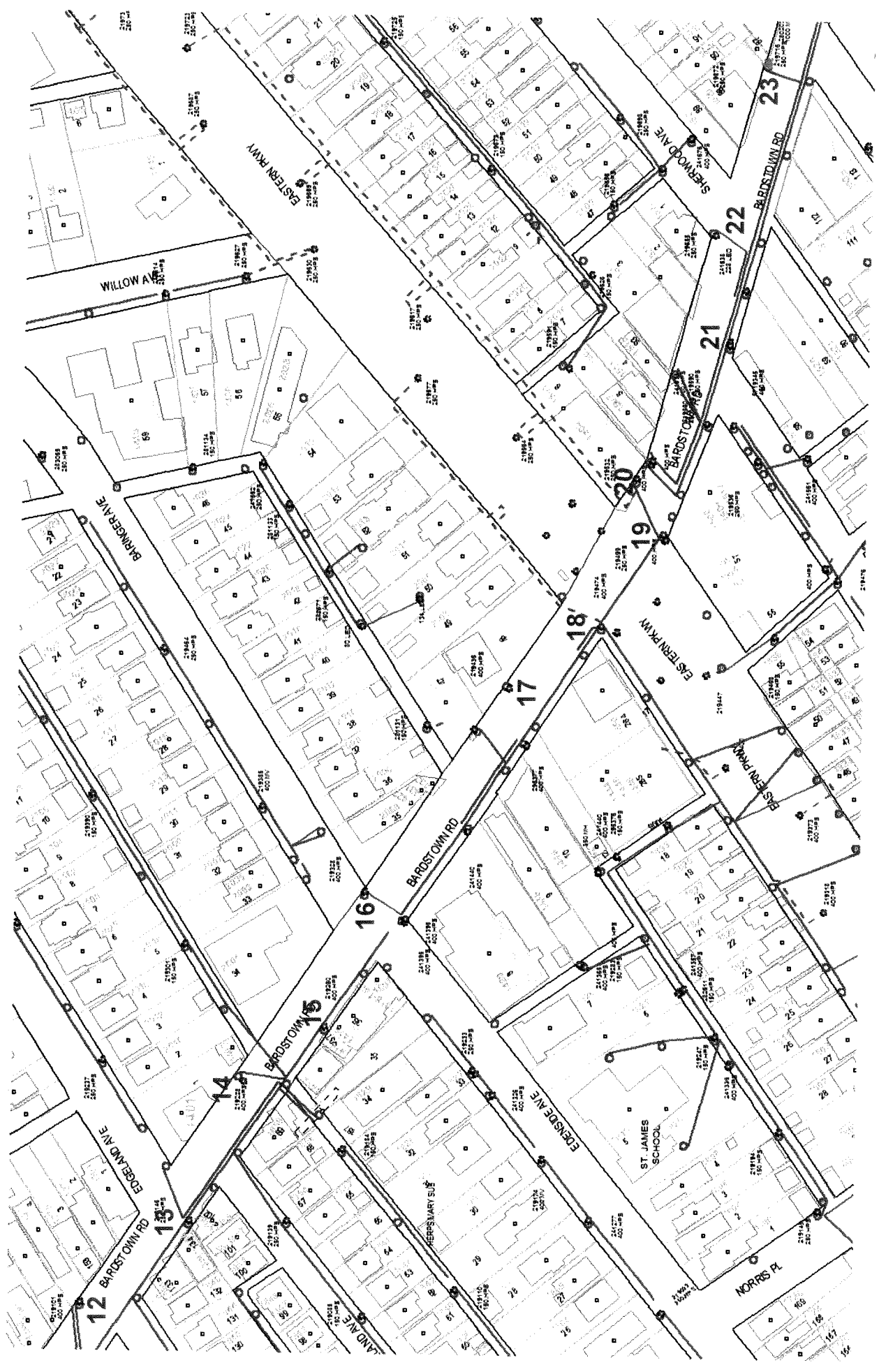

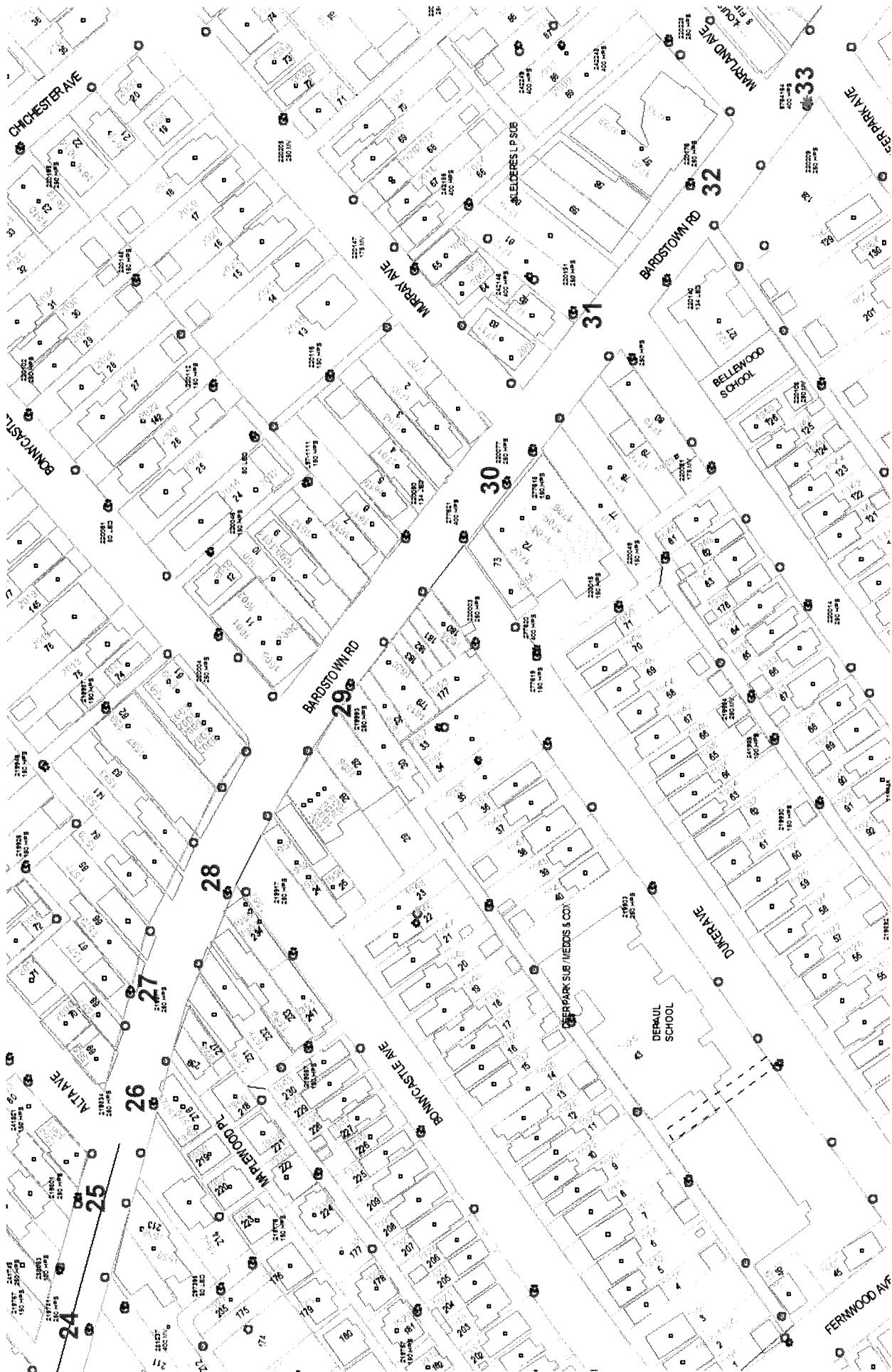



61
60
59

58

57

56

55

54

53

52

51

50

48

WOODBOURNE AVE

DOROTHY AVE

BARRISTOWN RD

SLS AVE

WOODBOURNE AVE

WOODBOURNE AVE

WISSE AVE

CHRISTOPHER

CHRISTOPHER

LOGSLEY CLASSICAL MASONRY

DUNGEON RD

BARRISTOWN RD

DUNGEON RD

ST GEORGE

WINDFORD PL

BARRISTOWN RD

CHRISTOPHER

CHRISTOPHER

BOULEVARD/MAPOLEON

ST GEORGE



62

63

64

65

66

67

68

69

70

71

72

73

74

75

76

BARDSTON RD

BARDSTON RD

TAYLORVILLE RD

BRIDGETOWN RD

TREMAIN WAY

TREMAIN WAY

LAKESIDE DR

LAKESIDE DR

LAKESIDE DR

LAKESIDE DR

LAKESIDE DR

EASTMAN AVE

BRIDGETOWN RD

TAYLORVILLE RD

WELLS AVE

KELLY AVE

ESTERMAN AVE

WELLS AVE

WELLS AVE

WELLS AVE

WELLS AVE

WELLS AVE

WELLS AVE

WELLS AVE

PAGEAVE

LAKESIDE DR

TREMAIN WAY

LAKESIDE DR

LAKESIDE DR

LAKESIDE DR

LAKESIDE DR

LAKESIDE DR

LAKESIDE DR

LAKESIDE DR

LAKESIDE DR

LAKESIDE DR

LAKESIDE DR

WELLS AVE

WELLS AVE

WELLS AVE

WELLS AVE

WELLS AVE

WELLS AVE

WELLS AVE

WELLS AVE

WELLS AVE

WELLS AVE

WELLS AVE

WELLS AVE

Dearing, Connie M.

From: Brown, Jeffrey E
Sent: Monday, July 6, 2020 9:50 AM
To: Weatherby, Jasmine
Subject: RE: Bardstown Rd District 8 LED Conversion

Public Works will accept the funds to convert the existing street lights in the corridor to LED

Jeffrey Brown, PE

From: Weatherby, Jasmine <Jasmine.Weatherby@louisvilleky.gov>
Sent: Monday, July 6, 2020 9:41 AM
To: Brown, Jeffrey E <Jeffrey.Brown@louisvilleky.gov>
Subject: FW: Bardstown Rd District 8 LED Conversion

Will you accept the below money from our office for the LED light conversion on Bardstown Road?

Thank you

Jasmine Weatherby (she/her/hers)
Legislative Aide
Councilman Brandon Coan
District 8
601 West Jefferson St
Louisville, KY 40202
Email: jasmine.weatherby@louisvilleky.gov
Office: (502) 574-1108

Help your friends and neighbors stay informed! Share [this link](#) to spread the joy of District 8 eNews.

From: Coan, Brandon <Brandon.Coan@louisvilleky.gov>
Sent: Thursday, July 2, 2020 7:02 PM
To: Hannah, Steve <Steve.Hannah@lge-ku.com>; Weatherby, Jasmine <Jasmine.Weatherby@louisvilleky.gov>; Brown, Jeffrey E <Jeffrey.Brown@louisvilleky.gov>
Cc: Butler, Marianne <Marianne.Butler@lge-ku.com>; Hayes, Bradley <Bradley.Hayes@lge-ku.com>; Tipton, Jason <Jason.Tipton@lge-ku.com>
Subject: Re: Bardstown Rd District 8 LED Conversion

Thanks, Steve.

Jasmine - please initiate a CIF transfer of \$23,009 to Public Works for Conversion of 95 Bardstown Rd Streetlights to LED. (The balance \$19k is already in the budget as CDF).

Jeff - we've got and are good for the money, so please expedite as you can. Thanks!

Brandon Coan

Metro Council District 8

(502) 574-1108

601 W. Jefferson Street
Louisville, KY 40202

Please sign-up to receive important notifications regarding District 8! Our goal is to increase from zero to 8,000 engaged subscribers by 2019.

From: Hannah, Steve <Steve.Hannah@lge-ku.com>

Sent: Thursday, July 2, 2020 6:57 PM

To: Coan, Brandon <Brandon.Coan@louisvilleky.gov>; Weatherby, Jasmine <Jasmine.Weatherby@louisvilleky.gov>

Cc: Brown, Jeffrey E <Jeffrey.Brown@louisvilleky.gov>; Butler, Marianne <Marianne.Butler@lge-ku.com>; Hayes, Bradley <Bradley.Hayes@lge-ku.com>; Tipton, Jason <Jason.Tipton@lge-ku.com>

Subject: RE: Bardstown Rd District 8 LED Conversion

CAUTION: This email came from outside of Louisville Metro. Do not click links or open attachments unless you recognize the sender and know the content is safe

Good catch Brandon. Disregard that last page. I had added that page because Jeffrey wanted me to add the light at Brownstown and Gardiner. After I did, I discovered that light had already been changed out with a 400w LED. Lights 96, 97 & 98 on that page are just duplicates of 93, 94 and 95 on the previous page.

Attached is a revised map with the last page deleted.

Thanks
Steve Hannah

From: Coan, Brandon <Brandon.Coan@louisvilleky.gov>

Sent: Thursday, July 02, 2020 6:31 PM

To: Hannah, Steve <Steve.Hannah@lge-ku.com>; Weatherby, Jasmine <Jasmine.Weatherby@louisvilleky.gov>

Cc: Brown, Jeffrey E <Jeffrey.Brown@louisvilleky.gov>; Butler, Marianne <Marianne.Butler@lge-ku.com>; Hayes, Bradley <Bradley.Hayes@lge-ku.com>; Tipton, Jason <Jason.Tipton@lge-ku.com>

Subject: Re: Bardstown Rd District 8 LED Conversion

EXTERNAL email. STOP and THINK before responding, clicking on links, or opening attachments.

Thanks, Steve. My only question is the map indicates 99 lights and the "invoice" mentions 95 - if you can just reconcile this seeming discrepancy then my office will move all money as necessary to expedite this project as quickly as possible.

Brandon Coan

Metro Council District 8
(502) 574-1108

601 W. Jefferson Street
Louisville, KY 40202

Please sign-up to receive important notifications regarding District 8! Our goal is to increase from zero to 8,000 engaged subscribers by 2019.

From: Hannah, Steve <Steve.Hannah@lge-ku.com>
Sent: Thursday, July 2, 2020 1:40 PM
To: Coan, Brandon <Brandon.Coan@louisvilleky.gov>
Cc: Brown, Jeffrey E <Jeffrey.Brown@louisvilleky.gov>; Butler, Marianne <Marianne.Butler@lge-ku.com>; Hayes, Bradley <Bradley.Hayes@lge-ku.com>; Tipton, Jason <Jason.Tipton@lge-ku.com>
Subject: Bardstown Rd District 8 LED Conversion

CAUTION: This email came from outside of Louisville Metro. Do not click links or open attachments unless you recognize the sender and know the content is safe

Councilman Coan,
Attached is a map showing the lights approved by Metro to be converted to LED in your district along Bardstown Rd. All of them will be converted to 250w equivalent LED's, except for the ones with stars next to them which will be converted to 400w equivalent LED's per Metro's request.

Also attached is the total cost for the monthly conversion fee of each of the lights for 60 months.

Let me know if you have any questions.

Thanks

STEVE HANNAH

TEAM LEADER | OUTDOOR LIGHTING | LG&E
6900 ENTERPRISE DRIVE, LOUISVILLE, KY 40214
O: 502-364-8259 | F: 502-217-2505
STEVE.HANNAH@LGE-KU.COM

----- The information contained in this transmission is intended only for the person or entity to which it is directly addressed or copied. It may contain material of confidential and/or private nature. Any review, retransmission, dissemination or other use of, or taking of any action in reliance upon, this information by persons or entities other than the intended recipient is not allowed. If you received this message and the information contained therein by error, please contact the sender and delete the material from your/any storage medium.

The information contained in this communication from the sender is confidential. It is intended solely for use by the recipient and others authorized to receive it. If you are not the recipient, you are hereby notified that any disclosure, copying, distribution or taking action in relation of the contents of this information is strictly prohibited and may be unlawful.

----- The information contained in this transmission is intended only for the person or entity to which it is directly addressed or copied. It may contain material of confidential and/or private nature. Any review, retransmission, dissemination or other use of, or taking of any action in reliance upon, this information by persons or entities other than the intended recipient is not allowed. If you received this message and the information contained therein by error, please contact the sender and delete the material from your/any storage medium.