

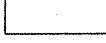



LOUISVILLE RENAISSANCE  
ZONE CORPORATION

## RENAISSANCE SOUTH BUSINESS PARK

**LEGEND**

-  PROPERTY OWNED BY LRAA, LRZC OR UNITED PARCEL SERVICE, INC.
-  NOT OWNED BY LRAA, LRZC OR UNITED PARCEL SERVICE, INC.
-  PROPOSED STREET CLOSING
-  CLOSED STREET

**APPROVED:**  
LOUISVILLE METRO PLANNING  
COMMISSION

DATE 4/17/14  
BY David P. Hapell

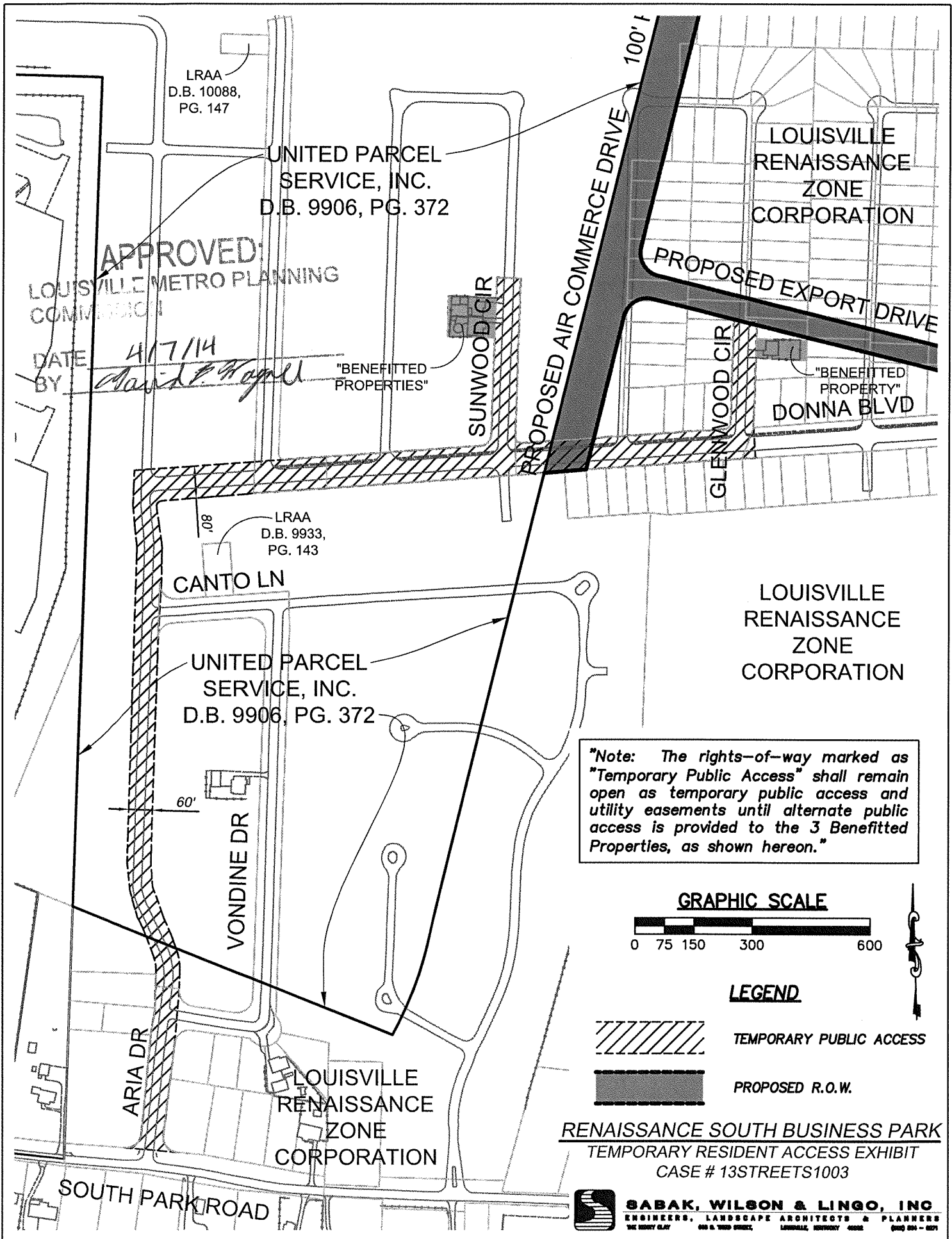

LRAA  
D.B. 10088,  
PG. 147

UNITED PARCEL  
SERVICE, INC.  
D.B. 9906, PG. 372

LOUISVILLE  
RENAISSANCE  
ZONE  
CORPORATION

APPROVED  
LOUISVILLE METRO PLANNING  
COMMISSION

DATE 4/7/14  
BY David W. Hapel

"BENEFITTED  
PROPERTIES"

SUNWOOD CIR

PROPOSED AIR COMMERCE DRIVE 100' F

PROPOSED EXPORT DRIVE

GLEMWOOD CIR

"BENEFITTED  
PROPERTY"  
DONNA BLVD

LRAA  
D.B. 9933,  
PG. 143

CANTO LN

UNITED PARCEL  
SERVICE, INC.  
D.B. 9906, PG. 372

LOUISVILLE  
RENAISSANCE  
ZONE  
CORPORATION

60'

VONDINE DR

**Note:** The rights-of-way marked as "Temporary Public Access" shall remain open as temporary public access and utility easements until alternate public access is provided to the 3 Benefitted Properties, as shown hereon."

**GRAPHIC SCALE**



**LEGEND**



TEMPORARY PUBLIC ACCESS



PROPOSED R.O.W.

**RENAISSANCE SOUTH BUSINESS PARK**  
TEMPORARY RESIDENT ACCESS EXHIBIT  
CASE # 13STREETS1003



**SABAK, WILSON & LINGO, INC**  
ENGINEERS, LANDSCAPE ARCHITECTS & PLANNERS  
THE HENRY CLAY 600 N. THIRD STREET, LAMARCA, KENTUCKY 40026 502.884.1001