

LOCATION MAP
NO SCALE

LEGEND

- SET 5/8" REBAR WITH CAP #4011
- FOUND 3/4" PINCH PIPE
- FOUND 1/2" REBAR
- FOUND 1/2" PIPE
- COMPUTED UNMARKED POINT

CURVE TABLE			
CURVE	CHORD BEARING	CHORD LENGTH	RADIUS
C1	S 24°36'29" E	123.52'	125.00'
C2	N 10°26'32" W	39.94'	75.00'
C3	N 07°15'07" E	5.89'	75.00'

LINE TABLE		
LINE	BEARING	DISTANCE
L1	N 89°00'58" W	60.42'
L2	N 01°09'42" E	199.92'
L3	N 00°33'58" E	399.83'
L4	N 05°00'07" E	122.59'
L5	N 05°00'07" E	187.24'
L6	N 05°00'07" E	39.27'
L7	N 05°00'07" E	37.10'
L8	N 89°44'44" E	60.20'
L9	S 04°40'24" W	120.39'
L10	S 04°40'24" W	68.89'
L11	S 04°40'24" W	79.50'
L12	S 04°40'24" W	117.27'
L13	S 00°56'25" W	401.04'
L14	S 00°56'25" W	200.00'
L15	N 85°19'36" W	61.49'
L16	N 05°00'07" E	75.11'

GRAPHIC SCALE 1"=120'

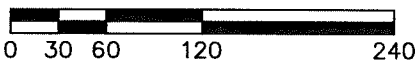

LAND SURVEYOR'S CERTIFICATE

I HEREBY CERTIFY THAT THE SURVEY AS DEPICTED HEREON WAS PERFORMED BY PERSONS UNDER MY DIRECT SUPERVISION, AND MEETS OR EXCEEDS THE MINIMUM TECHNICAL STANDARDS FOR AN URBAN SURVEY AS ESTABLISHED BY THE COMMONWEALTH OF KENTUCKY, PER 201 KAR 18:150 AND IN EFFECT ON THE DATE 07/20/18 THAT THIS SURVEY WAS COMPLETED IN THE FIELD.

STATE OF KENTUCKY
DAVID A. MINDEL
2843
LICENSED PROFESSIONAL LAND SURVEYOR

DAVID A. MINDEL PLS #2843 DATE:
NOT VALID WITHOUT ORIGINAL SIGNATURE AND SEAL OF THE PROFESSIONAL SURVEYOR

MINDEL SCOTT
ENGINEERING ► SURVEYING ►
PLANNING ► LANDSCAPE ARCHITECTURE
5151 Jefferson Blvd. Louisville, KY 40219
502-485-1508 ► MindelScott.com

APPROVED:
LOUISVILLE METRO PLANNING COMMISSION

DATE 3/7/19
BY

THE PURPOSE OF THIS PLAT IS TO CLOSE A PORTION OF SENTIMENTAL LANE.

ROAD CLOSURE PLAT
CASE #18STREETS1018
RELATED CASE: 18STREETS1022 & 15SUBDIV1011
SENTIMENTAL LANE
RIGHT OF WAY DEDICATED PER DOCKET #18-1-93, 18-2-93, 18-3-93 AND D.B. 3567 PG. 420
REVISION: 01/18/2019
REVISION: 10/15/2018
DATE: 09/24/2018

SCALE: 1"=120'

LEGEND

- SET 5/8" REBAR WITH CAP #4011
- FOUND 3/4" PINCH PIPE
- FOUND 1/2" REBAR
- ⊙ FOUND 1/2" PIPE
- △ COMPUTED UNMARKED POINT

NORTH & ALL BEARINGS SHOWN HEREON ARE BASED ON DEED BOOK 9964, PAGE 531. REFERENCE BEARING N 03°43'00" E ROTATED COUNTER-CLOCKWISE 03°09'02" FOR A NEW BEARING OF N 00°33'58" E.

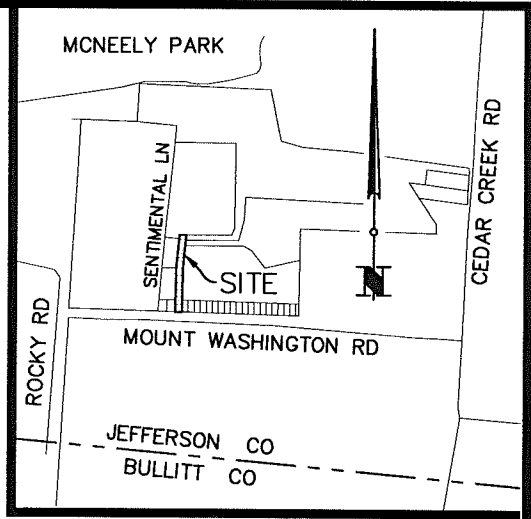

LOCATION MAP
NO SCALE

LINE TABLE		
LINE	BEARING	DISTANCE
L1	N 89°00'58" W	60.42'
L2	N 01°09'42" E	199.92'
L3	N 00°33'58" E	399.83'
L4	N 05°00'07" E	122.59'
L5	N 05°00'07" E	187.24'
L6	N 05°00'07" E	39.27'
L7	N 05°00'07" E	37.10'
L8	N 89°44'44" E	60.20'
L9	S 04°40'24" W	120.39'
L10	S 04°40'24" W	68.89'
L11	S 04°40'24" W	79.50'
L12	S 04°40'24" W	117.27'
L13	S 00°56'25" W	401.04'
L14	S 00°56'25" W	200.00'
L15	N 85°19'36" W	61.49'
L16	N 05°00'07" E	75.11'

LOT "B"
SENTIMENTAL LANE "BEING CLOSED"
1,101.7 S.F. / 0.025 ACRES
LAND TO REVERT TO
TAX BLOCK 0086, LOT 0200
AND LOT 201

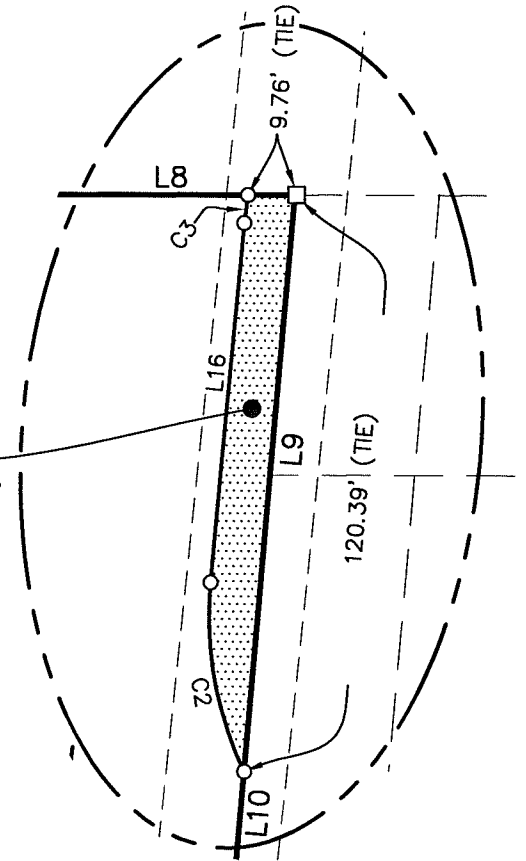

DETAIL "A"
NO SCALE

CURVE TABLE			
CURVE	CHORD BEARING	CHORD LENGTH	RADIUS
C1	S 24°36'29" E	123.52'	125.00'
C2	N 10°26'32" W	39.94'	75.00'
C3	N 07°15'07" E	5.89'	75.00'

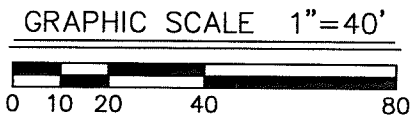

LAND SURVEYOR'S CERTIFICATE

I HEREBY CERTIFY THAT THE SURVEY AS DEPICTED HEREON WAS PERFORMED BY PERSONS UNDER MY DIRECT SUPERVISION, AND MEETS OR EXCEEDS THE MINIMUM TECHNICAL STANDARDS FOR AN URBAN SURVEY AS ESTABLISHED BY THE COMMONWEALTH OF KENTUCKY, PER 201 KAR 18:150 AND IN EFFECT ON THE DATE 07/20/18 THAT THIS SURVEY WAS COMPLETED IN THE FIELD.

STATE OF KENTUCKY
DAVID A. MINDEL
2843
LICENSED PROFESSIONAL LAND SURVEYOR

DAVID A. MINDEL PLS #2843 DATE:
NOT VALID WITHOUT ORIGINAL SIGNATURE AND SEAL OF THE PROFESSIONAL SURVEYOR

MINDEL SCOTT
ENGINEERING ► SURVEYING ►
PLANNING ► LANDSCAPE ARCHITECTURE
5151 Jefferson Blvd. Louisville, KY 40219
502-485-1508 ► MindelScott.com

APPROVED:
LOUISVILLE METRO PLANNING COMMISSION

DATE 3/7/19
BY

THE PURPOSE OF THIS PLAT IS TO CLOSE A PORTION OF SENTIMENTAL LANE.

ROAD CLOSURE PLAT
CASE #18STREETS1018
RELATED CASE: 18STREETS1022 & 15SUBDIV1011

SENTIMENTAL LANE
RIGHT OF WAY DEDICATED PER
DOCKET #18-1-93, 18-2-93,
18-3-93 AND D.B. 3567 PG. 420

REVISION: 10/15/2018
DATE: 09/24/2018

SCALE: 1"=40'