

GENERAL NOTES

1. Parking areas and drive lanes to be a hard and durable surface.
2. A portion of the site is within the 100 year flood plain per FIRM Map No. 21111 C 0093 E, 21111 C 0092 E dated December 5, 2006.
3. Drainage pattern depicted by arrows (⇒) is for conceptual purposes. Final configuration and size of drainage pipes and channels shall be determined during the construction plan design process. Drainage facilities shall conform to MSD requirements.
4. Erosion & Silt Control: Prior to any construction activities on the site a Erosion & Silt Control Plan shall be provided to MSD for approval.
5. Boundary prepared by Birch Trautwein & Mims Incorporated and provided by Waste Management of Kentucky LLC.
6. Tree Canopy Calculations are not required by Section 10.1.2.B.3 of the Louisville Metro Land Development Code because there is less than 20% increase in impervious area and less than 20% increase in building area.
7. No sewer capacity is necessary for this site.
8. Mitigation measures for dust control shall be in place during construction to prevent fugitive emissions from reaching neighboring properties and roadways.
9. Approval from the Division of Water will be required.
10. An MSD Floodplain Permit will be required.
11. New construction must meet the requirements of the floodplain ordinance.

PROJECT DATA

TOTAL SITE AREA	= 782± Ac.
SITE DEVELOPMENT AREA	= 25± Ac.
EXISTING ZONING	= M-3
FORM DISTRICT	= SUBURBAN WORKPLACE
EXISTING USE	= WASTE MANAGEMENT OF KENTUCKY LLC RECYCLING & LANDFILL OPERATION
PROPOSED USE	= CLEAN N' GREEN (COMPRESSED NATURAL GAS) VEHICLE FUELING FACILITY
CNG TIME FILL REFUELING STATIONS	= 93 EXISTING STATIONS
EXISTING REFUELING STATIONS	= 20 PROPOSED STATIONS
PROPOSED REFUELING STATIONS	= 113 FUELING STATIONS
TOTAL # OF REFUELING STATIONS	= N/A
PARKING	= 584,748 SF
VEHICULAR USE AREA	= NOT REQUIRED BY SECTION 10.2.12 OF THE LOUISVILLE METRO LAND DEVELOPMENT CODE
INTERIOR LANDSCAPE AREA	

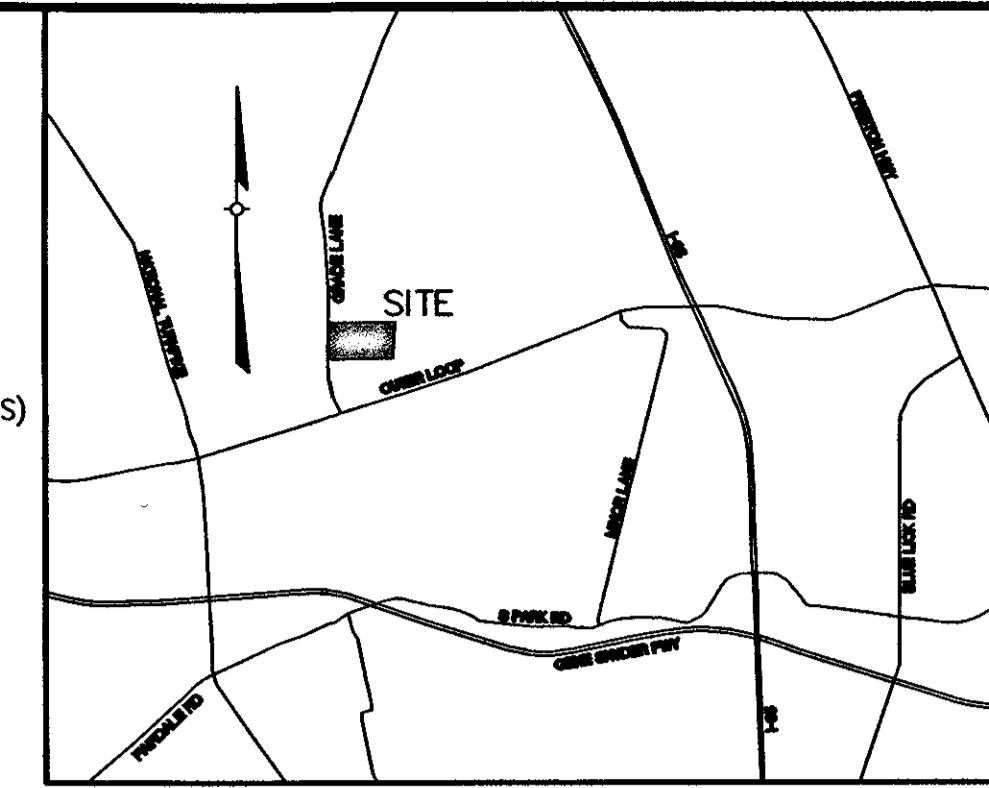

LOCATION MAP
NOT TO SCALE

ONLY REVISIONS TO THE PLAN IS THE ADDITION OF 20 CLEAN N' GREEN (COMPRESSED NATURAL GAS - CNG) REFUELING STATIONS

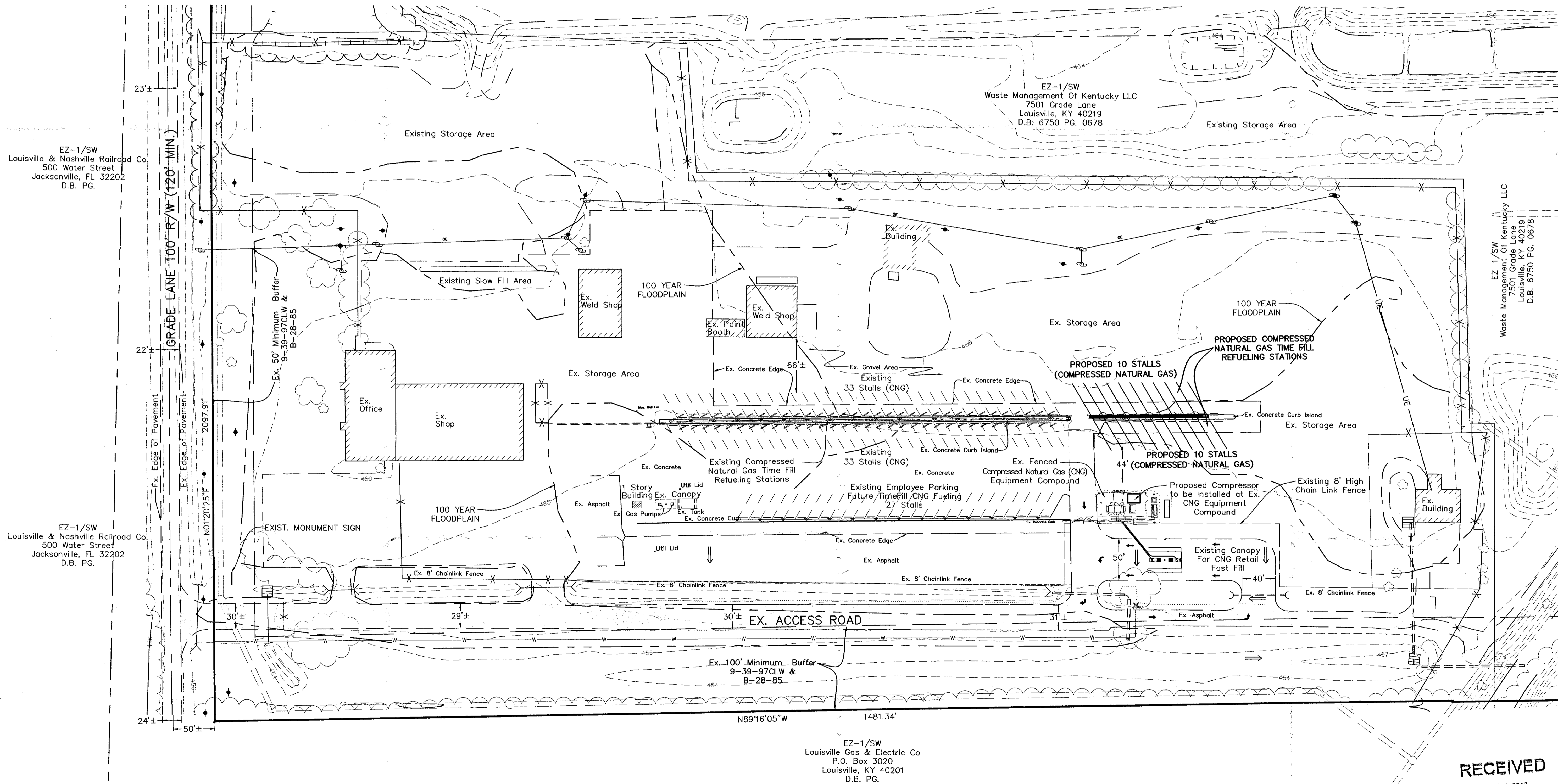

LEGEND

- EXISTING FLOODPLAIN
- PROPOSED STORM SEWER, CATCH BASIN
- EXISTING WATERLINE
- EXISTING UTILITY POLE
- EXISTING LIGHT POLE
- PROPOSED DRAINAGE FLOW
- (TBR) = TO BE REMOVED

GRAPHIC SCALE

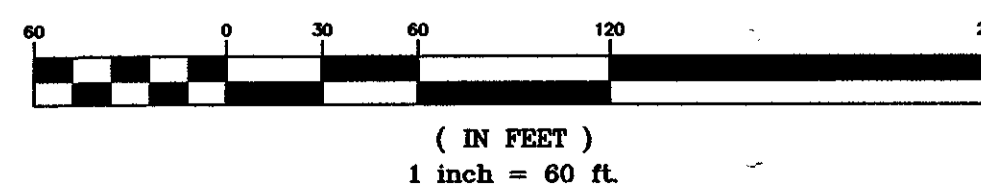

RECEIVED
JAN 21 2014
PLANNING & DESIGN SERVICES

COUNCIL DISTRICT - 24
FIRE PROTECTION DISTRICT - FAIRDALE, OKOLONA

SITE ADDRESS:
7501 GRADE LANE
TAX BLOCK 0640, LOT 0005
D.B. 6750, PG. 0678

CURRENT CASES: 14DEVPLAN44/7
14CUP1049
RELATED CASES: B-9-94, B-176-89,
9-39-97, 10-45-88,
16307

WM# 6751

NO.	DATE	DESCRIPTION	BY

PROJECT DATA	ENGINEER'S SEAL	SURVEYOR'S SEAL
FILE NAME: 11073-RDDP		
DATE: 12-22-14		
SCALE: AS SHOWN		
CHECKED BY: KY		
DRAWN BY: JH/SBS		

PROJECT DATA
FILE NAME: 11073-RDDP
DATE: 12-22-14
SCALE: AS SHOWN
CHECKED BY: KY
DRAWN BY: JH/SBS

LD&D
LAND DESIGN & DEVELOPMENT, INC.
50 WEAVER AVE. SUITE 100 LOUISVILLE, KENTUCKY 40202
PHONE: 502.424.8774 FAX: 502.424.8774
WEB SITE: WWW.LD&D.COM

REVISED DETAILED DISTRICT DEVELOPMENT PLAN AND MODIFIED CONDITIONAL USE PERMIT
WASTE MANAGEMENT OF KENTUCKY LLC
OWNER/DEVELOPER
WASTE MANAGEMENT OF KENTUCKY LLC
7501 GRADE LANE
LOUISVILLE, KY 40219

JOB NO. **11073**
SHEET **1** OF **1**