

# Louisville Metro Council City Agency Request

- Neighborhood Development Fund (NDF)
- Capital Infrastructure Fund (CIF)
- Municipal Aid Program (MAP)
- Paving Fund (PAV)

**Primary Sponsor:** Marianne Butler

**Amount:** \$1,200                                  **Date:** October 8, 2015

**Description of program/project including public purpose, additional funding sources, location of project/program and any external grantee(s):**  
Capital Improvements for materials to be installed in a closet set aside for the Familiar Faces initiative with the Department of Corrections.

**City Agency:**    Department of Corrections  
**Contact Person:**    Mark Bolton  
**Agency Phone:**    574-2167

I have reviewed this request for an expenditure of city tax dollars, and have determined the funds will be used for a public purpose.

15                                  Marianne Butler                                  \$600                                  10-8-15  
District #                                  Council Member Signature                                  Amount                                  Date

<b>Approved by:</b> _____		_____
Appropriations Committee Chairman		Date
<b>Clerk's Office &amp; OMB Use Only:</b>		
Request Amount: _____	Amended Amount: _____	
Reference #: _____	To OMB: _____	
Budget Revision #: _____		
Account #: _____		
To Project Manager: _____	Completion Date: _____	
Actual Cost: _____	Funds Returned: _____	

Department/Project: Familiar Faces Initiative/ Department of Corrections

### Additional Signatures

I have reviewed this request for an expenditure of city tax dollars, and have determined the funds will be used for a public purpose.

<u>7</u> District #	<u>Angela [Signature]</u> Council Member Signature	<u>600.00</u> Amount	<u>10/8/15</u> Date
_____ District #	_____ Council Member Signature	_____ Amount	_____ Date
_____ District #	_____ Council Member Signature	_____ Amount	_____ Date
_____ District #	_____ Council Member Signature	_____ Amount	_____ Date
_____ District #	_____ Council Member Signature	_____ Amount	_____ Date
_____ District #	_____ Council Member Signature	_____ Amount	_____ Date
_____ District #	_____ Council Member Signature	_____ Amount	_____ Date
_____ District #	_____ Council Member Signature	_____ Amount	_____ Date
_____ District #	_____ Council Member Signature	_____ Amount	_____ Date
_____ District #	_____ Council Member Signature	_____ Amount	_____ Date

## CIF, NDF, MAP OR PAV INTERAGENCY CHECKLIST

**Interagency Name:** Department of Corrections

**Program/Project Name:** Familiar Faces Initiative

	Yes/No/NA
<b>Request Form:</b> Is the Request Signed by all Council Member(s) Appropriating Funding?	Yes
<b>Request Form:</b> If matching funds are to be used, are they disclosed with account numbers in the request form description?	NA
<b>Request Form:</b> If matching funds are to be used, does the amount of the request exclude the matching fund amount?	NA
<b>Request Form:</b> If other funds are to be used for this project, are they disclosed with account numbers in the request form description?	NA
<b>Funding Source:</b> If CIF is being requested, does Metro Louisville own/will own the real estate, building or equipment? If not, the funding source is probably NDF.	Yes
<b>Funding Source:</b> If CIF is being requested, does the project have a useful life of more than one year? If not, the funding source is probably NDF.	Yes
<b>Ordinance Required:</b> Is the NDF request to a Metro Agency greater than \$5,000? If so, an ordinance is required.	NA
<b>Ordinance Required:</b> Is the request a transfer from NDF to cost center? If so, is the amount given for the fiscal year \$25,000 or less?	NA
<b>Supporting Documentation:</b> Does the attachment include a valid estimate and description of cost?	Yes

**Prepared by:**

Susan Hughes

**Date:** October 8, 2015

## Hughes, Susan

---

**From:** Butler, Marianne  
**Sent:** Thursday, October 08, 2015 1:34 PM  
**To:** Bolton, Mark; Leet, Angela  
**Cc:** Martirosyan, Mane; Dobson, Chris; Hughes, Susan  
**Subject:** RE: Metro Corrections Clothing Bank Capitol Improvement

Thanks - we will get to work on the paperwork to transfer to Corrections.

Marianne

---

**From:** Bolton, Mark  
**Sent:** Thursday, October 08, 2015 1:23 PM  
**To:** Butler, Marianne; Leet, Angela  
**Cc:** Martirosyan, Mane; Dobson, Chris  
**Subject:** Metro Corrections Clothing Bank Capitol Improvement

Councilwoman Butler and Councilwoman Leet:

The Louisville Metro Department of Corrections (LMDC) is very appreciative of the both of you for your efforts supporting offender community re-entry and more specifically, strategies outfitting mentally ill individuals released from custody with medication, housing, **seasonally appropriate clothing** and other resources.

With your help and that of others, we have developed a **fully stocked clothing bank** at Metro Corrections and are currently organizing this area with clothing containers, shelving and the necessary organizers to manage the closet in an orderly and efficient manner.

As such, Corrections graciously accepts \$1,200 for capital improvements to help organize the Metro Corrections clothing bank set aside for the Familiar Faces(F2ACT) initiative. **LMDC does have the maintenance personnel on-staff to make acquisition of the necessary materials and have them properly installed in the clothing bank area.**

Thanks again for supporting Metro Corrections and the challenging populations we return to the community on a daily basis.

Mark E. Bolton, Director  
Louisville Metro Department of Corrections  
[Mark.bolton@louisvilleky.gov](mailto:Mark.bolton@louisvilleky.gov)  
502-574-2181

Department of Corrections  
Proposed Layout

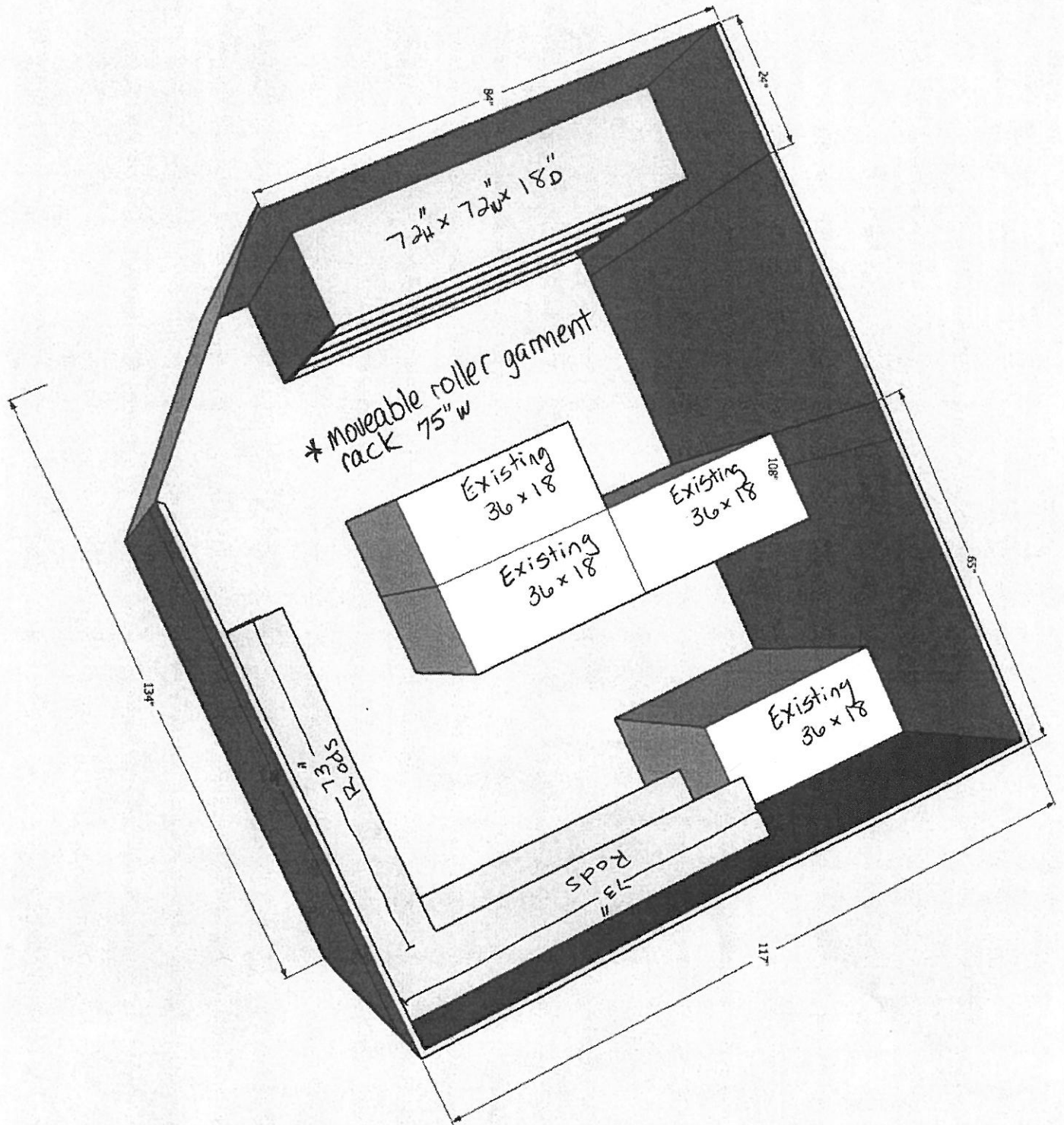



Item List from Lowe's

Item	Item #	Model #	Price	Quantity	Total
Edsal 72-in H x 72-in W x 18-in D 5-Tier Steel Freestanding Shelving Unit	50968	UR1872	\$411.36	1	\$411.36
EZ Shelf 3.33-ft to 30.8-ft White Adjustable Mount Wire Shelving Kits	755322	EZS-K-SCRW72-5-4	\$288.92	1	\$288.92
Hefty 29-Quart Clear Tote with Latching Lid	336490	7102HFT-10-111-44	\$7.78	16	\$124.48
Hefty 66 Quart(S) Clear Tote with Latching Lid	336492	7105HFT-10-111-44	\$9.98	15	\$149.70
Style Selections Chrome Steel Garment Rack	354847	MP-BD00323	\$54.98	1	\$54.98
					<b>\$1,029.44</b>