

LOCATION MAP

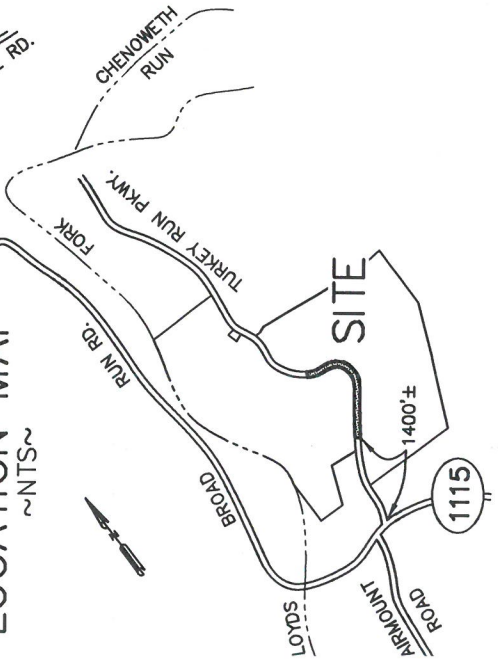

CURVE	RADIUS	CHORD LENGTH	CHORD BEARING
C1	628.00'	144.94'	N41°22'41"E
C2	243.50'	193.64'	N24°34'31"E
C3	135.00'	150.55'	N32°44'37"W
C4	493.00'	9.63'	N66°10'43"W
C5	543.00'	7.66'	S66°04'02"E
C6	185.00'	205.93'	S32°40'14"E
C7	293.50'	233.40'	S24°34'31"W
C8	578.00'	133.40'	S41°22'41"W

LINE	BEARING	DISTANCE
L1	N60°34'46"W	50.22'
L2	N26°09'37"E	50.06'

DATUM INFORMATION

The bearing datum for this plat is Grid North, based on GPS observation from LOJIC Control Monument STA015-2001 on February 07, 2014. The horizontal control is based on state plane NAD 83 KY North Zone, State Plane Coordinate, US Survey Foot.

NOTE: See Docket No. 18SUBDIV1020 for proposed Right-of-Way relocation and dedication.



INDICATES PORTION OF RIGHT-OF-WAY TO BE CLOSED 1.467 ACRES

TAX PARCEL 00570406
THE FUTURE FUND, INC.
D.B. 8716, PG. 781
8700 STOUT ROAD

I hereby certify that this plat and survey were made under my supervision and is correct to the best of my knowledge and belief. This plat meets or exceeds the minimum standards of governing authorities for an Urban survey.

STATE OF KENTUCKY
KEITH D. CROWE
2957
LICENSED PROFESSIONAL LAND SURVEYOR

Keith D. Crowe
LICENSED PROFESSIONAL LAND SURVEYOR

P.O.B.
N: 226374.05
E: 1270672.77

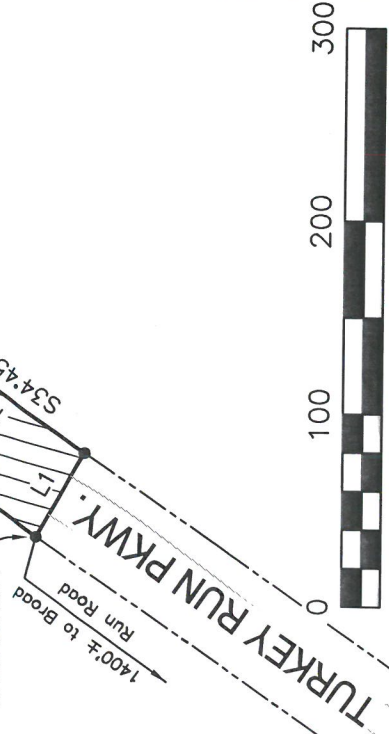

TAX PARCEL 00570041
THE FUTURE FUND, INC.
D.B. 8716, PG. 781
8710 STOUT ROAD

TURKEY RUN PKWY.

TAX PARCEL 00570406
THE FUTURE FUND, INC.
D.B. 8716, PG. 781
8700 STOUT ROAD

TAX PARCEL 00570041
THE FUTURE FUND, INC.
D.B. 8716, PG. 781
8710 STOUT ROAD

RIGHT-OF-WAY CLOSING PLAT

PREPARED FOR
THE FUTURE FUND, INC.
1357 BARDSTOWN RD., LOUISVILLE, KY
TAX PARCEL 0057-0041-0000
TAX PARCEL 0057-0406-0000
D.B. 8716, Pg. 781
PROPERTY ADDRESS:
8700 & 8710 TURKEY RUN PKWY.

OK
1046 E. CHESTNUT STREET
LOUISVILLE, KENTUCKY 40204
PH 502-585-2222 www.ok4.com

SCALE 1"=100' JOB NO. 12300.SRD DATE: 11/20/18