

Susan G. Hack
D.B. 10367, Pg. 660

Steven & Paige Brown
D.B. 9649, Pg. 804

Jennifer Lynn Jeanette,
Trustee of The Revocable Trust
Agreement of Jennifer Lynn Jeanette
D.B. 9137, Pg. 47

Shannon B. & Phillip L. Milliner, Jr.
D.B. 10610, Pg. 301

COUNTRY SQUIRE LANE
Ex. 60' Public Utility, Electric,
Telephone & Private Access Esm't.
P.B. 38, Pg. 94

SITE PLAN FOR KEITH AND GINA BOCKMON
15121 BARBET WAY
LOUISVILLE, KY 40299
CURRENT USAGE: VACANT LAND
PROPOSED USAGE: SINGLE FAMILY DWELLING
RIDGE HEIGHT OF PROPOSED STRUCTURE: 25' FROM LAG

MICHEAL AND REBECCA CURTIS
DB 10773, page 289

7501 COUNTRY SQUIRE LANE - 7.53 ACRES
KEITH AND GINA BOCKMON
PARCEL ID: 005704010090 and DB 7375, page 93

Paul & Frances Johnson
& Paul L. Bergman
D.B. 7193, Pg. 729

* MSD SINGLE LOT CONSTRUCTION PERMIT REQUIRED PRIOR TO ISSUE OF BUILDING PERMITS.

SITE PLAN
SCALE: 1"=150'

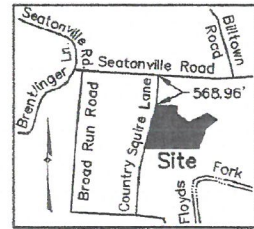

LOCATION MAP
NOT TO SCALE

SCALE: 1"=150'

