

# 416 WASHBURN AVE~LYNDON, KY

## MINOR PLAT WAIVER

Development Review Committee Meeting  
October 5<sup>th</sup>, 2022



**LAND DESIGN & DEVELOPMENT INC**

503 Washburn Avenue, Suite 101, Louisville, KY 40222 | p: (502) 426-9374

# Request

- WAIVER – To allow direct access to Washburn Avenue.



# Aerial View



# LOJIC - Historic Property Lines

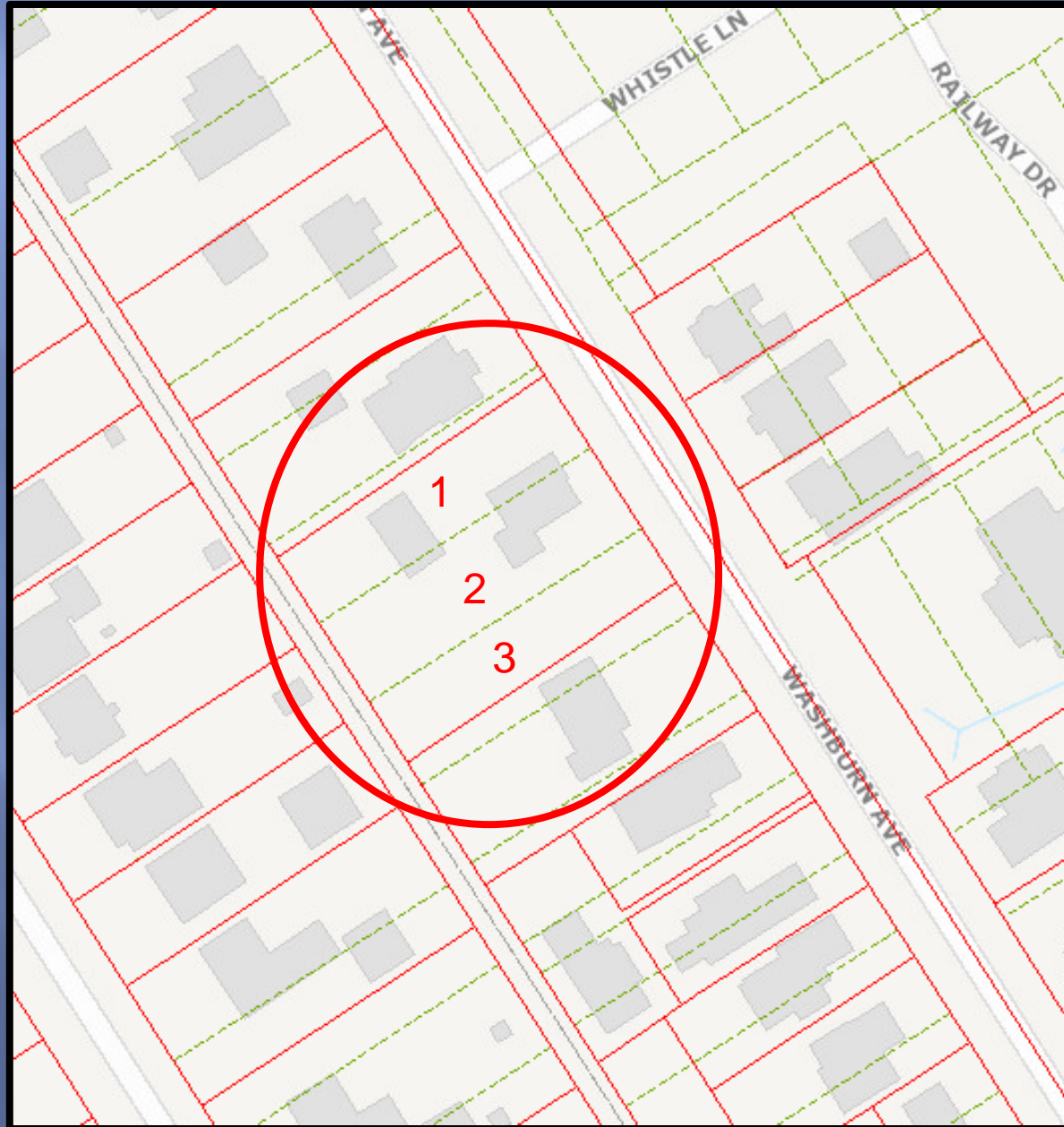

# Washburn Ave

- 1.0 mile long
- Between Westport Rd & New LaGrange Rd
- 89 driveways



# City of Lyndon

**From:** Brent Hagan <lyndonmayor@cityoflyndon.org>

**Sent:** Friday, July 15, 2022 2:41 PM

**To:** David Winkler <winkler@ltd-inc.com>

**Subject:** RE: 416 Washburn Avenue

Good afternoon David,

The City of Lyndon does not oppose a driveway for Lot 2, provided that the Lot 2 parcel has been properly separated from Lot 1, thus generating an independent parcel number and serves as a private residence.

Brent Hagan

Thank you.



Brent Hagan | Mayor | City of Lyndon  
515 Wood Rd. Lyndon, KY 40222  
P. 502.423.0932 | F. 502.339.9722  
lyndonmayor@cityoflyndon.org  
www.cityoflyndon.org

