

LEGAL DESCRIPTION

BEGINNING AT A POINT IN BISHOP LANE AT THE EAST LINE OF THE 1944-45 CONVEYANCE... (text continues with legal description of the property boundaries and historical conveyances)

VICINITY MAP

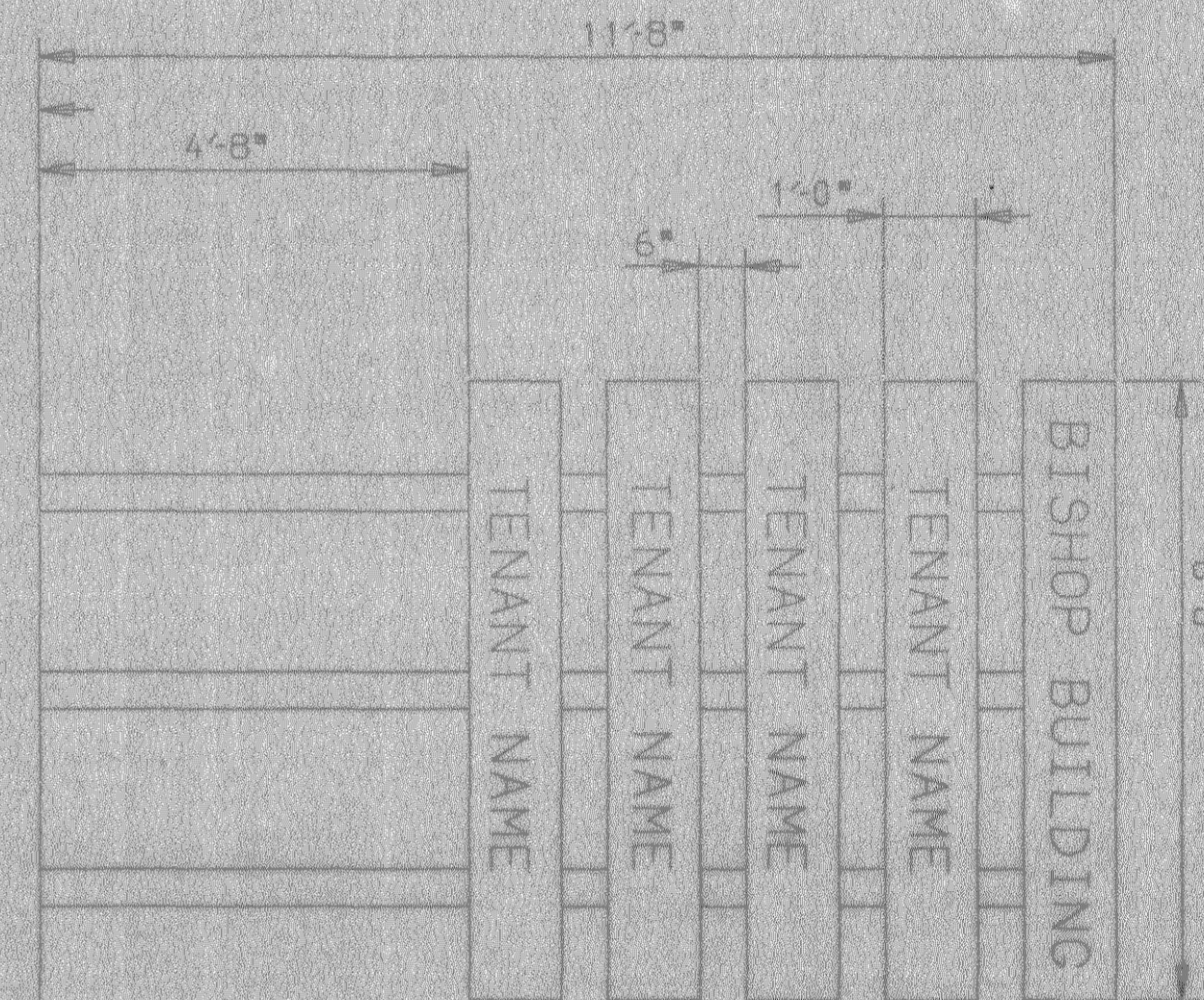
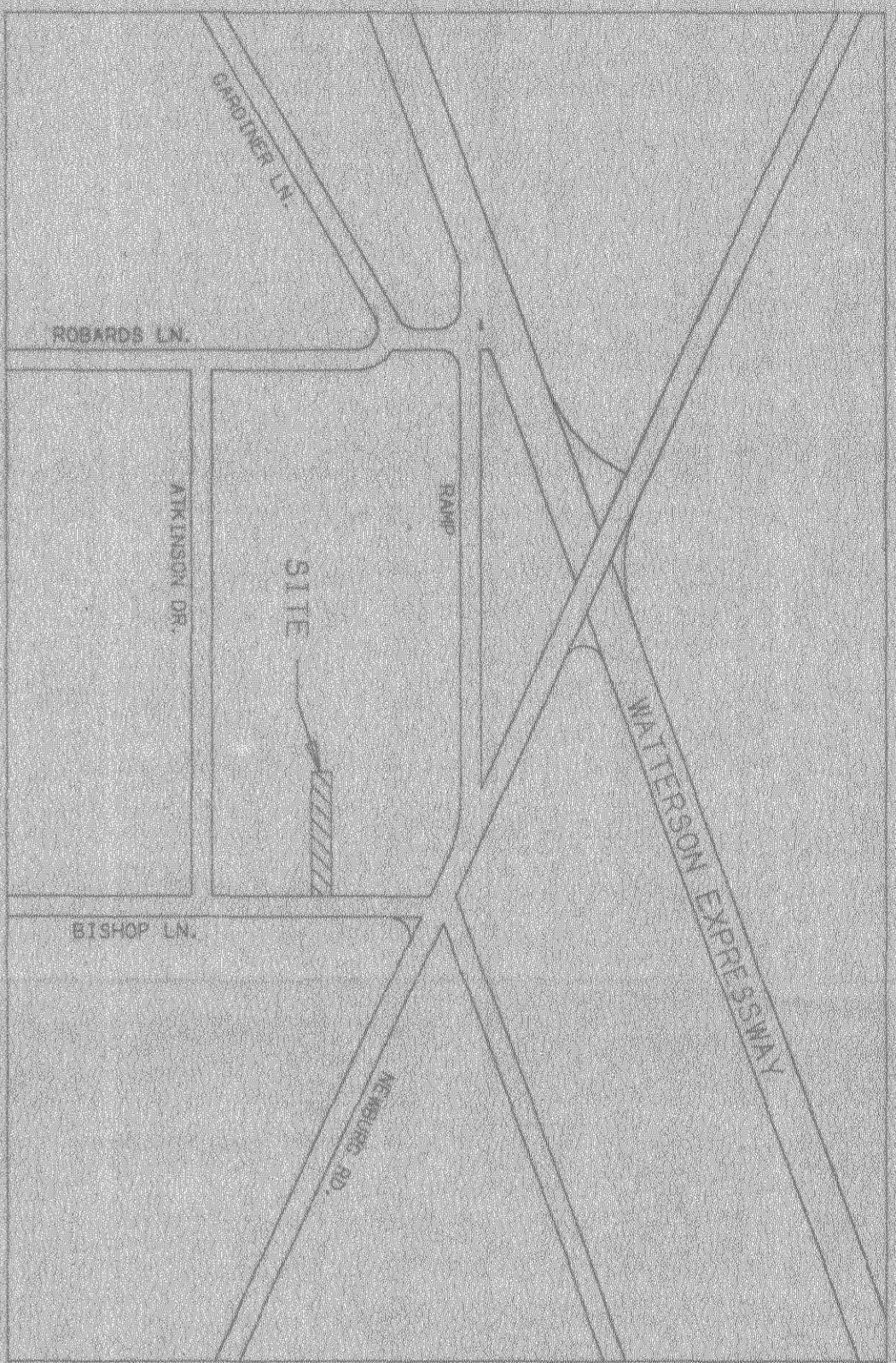

BUILDING SIGN
SIGN SCALE 1/2" = 1'
PLANTER HEIGHT 6"

AGREEMENT OF INGRESS & EGRESS
I, the undersigned, hereby grant to the City of Jefferson County, Kentucky, the right of ingress and egress over the property described herein for the purpose of installing and maintaining a building sign on the property...

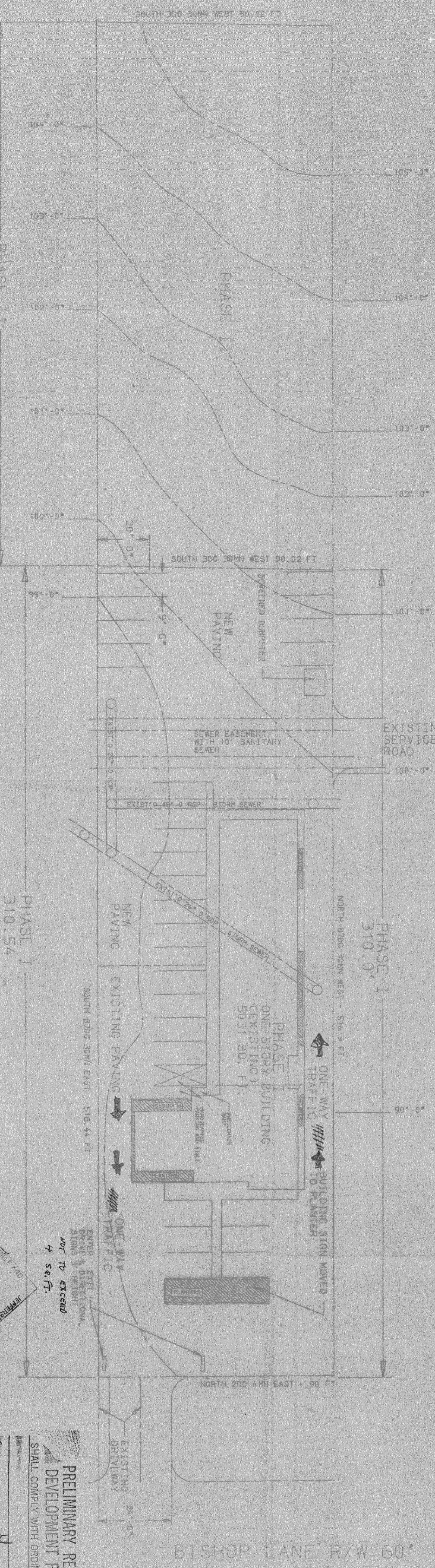
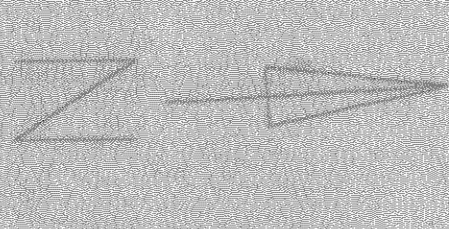

CHANGE IN PHASE I ZONING ONLY ZONING R9 - C1

NOTICE

PERMITS SHALL BE ISSUED ONLY IN CONFORMANCE WITH THE BINDING ELEMENTS OF THIS DISTRICT DEVELOPMENT PLAN

1. This development shall be in accordance with the approved conditions of approval...
2. The development shall be completed within the approved time period...
3. The development shall be in accordance with the approved conditions of approval...
4. The development shall be in accordance with the approved conditions of approval...
5. The development shall be in accordance with the approved conditions of approval...
6. The development shall be in accordance with the approved conditions of approval...
7. The development shall be in accordance with the approved conditions of approval...
8. The development shall be in accordance with the approved conditions of approval...
9. The development shall be in accordance with the approved conditions of approval...
10. The development shall be in accordance with the approved conditions of approval...

APPROVED DISTRICT DEVELOPMENT PLAN
DOCKET NO. 10-21-20
APPROVAL DATE: 10/21/20
COMMISSIONER OF PUBLIC WORKS: [Signature]

PRELIMINARY REVIEW DEVELOPMENT PLAN
SHALL CONFORM WITH ORDINANCE #28
DATE: 10-21-20
JERRY D. TAYLOR, DEPT. OF PUBLIC WORKS

PRELIMINARY APPROVAL DEVELOPMENT PLAN
CONDITIONS:
DATE: 10-21-20
BY: [Signature], DEPT. OF PUBLIC WORKS

RECEIVED
BISHOP BUILDING
4310 BISHOP LANE
OWNED BY: BYRON COHEN
TO BE LEASED

9-22-20

