

6209 & 6211  
Whispering Hills Boulevard  
Sidewalk Waiver

Case: #16waiver1045

November 17, 2016

Mindel, Scott & Associates, Inc.  
5151 Jefferson Blvd., Suite 101  
Louisville, Kentucky 40219

# Aerial View of Site



Legend

Hoover Way

Woodrow Way

Whispering Hills Blvd

6205

6207

6209

6211



# Waiver Exhibit

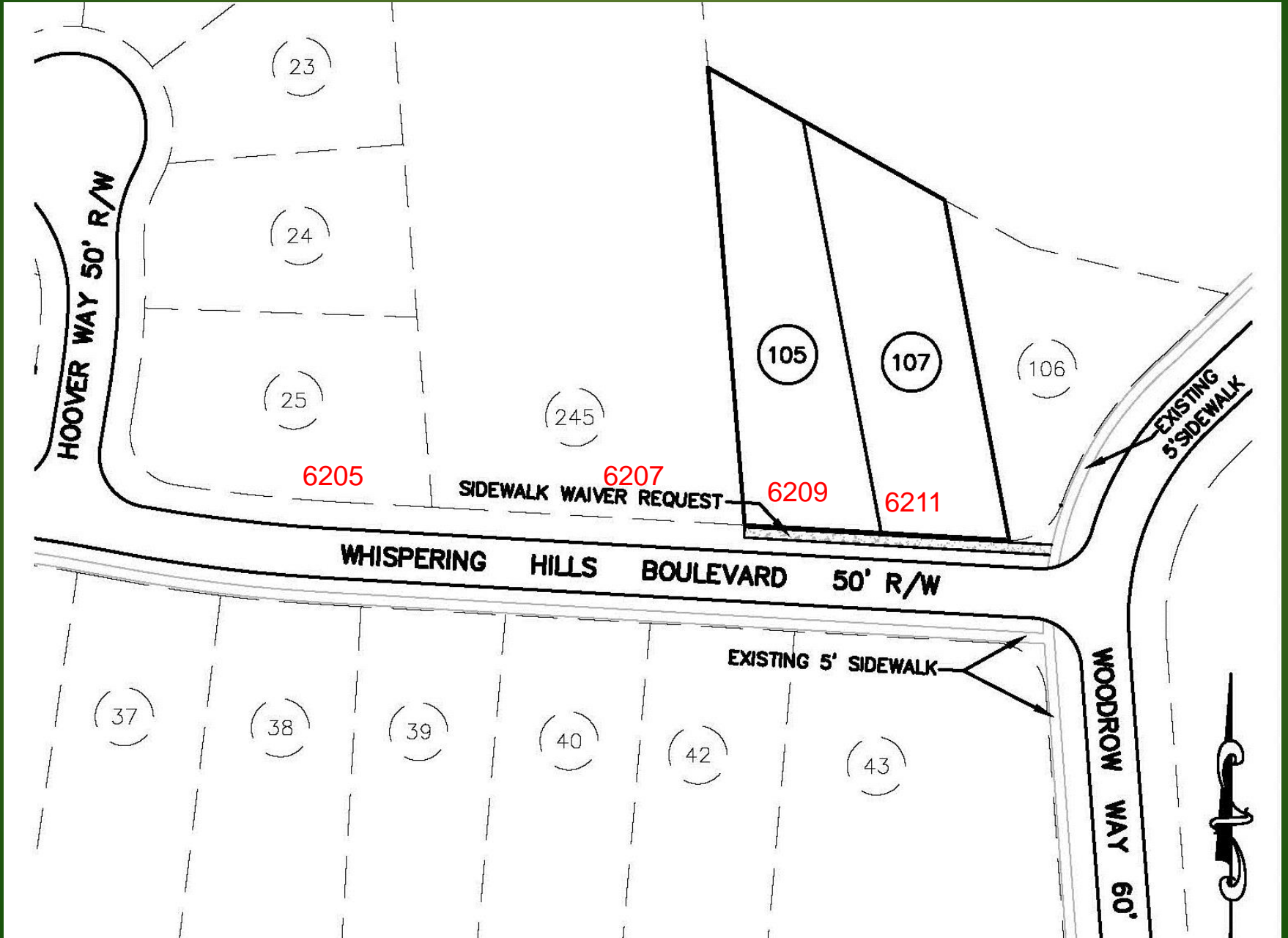

# Waiver Justification

- Existing steep grade of the site relative to the roadway and the shallow depth of rock is the reason for this request. A rock ridge prevented further grading of the driveways.
- In constructing an accessible sidewalk (with MPW inspector assistance) driveway is not mountable. Elimination of the sidewalk is required to reconstruct the driveway and provide access to the garage.
- No sidewalk is provided in front of existing homes, 6205 or 6207 Whispering Hills Blvd, which also lie on the north side of Whispering Hills Blvd between Woodrow Way and Hoover Way.
- An existing sidewalk is provided on the southside of Whispering Hills Blvd which provides safe pedestrian access within the subdivision.



# Aerial View of Site



Legend

Hoover Way

Woodrow Way

Whispering Hills Blvd

6205

6207

6209

6211



# West on Whispering Hills Blvd from Woodrow Way.





# View of Driveways from Whispering Hills Blvd



Legend





West on Whispering Hill Blvd, site on right, ex. walk on left side





6209 Whispering Hills Blvd – Current condition, most cars cannot mount driveway, bottom-out at sidewalk





6209 & 62011 Whispering Hills Blvd – Current condition, most cars cannot mount driveway, bottom-out at sidewalk





# Close up of existing driveways and sidewalk





# 6207 Whispering Hills Blvd - View of driveway, with site on the right and above in the inset photo





View west toward Hoover Way. No sidewalk in front of either 6205 or 6207 Whispering Hills Blvd.



# Driveway Cross Sections

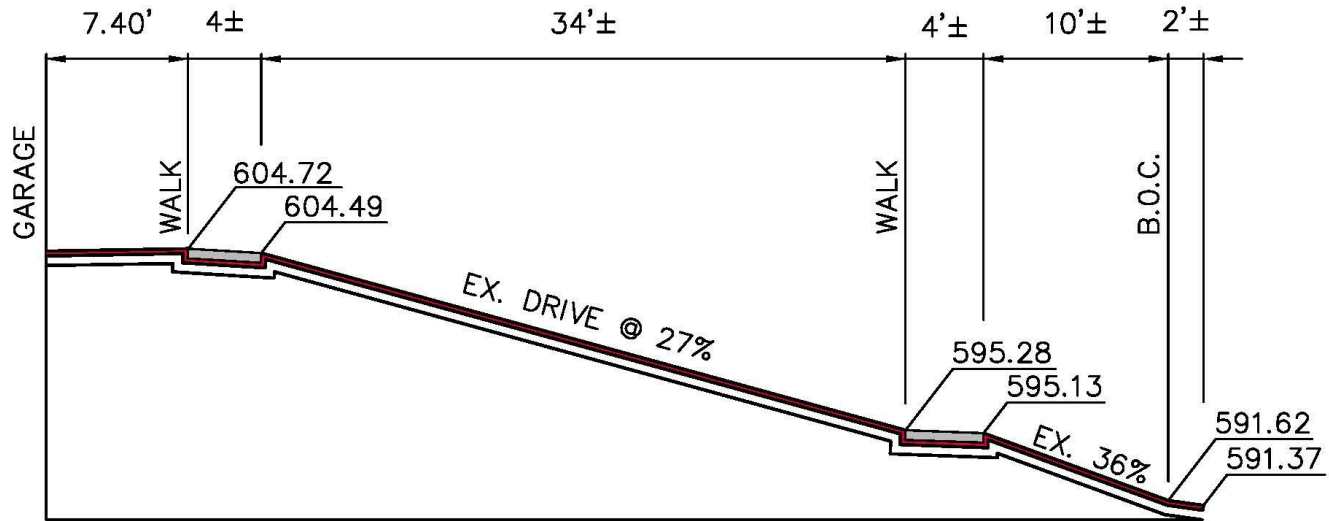

**EXISTING CONDITIONS**

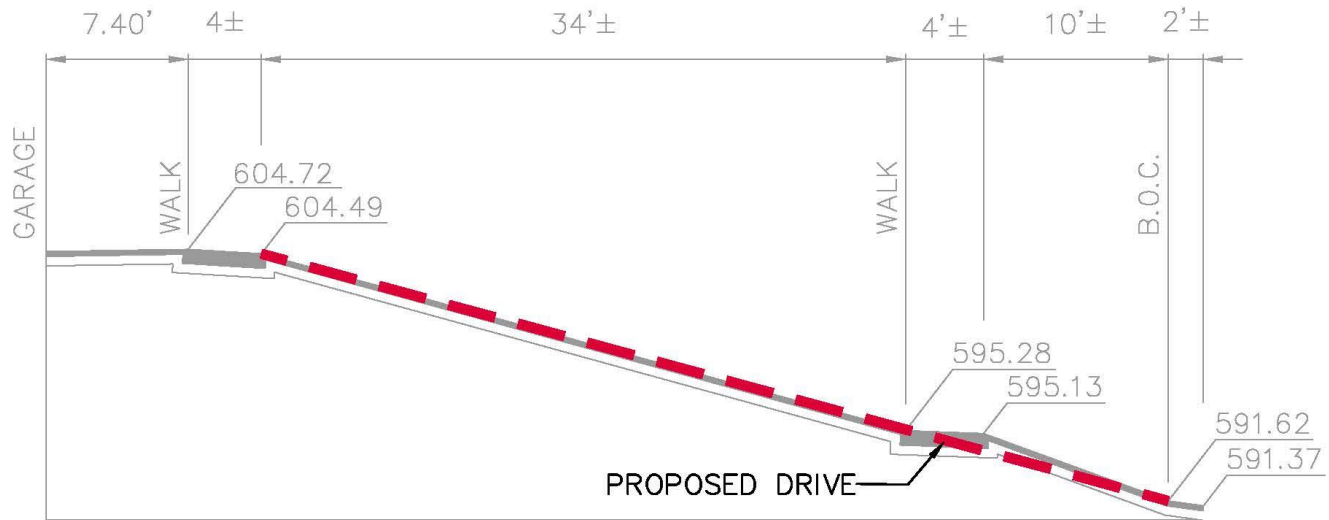

**PROPOSED CONDITIONS**



# Cross Section – Exaggerated Scale 1:5

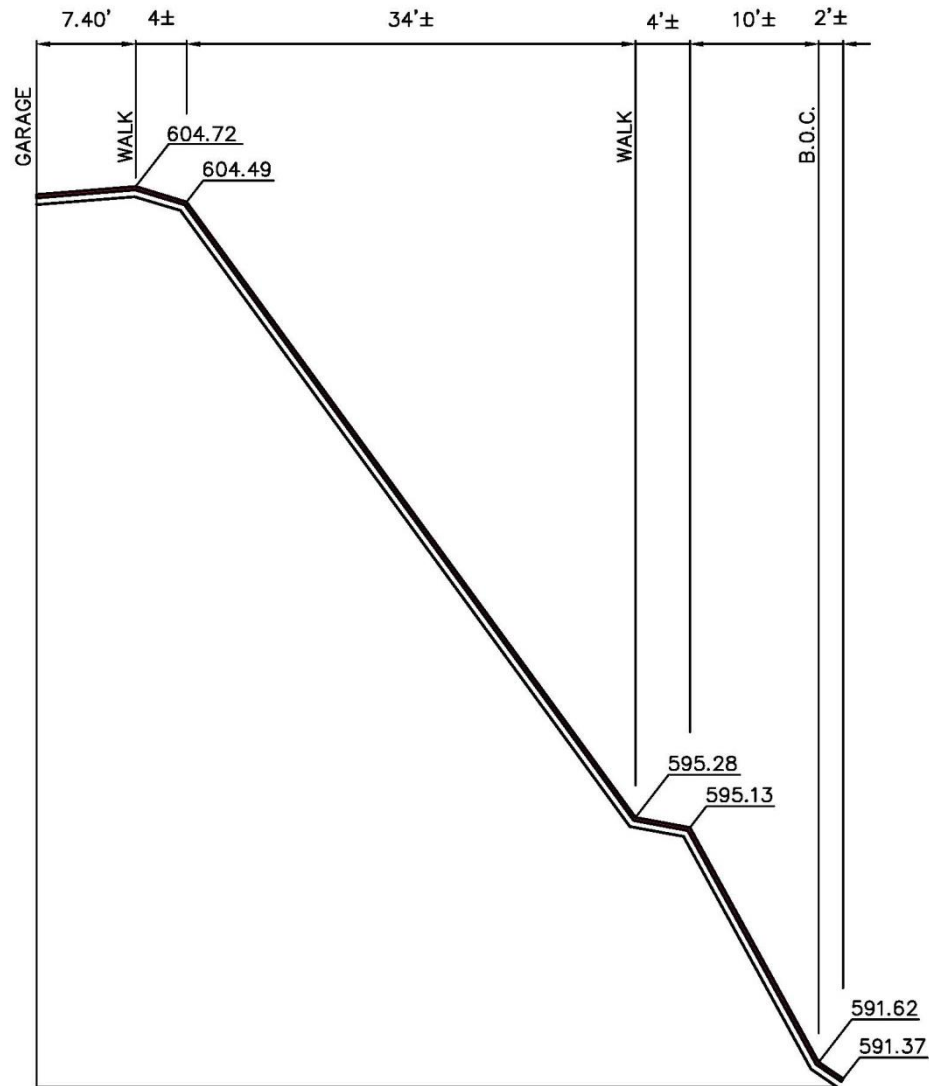



# Waiver Justification

- Existing steep grade of the site relative to the roadway and the shallow depth of rock is the reason for this request. A rock ridge prevented further grading of the driveways.
- In constructing an accessible sidewalk (with MPW inspector assistance) driveway is not mountable. Elimination of the sidewalk is required to reconstruct the driveway and provide access to the garage.
- No sidewalk is provided in front of existing homes, 6205 or 6207 Whispering Hills Blvd, which also lie on the north side of Whispering Hills Blvd between Woodrow Way and Hoover Way.
- An existing sidewalk is provided on the southside of Whispering Hills Blvd which provides safe pedestrian access within the subdivision.

6209 & 6211  
Whispering Hills Boulevard  
Sidewalk Waiver

Case: #16waiver1045

November 10, 2016

Mindel, Scott & Associates, Inc.  
5151 Jefferson Blvd., Suite 101  
Louisville, Kentucky 40219



# Aerial View of Site





# 6207 Whispering Hills Blvd - View of existing driveway, with site on the right

