

Planning Commission

Staff Report

August 3, 2017



Case No:	16zone1040
Project Name:	158 Thierman Lane
Location:	158 Thierman Lane
Owner(s):	Tom Winters
Applicant:	Tom Winters
Jurisdiction:	City of St. Matthews
Council District:	9-Bill Hollander
Case Manager:	Julia Williams, RLA, AICP, Planning Supervisor

REQUEST(S)

- Change in Zoning from R-6 to OR-1
- Variance to permit parking to encroach approximately 1' into the 5' setback (1'+/- variance) along the north property line
- Waiver to permit the encroachment of Vehicle Use Area (VUA) into the 15' LBA along the north property line.
- District Development Plan

CASE SUMMARY/BACKGROUND

The proposal is for the re-use of an existing building for an office use where 5 parking spaces will be added to the site. There is non-residential zoning and uses to the west, south, and east of the site. The applicant is proposing a sidewalk along the sites frontage and will be preserving the 2 large trees along Thierman Lane.

STAFF FINDING

Staff finds that the proposal meets the guidelines of the Comprehensive Plan and requirements of the Development Code. The proposal is located in a mixed multi-family/office area where parking is mainly located to the rear of the sites.

TECHNICAL REVIEW

All technical review issues have been resolved. Transportation Planning and MSD have preliminarily approved the proposal.

INTERESTED PARTY COMMENTS

None received.

STANDARD OF REVIEW FOR REZONING

Criteria for granting the proposed form district change/rezoning: *KRS Chapter 100.213*

1. The proposed form district/rezoning change complies with the applicable guidelines and policies Cornerstone 2020; OR

2. The existing form district/zoning classification is inappropriate and the proposed classification is appropriate; OR
3. There have been major changes of an economic, physical, or social nature within the area involved which were not anticipated in Cornerstone 2020 which have substantially altered the basic character of the area.

STAFF ANALYSIS FOR CHANGE IN ZONING

Following is staff's analysis of the proposed rezoning against the Guidelines and Policies of Cornerstone 2020.

The site is located in the Neighborhood Form District

The Neighborhood Form is characterized by predominantly residential uses that vary from low to high density and that blend compatibly into the existing landscape and neighborhood areas. High-density uses will be limited in scope to minor or major arterials and to areas that have limited impact on the low to moderate density residential areas.

The Neighborhood Form will contain diverse housing types in order to provide housing choice for differing ages and incomes. New neighborhoods are encouraged to incorporate these different housing types within a neighborhood as long as the different types are designed to be compatible with nearby land uses. These types may include, but not be limited to large lot single family developments with cul-de-sacs, neo-traditional neighborhoods with short blocks or walkways in the middle of long blocks to connect with other streets, villages and zero lot line neighborhoods with open space, and high density multi-family condominium-style or rental housing.

The Neighborhood Form may contain open space and, at appropriate locations, civic uses and neighborhood centers with a mixture of uses such as offices, retail shops, restaurants and services. These neighborhood centers should be at a scale that is appropriate for nearby neighborhoods. The Neighborhood Form should provide for accessibility and connectivity between adjacent uses and neighborhoods by automobile, pedestrian, bicycles and transit.

Neighborhood streets may be either curvilinear, rectilinear or in a grid pattern and should be designed to invite human interaction. Streets are connected and easily accessible to each other, using design elements such as short blocks or bike/walkways in the middle of long blocks to connect with other streets. Examples of design elements that encourage this interaction include narrow street widths, street trees, sidewalks, shaded seating/gathering areas and bus stops. Placement of utilities should permit the planting of shade trees along both sides of the streets.

The proposal is adjacent to R-7 and OR-3 zoning. There is also other OR zoning located across the street and in the area which indicates that the proposal will be integrated. A sidewalk is proposed along the frontage to accommodate pedestrians and transit users. The proposal is for an existing building to be used as offices. The curb cuts for the site are existing and will remain unchanged. All landscape buffer requirements will be met. The proposals high density but low intensity use is proposed for an area with similar uses as well as a mix of densities. Commercial is also located in the area which further makes the proposal compatible. The proposal is located within the existing SMC. The proposal will not create a new center but will be part of an existing center that has been established along the Thierman Lane corridor. An existing building is proposed to be re-used for offices.

All other agency comments should be addressed to demonstrate compliance with the remaining Guidelines and Policies of Cornerstone 2020.

A checklist is attached to the end of this staff report with a more detailed analysis. The Louisville Metro Planning Commission is charged with making a recommendation to the City of St. Matthews regarding

the appropriateness of this zoning map amendment. The City of St. Matthews has zoning authority over the property in question.

STANDARD OF REVIEW AND STAFF ANALYSIS FOR VARIANCE

- (a) The requested variance will not adversely affect the public health, safety or welfare.

STAFF: The variance will not affect the public as it will allow a portion of the existing driveway to continue to encroach and will allow for new access to a parking lot in the rear of the site.

- (b) The requested variance will not alter the essential character of the general vicinity.

STAFF: One of the adjacent sites is also an office site while the other is an apartment complex where the driveway is directly adjacent to the shared property line. Parking is located at the rear of the buildings so the character of the area will not be affected.

- (c) The requested variance will not cause a hazard or nuisance to the public.

STAFF: The public will not be affected by the encroachment of parking into the setback since most of the condition is existing and the other encroachment is for parking which is common for most of the lots along Theirman.

- (d) The requested variance will not allow an unreasonable circumvention of the zoning regulations.

STAFF: The variance is reasonable since most of the encroachment is existing and the new encroachment is for parking in the rear of the site which is the standard location for parking in this area.

ADDITIONAL CONSIDERATIONS:

1. The requested variance arises from special circumstances which do not generally apply to land in the general vicinity or the same zone.

STAFF: The variance arises from the site needing to access parking. Most of the encroachment is existing and the new encroachment is for parking in the rear of the site which is the standard location for parking in this area.

2. The strict application of the provisions of the regulation would deprive the applicant of the reasonable use of the land or create an unnecessary hardship on the applicant.

STAFF: The strict application of the code would require the demolition of an existing driveway and car port to gain access to rear parking which would be an unnecessary hardship for a mainly existing condition in an area that is mixed multi-family and office uses.

3. The circumstances are the result of actions of the applicant taken subsequent to the adoption of the zoning regulation from which relief is sought.

STAFF: The variance is the result of an existing condition on the site prior to the applicants ownership.

STANDARD OF REVIEW AND STAFF ANALYSIS FOR WAIVER

- (a) The waiver will not adversely affect adjacent property owners; and

STAFF: The reduction in LBA will not affect adjacent property owners because the landscape requirements will still be met.

- (b) The waiver will not violate specific guidelines of Cornerstone 2020; and

STAFF: Guideline 3, Policy 9 of Cornerstone 2020 calls for protection of the character of residential areas, roadway corridors and public spaces from visual intrusions and mitigation when appropriate. Guideline 3, Policies 21 and 22 call for appropriate transitions between uses that are substantially different in scale and intensity or density, and mitigation of the impact caused when incompatible developments occur adjacent to one another through the use of landscaped buffer yards, vegetative berms and setback requirements to address issues such as outdoor lighting, lights from automobiles, illuminated signs, loud noise, odors, smoke, automobile exhaust or other noxious smells, dust and dirt, litter, junk, outdoor storage, and visual nuisances. Guideline 3, Policy 24 states that parking, loading and delivery areas located adjacent to residential areas should be designed to minimize impacts from noise, lights and other potential impacts, and that parking and circulation areas adjacent to streets should be screened or buffered. Guideline 13, Policy 4 calls for ensuring appropriate landscape design standards for different land uses within urbanized, suburban, and rural areas. Guideline 13, Policy 6 calls for screening and buffering to mitigate adjacent incompatible uses. The intent of landscape buffer areas is to create suitable transitions where varying forms of development adjoin, to minimize the negative impacts resulting from adjoining incompatible land uses, to decrease storm water runoff volumes and velocities associated with impervious surfaces, and to filter airborne and waterborne pollutants. The waiver will not violate the comprehensive plan because the existing building will be renovated to have more of a residential appearance with parking to the rear which is characteristic of the area. The buffer requirements will still be met within the LBA.

- (c) The extent of the waiver of the regulation is the minimum necessary to afford relief to the applicant; and

STAFF: The waiver is necessary because much of the encroachment is due to the existing driveway and need to access parking.

- (d) Either:

(i) The applicant has incorporated other design measures that exceed the minimums of the district and compensate for non-compliance with the requirements to be waived (net beneficial effect); OR

(ii) The strict application of the provisions of the regulation would deprive the applicant of the reasonable use of the land or would create an unnecessary hardship on the applicant.

STAFF: The strict application of the provisions of the regulation would deprive the applicant of the reasonable use of the land or would create an unnecessary hardship on the applicant since the landscape requirements will still be met.

STANDARD OF REVIEW AND STAFF ANALYSIS FOR RDDDP and AMENDMENT TO BINDING ELEMENTS

- a. The conservation of natural resources on the property proposed for development, including: trees and other living vegetation, steep slopes, water courses, flood plains, soils, air quality, scenic views, and historic sites;

STAFF: There do not appear to be any environmental constraints or historic resources on the subject site.

- b. The provisions for safe and efficient vehicular and pedestrian transportation both within the development and the community;

STAFF: Provisions for safe and efficient vehicular and pedestrian transportation within and around the development and the community has been provided, and Metro Public Works has approved the preliminary development plan.

- c. The provision of sufficient open space (scenic and recreational) to meet the needs of the proposed development;

STAFF: There are no open space requirements pertinent to the current proposal.

- d. The provision of adequate drainage facilities on the subject site in order to prevent drainage problems from occurring on the subject site or within the community;

STAFF: The Metropolitan Sewer District has approved the preliminary development plan and will ensure the provision of adequate drainage facilities on the subject site in order to prevent drainage problems from occurring on the subject site or within the community.

- e. The compatibility of the overall site design (location of buildings, parking lots, screening, landscaping) and land use or uses with the existing and projected future development of the area;

STAFF: The overall site design and land uses are compatible with the existing and future development of the area. Appropriate landscape buffering and screening will be provided to screen adjacent properties and roadways.

- f. Conformance of the development plan with the Comprehensive Plan and Land Development Code.

STAFF: The development plan conforms to applicable guidelines and policies of the Comprehensive Plan and to requirements of the Development Code.

REQUIRED ACTIONS:

- **RECOMMEND** that the City of St. Matthews **APPROVE** or **DENY** the **Change-in-Zoning** from R-6 to OR-1
- **APPROVE** or **DENY** the **Variance**
- **RECOMMEND** that the City of St. Matthews **APPROVE** or **DENY** the LBA waiver
- **RECOMMEND** that the City of St. Matthews **APPROVE** or **DENY** the **District Development Plan with Binding Elements**

Based upon the information in the staff report, the testimony and evidence provided at the public hearing, the Planning Commission must determine if the proposal is in conformance with the Comprehensive Plan; OR the existing form district/zoning classification is inappropriate and the proposed classification is appropriate; OR if there have been major changes of an economic, physical, or social nature within the area involved which were not anticipated in Cornerstone 2020 which have substantially altered the basic character of the area.

NOTIFICATION

Date	Purpose of Notice	Recipients
6/29/17	Hearing before LD&T on 7/13/17	1 st and 2 nd tier adjoining property owners Registered Neighborhood Groups in Council District 9
7/18/17	Hearing before PC on August 3, 2017	1 st and 2 nd tier adjoining property owners Registered Neighborhood Groups in Council District 9
7/19/17	Hearing before PC	Sign Posting on property
	Hearing before PC	Legal Advertisement in the Courier-Journal

ATTACHMENTS

1. Zoning Map
2. Aerial Photograph
3. Staff Cornerstone 2020 Checklist
4. Proposed Binding Elements

1. Zoning Map

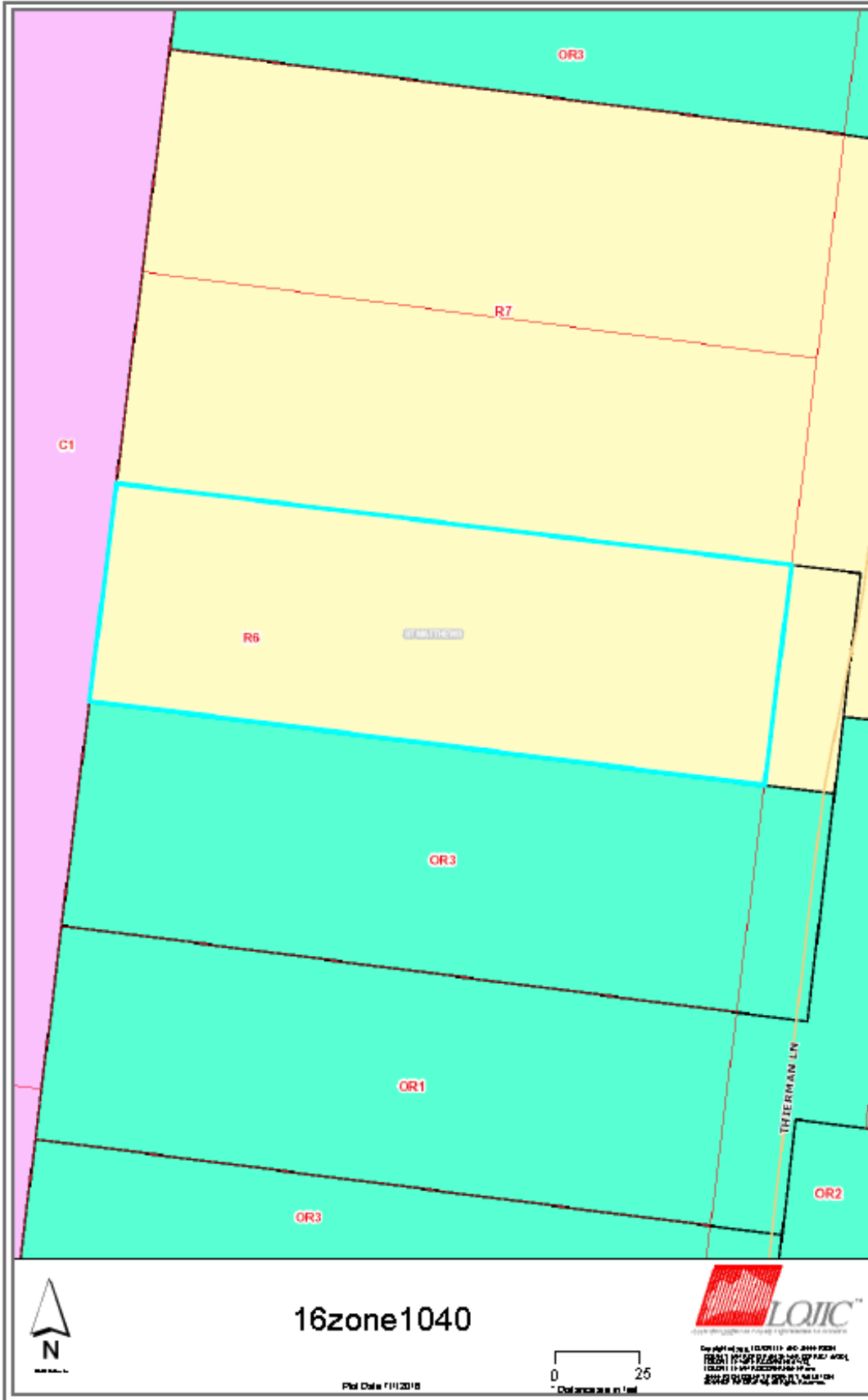

2. Aerial Photograph



3. Staff Cornerstone 2020 Checklist

- + Exceeds Guideline
- ✓ Meets Guideline
- Does Not Meet Guideline
- +/- More Information Needed
- NA Not Applicable

Suburban Marketplace Corridor: Non-Residential

#	Cornerstone 2020 Plan Element	Plan Element or Portion of Plan Element	Staff Finding	Staff Comments
1	Community Form/Land Use Guideline 1: Community Form	B.8: The proposal integrates into the existing pattern of development, which includes a mixture of medium- to high-density uses.	✓	The proposal is adjacent to R-7 and OR-3 zoning. There is also other OR zoning located across the street and in the area which indicates that the proposal will be integrated.
2	Community Form/Land Use Guideline 1: Community Form	B.8: The proposal provides accommodations for transit users, pedestrians and bicyclists and provides connectivity to adjacent developments.	✓	A sidewalk is proposed along the frontage to accommodate pedestrians and transit users.
3	Community Form/Land Use Guideline 1: Community Form	B.8: The proposal includes a compact group of buildings using the same curb cut, parking and signs, and that have a common buffering or streetscape plan with respect to any abutting lower density or intensity uses.	✓	The proposal is for an existing building to be used as offices. The curb cuts for the site are existing and will remain unchanged. All landscape buffer requirements will be met.
4	Community Form/Land Use Guideline 1: Community Form	B.8: The proposal is of a medium to high density designed to be compatible with both non-residential development in the corridor and adjacent low density residential development in other form districts.	✓	The proposals high density but low intensity use is proposed for an area with similar uses as well as a mix of densities. Commercial is also located in the area which further makes the proposal compatible.
5	Community Form/Land Use Guideline 1: Community Form	B.8: The proposal is located within the boundaries of the existing form district, and if the proposal is to expand an existing corridor, the justification for doing so addresses the use or reuse of land within the existing corridor, the potential for disruption of established residential neighborhoods, and compliance with the site and community design standards of the Land Development Code.	✓	The proposal is located within the existing SMC.
6	Community Form/Land Use Guideline 2: Centers	A.1/7: The proposal, which will create a new center, is located in the Suburban Marketplace Corridor Form District, and includes new construction or the reuse of existing buildings to provide commercial, office and/or residential use.	✓	The proposal will not create a new center but will be part of an existing center that has been established along the Thierman Lane corridor. An existing building is proposed to be re-used for offices.

#	Cornerstone 2020 Plan Element	Plan Element or Portion of Plan Element	Staff Finding	Staff Comments
7	Community Form/Land Use Guideline 2: Centers	A.3: The proposed retail commercial development is located in an area that has a sufficient population to support it.	NA	The proposal is not for commercial.
8	Community Form/Land Use Guideline 2: Centers	A.4: The proposed development is compact and results in an efficient land use pattern and cost-effective infrastructure investment.	✓	The proposal results in an efficient land use pattern because OR-3 and C-1 is located adjacent to and around the site making the proposal cost effective for infrastructure as well.
9	Community Form/Land Use Guideline 2: Centers	A.5: The proposed center includes a mix of compatible land uses that will reduce trips, support the use of alternative forms of transportation and encourage vitality and sense of place.	✓	The proposal is for one use, office. All types of transportation are provided for.
10	Community Form/Land Use Guideline 2: Centers	A.6: The proposal incorporates residential and office uses above retail and/or includes other mixed-use, multi-story retail buildings.	✓	The proposal is for office only. Retail is not proposed.
11	Community Form/Land Use Guideline 2: Centers	A.12: If the proposal is a large development in a center, it is designed to be compact and multi-purpose, and is oriented around a central feature such as a public square or plaza or landscape element.	NA	The proposal is not a large development.
12	Community Form/Land Use Guideline 2: Centers	A.13/15: The proposal shares entrance and parking facilities with adjacent uses to reduce curb cuts and surface parking, and locates parking to balance safety, traffic, transit, pedestrian, environmental and aesthetic concerns.	✓	Entrances to the site will remain unchanged. Parking is to the rear of the site which is common for the area and allows for pedestrian access across the frontage.
13	Community Form/Land Use Guideline 2: Centers	A.14: The proposal is designed to share utility hookups and service entrances with adjacent developments, and utility lines are placed underground in common easements.	✓	No new utilities are proposed.
14	Community Form/Land Use Guideline 2: Centers	A.16: The proposal is designed to support easy access by bicycle, car and transit and by pedestrians and persons with disabilities.	✓	The site can be easily accessed by all forms of transportation.
15	Community Form/Land Use Guideline 3: Compatibility	A.2: The proposed building materials increase the new development's compatibility.	NA	More information is necessary.

#	Cornerstone 2020 Plan Element	Plan Element or Portion of Plan Element	Staff Finding	Staff Comments
16	Community Form/Land Use Guideline 3: Compatibility	A.4/5/6/7: The proposal does not constitute a non-residential expansion into an existing residential area, or demonstrates that despite such an expansion, impacts on existing residences (including traffic, parking, signs, lighting, noise, odor and stormwater) are appropriately mitigated.	✓	The proposal is not a non-residential expansion into a residential area. The area is mixed with both residential and non-residential.
17	Community Form/Land Use Guideline 3: Compatibility	A.5: The proposal mitigates any potential odor or emissions associated with the development.	✓	APCD has no issues with the proposal.
18	Community Form/Land Use Guideline 3: Compatibility	A.6: The proposal mitigates any adverse impacts of its associated traffic on nearby existing communities.	✓	Transportation Planning has not indicated that there will be an issue with traffic.
19	Community Form/Land Use Guideline 3: Compatibility	A.8: The proposal mitigates adverse impacts of its lighting on nearby properties, and on the night sky.	✓	Lighting will meet LDC requirements.
20	Community Form/Land Use Guideline 3: Compatibility	A.11: If the proposal is a higher density or intensity use, it is located along a transit corridor AND in or near an activity center.	✓	The proposal permits high density but is a low intensity land use. The proposal is located on a transit route and within an existing activity corridor.
21	Community Form/Land Use Guideline 3: Compatibility	A.21: The proposal provides appropriate transitions between uses that are substantially different in scale and intensity or density of development such as landscaped buffer yards, vegetative berms, compatible building design and materials, height restrictions, or setback requirements.	✓	The existing building will remain unchanged and a minimum 5' LBA between the site and the adjacent R-7 zoned apartments.
22	Community Form/Land Use Guideline 3: Compatibility	A.22: The proposal mitigates the impacts caused when incompatible developments unavoidably occur adjacent to one another by using buffers that are of varying designs such as landscaping, vegetative berms and/or walls, and that address those aspects of the development that have the potential to adversely impact existing area developments.	✓	The existing building will remain unchanged and a minimum 5' LBA between the site and the adjacent R-7 zoned apartments.
23	Community Form/Land Use Guideline 3: Compatibility	A.23: Setbacks, lot dimensions and building heights are compatible with those of nearby developments that meet form district standards.	✓	Setbacks and lot dimensions will not change with this proposal.

#	Cornerstone 2020 Plan Element	Plan Element or Portion of Plan Element	Staff Finding	Staff Comments
24	Community Form/Land Use Guideline 3: Compatibility	A.24: Parking, loading and delivery areas located adjacent to residential areas are designed to minimize adverse impacts of lighting, noise and other potential impacts, and that these areas are located to avoid negatively impacting motorists, residents and pedestrians.	✓	The proposed parking area is at the rear of the property similar to that of the adjacent residential property.
25	Community Form/Land Use Guideline 3: Compatibility	A.24: The proposal includes screening and buffering of parking and circulation areas adjacent to the street, and uses design features or landscaping to fill gaps created by surface parking lots. Parking areas and garage doors are oriented to the side or back of buildings rather than to the street.	✓	The 5' LBA will screen the parking lots from each other.
26	Community Form/Land Use Guideline 3: Compatibility	A.25: Parking garages are integrated into their surroundings and provide an active, inviting street-level appearance.	NA	A parking garage is not proposed.
27	Community Form/Land Use Guideline 3: Compatibility	A.28: Signs are compatible with the form district pattern and contribute to the visual quality of their surroundings.	✓	Signs will meet development code requirements.
28	Community Form/Land Use Guideline 4: Open Space	A.2/3/7: The proposal provides open space that helps meet the needs of the community as a component of the development and provides for the continued maintenance of that open space.	✓	The open space on the site is consistent with the open space areas for the adjacent sites and the area.
29	Community Form/Land Use Guideline 4: Open Space	A.4: Open space design is consistent with the pattern of development in the Neighborhood Form District.	✓	The open space on the site is consistent with the open space areas for the adjacent sites and the area.
30	Community Form/Land Use Guideline 4: Open Space	A.5: The proposal integrates natural features into the pattern of development.	NA	There are no natural features evident on the property.
31	Community Form/Land Use Guideline 5: Natural Areas and Scenic and Historic Resources	A.1: The proposal respects the natural features of the site through sensitive site design, avoids substantial changes to the topography and minimizes property damage and environmental degradation resulting from disturbance of natural systems.	✓	The proposal is for the addition of parking and a change in use. The topography will not change dramatically due to the proposal.

#	Cornerstone 2020 Plan Element	Plan Element or Portion of Plan Element	Staff Finding	Staff Comments
32	Community Form/Land Use Guideline 5: Natural Areas and Scenic and Historic Resources	A.2/4: The proposal includes the preservation, use or adaptive reuse of buildings, sites, districts and landscapes that are recognized as having historical or architectural value, and, if located within the impact area of these resources, is compatible in height, bulk, scale, architecture and placement.	✓	The proposal is for the reuse of an existing building that has no historical or cultural value.
33	Community Form/Land Use Guideline 5: Natural Areas and Scenic and Historic Resources	A.6: Encourage development to avoid wet or highly permeable soils, severe, steep or unstable slopes with the potential for severe erosion.	✓	Soils are not an issue with the proposal.
34	Marketplace Guideline 6: Economic Growth and Sustainability	A.3: Encourage redevelopment, reinvestment and rehabilitation in the downtown where it is consistent with the form district pattern.	NA	The proposal is not located in a downtown.
35	Marketplace Guideline 6: Economic Growth and Sustainability	A.4: Encourage industries to locate in industrial subdivisions or adjacent to existing industry to take advantage of special infrastructure needs.	NA	The proposal is not for industrial development.
36	Marketplace Guideline 6: Economic Growth and Sustainability	A.6: Locate retail commercial development in activity centers. Locate uses generating large amounts of traffic on a major arterial, at the intersection of two minor arterials or at locations with good access to a major arterial and where the proposed use will not adversely affect adjacent areas.	NA	The proposal is not for retail zoning.
37	Marketplace Guideline 6: Economic Growth and Sustainability	A.8: Require industrial development with more than 100 employees to locate on or near an arterial street, preferably in close proximity to an expressway interchange. Require industrial development with less than 100 employees to locate on or near an arterial street.	NA	The proposal is not for industrial development.
38	Mobility/Transportation Guideline 7: Circulation	A.1/2: The proposal will contribute its proportional share of the cost of roadway improvements and other services and public facilities made necessary by the development through physical improvements to these facilities, contribution of money, or other means.	✓	Transportation Planning has not indicated that roadway improvements are necessary.

#	Cornerstone 2020 Plan Element	Plan Element or Portion of Plan Element	Staff Finding	Staff Comments
39	Mobility/Transportation Guideline 7: Circulation	A.3/4: The proposal promotes mass transit, bicycle and pedestrian use and provides amenities to support these modes of transportation.	✓	Amenities are available for pedestrians and transit users. Bicycles will use the roadways.
40	Mobility/Transportation Guideline 7: Circulation	A.6: The proposal's transportation facilities are compatible with and support access to surrounding land uses, and contribute to the appropriate development of adjacent lands. The proposal includes at least one continuous roadway through the development, adequate street stubs, and relies on cul-de-sacs only as short side streets or where natural features limit development of "through" roads.	✓	Amenities are available for pedestrians and transit users. Bicycles will use the roadways.
41	Mobility/Transportation Guideline 7: Circulation	A.9: The proposal includes the dedication of rights-of-way for street, transit corridors, bikeway and walkway facilities within or abutting the development.	✓	Dedication of ROW will be required to accommodate the sidewalk.
42	Mobility/Transportation Guideline 7: Circulation	A.10: The proposal includes adequate parking spaces to support the use.	✓	Parking is being provided for the proposed use.
43	Mobility/Transportation Guideline 7: Circulation	A.13/16: The proposal provides for joint and cross access through the development and to connect to adjacent development sites.	✓	Cross access is not required.
44	Mobility/Transportation Guideline 8: Transportation Facility Design	A.8: Adequate stub streets are provided for future roadway connections that support and contribute to appropriate development of adjacent land.	NA	No new roads are being provided.
45	Mobility/Transportation Guideline 8: Transportation Facility Design	A.9: Avoid access to development through areas of significantly lower intensity or density if such access would create a significant nuisance.	✓	Access to the lot is within the site and not through a lower density area.
46	Mobility/Transportation Guideline 8: Transportation Facility Design	A.11: The development provides for an appropriate functional hierarchy of streets and appropriate linkages between activity areas in and adjacent to the development site.	NA	No new roads are being provided.

#	Cornerstone 2020 Plan Element	Plan Element or Portion of Plan Element	Staff Finding	Staff Comments
47	Mobility/Transportation Guideline 9: Bicycle, Pedestrian and Transit	A.1/2: The proposal provides, where appropriate, for the movement of pedestrians, bicyclists and transit users around and through the development, provides bicycle and pedestrian connections to adjacent developments and to transit stops, and is appropriately located for its density and intensity.	✓	Pedestrians and transit users are being provided for with sidewalks while bicycles are being provided for with the driveway.
48	Livability/Environment Guideline 10: Flooding and Stormwater	The proposal's drainage plans have been approved by MSD, and the proposal mitigates negative impacts to the floodplain and minimizes impervious area. Solid blue line streams are protected through a vegetative buffer, and drainage designs are capable of accommodating upstream runoff assuming a fully-developed watershed. If streambank restoration or preservation is necessary, the proposal uses best management practices.	✓	MSD has preliminarily approved the proposal.
49	Livability/Environment Guideline 12: Air Quality	The proposal has been reviewed by APCD and found to not have a negative impact on air quality.	✓	APCD has no issues with the proposal.
50	Livability/Environment Guideline 13: Landscape Character	A.3: The proposal includes additions and connections to a system of natural corridors that can provide habitat areas and allow for migration.	✓	Natural features are not evident on the site.
51	Community Facilities Guideline 14: Infrastructure	A.2: The proposal is located in an area served by existing utilities or planned for utilities.	✓	Existing utilities will serve the site.
52	Community Facilities Guideline 14: Infrastructure	A.3: The proposal has access to an adequate supply of potable water and water for fire-fighting purposes.	✓	Water is available to the site.
53	Community Facilities Guideline 14: Infrastructure	A.4: The proposal has adequate means of sewage treatment and disposal to protect public health and to protect water quality in lakes and streams.	✓	The health department has no issues with the proposal.

4. Proposed Binding Elements

1. The development shall be in accordance with the approved district development plan, all applicable sections of the Land Development Code (LDC) and agreed upon binding elements unless amended pursuant to the Land Development Code. Any changes/additions/alterations of any binding element(s) shall be submitted to the Planning Commission or the Planning Commission's designee and to the City of St. Matthews for review and approval; any changes/additions/alterations not so referred shall not be valid.
2. No outdoor advertising signs, small freestanding signs, pennants, balloons, or banners shall be permitted on the site.
3. Construction fencing shall be erected when off-site trees or tree canopy exists within 3' of a common property line. Fencing shall be in place prior to any grading or construction to protect the existing root systems from compaction. The fencing shall enclose the entire area beneath the tree canopy and shall remain in place until all construction is completed. No parking, material storage or construction activities are permitted within the protected area.
4. Before any permit (including but not limited to building, parking lot, change of use, site disturbance, alteration permit or demolition permit) is requested:
 - a. The development plan must receive full construction approval from Develop Louisville, Louisville Metro Public Works and the Metropolitan Sewer District.
 - b. A minor subdivision plat or legal instrument shall be recorded dedicating additional right-of-way to Thierman Lane to provide a total of 34 feet from the centerline. A copy of the recorded instrument shall be submitted to the Division of Planning and Design Services prior to obtaining a building permit.
 - c. The property owner/developer must obtain approval of a detailed plan for screening (buffering/landscaping) as described in Article 12 prior to requesting a building permit. Such plan shall be implemented prior to occupancy of the site and shall be maintained thereafter.
5. If a certificate of occupancy (building permit) is not issued within one year of the date of approval of the plan or rezoning, whichever is later, the property shall not be used in any manner unless a revised district development plan is approved or an extension is granted by the Planning Commission.
6. A certificate of occupancy must be received from the appropriate code enforcement department prior to occupancy of the structure or land for the proposed use. All binding elements requiring action and approval must be implemented prior to requesting issuance of the certificate of occupancy, unless specifically waived by the Planning Commission.
7. There shall be no outdoor music (live, piped, radio or amplified) or outdoor entertainment or outdoor PA system audible beyond the property line.
8. The applicant, developer, or property owner shall provide copies of these binding elements to tenants, purchasers, contractors, subcontractors and other parties engaged in development of this site and shall advise them of the content of these binding elements. These binding elements shall run with the land and the owner of the property and occupant of the property shall at all times be responsible for compliance with these binding elements. At all times during development of the site, the applicant and developer, their heirs, successors; and assignees, contractors, subcontractors, and other parties engaged in development of the site, shall be responsible for compliance with these binding elements.