

PRELIMINARY APPROVAL

Condition of Approval:

Development Review Date

LOUISVILLE & JEFFERSON COUNTY METROPOLITAN SEWER DISTRICT

Table with columns for Block, Lot No., Lot Size, and various area calculations for blocks A through H.

Table with columns for Building Type, Gross Building Footprint Area, Gross Building Floor Area, and Height (Mid Point of Roof).

PARKING STATISTICS table showing required and proposed parking spaces for blocks A through H.

SITE STATISTICS table showing acreage, number of units, tree canopy coverage, and gross site area.

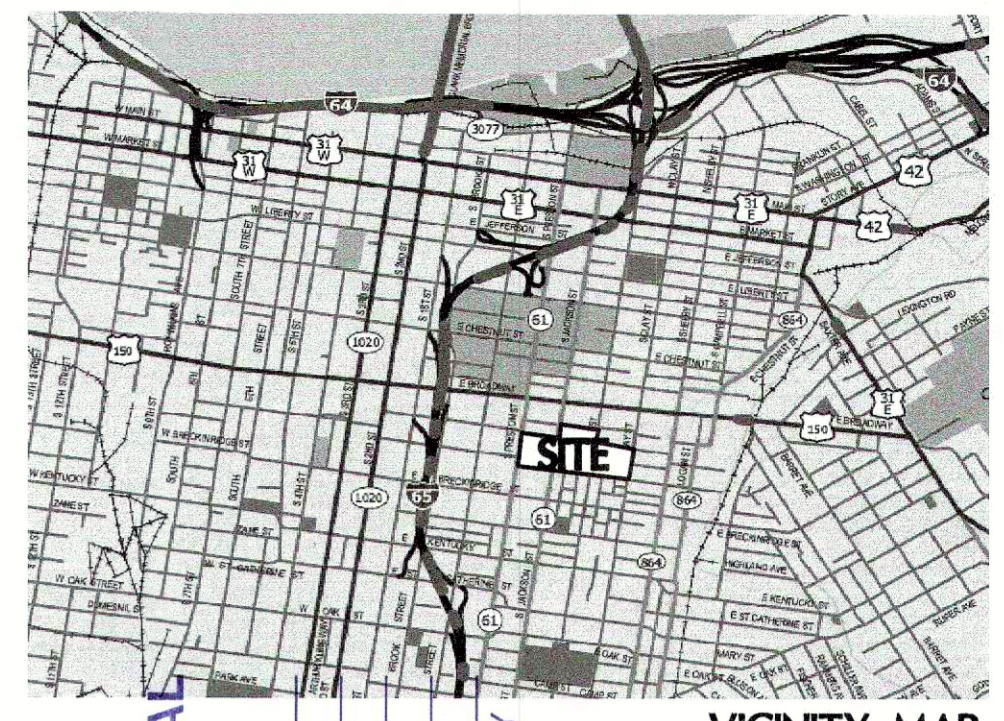

PRELIMINARY APPROVAL DEVELOPMENT PLAN CONDITIONS. BY: [Signature] DATE: 7-13-17 LOUISVILLE/JEFFERSON COUNTY METRO PUBLIC WORKS

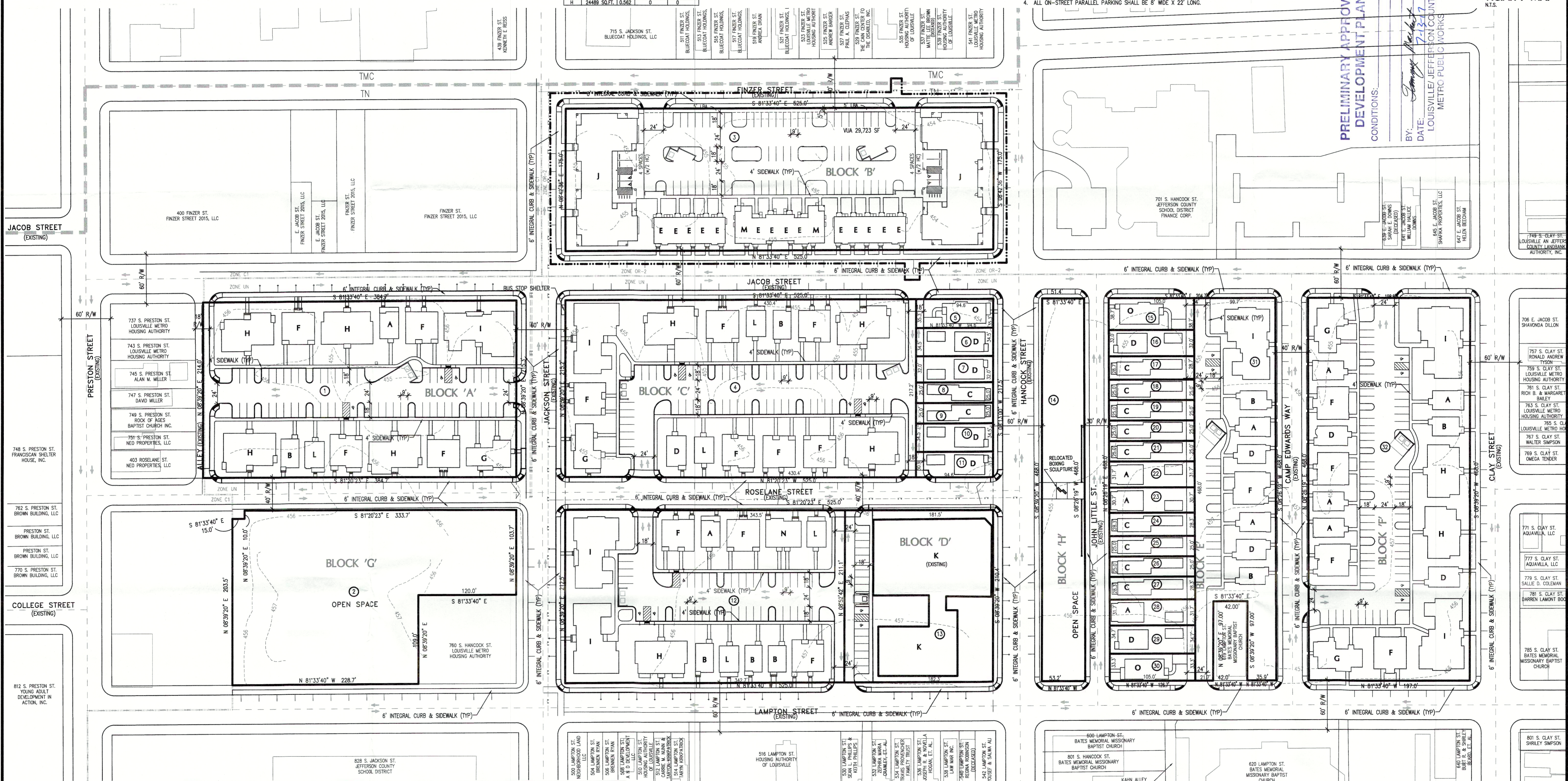

UNIT MIX CHART showing unit counts for various unit types (A, B, C, D, E, F, G, H, I, J, K, L, M, N, O) across different blocks.

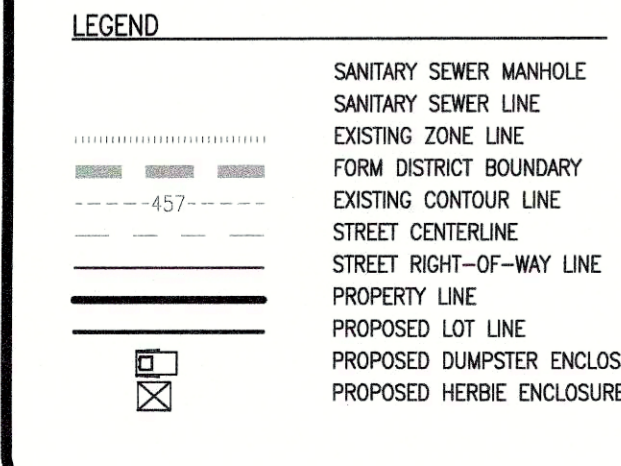

EROSION PREVENTION AND SEDIMENT CONTROL NOTES. 1. THE APPROVED EROSION PREVENTION AND SEDIMENT CONTROL (EPSC) PLAN SHALL BE IMPLEMENTED PRIOR TO ANY LAND-DISTURBING ACTIVITY ON THE CONSTRUCTION SITE.

WDO GENERAL NOTES. 1. WDO NOTES. 2. WDO SANITARY SEWERS ARE AVAILABLE BY I.E. SUBJECT TO FEES AND CHARGES. SEWAGE TO BE TREATED AT THE WORKS FURNISH WOTC. FEES WILL BE DUE FOR ANY NEW CONNECTIONS TO THE WDO SYSTEMS.

STORMWATER NOTES. 1. IMPERVIOUS AREA (LOTS 5-30): EXISTING IMPERVIOUS SURFACE: 34,222 SQ.FT. PROPOSED IMPERVIOUS SURFACE: 33,775 SQ.FT. NET IMPERVIOUS SURFACE: (447 SQ.FT.)

DEPARTMENT OF PUBLIC HEALTH & WELLNESS GENERAL NOTES. 1. R00P 18994. *EXISTING PROPOSED BUILDING MUST CONNECT TO ITS OWN SANITARY SEWER PSC WITH A MINIMUM SIX INCH SANITARY SEWER.

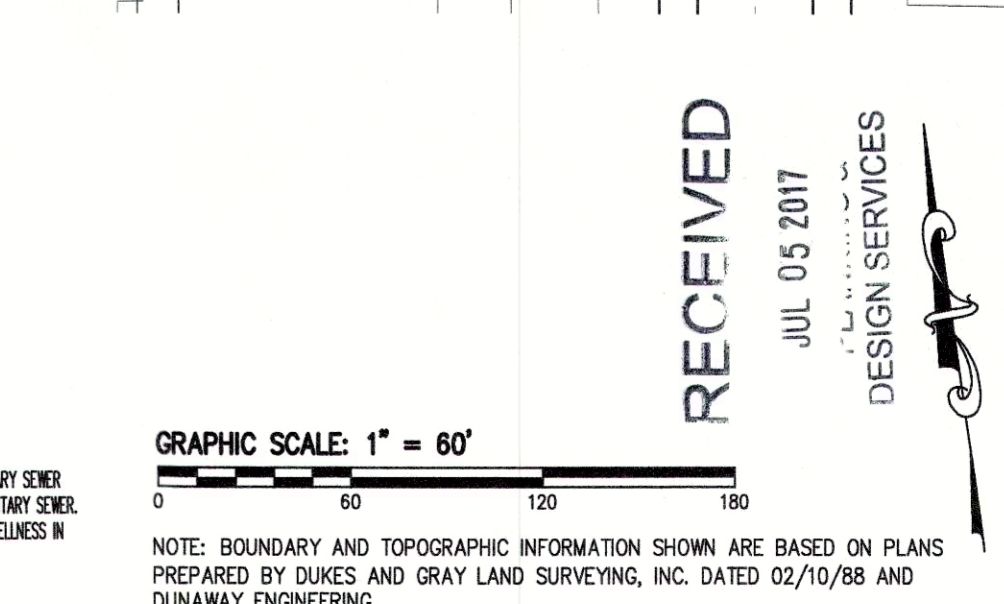

Vertical sidebar containing project title: SHEPPARD SQUARE RDDP & REVISED PRELIMINARY SUBDIVISION PLAN, DEVELOPMENT PLAN, Sherman-Carter-Barnhart logo, JOB NO. 0327.14, DATE 10/26/09, DRAWN CBS, CHECKED SIMM, COPYRIGHT © 2013 SHERMAN / CARTER / BARNHART, PSC, REVISIONS list, SHEET number, and RECEIVED stamp.