

EASTVIEW AVE

(R5)  
NEIGHBORING PROPERTY  
SINGLE FAMILY RESIDENCE

EXISTING  
6' TALL WOOD PRIVACY FENCE

2173 EASTVIEW AVENUE  
PARCEL ID: 080B01490000

NEW  
TWO STORY  
ADDITION  
422 GSF PER  
FLOOR  
844 GSF TOTAL

EXISTING  
TWO STORY BUILDING  
WITH LOWER LEVEL  
4354 GSF TOTAL  
FINISH FLOOR ELEVATION = 100'-0"

GRASS AREA  
AND EXISTING  
TREES

EXISTING 6' TALL WOOD  
PRIVACY FENCE

(C2) NEIGHBORING PROPERTY

EXISTING SIDEWALK

EXISTING WALK

GRASS

EXISTING LANDSCAPING

CONCRETE  
STAIR

GRASS  
AREA

EXISTING  
ASPHALT  
PARKING PAD

EXISTING  
ASPHALT

EXISTING SIDEWALK

EXISTING SIDEWALK

EXISTING  
LANDSCAPING

BARDSTOWN ROAD

EXISTING CURB CUT

GRASS

HYDRANT



01/A5.0

02/A5.1

01/A5.1

02/A5.0

NEW WALK

NEW ADA RAMP

NEW SHRUBS

NEW SHRUBS

EXISTING  
LANDSCAPING

16'-0"

22'-5"

18'-0"

82'-5"

25'-8"

8'-9"

26'-5"

RECEIVED  
NOV 08 2019  
PLANNING &  
DESIGN SERVICES

VARIANCE TO LDC 5.2.3.D.3.  
REQUIRED: 15'-0" MAX. SETBACK  
REQUESTING 18'-0" & 22'-5"  
SETBACK

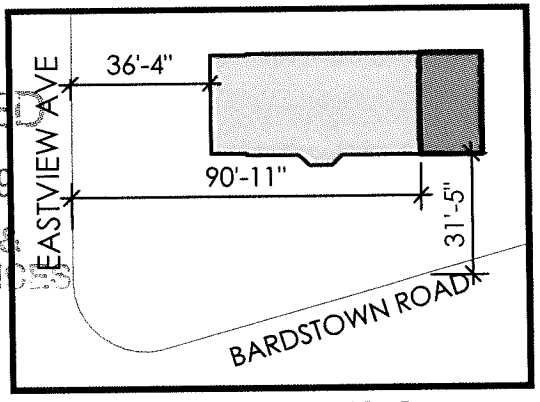

VICINITY PLAN: NOT TO SCALE

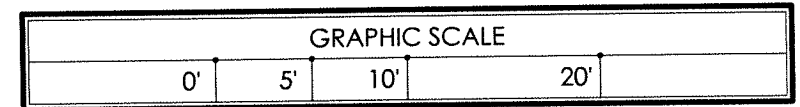

SITE PLAN REFER TO SHEET A1.0		
O'NEILL FAMILY DENTISTRY OFFICE RENOVATION / ADDITION 2173 EASTVIEW AVE LOUISVILLE, KY 40205	SK-01	
SCALE: 1"=10'-0"	19P16	07 NOVEMBER 2019
FOXWORTH ARCHITECTURE, PLLC 903 LYDIA STREET LOUISVILLE, KENTUCKY 40217 Phone: 502.418.6270 Email: info@foxworth-arch.com		

19 - VARIANCE - 0066