

**Louisville Metro Council City Agency Request**

**Neighborhood Development Fund (NDF)**

✓ **Capital Infrastructure Fund (CIF)**

**Municipal Aid Program (MAP)**

**Paving Fund (PAV)**

**Primary Sponsor:** Councilwoman Jessica Green

**Amount:** \$ 5,648.53 **Date:** 9/20/2019

**Description of program/project including public purpose, additional funding sources, location of project/program and any external grantee(s):**  
CIF funds requested to repair or replace dangerous and defective sidewalks in council district 1 .  
#1 6504 Jennifer Valley Way \$ 2,420.53  
#2 6511 Jennifer Valley Way \$ 1,968.00  
#3 6517 Jennifer Valley Way \$ 1,260.00  
Total = \$ 5,648.53

**City Agency:** Metro Public Works  
**Contact Person:** Craig Allen  
**Agency Phone:** 502 574 6159

**I have reviewed this request for an expenditure of city tax dollars, and have determined the funds will be used for a public purpose and have the attached documentation from the receiving department concerning the project/expenditure.**

1		\$5,648.53	9/20/2019
District #	Council Member Signature	Amount	Date

**Approved by:** \_\_\_\_\_  
Appropriations Committee Chairman Date

**Clerk's Office & OMB Use Only:**

Request Amount: \_\_\_\_\_ Amended Amount: \_\_\_\_\_

Reference #: CIF1002MPW01 To OMB: \_\_\_\_\_

Budget Revision #: \_\_\_\_\_

Account #: \_\_\_\_\_

To Project Manager: \_\_\_\_\_ Completion Date: \_\_\_\_\_

Actual Cost: \_\_\_\_\_ Funds Returned: \_\_\_\_\_

## NDF, CIF, MAP OR PAV INTERAGENCY CHECKLIST

<b>Interagency Name:</b> Metro Public Works	
<b>Program/Project Name:</b> Jennifer Valley Way sidewalk repair or replacement	<b>Yes/No/NA</b>
<b>Request Form:</b> Is the Request Signed by all Council Member(s) Appropriating Funding?	Yes
<b>Request Form:</b> If matching funds are to be used, are they disclosed with account numbers in the request form description?	NA
<b>Request Form:</b> If matching funds are to be used, does the amount of the request exclude the matching fund amount?	NA
<b>Request Form:</b> If other funds are to be used for this project, are they disclosed with account numbers in the request form description?	NA
<b>Funding Source:</b> If CIF is being requested, does Metro Louisville own/will own the real estate, building or equipment? If not, the funding source is probably NDF.	Yes
<b>Funding Source:</b> If CIF is being requested, does the project have a useful life of more than one year? If not, the funding source is probably NDF.	Yes
<b>Ordinance Required:</b> Is the NDF request to a Metro Agency greater than \$5,000? If so, an ordinance is required.	NA
<b>Ordinance Required:</b> Is the request a transfer from NDF to cost center? If so, is the amount given for the fiscal year \$25,000 or less?	NA
<b>Supporting Documentation:</b> Does the attachment include a valid estimate and description of cost?	Yes

Submitted by: \_\_\_\_\_



Date: 9/20/2019

## Weathers, Charles

---

**From:** Allen, Craig L  
**Sent:** Friday, September 13, 2019 11:15 AM  
**To:** Weathers, Charles  
**Subject:** D1 Sidewalk Repairs

Charles,

Please see the below estimates. 6504 and 6511 Jennifer Valley Way are the estimates you requested. While I was there I saw multiple other bad sidewalks on the block but 6517 Jennifer Valley Way really stood out as worse than the rest so I included an estimate for this one as well.

There is a tree at each address causing the trip hazards. I am going to ask the Arborist for his recommendation on whether or not the trees need to be removed or can be salvaged. If one or more of the trees don't need to be removed the total cost would go down. If you have any other questions please let me know.

LOCATION	6504 Jennifer Valley Way
REQUESTED BY	Dist 1
RATE	4
DATE SENT	9/13/2019
ESTIMATE BY	CA
MEASUREMENTS/COMMENTS	20'x4' of sw, one water valve, one 12-24" tree, seed and protection
ESTIMATE AMOUNT	\$2,420.53
<p><b>Estimate is valid for 120 days from date sent.</b>  <b>Any requests after 120 days will require re-inspection.</b></p>	

\$ 5648.53

LOCATION	6511 Jennifer Valley Way
REQUESTED BY	Dist 1
RATE	3
DATE SENT	9/13/2019
ESTIMATE BY	CA
MEASUREMENTS/COMMENTS	10'x4' of sw, one 12-24" tree, seed and protection
ESTIMATE AMOUNT	\$1,968.00
<p><b>Estimate is valid for 120 days from date sent.</b>  <b>Any requests after 120 days will require re-inspection.</b></p>	

LOCATION	6517 Jennifer Valley Way
REQUESTED BY	Dist 1
RATE	5
DATE SENT	9/13/2019
ESTIMATE BY	CA

MEASUREMENTS/COMMENTS	15'x4' of sw, one <12" tree, seed and protection
ESTIMATE AMOUNT	\$1,260.00
<b><i>Estimate is valid for 120 days from date sent. Any requests after 120 days will require re-inspection.</i></b>	

Thanks,

Craig Allen, PE  
 Engineer II  
 Louisville Metro Public Works & Assets  
 444 South 5<sup>th</sup> Street, 4<sup>th</sup> Floor  
 Louisville KY 40202  
 (502)574-6159

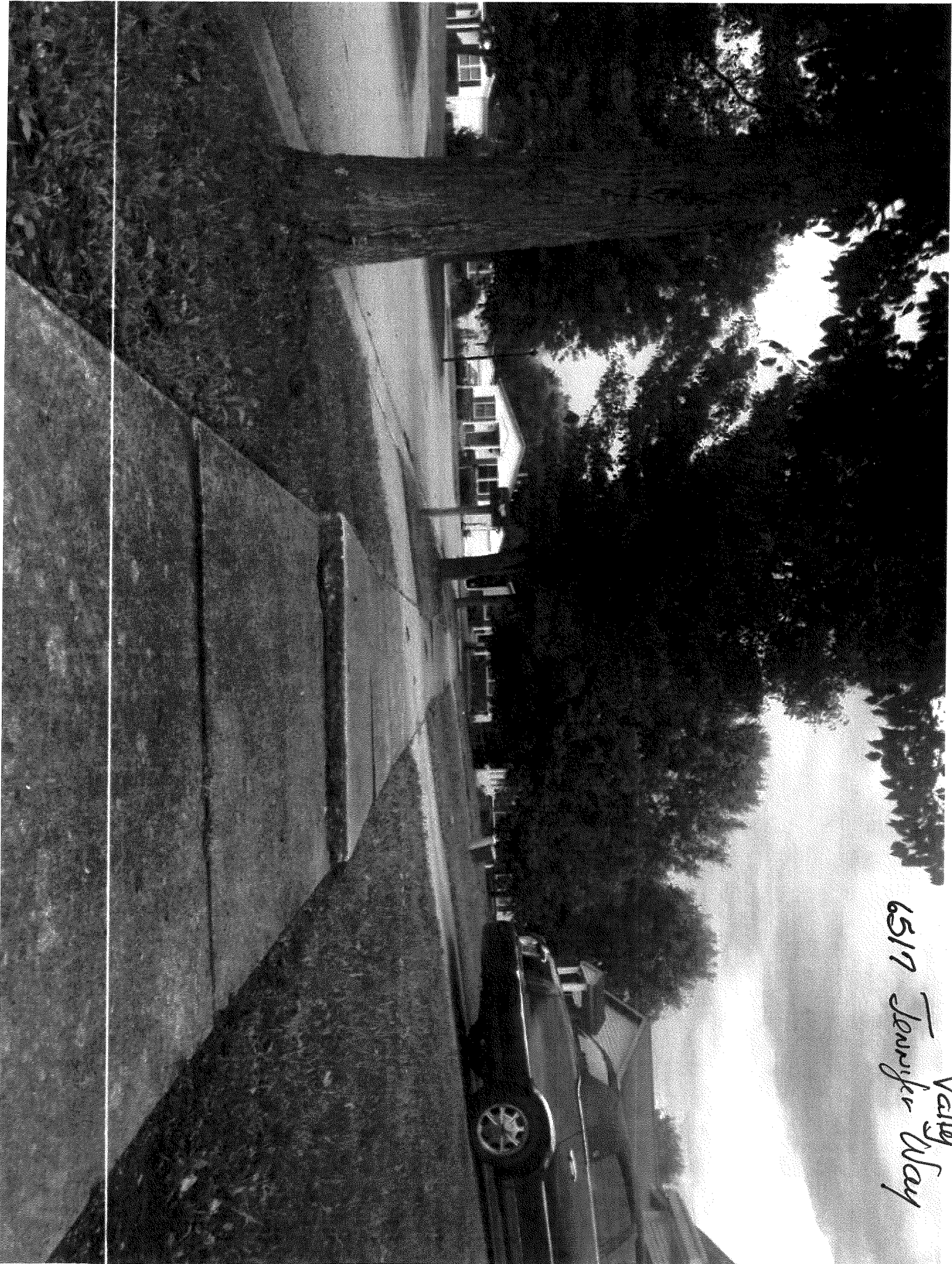

6517 Jennifer Way  
Valley



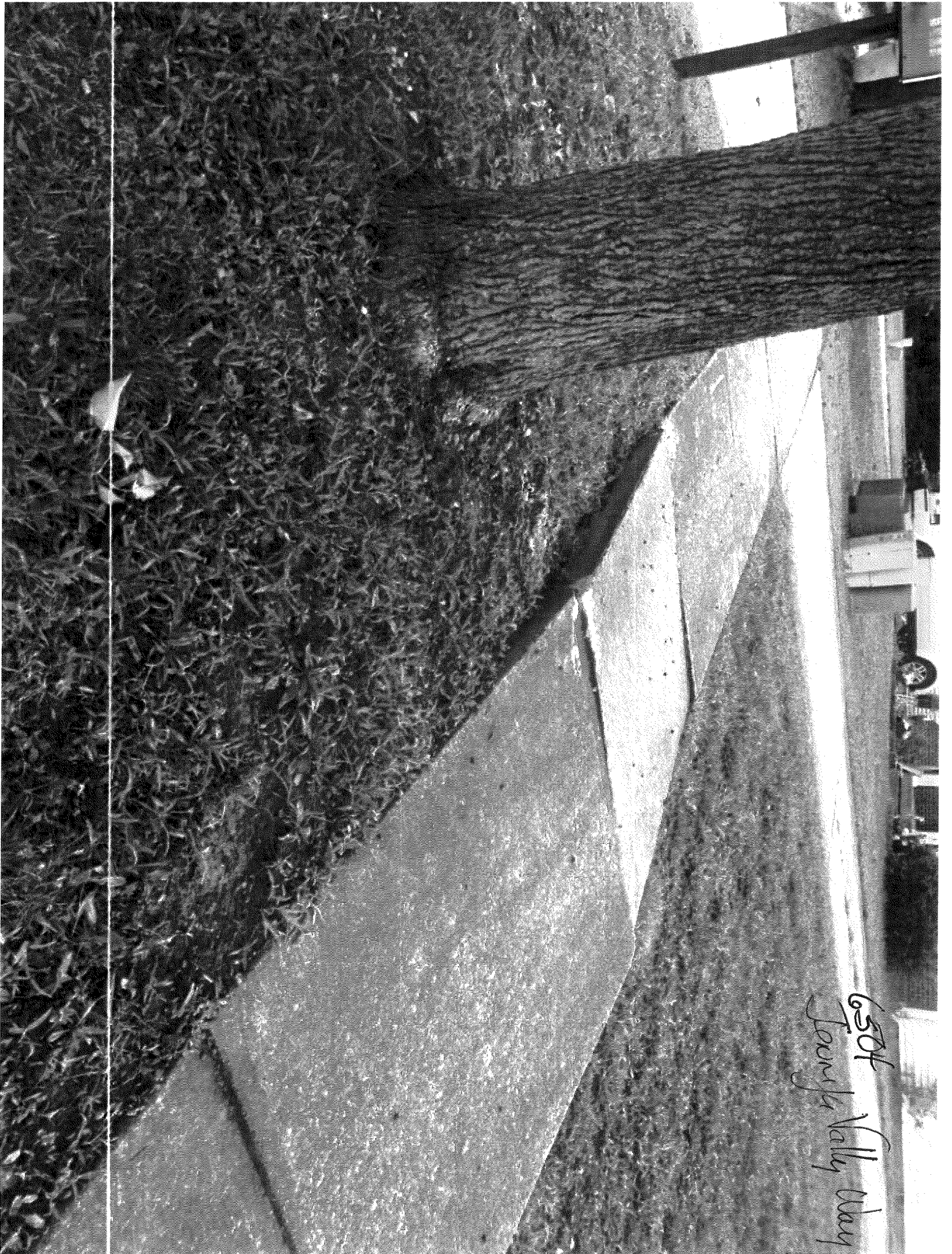

6504  
Fountain Valley Way



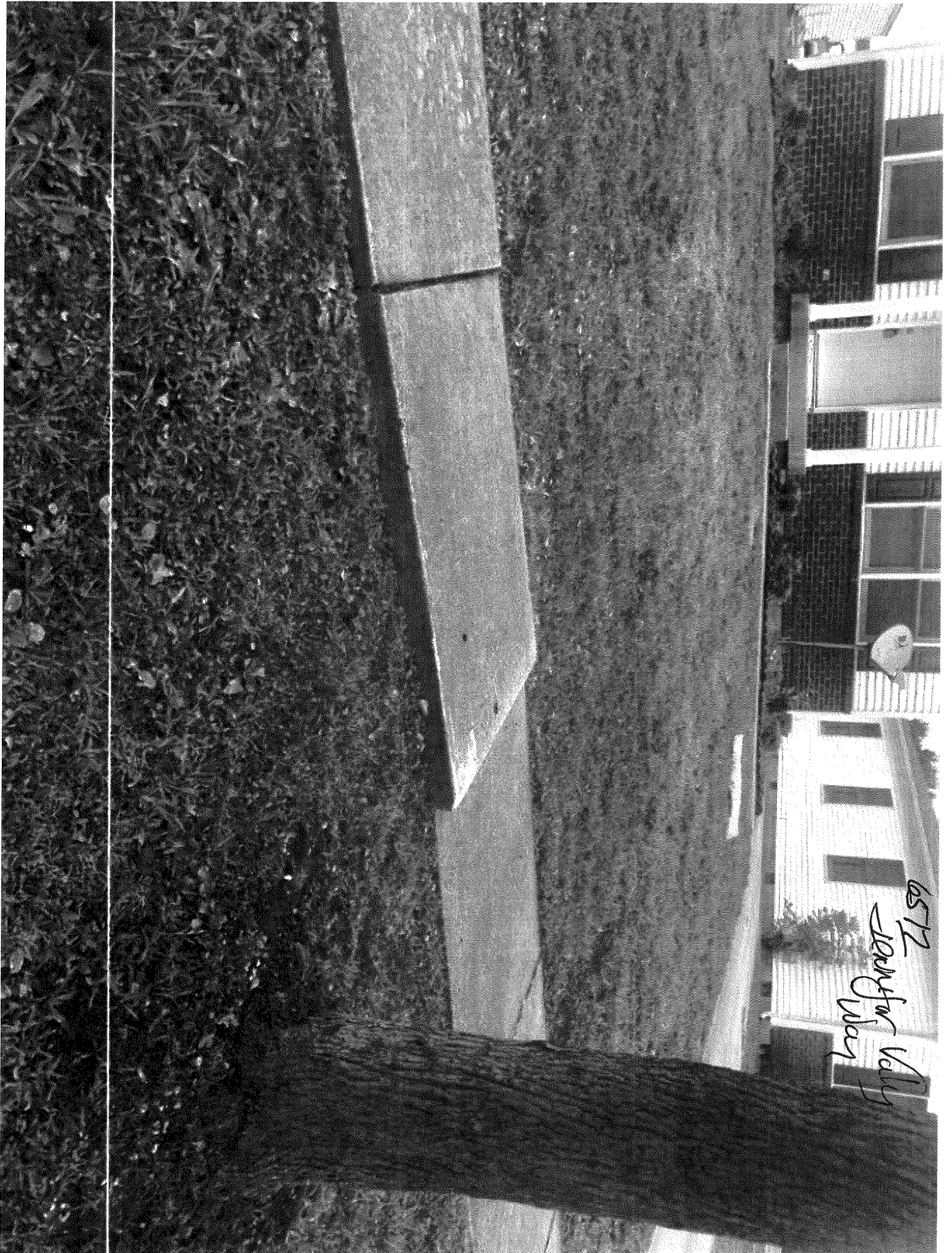

6512  
Jennifer Valley  
Way