

TOTAL DISTURBANCE AREA: 2007 SF
 TOTAL EXISTING IMPERVIOUS AREA: 0 SF
 TOTAL PROPOSED IMPERVIOUS AREA: 568.96 SF
 TOTAL NET IMPERVIOUS AREA: 568.96 SF

GENERAL NOTES

1. SITE MAY BE SUBJECT TO REGIONAL FACILITY FEE
2. ENCROACHMENT PERMIT AND BOND REQUIRED FROM MPW BEFORE CONSTRUCTION IN THE RIGHT OF WAY IS ALLOWED
3. MSD SITE DISTURBANCE PERMIT REQUIRED PRIOR TO CONSTRUCTION

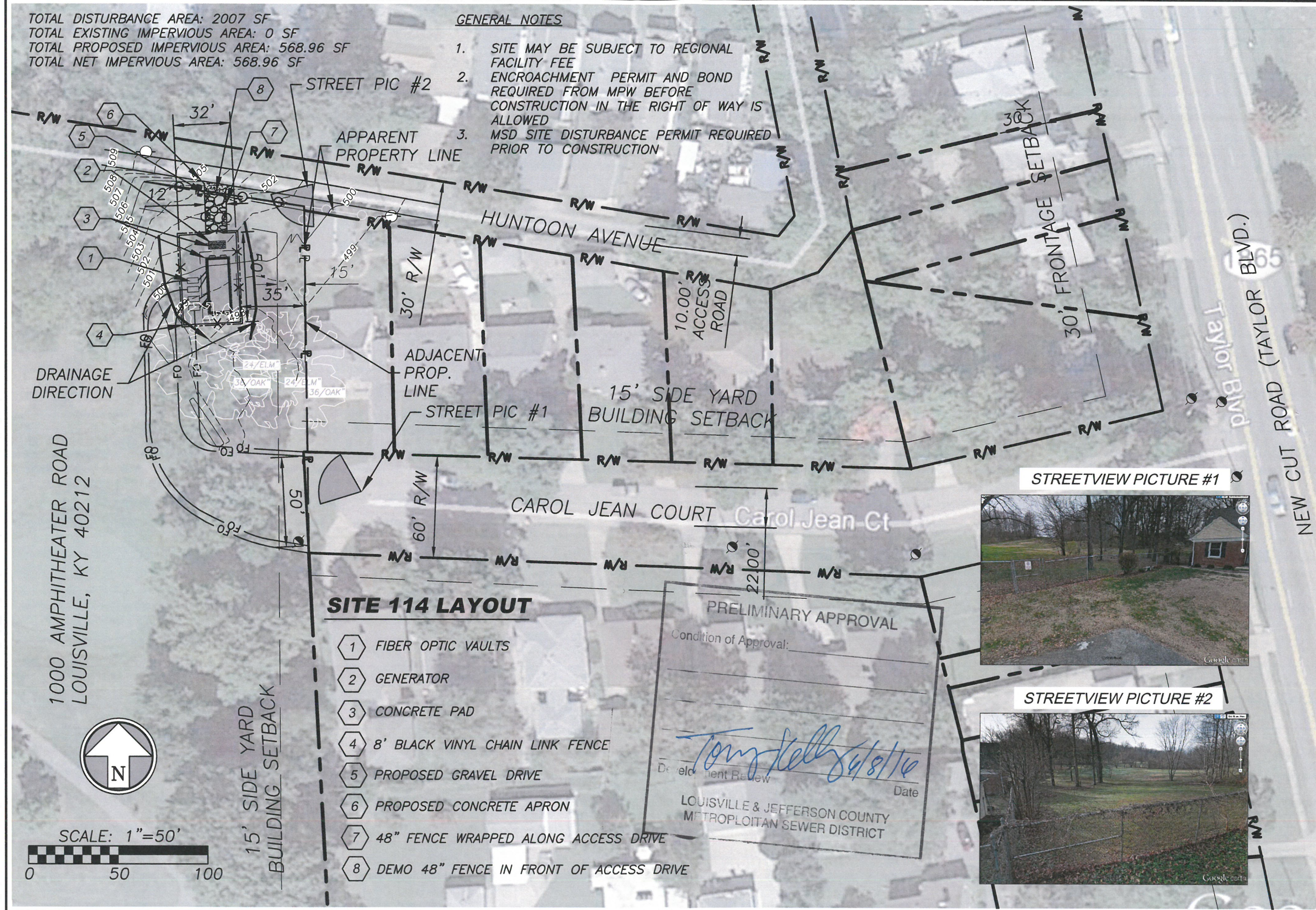

SITE 114 LAYOUT

- 1 FIBER OPTIC VAULTS
- 2 GENERATOR
- 3 CONCRETE PAD
- 4 8' BLACK VINYL CHAIN LINK FENCE
- 5 PROPOSED GRAVEL DRIVE
- 6 PROPOSED CONCRETE APRON
- 7 48" FENCE WRAPPED ALONG ACCESS DRIVE
- 8 DEMO 48" FENCE IN FRONT OF ACCESS DRIVE

PRELIMINARY APPROVAL
 Condition of Approval: _____

 Development Review Date: 8/8/16
 Louisville & Jefferson County
 Metropolitan Sewer District



May 09, 2016 8:36am Plotted By: noah.hartford T:\022320.02-114-SITE-LAY-11x17.dwg Layout Layout1

RECEIVED

May 09 2016

DESIGN SERVICES

LOUISVILLE HUT 114
 SITE IMPROVEMENT PLANS
 1000 AMPHITHEATER ROAD

PRELIMINARY SITE PLAN

Rev.	Date	Description	By	App.

BHC RHODES
 Civil Engineering • Surveying • Utilities
 7101 College Blvd., Suite 400
 Overland Park, Kansas 66210
 P. (913) 663-1900 F. (913) 663-1633
BHC is a member of the Fluor Corporation & Company, I.A.

Design: PJJ Drawn: JER
 Checked: PJJ
 Issue Date: 04/15/2016
 Project Number: 022320.02

C1.2

2 of 3

WM#4951

16 DEVPLAN 1092