

RECEIVED

NOV 01 2018

PLANNING & DESIGN SERVICES

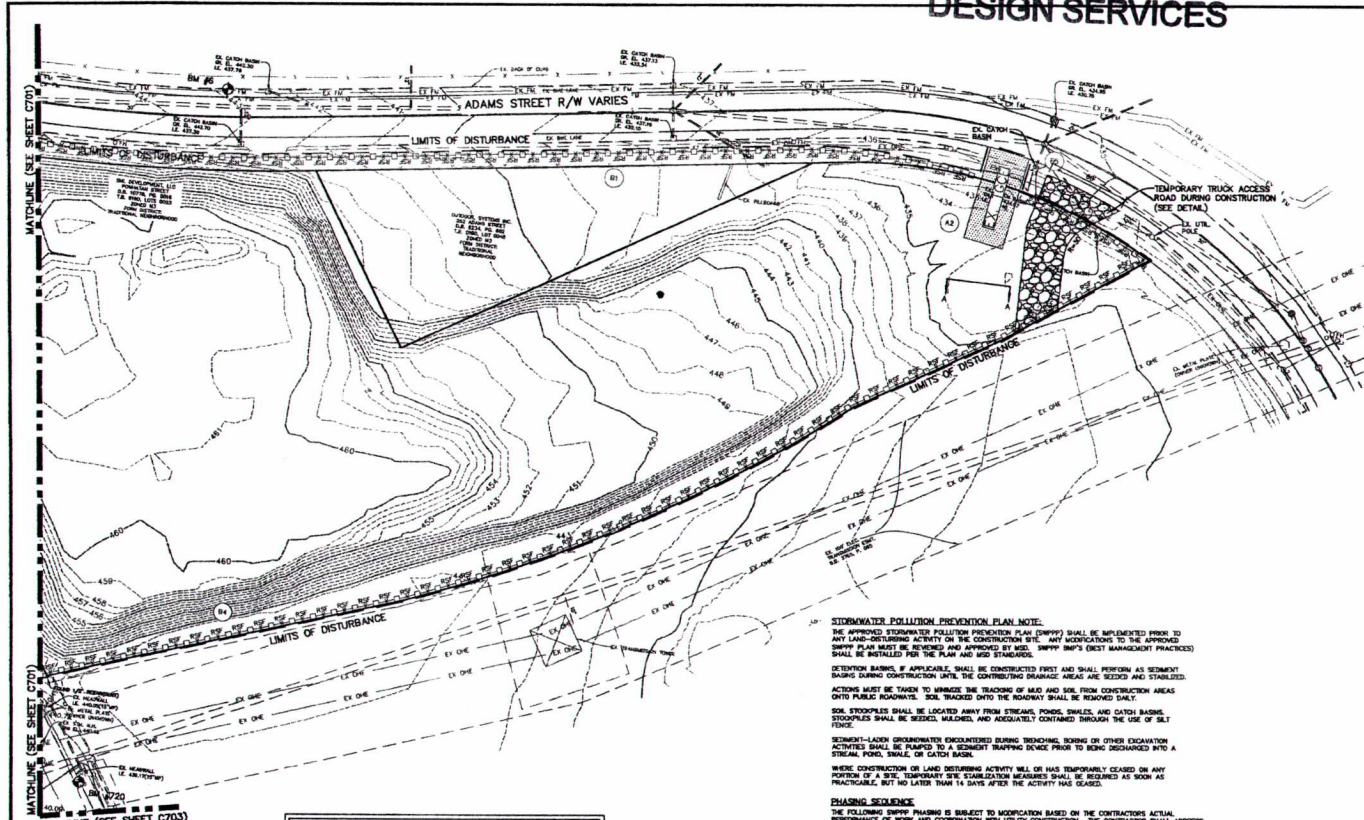

LEGEND table listing symbols for existing and proposed features such as contours, fences, manholes, and utility lines.

EROSION CONTROLS table with columns for LABEL, EROSION CONTROL PRACTICE, and MSD STANDARD DETAIL. Includes items like Stabilized Construction Entrance, Reinforced Silt Fence, etc.

OVERALL SITE TOTAL AREA OF DISTURBANCE: 33.82 ACRES

- NOTES: 1. CONTRACTOR TO COORDINATE INSTALLATION WITH OWNER'S GEOTECHNICAL ENGINEER. 2. SLOPES TO BE INSPECTED BY GEOTECHNICAL ENGINEER PRIOR TO PLACEMENT...

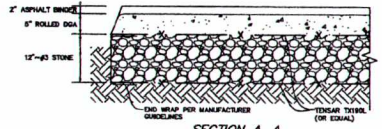

SECTION A-A TEMPORARY SWIFT PROPERTY ACCESS ROAD WIDTH=30' MIN. NO SOIL

STORMWATER POLLUTION PREVENTION PLAN NOTE: THE APPROVED STORMWATER POLLUTION PREVENTION PLAN (SWPPP) SHALL BE IMPLEMENTED PRIOR TO ANY LAND-DISTURBING ACTIVITY ON THE CONSTRUCTION SITE...

FLOODPLAIN NOTE: A PORTION OF THE SUBJECT PROPERTY IS LOCATED IN SOME A-1, WHICH IS AN AREA DETERMINED TO BE INSIDE OF THE 100-YEAR FLOODPLAIN...

UTILITY NOTE: ALL UTILITIES SHOWN ON THESE PLANS ARE APPROXIMATE. INDIVIDUAL SERVICE LINES ARE NOT SHOWN. THE CONTRACTOR OR SUBCONTRACTOR SHALL VERIFY THE UTILITY PROTECTION COVER NEARBY...

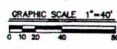

PRELIMINARY NOT FOR CONSTRUCTION

CASE # 18DCVPLAN1038 PREVIOUS CASE # 17ZONE1050 MSD SUB # 6896



OWNER: LOUISVILLE/JEFFERSON COUNTY BUTCHERTOWN DEVELOPMENT DISTRICT

STREETSCAPE & PRELIMINARY GRADING PLAN BUTCHERTOWN DEVELOPMENT DISTRICT

Table with columns for Project Name, Address, City, State, Zip, and Date.

Vertical Scale: 1/4" = 40' Date: 04/18/18 Job Number: 3456 Sheet: C702 12 of 15

18 CUP 1151

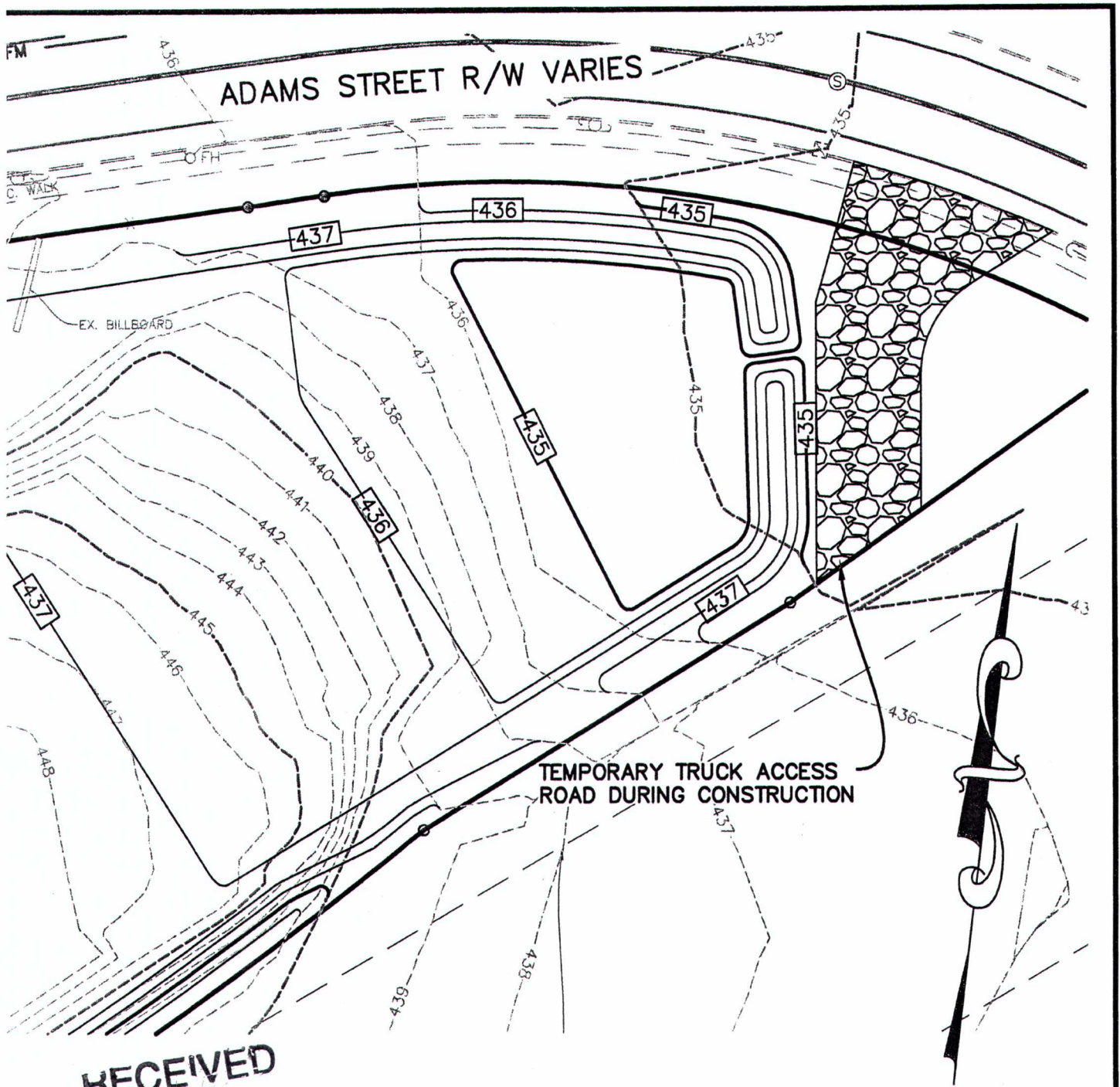

**RECEIVED**  
 NOV 01 2018  
 PLANNING &  
 DESIGN SERVICES

EAST SIDE

SHEET TITLE  
**BUTCHERTOWN DEVELOPMENT DISTRICT**  
 OUTDOOR ADVERTISING  
 GRADING EXHIBIT

Vertical Scale: N/A  
 Horizontal Scale: 1"=40'  
 Date: 4-16-18  
 Job Number: 3459

Sheet  
**EX-1**

18 CUP 1157