

WAYNE STREET CLOSURE DESCRIPTION

BEING THE CLOSURE OF WAYNE STREET (DEDICATION SOURCE UNKNOWN), BETWEEN WOOD STREET AND INTERSTATE 71 AND BEING MORE PARTICULARLY DESCRIBED AS FOLLOWS:
BEGINNING AT THE SOUTHEAST CORNER OF WAYNE STREET, 60-FEET WIDE AND WOOD STREET RIGHTS-OF-WAY (RECORD SOURCES UNKNOWN); THENCE ALONG THE EAST RIGHT-OF-WAY LINE OF WAYNE STREET SOUTH 22°24'33" EAST, 160.00 FEET; THENCE ALONG THE NORTH RIGHT-OF-WAY LINE OF INTERSTATE 71, THE FOLLOWING THREE CALLS:
SOUTH 67°35'27" WEST, 21.58 FEET; THENCE
NORTH 83°26'15" WEST, 34.91 FEET; THENCE
NORTH 76°00'16" WEST, 9.79 FEET; THENCE
ALONG THE WEST RIGHT-OF-WAY LINE OF WAYNE STREET, NORTH 22°24'33" WEST, 132.28 FEET, TO THE SOUTHWEST RIGHT-OF-WAY CORNER OF WAYNE STREET AND WOOD STREET; THENCE CROSSING WAYNE STREET, SOUTH 89°47'10" EAST, 65.00 FEET TO THE POINT OF BEGINNING. SAID CLOSED WAYNE STREET CONTAINING 8136 SQUARE FEET, BASED ON A ROAD CLOSURE PLAT BY JOHN M. THOMAS, PLS NO. 3259, OF SABAK, WILSON & LINGO, INC, JOB NO. 2874-WP, ATTACHED TO AND MADE A PART HEREOF.

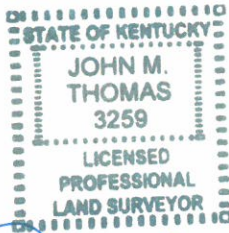

John M. Thomas
9-13-21