

S. 13TH STREET 60' R/W

N 08°56'04" E 160.00' EX. IPC L1 L2 EX. IPC

N 81°41'26" W 200.00'

S 81°41'26" E 420.07'

N 81°41'26" W 200.00'

S 08°56'04" W 100.00'

EX. ALLEY 20' R/W

N 08°55'37" E 100.00'

N 81°41'26" W 20.06'

EX. PIPE L4 L5 EX. IPC

RAILROAD & S. 14TH STREET 60' R/W

JCP LLC
1519 PETUNIA AVE
LOUISVILLE, KY 40218-2927
T.B. 36K LOT 6
D.B. 10720 PG. 351

LOT B
6207 S.F.
0.142 Acres

LOT A
4201 S.F.
0.096 Acres

LOCATION MAP
NO SCALE

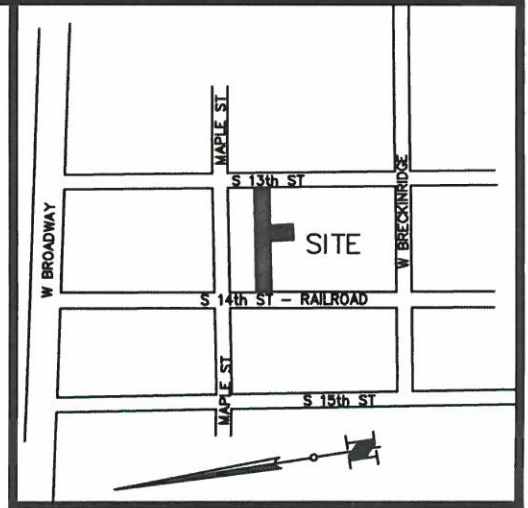

LEGEND

- SET 1/2"X18" REBAR WITH CAP #3005
- CORNER INACCESSIBLE NOT SET
- FOUND MONUMENT AS NOTED

CARDINAL FARMS LLC
6000 BROWNSBORO PARK BLVD.
UNIT B
LOUISVILLE, KY 40207-7201
T.B. 36K LOT X
D.B. X PG. X

LINE	BEARING	DISTANCE
L1	S 08°56'04" W	10.00'
L2	S 08°56'04" W	10.00'
L3	N 81°41'26" W	420.07'
L4	N 08°55'37" E	10.00'
L5	N 08°55'37" E	10.00'

GRAPHIC SCALE 1"=100'



NORTH & ALL BEARINGS SHOWN HEREON
ARE BASED ON KY STATE PLANE COORDINATES
SYSTEM, NORTH ZONE (NAD 83).

LAND SURVEYOR'S CERTIFICATE

I HEREBY CERTIFY THAT THE SURVEY AS
DEPICTED HEREON WAS PERFORMED BY
PERSONS UNDER MY DIRECT SUPERVISION,
AND MEETS OR EXCEEDS THE MINIMUM
TECHNICAL STANDARDS FOR AN URBAN
SURVEY AS ESTABLISHED BY THE
COMMONWEALTH OF KENTUCKY, PER 201
KAR 18:150 AND IN EFFECT ON THE DATE
THAT THIS SURVEY WAS COMPLETED IN THE
FIELD. THE UNADJUSTED TRAVERSE
CLOSURE WAS 1:86,102.

DRAFT

TIMOTHY L. GEHLHAUSEN PLS# 3005
NOT VALID WITHOUT ORIGINAL SIGNATURE AND SEAL OF THE PROFESSIONAL SURVEYOR



MINDEL SCOTT
ENGINEERING ► SURVEYING ►
PLANNING ► LANDSCAPE ARCHITECTURE
5151 Jefferson Blvd. Louisville, KY 40219
502-485-1508 ► MindelScott.com

THE PURPOSE OF THIS PLAT IS TO CLOSE
TWO ALLEYS.

ROAD CLOSURE PLAT
CASE # 20-STRCLOSURE-

ALLEYS BETWEEN S. 13th STREET & S.
14th STREET & SOUTH OF MAPLE STREET
LOUISVILLE, KY. 40210
TAX BLOCK 36K

DATE: 9 SEPT 20

SCALE: 1"=50'

**LAND DESCRIPTION
FOR ALLEY CLOSURE**

Being two 20 foot Alleys in the City of Louisville, Jefferson County, Kentucky, north of West Breckinridge Street, bound on the west by South 14th Street, bound on the east by South 13th Street and south of Maple Street and being more particularly described as follows:

Commencing at an existing iron pin and cap (IPC) in the west r/w line of South 13th Street and the south r/w line of a 20 foot Alley, 180 feet south of Maple Street, at the northeast corner of property conveyed to Cardinal Farms LLC in Deed Book 11668 Page 952 of record in the Clerk's office of Jefferson County, Kentucky; thence with the south r/w line of said Alley North 81°41'26" West, 200.00 feet to point in the east r/w line of another 20 foot Alley; thence with said east r/w line South 8°56'04" West, 100.00 feet to an existing pipe at the terminus of said Alley; thence North 81°41'26" West, 20.06 feet to a point; thence with the west r/w line of said Alley North 8°55'37" East, 100.00 feet to south r/w line of aforesaid Alley; thence with said south r/w line North 81°41'26" West, 200.00 feet to an existing IPC in the east r/w line of South 14th Street; thence with said east r/w line North 8°55'37" East, 20.00 feet to an existing pipe in the north r/w line of aforesaid alley; thence with said north r/w line South 81°41'26" East, 420.07 feet to an existing IPC in the west r/w line of 13th Street aforesaid; thence with said west r/w line South 8°56'04" West, 20.00 feet to the point of beginning containing 10,408 square feet or 0.238 acres.

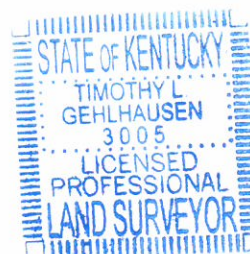

11 SEPT 20

Timothy L. Gehlhausen