

**GENERAL NOTES:**  
 1. THE SUBMITTER SHALL BE RESPONSIBLE FOR OBTAINING ALL NECESSARY PERMITS.  
 2. THE SUBMITTER SHALL BE RESPONSIBLE FOR OBTAINING ALL NECESSARY PERMITS.  
 3. THE SUBMITTER SHALL BE RESPONSIBLE FOR OBTAINING ALL NECESSARY PERMITS.  
 4. THE SUBMITTER SHALL BE RESPONSIBLE FOR OBTAINING ALL NECESSARY PERMITS.  
 5. THE SUBMITTER SHALL BE RESPONSIBLE FOR OBTAINING ALL NECESSARY PERMITS.  
 6. THE SUBMITTER SHALL BE RESPONSIBLE FOR OBTAINING ALL NECESSARY PERMITS.  
 7. THE SUBMITTER SHALL BE RESPONSIBLE FOR OBTAINING ALL NECESSARY PERMITS.  
 8. THE SUBMITTER SHALL BE RESPONSIBLE FOR OBTAINING ALL NECESSARY PERMITS.  
 9. THE SUBMITTER SHALL BE RESPONSIBLE FOR OBTAINING ALL NECESSARY PERMITS.  
 10. THE SUBMITTER SHALL BE RESPONSIBLE FOR OBTAINING ALL NECESSARY PERMITS.  
 11. THE SUBMITTER SHALL BE RESPONSIBLE FOR OBTAINING ALL NECESSARY PERMITS.

**NET DATA - GENERAL (1/4 SECTION)**

SECTIONAL AREA	453,185 SQ. FT.
NET AREA	453,185 SQ. FT.
PERCENTAGE COVERED	100.00%
ADDITIONAL LOTS	0
ADDITIONAL ACRES	0.0000
ADDITIONAL ACRES (R.O.)	0.0000

**NET DATA - GENERAL (1/4 SECTION)**

SECTIONAL AREA	453,185 SQ. FT.
NET AREA	453,185 SQ. FT.
PERCENTAGE COVERED	100.00%
ADDITIONAL LOTS	0
ADDITIONAL ACRES	0.0000
ADDITIONAL ACRES (R.O.)	0.0000

**NET DATA - GENERAL (1/4 SECTION)**

SECTIONAL AREA	453,185 SQ. FT.
NET AREA	453,185 SQ. FT.
PERCENTAGE COVERED	100.00%
ADDITIONAL LOTS	0
ADDITIONAL ACRES	0.0000
ADDITIONAL ACRES (R.O.)	0.0000



**TYPICAL ACCESSIBLE PARKING SPACES**  
 NO SCALE

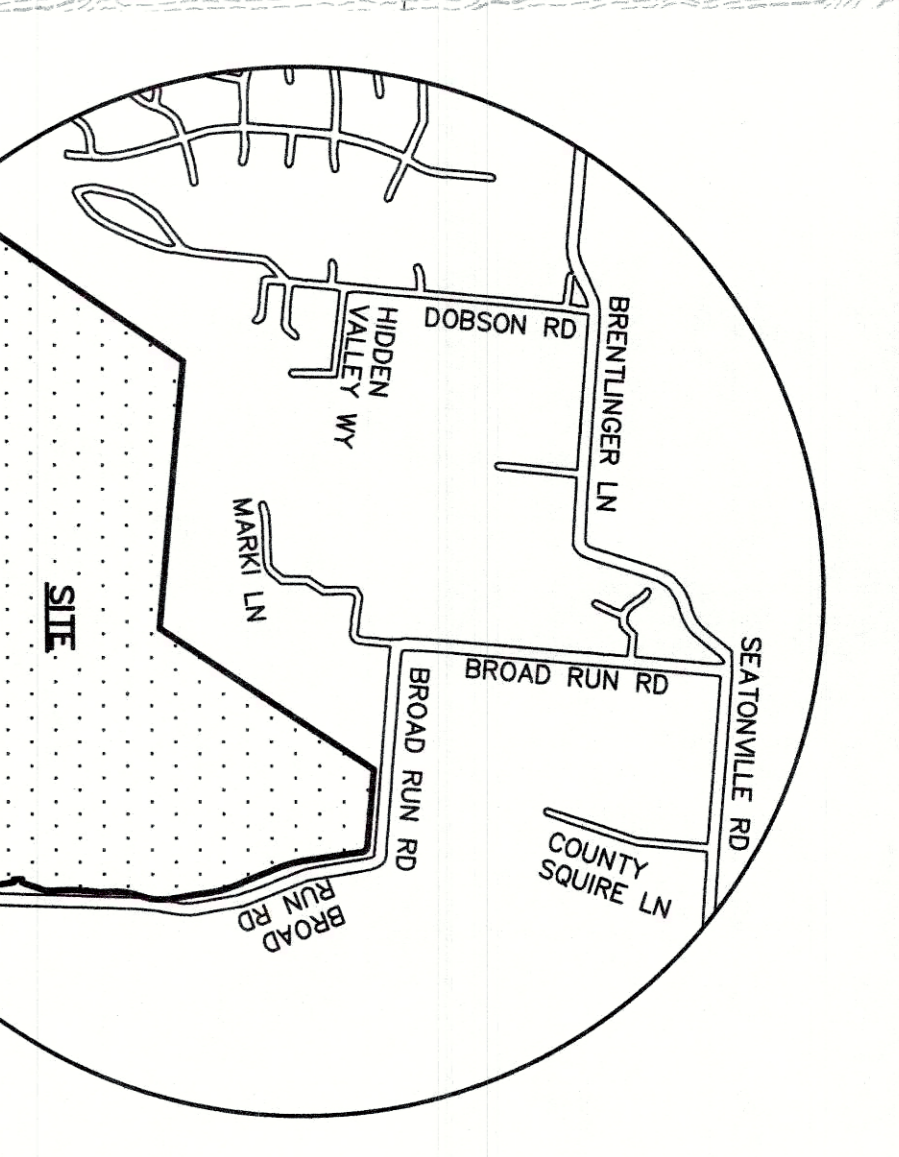

**LOCATION MAP**  
 NO SCALE

**LEGEND**

	EXISTING CONTOUR
	EXISTING SPOT ELEVATION
	PROPOSED SPOT ELEVATION
	PROPOSED SPOT ELEVATION (FLOOD HAZARD AREA)
	PROPOSED SPOT ELEVATION (FLOOD HAZARD AREA)
	PROPOSED SPOT ELEVATION (FLOOD HAZARD AREA)

RECEIVED  
 OCT 11 2022  
 PLANNING & DESIGN SERVICES  
 CASE # 22-MS1B-001  
 RELATED CASE # 20-ZONE-0122  
 MSO W.M. #12203

PRELIMINARY PLAN  
**8000 BROAD RUN ROAD SUBDIVISION**  
 8000 BROAD RUN ROAD  
 LOUISVILLE, KENTUCKY 40291  
 D.B. 11731, PG. 177  
 T.B. 57, LOT: 43

OWNER: WALTON INVESTMENTS LLC  
 2705 AVENUE OF THE WOODS  
 LOUISVILLE, KY 40241

DEVELOPER: HIGHGATES MANAGEMENT  
 7301 MONSEY CIRCLE  
 LOUISVILLE, KY 40219

MINDLE SCOTT  
 ENGINEERING | PLANNING | LANDSCAPE ARCHITECTURE  
 5151 Jefferson Blvd, Louisville, KY 40229  
 502-465-1550 | MINDLESCOTT.COM