

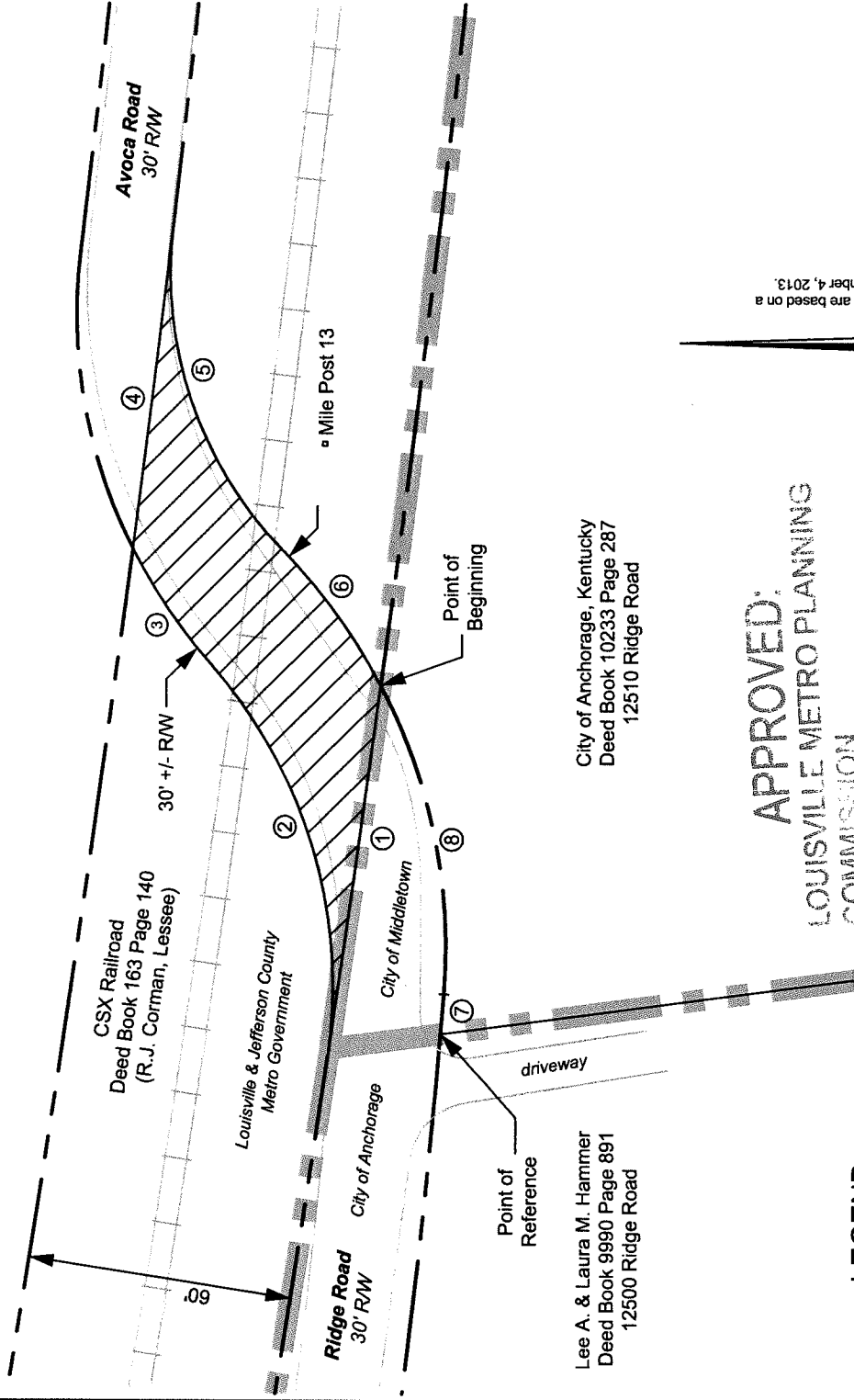

Vicinity Map
1" = 4000'

Louisville & Jefferson County
Metro Government
(Berrytown Park)
1300 Heafer Road

LINE & CURVE TABLE			
1	N 82° 04' 25" W	85.31'	R = 5,750'
2	N 73° 15' 52" E	93.28'	R = 110'
3	N 55° 46' 35" E	31.74'	R = 120'
4	S 83° 06' 21" E	73.71'	R = 5,690'
5	S 71° 03' 17" W	77.40'	R = 90'
6	S 54° 03' 52" W	38.33'	R = 130'
7	S 85° 23' 04" E	9.06'	
8	N 78° 30' 52" E	71.54'	R = 130'



Lee A. & Laura M. Hammer
Deed Book 9990 Page 891
12500 Ridge Road

City of Anchorage, Kentucky
Deed Book 10233 Page 287
12510 Ridge Road

APPROVED:
LOUISVILLE METRO PLANNING
COMMISSION

DATE 2/19/15
BY David E. Proffitt

North and all bearings shown hereon are based on a
GPS survey conducted on September 4, 2013.

LEGEND

- CORPORATE LIMITS
- AREA TO BE CLOSED = 2848 SF
ROADWAY TO BE CLOSED AND
ASPHALT TO BE REMOVED

NOTE

Related Case: 13STREETS1004

STATE OF KENTUCKY
GEORGE BRIAN
WYATT
2328
LICENSED
PROFESSIONAL
LAND SURVEYOR

LAND SURVEYOR'S CERTIFICATE

I hereby certify that this Road Closure Plat and survey were made under my supervision, and that the angular and linear measurements as witnessed by monuments shown hereon are true and correct to the best of my knowledge and belief. This survey does not represent a boundary survey and is not intended for land transfer.

George Brian Wyatt
George Brian Wyatt PLS #2328

October 16, 2014

Date:

ROAD CLOSURE PLAT

Site Information

CSX Railroad Crossing
Avoca Road / Ridge Road
Louisville, Jefferson County, Kentucky

APPLICANT

Louisville & Jefferson County Metro Government
444 South 5th Street
Louisville, Kentucky 40202
Zoning: R4 / Neighborhood

PROPOSED USE: To Revert to Railroad Property

BTM ENGINEERING, INC.

Consulting Engineers Landscape Architects Planners
3001 Taylor Springs Drive
Louisville, Kentucky 40220
(502) 459-8402



13STREETS1004