

WV# 10779

CAT2B PLAN

RECEIVED  
AUG 31 2017  
DESIGN SERVICES

PRELIMINARY APPROVAL  
DEVELOPMENT PLAN  
CONDITIONS:  
DATE: *Boyer & Boyer*  
LOUISVILLE/JEFFERSON COUNTY  
METRO PUBLIC WORKS

Table with columns for DATE, REVISION, and other project details.



YVCA  
1700 WEST BROADWAY  
WEST LOUISVILLE, KY

[smart design] LUCKETT & FARLEY

737 South Third Street, Louisville, Kentucky 40202-2100  
502-585-1811  
252-585-1811

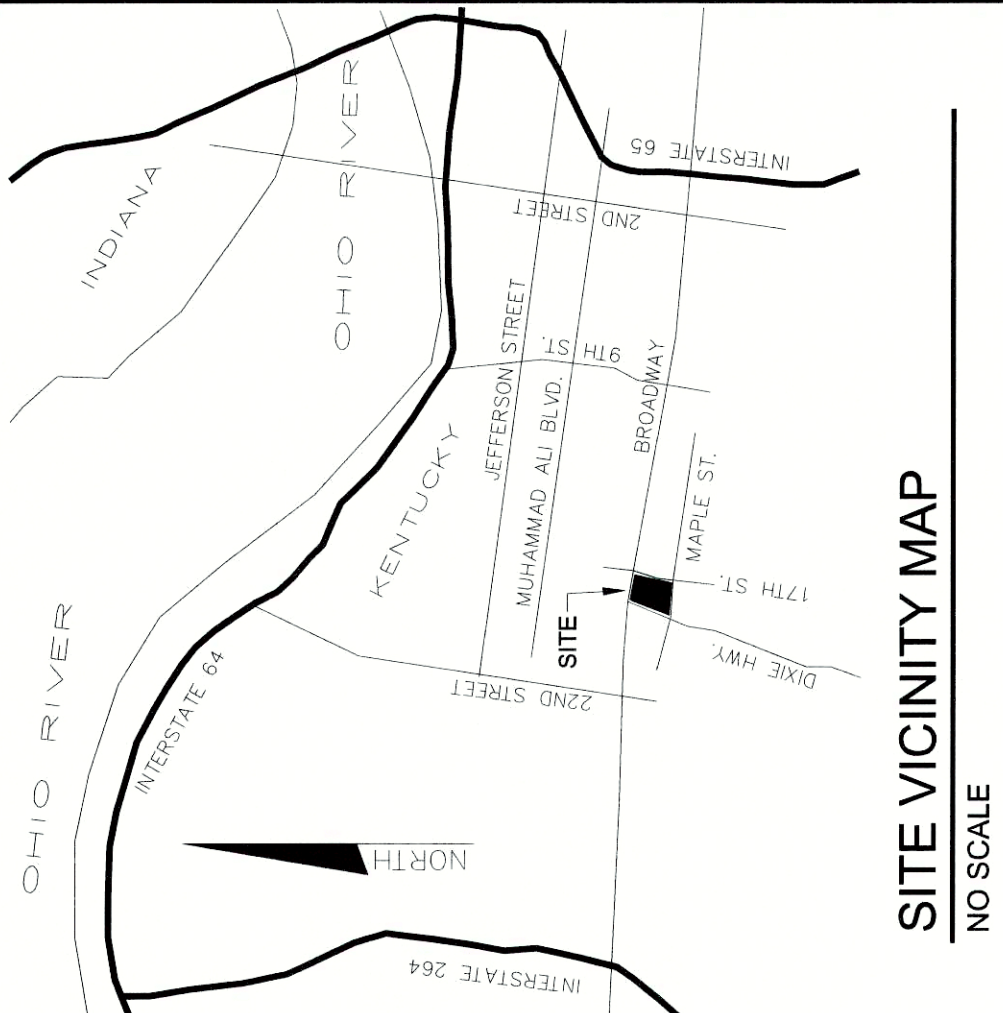
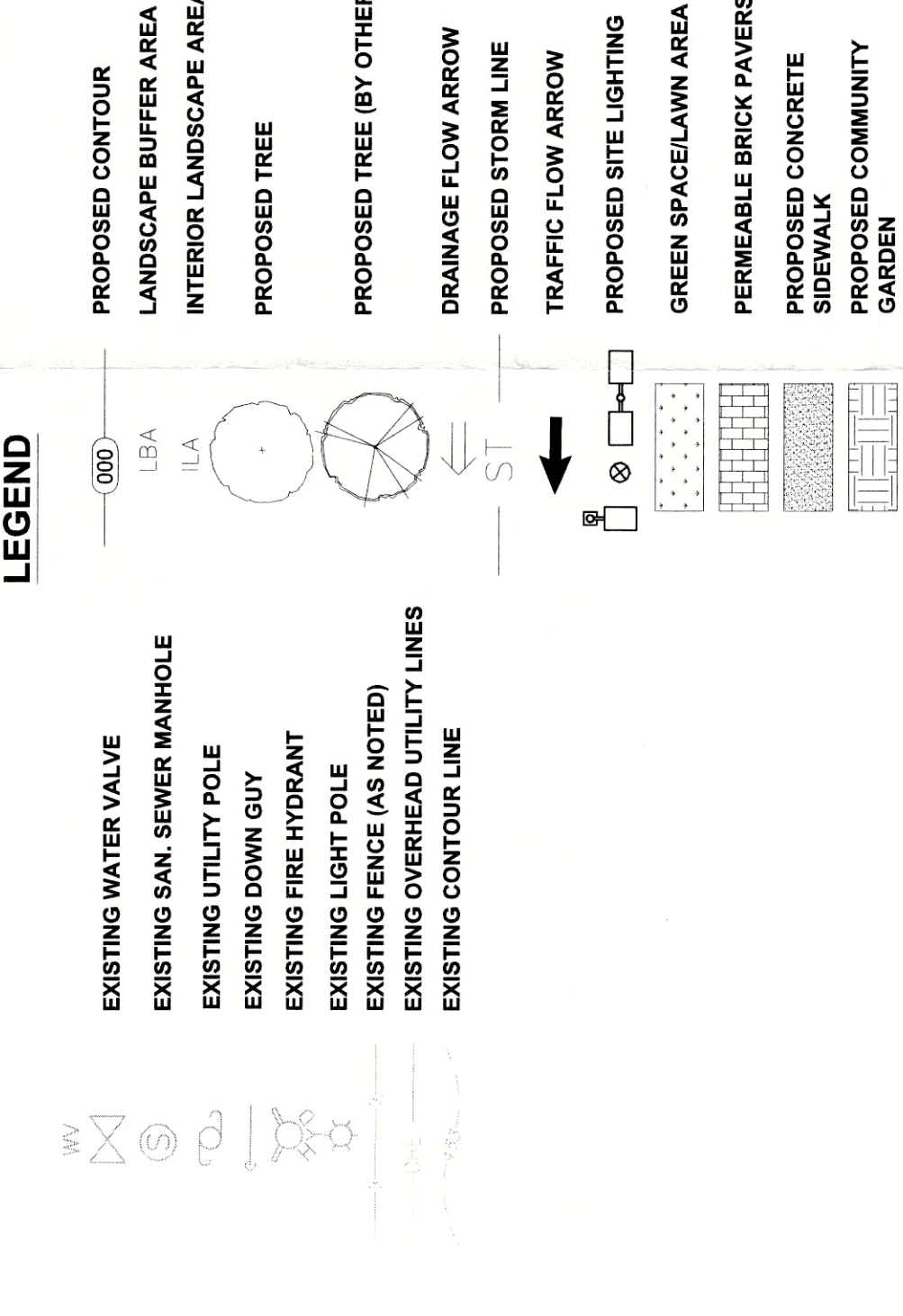

Table with columns for OWNER, SITE ADDRESS, PERMITS, PROPOSED USE, BUILDING FOOTPRINT, GROSS FLOOR AREAS, PROPOSED BUILDING HEIGHT, PROPOSED FAS, PROPOSED PARKING, REQUIRED PARKING, REQUIRED ACCESSIBLE PARKING, REQUIRED TOTAL PARKING PROVIDED, ACCESSIBLE PARKING PROVIDED, BICYCLE PARKING REQUIREMENTS, and STORM WATER NOTES.



PROPOSED CONTOUR  
LANDSCAPE BUFFER AREA  
INTERIOR LANDSCAPE AREA  
PROPOSED TREE (BY OTHERS)  
PROPOSED TREE  
DRAINAGE FLOW ARROW  
PROPOSED STORM LINE  
TRAFFIC FLOW ARROW  
GREEN SPACELAWN AREA  
PERMEABLE BRICK PAVERS  
PROPOSED CONCRETE  
PROPOSED SIDEWALK  
PROPOSED COMMUNITY GARDEN

AIR POLLUTION CONTROL DISTRICT NOTES:  
PARTICULATE EMISSIONS FROM HEATING RADIATORS AND NEIGHBORING PROPERTIES.  
EROSION PREVENTION AND SEDIMENT CONTROL NOTES:  
AN APPROVED EROSION PREVENTION AND SEDIMENT CONTROL (EPSC) PLAN SHALL BE IMPLEMENTED PRIOR TO ANY LAND DISTURBING ACTIVITY ON THE CONSTRUCTION SITE.

STORM WATER NOTES:  
PROPOSED INTERIOR LANDSCAPING AREA PROVIDED: 1,448 SF (12.1%)  
FUTURE INTERIOR LANDSCAPING AREA PROVIDED: 1,448 SF (12.1%)  
TOTAL INTERIOR LANDSCAPING AREA PROVIDED: 2,896 SF (24.2%)

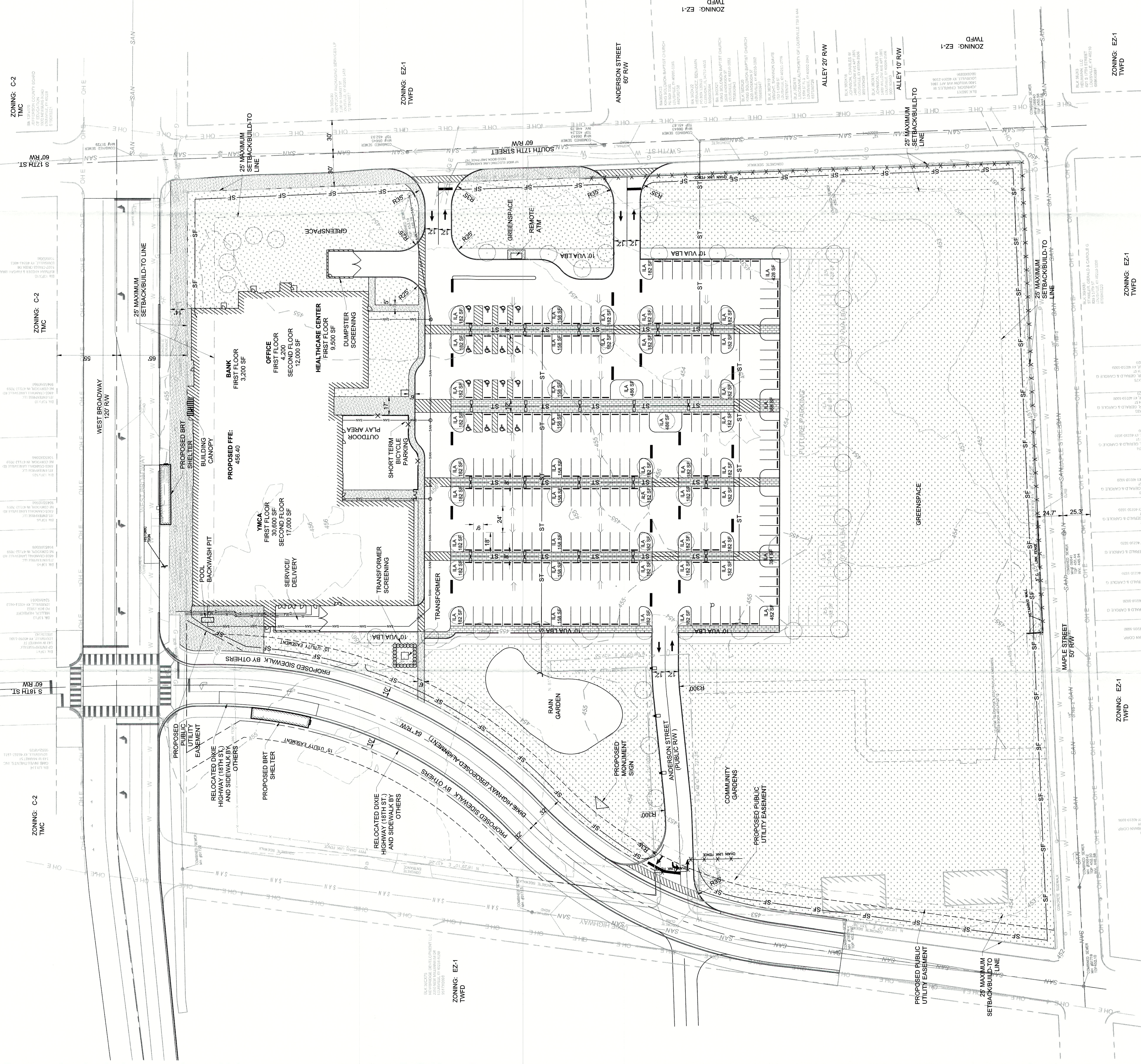

CATEGORY 2B PLAN  
SITE PLAN  
NORTH  
GRAPHIC SCALE: SUPERSEDES NUMERIC SCALE  
0' 20' 40' 80'  
SCALE: 1" = 40'