

Land Development and Transportation Committee Staff Report

April 13, 2017



Case No:	16zone1090
Request:	Change in zoning from R-4 to PEC on approximately 14.93 acres
Project Name:	Blankenbaker Land Aquisition
Location:	Tucker Station Road TB 3672 LOT 1 (Southeast and approximately 1,000 feet from the intersection of Tucker Station Road and Lakefront Place, rear of lot only)
Owner:	LRH Family, LLC.
Applicant:	Hollenbach Oakley LLC
Representative:	Mindel Scott and Assoc.; Bardenwerper Talbott and Roberts PLLC.
Jurisdiction:	Louisville Metro
Council District:	20-Stuart Benson
Case Manager:	Julia Williams, RLA, AICP, Planning Supervisor

REQUEST

- Change in zoning from R-4 to PEC
- District Development Plan

CASE SUMMARY/BACKGROUND/SITE CONTEXT

The proposal is to rezone the pond portion of the site from R-4 to PEC.

LAND USE/ZONING DISTRICT/FORM DISTRICT TABLE

	Land Use	Zoning	Form District
<i>Subject Property</i>			
Existing	Pond	R-4	SW
Proposed	Pond	PEC	SW
<i>Surrounding Properties</i>			
North	Residential	R-4	SW
South	Office/Warehouse	PEC	SW
East	Residential	R-4	SW
West	Office/Warehouse	PEC	SW

PREVIOUS CASES ON SITE

None found.

INTERESTED PARTY COMMENTS

None received.

APPLICABLE PLANS AND POLICIES

Cornerstone 2020
Land Development Code

STANDARD OF REVIEW FOR REZONING

Criteria for granting the proposed form district change/rezoning: KRS Chapter 100.213

1. The proposed form district/rezoning change complies with the applicable guidelines and policies Cornerstone 2020; OR
2. The existing form district/zoning classification is inappropriate and the proposed classification is appropriate; OR
3. There have been major changes of an economic, physical, or social nature within the area involved which were not anticipated in Cornerstone 2020 which have substantially altered the basic character of the area.

STAFF ANALYSIS FOR REZONING

Following is staff's analysis of the proposed rezoning against the Guidelines and Policies of Cornerstone 2020.

The site is proposed to be located in the Suburban Workplace Form District

A Suburban Workplace is a form characterized by predominately industrial and office uses where the buildings are set back from the street in a landscaped setting. Suburban workplaces often contain a single large-scale use or a cluster of uses within a master planned development. New larger proposed industrial uses are encouraged to apply for a planned development district.

In order to provide adequate transportation access in suburban workplaces connected roads, public transportation and pedestrian facilities should be encouraged. Walkways to workplace-serving uses are encouraged for workplace employees. Development within suburban workplace form districts may need significant buffering from abutting uses.

TECHNICAL REVIEW

- The applicants zoning justification statement needs to be submitted.

STAFF CONCLUSIONS

The proposal is ready for a public hearing date to be set.

NOTIFICATION

Date	Purpose of Notice	Recipients
3/30/17	Hearing before LD&T on April 13, 2017	1 st and 2 nd tier adjoining property owners Subscribers of Council District 20 Notification of Development Proposals
	Hearing before PC	1 st and 2 nd tier adjoining property owners Subscribers of Council District 20 Notification of Development Proposals
	Hearing before PC	Sign Posting on property
	Hearing before PC	Legal Advertisement in the Courier-Journal

ATTACHMENTS

1. Zoning Map
2. Aerial Photograph
3. Proposed Binding Elements

1. Zoning Map

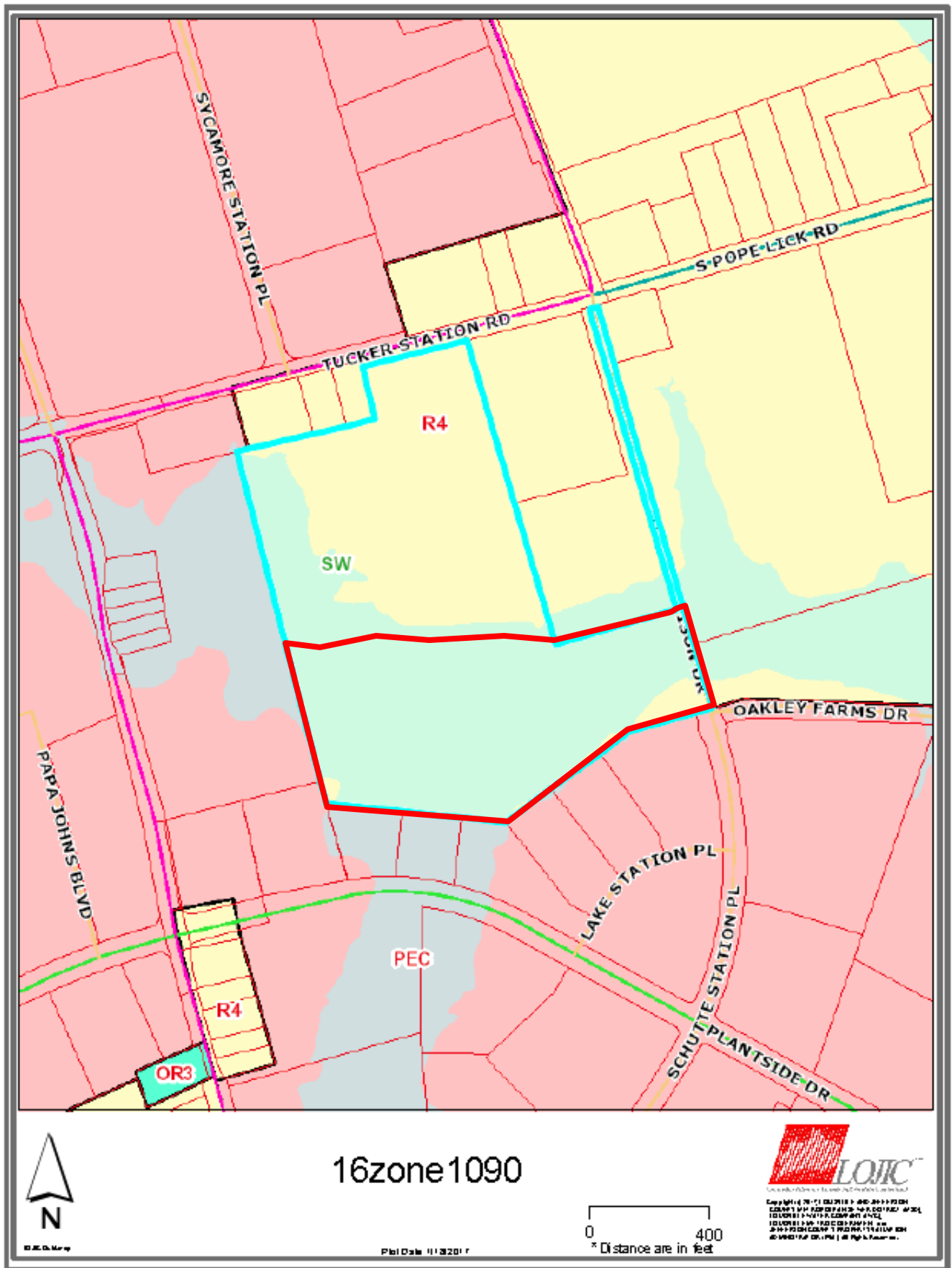

2. Aerial Photograph



3. Proposed Binding Elements

1. The development shall be in accordance with the approved district development plan, all applicable sections of the Land Development Code (LDC) and agreed upon binding elements unless amended pursuant to the Land Development Code. Any changes/additions/alterations of any binding element(s) shall be submitted to the Planning Commission or the Planning Commission's designee for review and approval; any changes/additions/alterations not so referred shall not be valid.
2. No outdoor advertising signs, small freestanding signs, pennants, balloons, or banners shall be permitted on the site.
3. Construction fencing shall be erected when off-site trees or tree canopy exists within 3' of a common property line. Fencing shall be in place prior to any grading or construction to protect the existing root systems from compaction. The fencing shall enclose the entire area beneath the tree canopy and shall remain in place until all construction is completed. No parking, material storage or construction activities are permitted within the protected area.
4. Before any permit (including but not limited to building, parking lot, change of use, site disturbance, alteration permit) is requested:
 - a. The development plan must receive full construction approval from Develop Louisville, Louisville Metro Public Works and the Metropolitan Sewer District.
 - b. A minor subdivision plat or legal instrument shall be recorded creating the lot lines as shown on the development plan. A copy of the recorded instrument shall be submitted to the Division of Planning and Design Services prior to obtaining a building permit.
 - c. The property owner/developer must obtain approval of a detailed plan for screening (buffering/landscaping) as described in Chapter 10 prior to obtaining a building permit. Such plan shall be implemented prior to occupancy of the site and shall be maintained thereafter.
 - d. A Tree Preservation Plan in accordance with Chapter 10 of the LDC shall be reviewed and approved prior to obtaining approval for site disturbance.
5. The applicant, developer, or property owner shall provide copies of these binding elements to tenants, purchasers, contractors, subcontractors and other parties engaged in development of this site and shall advise them of the content of these binding elements. These binding elements shall run with the land and the owner of the property and occupant of the property shall at all times be responsible for compliance with these binding elements. At all times during development of the site, the applicant and developer, their heirs, successors; and assignees, contractors, subcontractors, and other parties engaged in development of the site, shall be responsible for compliance with these binding elements.