

Case No. 14STREETS1011

Avoca Road Street Closure



Louisville Metro Planning Commission Public Hearing

David B. Wagner, Planner II

February 19, 2015

Requests

- Closure of Avoca Road at its intersection with Ridge Rd. and the CSX Railroad

Case Summary / Background

- Louisville Metro Council resolution requesting the PC proceed with street closure to physically close railroad crossing
- Pavement in RR ROW removed & barricades erected
- Will reflect existing conditions on site
- At juncture of Louisville Metro, Anchorage, & Middletown
- Topography on south side causing erosion
- All 3 municipalities consulted to determine best course of action, resulting in this proposal

Zoning/Form Districts

- Subject Property:
 - Existing: R-4, N
 - Proposed: R-4, N
- Adjacent Properties:
 - North: R-4, N
 - South: R-4, N
 - East: R-4, N
 - West: R-4, N

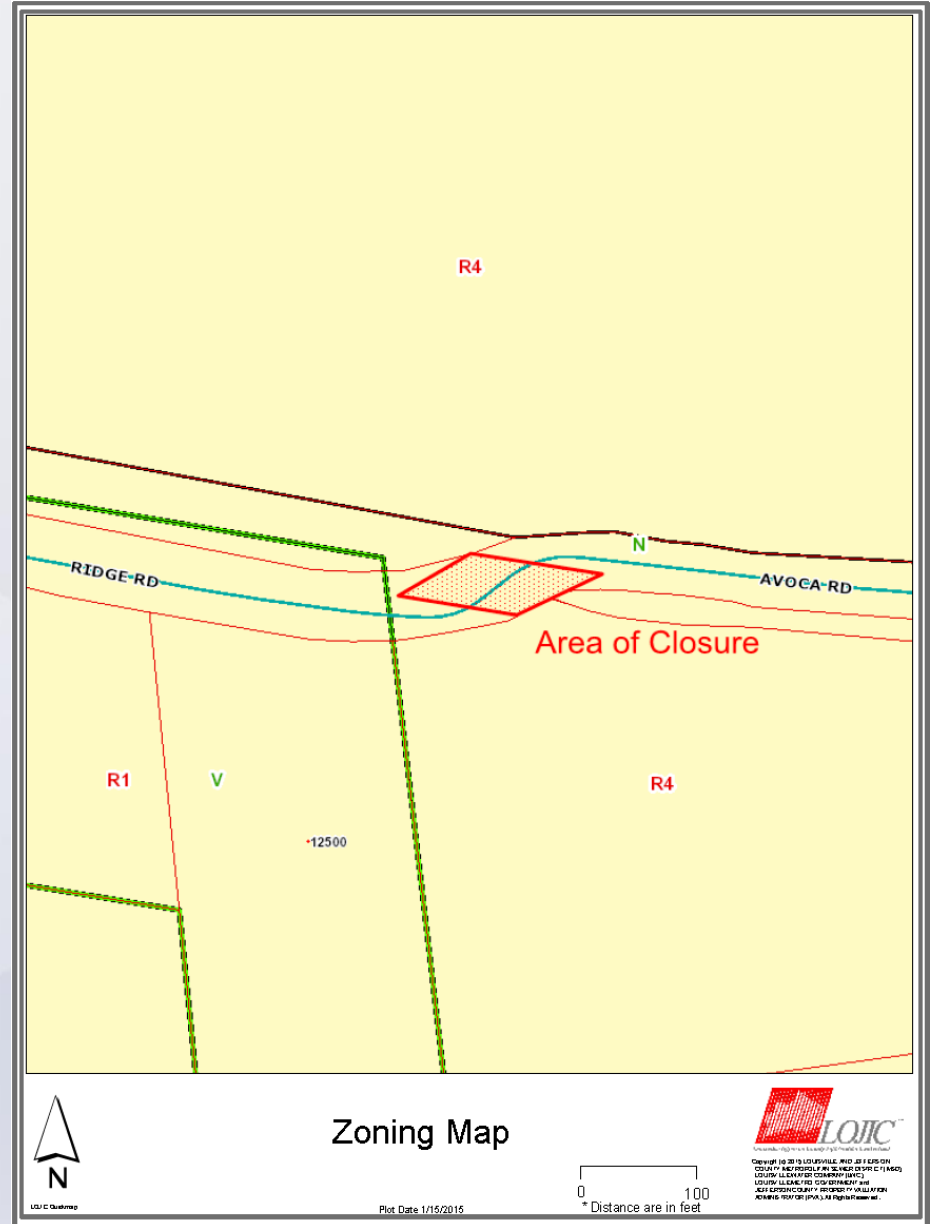

Case 14STREETS1011

Aerial Photo/Land Use

- Subject Property:
 - Existing: ROW
 - Proposed: RR ROW Only
- Adjacent Properties:
 - North: Recreational
 - South: Residential
 - East: RR ROW
 - West: RR ROW



East at Glenbrook & Ridge



Glenbrook & Ridge



South of Area of Closure



North of Area of Closure



West at Avoca & Old Henry



Applicant's Closure Plat

Highlights:

- Area: 2,848 SF
- CSX RR Crossing
- 3 Municipalities Involved

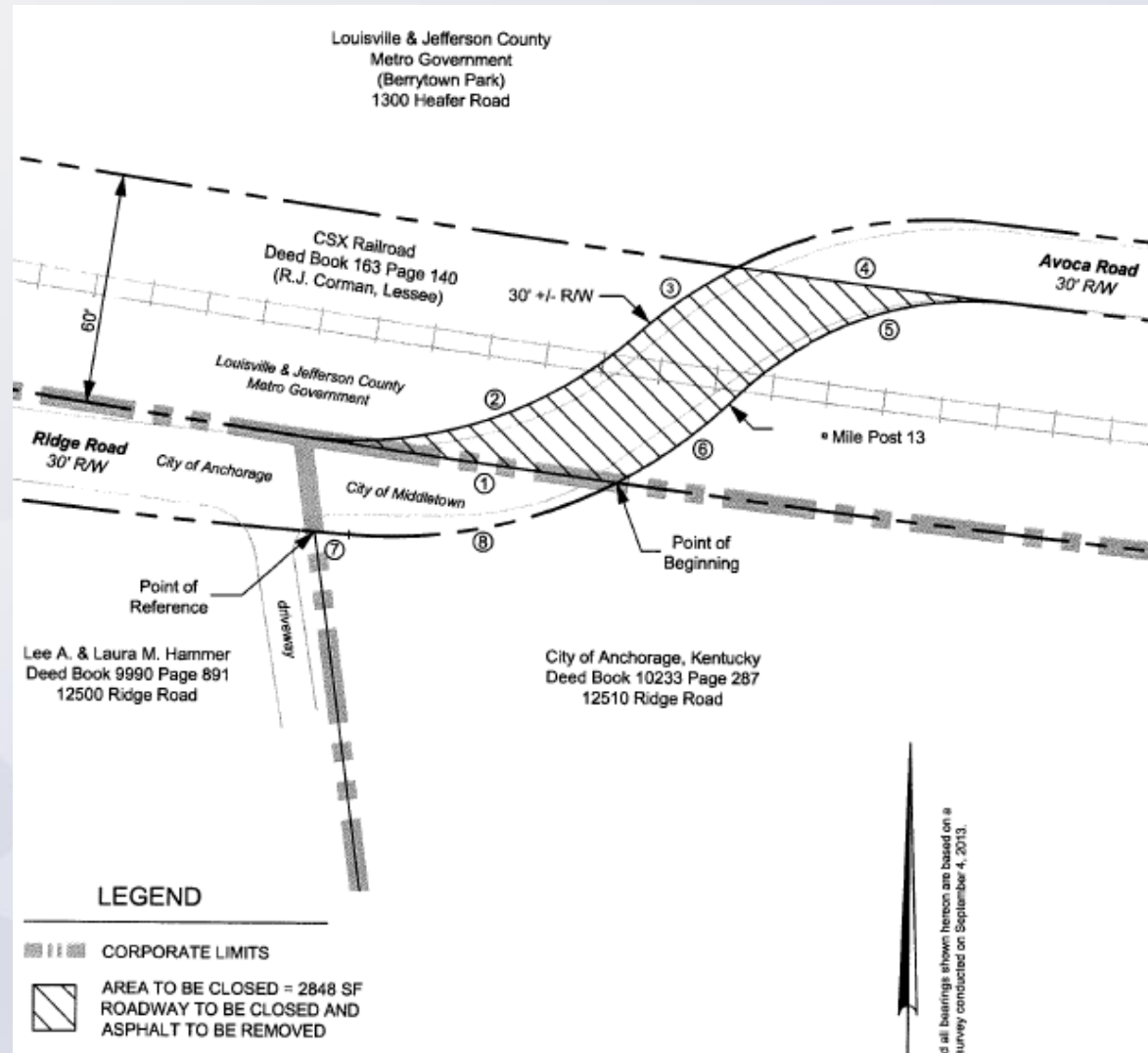

Technical Review

- All agencies approve
- The plat meets the requirements of the LDC

Staff Analysis and Conclusions

- Street Closure
 - The proposal meets or exceeds all applicable items of the comprehensive plan in regards to the Neighborhood Form District. The closure will reflect what currently exists on the ground. Fewer railroad crossings are generally safer for vehicular traffic and the closure would also allow for fewer train horns to be blown in the area to assist in extending area Quiet Zones. CSX has presented Louisville Metro with a Crossing Closure Agreement for this proposal which represents the entity's support for the closure. As there are no plans to open this crossing permanently, the Middletown Fire District has stated it no longer opposes the closure.
 - Due to the unique nature of this closure being located at the juncture of three different municipalities, and that it includes a railroad crossing, staff will have the Planning Commission's recommendation transmitted to all three municipalities to obtain an ordinance approving the closure.

Required Actions

- Based upon the information in the staff report, the testimony and evidence provided at the public meeting, the Planning Commission must **RECOMMEND** Louisville Metro Council, City of Anchorage, and City of Middletown **APPROVE** or **DENY** this proposal.