

**SOIL CLASSIFICATION TABLE**

SYMBOL	CLASS	DEPTH TO RESTRICTIVE FEATURE	DWELLINGS W/OUT BASEMENTS	DWELLINGS W/ BASEMENTS	LOCAL ROADS AND STREETS
BeC	Basley Silt Loam, 6 to 12% slopes	4'-5'	Somewhat limited, due to shrink-swell & slope	Somewhat limited, due to shrink-swell & slope	Very limited, due to low strength, shrink-swell & slope
Bb	Brownwood Silt Loam, occasionally flooded	2'-4'	Very limited, due to flooding, depth to saturated zone, and depth of bedrock	Very limited, due to flooding, depth to saturated zone, and depth of bedrock	Very limited, due to low strength, slope & shrink-swell
CaC2	Caryville Silt Loam, 6 to 12% slopes, eroded, very rocky	2'-4'	Somewhat limited, due to depth of bedrock, shrink-swell & slope	Very limited, due to depth of bedrock, shrink-swell & slope	Very limited, low strength, depth of bedrock, shrink-swell & slope
CaD2	Caryville Silt Loam, 12 to 25% slopes, eroded very rocky	2'-4'	Very limited, due to slope, depth of bedrock, & shrink-swell	Very limited, due to depth of bedrock, slope & shrink-swell	Very limited, low strength, slope, depth of bedrock & shrink-swell
CrB	Cider Silt Loam, 2 to 6% slopes	>6'	Not limited	Not limited	Very limited due to low strength
CrC	Cider Silt Loam, 2 to 6% slopes	>6'	Somewhat limited, due to slope	Somewhat limited, due to depth of cemented pan, slope & shrink-swell	Very limited due to low strength and slope
NhB	Bedford Silt Loam, 2 to 6% slopes	2'-3'	Somewhat limited, due to shrink-swell, depth to saturated zone, cemented pan	Very limited, due to depth of saturated zone, thick cemented pan, shrink-swell	Very limited, due to frost action, low strength & depth of saturated zone, depth of cemented pan
SaB	Sandview Silt Loam, 2 to 6% slopes	>6'	Not limited	Not limited	Very limited due to low strength
U1C	Urban land-Alic, Udicretis complex, fragipan substratum-over hard bedrock, 0-12% slopes	4'-5'	Not rated	Not rated	Not rated
U2C	Urban land-Alic, Udicretis complex, clayey substratum-over hard bedrock, 0-12% slopes	4'-5'	Not rated	Not rated	Not rated
U3C	Urban land-Alic, Udicretis complex, clayey substratum-over hard bedrock, 12-25% slopes	4'-5'	Not rated	Not rated	Not rated
U4C	Urban land-Alic, Udicretis-Cider complex 0-12% slopes	4'-5'	Not limited	Not limited	Very limited due to low strength

\* Source: US Department of Agriculture, NRCS of Jefferson County, Kentucky, <http://soildatamart.nrcs.usda.gov/Manuals/ky1110/ma99/sheet21.pdf>

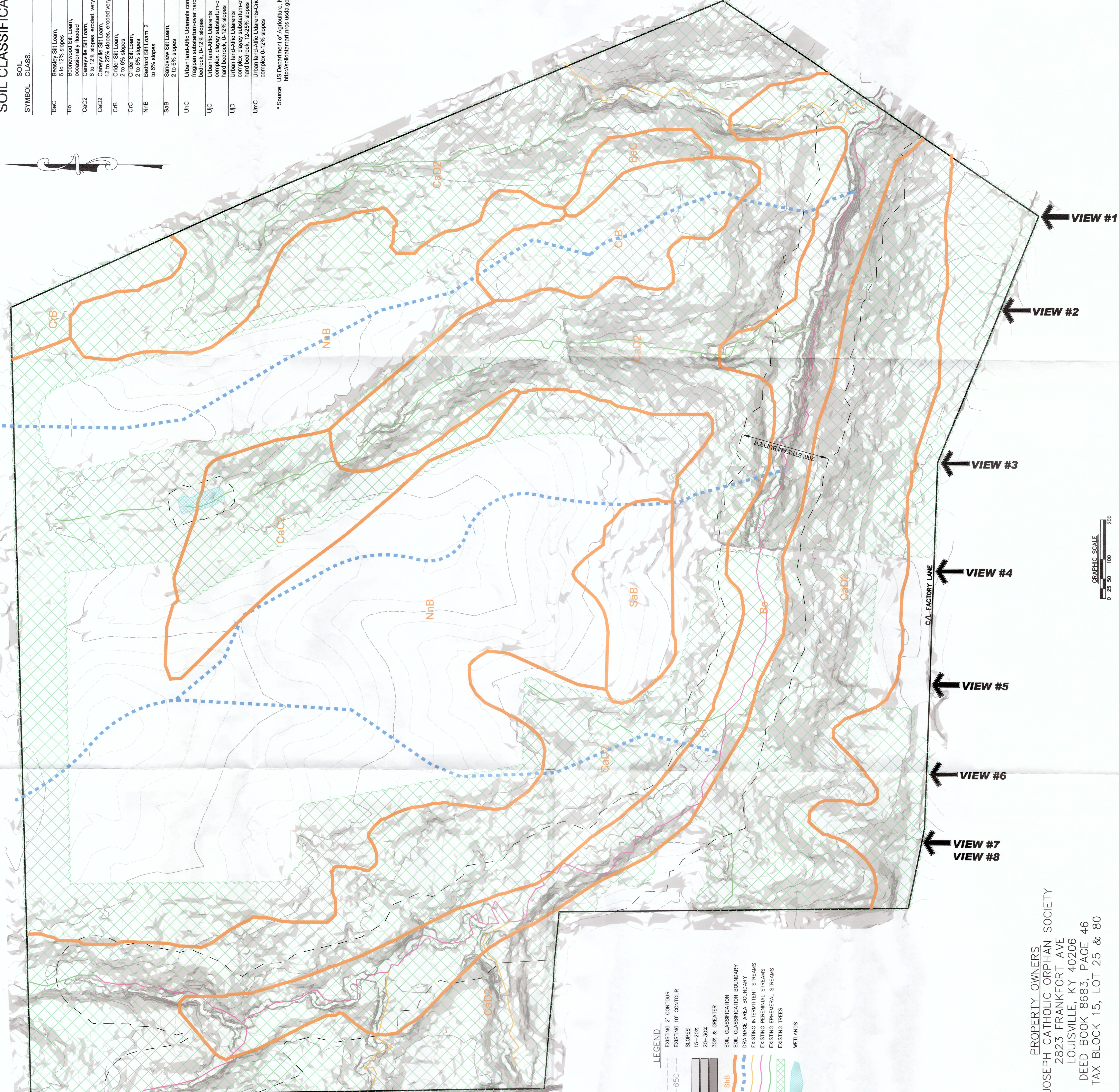

- LEGEND**
- EXISTING 2' CONTOUR
  - EXISTING 10' CONTOUR
  - SLOPES
  - 15-20%
  - 20-30%
  - 30% & GREATER
  - SOIL CLASSIFICATION
  - SOIL CLASSIFICATION BOUNDARY
  - DRAINAGE AREA BOUNDARY
  - EXISTING PERENNIAL STREAMS
  - EXISTING EPHEMERAL STREAMS
  - EXISTING TREES
  - WETLANDS

PROPERTY OWNERS:  
 JOSEPH CATHOLIC ORPHAN SOCIETY  
 2823 FRANKFORT AVE  
 LOUISVILLE, KY 40206  
 DEED BOOK 8683, PAGE 46  
 TAX BLOCK 15, LOT 25 & 80

**VIEW SHED ANALYSIS**

OVERGROW AND INVASIVE VEGETATION PREVENTS VIEWS INTO THE PROPERTY. AS A PART OF DEVELOPMENT, EXISTING VEGETATION WILL BE REMOVED AND REPLACED WITH SCREENING VEGETATION IN ORDER TO MAINTAIN SCREENED VIEWS INTO THE SITE. EXISTING OVERHEAD POWERLINES WILL PREVENT THE PLANTING OF LARGE TREES ADJACENT TO THE ROADWAY.

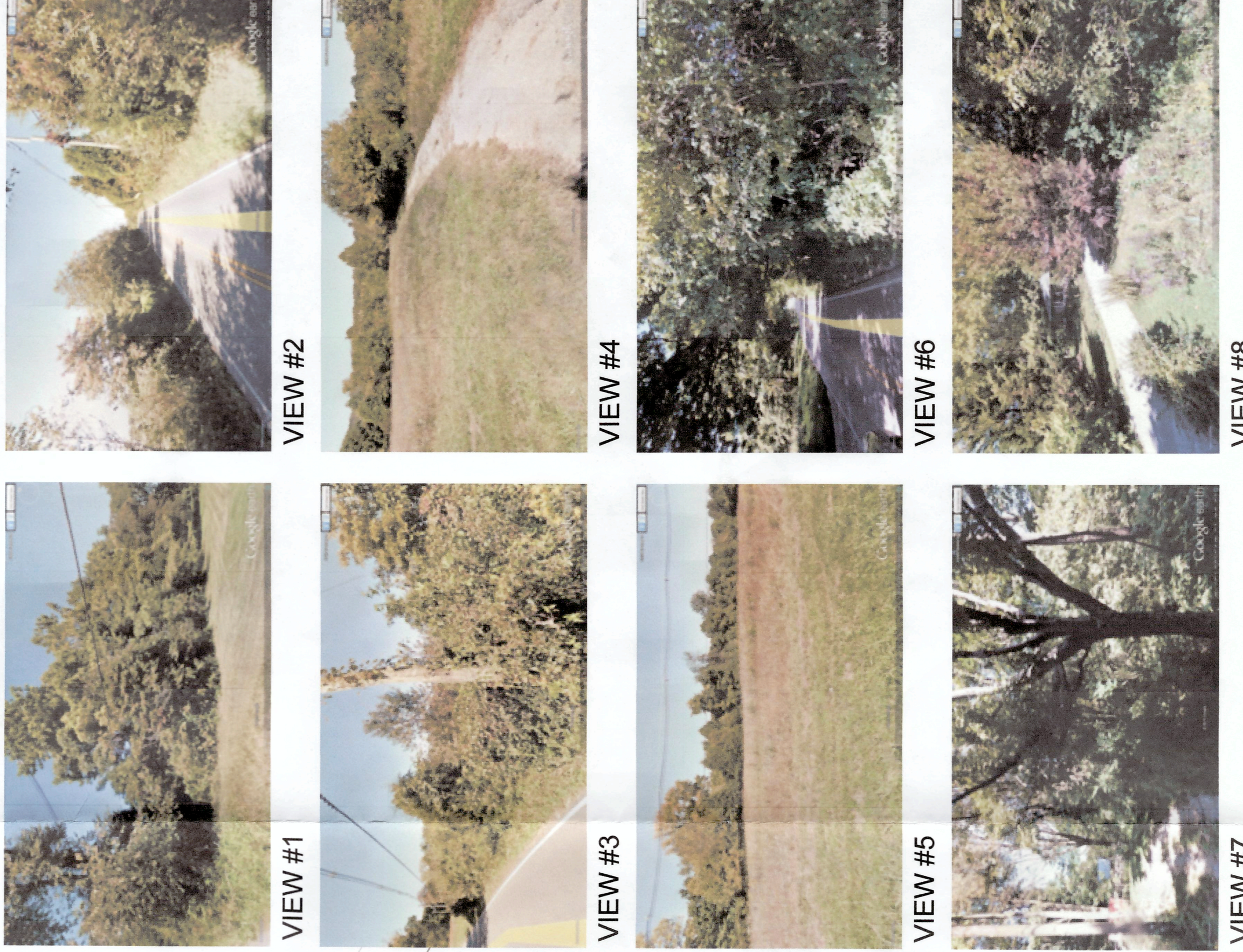

RECEIVED  
 FEB 23 2015  
 PLANNING &  
 DESIGN SERVICES

GRAPHIC SCALE  
 0 25 50 100 200