

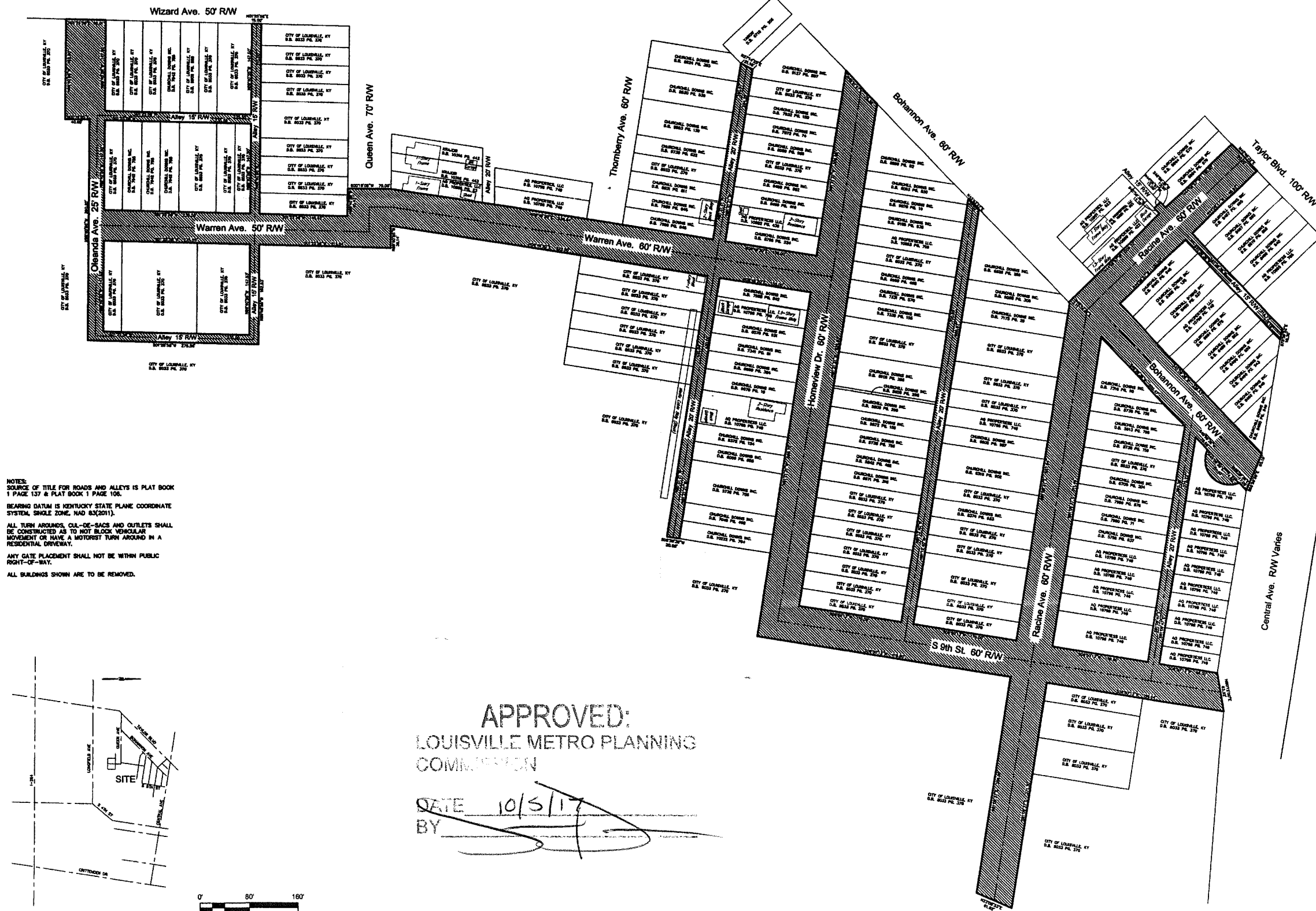

**STREET CLOSURE
 CHURCHILL DOWNS**
 RACINE AVE, HOMEVIEW AVE, BOHANNON AVE,
 WARREN AVE, S 9th ST, OLEANDA AVE

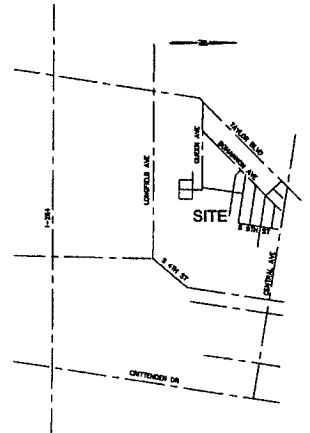

NOTES:
 SOURCE OF TITLE FOR ROADS AND ALLEYS IS PLAT BOOK 1 PAGE 137 & PLAT BOOK 1 PAGE 100.
 BEARING DATUM IS KENTUCKY STATE PLANE COORDINATE SYSTEM, SINGLE ZONE, NAD 83(2011).
 ALL TURN AROUNDS, CUL-DE-SACS AND OUTLETS SHALL BE CONSTRUCTED AS TO NOT BLOCK VEHICULAR MOVEMENT OR HAVE A MOTORIST TURN AROUND IN A RESIDENTIAL DRIVEWAY.
 ANY GATE PLACEMENT SHALL NOT BE WITHIN PUBLIC RIGHT-OF-WAY.
 ALL BUILDINGS SHOWN ARE TO BE REMOVED.



VICINITY MAP
 NO SCALE

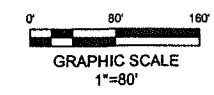

APPROVED:
 LOUISVILLE METRO PLANNING
 COMMISSION

DATE 10/5/17
 BY [Signature]

RECEIVED
 SEP 25 2017
 PLANNING &
 DESIGN SERVICES

STATE OF KENTUCKY
 JAMES H. GIBSON
 2008
 LICENSED
 PROFESSIONAL
 LAND SURVEYOR
 15589717
 [Signature]

DATE	2-15-2017	8-15-2017
REVISION		
PROJECT NUMBER	17305.000	
DRAWN BY	TLG	CHECKED BY:
SCALE	1"=80'	
DATE	6/22/2017	
SHEET NUMBER	1	