

RECEIVED

JUL 13 2020

PLANNING & DESIGN
SERVICES

6600 Cooper Chapel Road

June 23, 2020 Neighborhood Meeting

20-June-2020

Meeting Agenda

RECEIVED
JUL 13 2020
PLANNING & DESIGN
SERVICES

- ▶ Welcome
- ▶ Introductions of development team: Michael Gross, Ramona Vasta, John Campbell, Cliff Ashburner
- ▶ Housekeeping: New Names and Addresses; Sign in
- ▶ Presentation
- ▶ Questions: Use of Chat, Raising Hand, Phone Questions

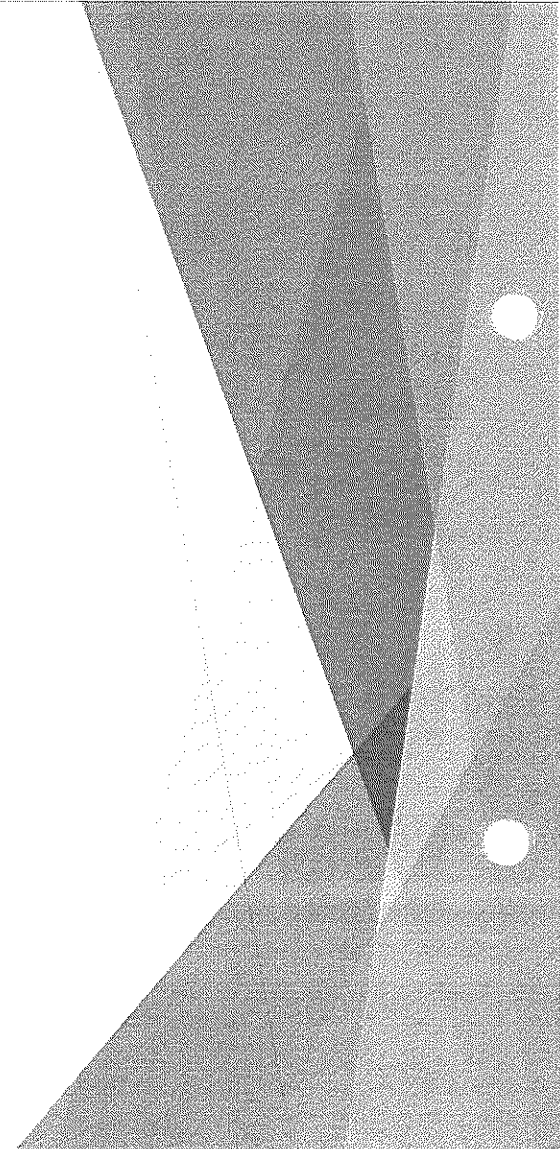

20-20116-0064

RECEIVED
JUL 13 2020
PLANNING & DESIGN
SERVICES

Notice Area

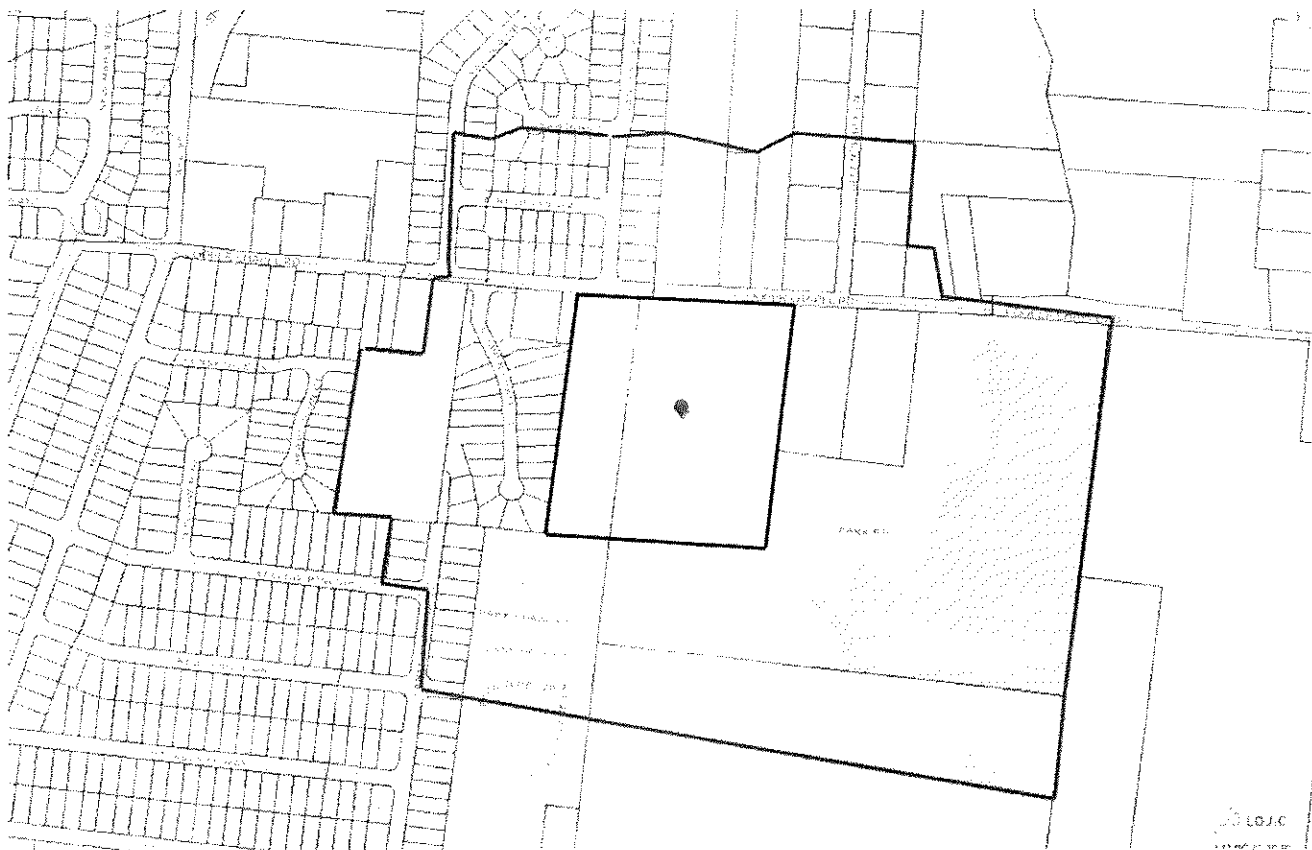

20-15ME-0066

JUL 13 2020

RECEIVED

WHO IS LDG?

1. Founded and headquartered in Louisville
2. More than 50 employees locally, 109 companywide
3. Created more than 13,000 high quality multi-family units in 8 states.
4. Focused on providing communities that offer a variety of amenities for residents

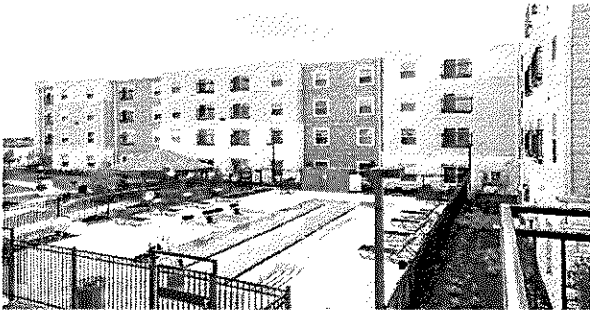

20-237E-0264

WHO IS LDG?

RECEIVED

JUL 13 2020

PLANNING & DESIGN
SERVICES

1. Ranked as one of Louisville's Best places to work
2. Supported dozens of local and national non-profits focused on serving the community
3. Committed to improving the communities we serve
4. Driven by the belief that "Everyone Deserves a Quality Place to Live."

20-2012-0066

PLANNING & DESIGN
SERVICES

JUL 13 2020

RECEIVED

SITE LOCATION



30-20101-0064

RECEIVED
JUL 13 2020
PLANNING & DESIGN
SERVICES

SITE LOCATION



20-2012-0064

RECEIVED
JUL 13 2020
PLANNING & DESIGN
SERVICES

Proposed Development Plan

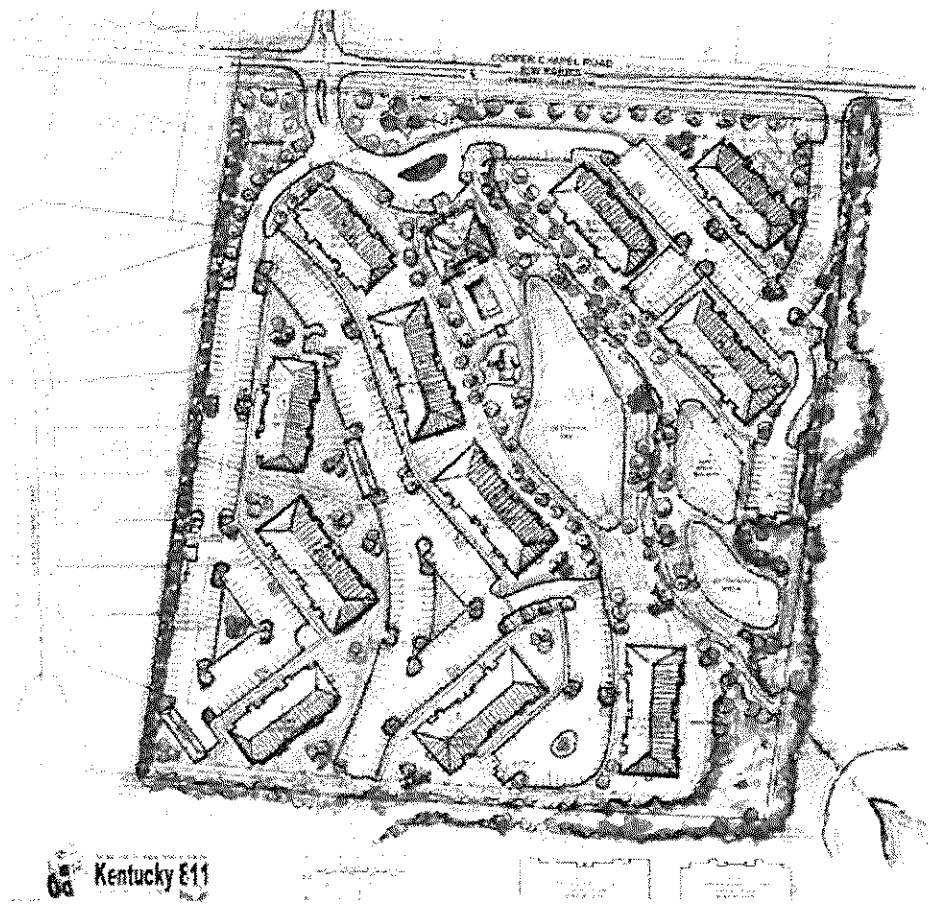

COOPER CHAPEL ROAD
NEW ROADS

1.000' = 1" (Horizontal)
1.000' = 1" (Vertical)

DATE: 06/15/2020
PROJECT: [illegible]
DRAWN BY: [illegible]
CHECKED BY: [illegible]
SCALE: AS SHOWN

LEGEND:
[illegible symbols and text]

NOTES:
1. ALL CONSTRUCTION SHALL BE IN ACCORDANCE WITH THE LATEST EDITIONS OF THE INTERNATIONAL BUILDING CODE (IBC) AND THE INTERNATIONAL PLUMBING CODE (IPC).
2. THE DEVELOPER SHALL BE RESPONSIBLE FOR OBTAINING ALL NECESSARY PERMITS AND APPROVALS FROM THE LOCAL JURISDICTION.
3. THE SITE SHALL BE RESTORED TO ORIGINAL OR BETTER CONDITION AFTER CONSTRUCTION IS COMPLETE.

Kentucky E11

20-2014-00610

RECEIVED
JUL 13 2020
PLANNING & DESIGN
SERVICES

Key Contacts

- ▶ Cliff Ashburner, Dinsmore & Shohl, LLP: 540-2382;
Clifford.Ashburner@dinsmore.com
- ▶ Michael Gross, LDG Development, LLC: 916-2405;
MGross@ldgdevelopment.com
- ▶ John Campbell, Heritage Engineering, jcampbell@heritageeng.com
- ▶

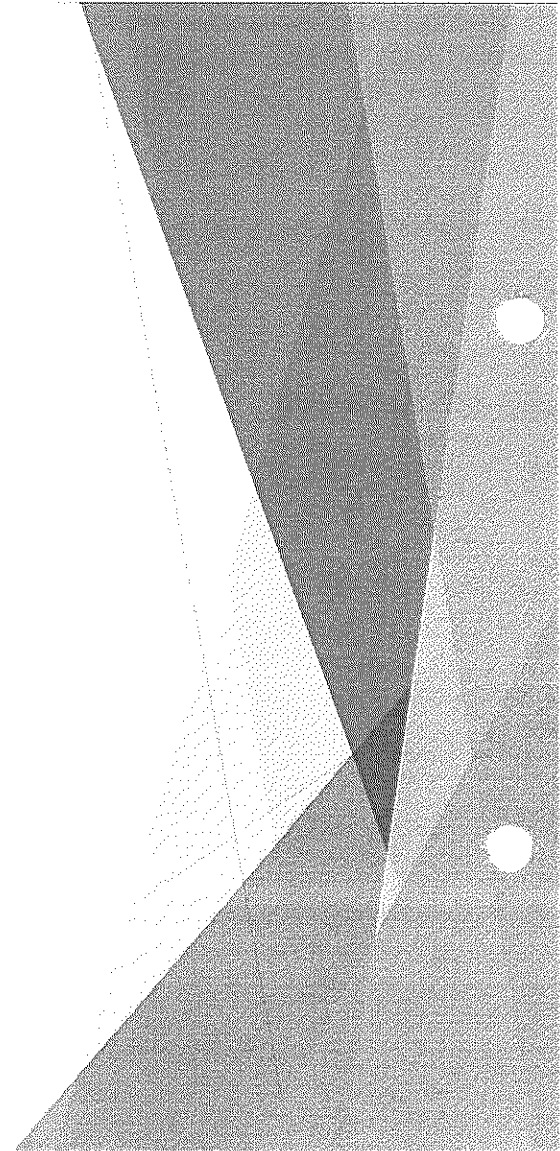

20-20ne-0006

RECEIVED
JUL 13 2020
PLANNING & DESIGN
SERVICES

Proposed Building Elevations



20-ZONE-00664

10-11-20