

NOTE:

All of the area closed by this Right-of-Way Closure Plat shall be added to Lot 28, Lancashire Subdivision, and the intended use is a parking lot.

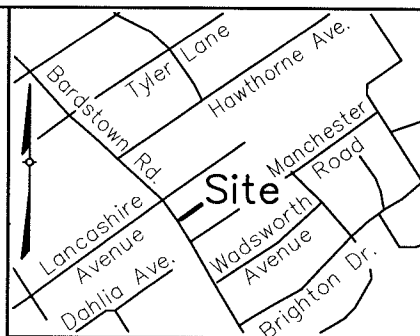

LOCATION MAP
Not To Scale

APPROXIMATE LANCASHIRE AVENUE 50'R/W

LOUISVILLE METRO PLANNING
COMMISSION

DATE 3/21/19
BY Larry

Lancashire Subdivision
D.B. 815, Pg. 590

Lot 28
Bardstown Post Parking, LLC
D.B. 10727, Pg. 763
2919 Bardstown road
(Parking Lot)

BARDSTOWN ROAD R/W VARIES

10' ALLEY
D.B. 815, Pg. 591
R-5/N
C-1/SMC

TRACT A
3,529.64 S.F.

N47°57'29"W
10.38'

S33°12'49"E
10.00'

N57°33'36"E

153.06'

10' ALLEY (To Be Closed) D.B. 815, Pg. 591 C-1/SMC R-5/N

Point of Beginning

S57°33'36"W

150.42'

Lot 1
Bardstown Post Parking, LLC
D.B. 10727, Pg. 763
2201 Manchester road
(Vacant Lot)

Lot 2
Bardstown Post Parking, LLC
D.B. 10727, Pg. 763
2203 Manchester road
(Vacant Lot)

Lot 3
Bardstown Post Parking, LLC
D.B. 10727, Pg. 763
2205 Manchester road
(Vacant Lot)

Lot 4
Bardstown Post Parking, LLC
D.B. 10727, Pg. 763
2207 Manchester road
(Vacant Lot)

Wellington Subdivision
P.B. 6, Pg. 34-36

AREA TO BE CLOSED = 1,517.39 SQ. FT.

The reference meridian used on this plat to determine the directions of the survey lines were based on the Kentucky State Plane Coordinate System, North Zone 1601, NAD 1983.

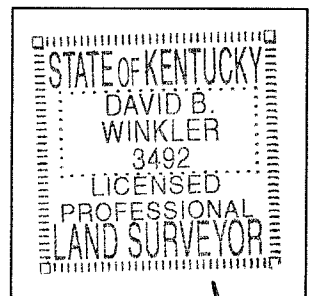
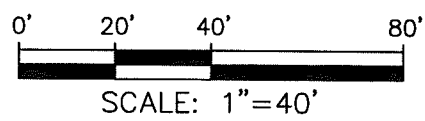

LAND SURVEYOR'S CERTIFICATE
I hereby certify that this plat and survey were made under my supervision, and that the property lines shown hereon were obtained from recorded deeds or plats, and that only the property corners noted as monumented were located in the field.

LD&D
LAND DESIGN & DEVELOPMENT, INC.
ENGINEERING • LAND SURVEYING • LANDSCAPE ARCHITECTURE
503 WASHBURN AVENUE, SUITE 101, LOUISVILLE, KY 40222
PHONE: 502.426.9374 WEB SITE: WWW.LD&D-INC.COM

RIGHT-OF-WAY CLOSURE PLAT

For:
BARDSTOWN POST PARKING LLC
2170 TYLER LANE
LOUISVILLE, KY 40205-2950
PLAT DATE: JANUARY 11, 2019

David Winkler # 3492 1-11-19
Surveyor's Signature PLS# Date

G:\Current Projects\16155\DWG\Survey\16155closure.dwg 1/11/2019

18STREETS1030