

**Planning Commission**  
**Staff Report**  
September 6, 2018



<b>Case No:</b>	18zone1040
<b>Project Name:</b>	13501 Aiken Road
<b>Location:</b>	13501 Aiken Road
<b>Owner(s):</b>	Sandra and Mark Holloway
<b>Applicant:</b>	Donnascott LLC
<b>Jurisdiction:</b>	Louisville Metro
<b>Council District:</b>	19- Julie Denton
<b>Case Manager:</b>	Julia Williams, AICP, Planning Supervisor

**REQUEST(S)**

- Change in zoning from M-2 to C-1
- District Development Plan with Binding Elements

**CASE SUMMARY/BACKGROUND**

The proposal is to rezone an existing building that appears to have been used as an office but has a residential appearance. 17 parking spaces are proposed.

**STAFF FINDING**

Staff finds that the proposal meets/does not meet the guidelines of the Comprehensive Plan and requirements of the Land Development Code.

**TECHNICAL REVIEW**

Land Development Code  
Cornerstone 2020

Transportation Planning and MSD have preliminarily approved the proposal.

**INTERESTED PARTY COMMENTS**

None received.

**STANDARD OF REVIEW FOR REZONING**

Criteria for granting the proposed form district change/rezoning: KRS Chapter 100.213

1. The proposed form district/rezoning change complies with the applicable guidelines and policies Cornerstone 2020; OR
2. The existing form district/zoning classification is inappropriate and the proposed classification is appropriate; OR
3. There have been major changes of an economic, physical, or social nature within the area involved which were not anticipated in Cornerstone 2020 which have substantially altered the basic character of the area.

## **STAFF ANALYSIS FOR CHANGE IN ZONING**

Following is staff's analysis of the proposed rezoning against the Guidelines and Policies of Cornerstone 2020.

### **The site is located in the Neighborhood Form District**

The Neighborhood Form is characterized by predominantly residential uses that vary from low to high density and that blend compatibly into the existing landscape and neighborhood areas. High-density uses will be limited in scope to minor or major arterials and to areas that have limited impact on the low to moderate density residential areas.

The Neighborhood Form will contain diverse housing types in order to provide housing choice for differing ages and incomes. New neighborhoods are encouraged to incorporate these different housing types within a neighborhood as long as the different types are designed to be compatible with nearby land uses. These types may include, but not be limited to large lot single family developments with cul-de-sacs, neo-traditional neighborhoods with short blocks or walkways in the middle of long blocks to connect with other streets, villages and zero lot line neighborhoods with open space, and high density multi-family condominium-style or rental housing.

The Neighborhood Form may contain open space and, at appropriate locations, civic uses and neighborhood centers with a mixture of uses such as offices, retail shops, restaurants and services. These neighborhood centers should be at a scale that is appropriate for nearby neighborhoods. The Neighborhood Form should provide for accessibility and connectivity between adjacent uses and neighborhoods by automobile, pedestrian, bicycles and transit.

Neighborhood streets may be either curvilinear, rectilinear or in a grid pattern and should be designed to invite human interaction. Streets are connected and easily accessible to each other, using design elements such as short blocks or bike/walkways in the middle of long blocks to connect with other streets. Examples of design elements that encourage this interaction include narrow street widths, street trees, sidewalks, shaded seating/gathering areas and bus stops. Placement of utilities should permit the planting of shade trees along both sides of the streets.

All other agency comments should be addressed to demonstrate compliance with the remaining Guidelines and Policies of Cornerstone 2020.

The proposal is not a neighborhood center due to the existing industrial that surrounds most of the site. The existing condition of the site and the surrounding area prevents it from being neighborhood oriented. The proposal allows for commercial that could be considered neighborhood focused. The proposal is located on a collector level roadway. The proposal is for a down zone to a less intense zoning district located in an existing industrial subdivision. The proposal is for the re-use of an existing structure for commercial. There is sufficient population located in the area that would utilize commercial zoning. The proposal is compact and is an efficient land use pattern because it is a downzone from M-2 to C-1. C-1 could provide services for the industrial area closer than they currently exist for the users of the industrial land uses.

A checklist is attached to the end of this staff report with a more detailed analysis. The Louisville Metro Planning Commission is charged with making a recommendation to the Louisville Metro Council regarding the appropriateness of this zoning map amendment. The Louisville Metro Council has zoning authority over the property in question.

## STANDARD OF REVIEW AND STAFF ANALYSIS FOR DDP

- a. The conservation of natural resources on the property proposed for development, including: trees and other living vegetation, steep slopes, water courses, flood plains, soils, air quality, scenic views, and historic sites;

STAFF: There do not appear to be any environmental constraints or historic resources on the subject site. Tree canopy requirements of the Land Development Code will be provided on the subject site.

- b. The provisions for safe and efficient vehicular and pedestrian transportation both within the development and the community;

STAFF: Provisions for safe and efficient vehicular and pedestrian transportation within and around the development and the community has been provided, and Metro Public Works has approved the preliminary development plan.

- c. The provision of sufficient open space (scenic and recreational) to meet the needs of the proposed development;

STAFF: There are no open space requirements pertinent to the current proposal.

- d. The provision of adequate drainage facilities on the subject site in order to prevent drainage problems from occurring on the subject site or within the community;

STAFF: The Metropolitan Sewer District has approved the preliminary development plan and will ensure the provision of adequate drainage facilities on the subject site in order to prevent drainage problems from occurring on the subject site or within the community.

- e. The compatibility of the overall site design (location of buildings, parking lots, screening, landscaping) and land use or uses with the existing and projected future development of the area;

STAFF: The overall site design and land uses are compatible with the existing and future development of the area. Appropriate landscape buffering and screening will be provided to screen adjacent properties and roadways. Buildings and parking lots will meet all required setbacks.

- f. Conformance of the development plan with the Comprehensive Plan and Land Development Code.

STAFF: The development plan conforms to applicable guidelines and policies of the Comprehensive Plan and to requirements of the Land Development Code.

## REQUIRED ACTIONS:

- **RECOMMEND** that the Louisville Metro Council **APPROVE** or **DENY** the **Change-in-Zoning** from M-2 to C-1
- **APPROVED** or **DENY** the **Detailed District Development Plan**

Based upon the information in the staff report, the testimony and evidence provided at the public hearing, the Planning Commission must determine if the proposal is in conformance with the Comprehensive Plan; OR the existing form district/zoning classification is inappropriate and the proposed classification is appropriate; OR if there have been major changes of an economic, physical, or social nature within the area involved which were not anticipated in Cornerstone 2020 which have substantially altered the basic character of the area.

**NOTIFICATION**

Date	Purpose of Notice	Recipients
7/27/18	Hearing before LD&T on 8/9/18	1 <sup>st</sup> and 2 <sup>nd</sup> tier adjoining property owners Registered Neighborhood Groups in Council District 19
8/22/18	Hearing before PC on 9/6/18	1 <sup>st</sup> and 2 <sup>nd</sup> tier adjoining property owners Registered Neighborhood Groups in Council District 19
	Hearing before PC	Sign Posting on property
	Hearing before PC	Legal Advertisement in the Courier-Journal

**ATTACHMENTS**

1. Zoning Map
2. Aerial Photograph
3. Staff Cornerstone 2020 Checklist
4. Proposed Binding Elements

1. Zoning Map

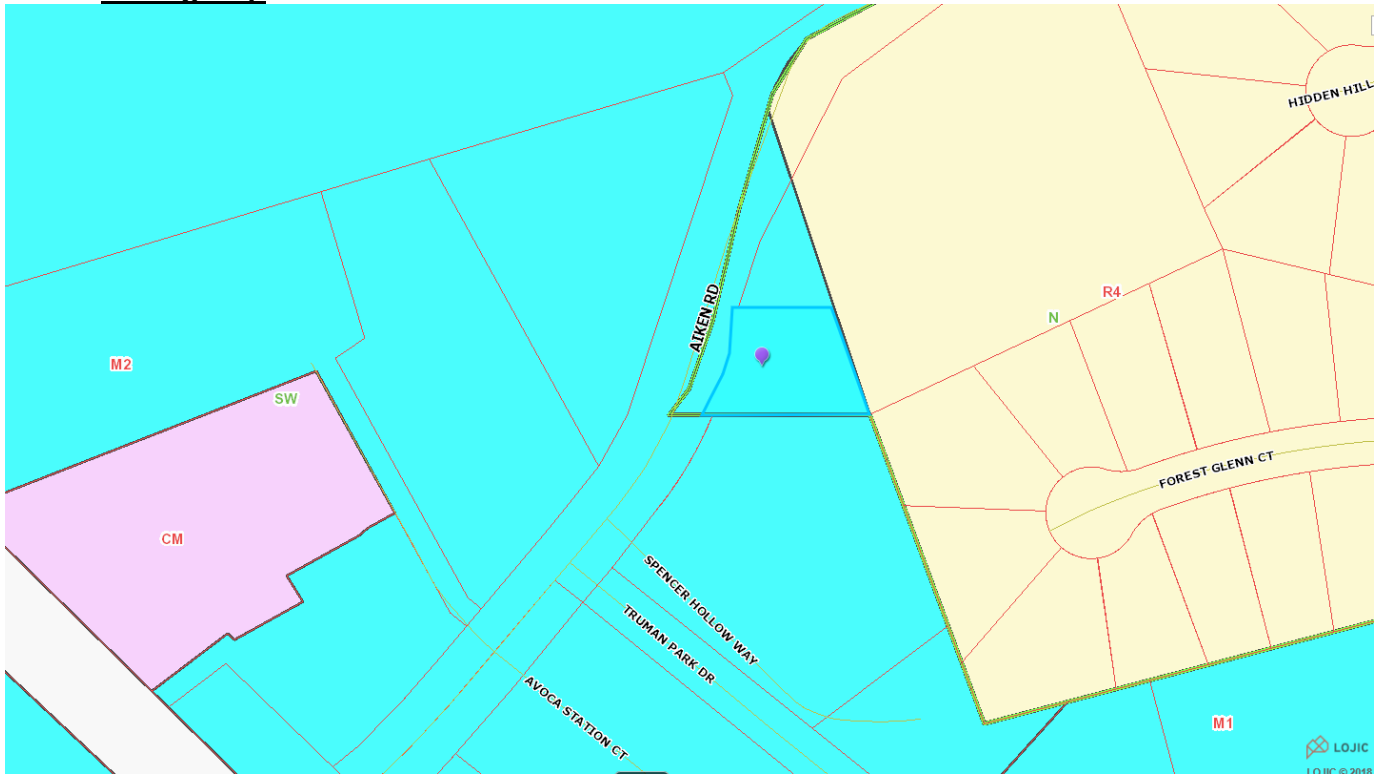

2. Aerial Photograph



### 3. Staff Cornerstone 2020 Checklist

- + Exceeds Guideline
- ✓ Meets Guideline
- Does Not Meet Guideline
- +/- More Information Needed
- NA Not Applicable

#### Neighborhood: Non-Residential

#	Cornerstone 2020 Plan Element	Plan Element or Portion of Plan Element	Staff Finding	Staff Analysis
1	Community Form/Land Use Guideline 1: Community Form	B.3: The proposal is a neighborhood center with a mixture of uses such as offices, retail shops, restaurants and services at a scale that is appropriate for nearby neighborhoods.	✓	The proposal is not a neighborhood center due to the existing industrial that surrounds most of the site. The existing condition of the site and the surrounding area prevents it from being neighborhood oriented. The proposal allows for commercial that could be considered neighborhood focused.
2	Community Form/Land Use Guideline 1: Community Form	B.3: If the proposal is high intensity, it is located on a major or minor arterial or an area with limited impact on low to moderate intensity residential uses.	✓	The proposal is located on a collector level roadway. The proposal is for a downzone to a less intense zoning district located in an existing industrial subdivision.
3	Community Form/Land Use Guideline 2: Centers	A.1/7: The proposal, which will create a new center, is located in the Neighborhood Form District, and includes new construction or the reuse of existing buildings to provide commercial, office and/or residential use.	✓	The proposal is for the re-use of an existing structure for commercial.
4	Community Form/Land Use Guideline 2: Centers	A.3: The proposed retail commercial development is located in an area that has a sufficient population to support it.	✓	There is sufficient population located in the area that would utilize commercial zoning.
5	Community Form/Land Use Guideline 2: Centers	A.4: The proposed development is compact and results in an efficient land use pattern and cost-effective infrastructure investment.	✓	The proposal is compact and is an efficient land use pattern because it is a downzone from M-2 to C-1.
6	Community Form/Land Use Guideline 2: Centers	A.5: The proposed center includes a mix of compatible land uses that will reduce trips, support the use of alternative forms of transportation and encourage vitality and sense of place.	✓	C-1 could provide services for the industrial area closer than they currently exist for the users of the industrial land uses.
7	Community Form/Land Use Guideline 2: Centers	A.6: The proposal incorporates residential and office uses above retail and/or includes other mixed-use, multi-story retail buildings.	-	The proposal does not incorporate residential.

#	Cornerstone 2020 Plan Element	Plan Element or Portion of Plan Element	Staff Finding	Staff Analysis
8	Community Form/Land Use Guideline 2: Centers	A.12: If the proposal is a large development in a center, it is designed to be compact and multi-purpose, and is oriented around a central feature such as a public square or plaza or landscape element.	NA	The proposal is not a large development.
9	Community Form/Land Use Guideline 2: Centers	A.13/15: The proposal shares entrance and parking facilities with adjacent uses to reduce curb cuts and surface parking, and locates parking to balance safety, traffic, transit, pedestrian, environmental and aesthetic concerns.	✓	The proposal utilizes an existing curb cut.
10	Community Form/Land Use Guideline 2: Centers	A.14: The proposal is designed to share utility hookups and service entrances with adjacent developments, and utility lines are placed underground in common easements.	✓	Utilities exist on the site but could be expanded to be shared if necessary.
11	Community Form/Land Use Guideline 2: Centers	A.16: The proposal is designed to support easy access by bicycle, car and transit and by pedestrians and persons with disabilities.	✓	The site can be accessed by all form of transportation. Transit is not available.
12	Community Form/Land Use Guideline 3: Compatibility	A.2: The proposed building materials increase the new development's compatibility.	NA	No new construction is proposed.
13	Community Form/Land Use Guideline 3: Compatibility	A.4/5/6/7: The proposal does not constitute a non-residential expansion into an existing residential area, or demonstrates that despite such an expansion, impacts on existing residences (including traffic, parking, signs, lighting, noise, odor and stormwater) are appropriately mitigated.	✓	The proposal does not constitute a non-residential expansion into an existing residential area since the surrounding properties consist of a mix of non-residential uses with varying degrees of intensity along the Aiken Road and Avoca Station Court corridor.
14	Community Form/Land Use Guideline 3: Compatibility	A.5: The proposal mitigates any potential odor or emissions associated with the development.	✓	APCD has reviewed and preliminarily approved development proposal.
15	Community Form/Land Use Guideline 3: Compatibility	A.6: The proposal mitigates any adverse impacts of its associated traffic on nearby existing communities.	✓	Transportation Planning did not indicate any adverse impacts to traffic.
16	Community Form/Land Use Guideline 3: Compatibility	A.8: The proposal mitigates adverse impacts of its lighting on nearby properties, and on the night sky.	✓	The proposed lighting will follow the regulations of the LDC.
17	Community Form/Land Use Guideline 3: Compatibility	A.11: If the proposal is a higher density or intensity use, it is located along a transit corridor AND in or near an activity center.	NA	The proposal is not a higher density or intensity use.

#	Cornerstone 2020 Plan Element	Plan Element or Portion of Plan Element	Staff Finding	Staff Analysis
18	Community Form/Land Use Guideline 3: Compatibility	A.21: The proposal provides appropriate transitions between uses that are substantially different in scale and intensity or density of development such as landscaped buffer yards, vegetative berms, compatible building design and materials, height restrictions, or setback requirements.	✓	All buffers are being provided on the site.
19	Community Form/Land Use Guideline 3: Compatibility	A.22: The proposal mitigates the impacts caused when incompatible developments unavoidably occur adjacent to one another by using buffers that are of varying designs such as landscaping, vegetative berms and/or walls, and that address those aspects of the development that have the potential to adversely impact existing area developments.	✓	All buffers are being provided on the site.
20	Community Form/Land Use Guideline 3: Compatibility	A.23: Setbacks, lot dimensions and building heights are compatible with those of nearby developments that meet form district standards.	✓	Setbacks and building heights are compatible with the existing developments within the vicinity of the adjacent Suburban Workplace form district.
21	Community Form/Land Use Guideline 3: Compatibility	A.24: Parking, loading and delivery areas located adjacent to residential areas are designed to minimize adverse impacts of lighting, noise and other potential impacts, and that these areas are located to avoid negatively impacting motorists, residents and pedestrians.	✓	Parking, loading and delivery areas are not located adjacent to or near residential uses.
22	Community Form/Land Use Guideline 3: Compatibility	A.24: The proposal includes screening and buffering of parking and circulation areas adjacent to the street, and uses design features or landscaping to fill gaps created by surface parking lots. Parking areas and garage doors are oriented to the side or back of buildings rather than to the street.	✓	All buffers and setbacks are being met on the site.
23	Community Form/Land Use Guideline 3: Compatibility	A.25: Parking garages are integrated into their surroundings and provide an active, inviting street-level appearance.	NA	No parking garage is proposed.
24	Community Form/Land Use Guideline 3: Compatibility	A.28: Signs are compatible with the form district pattern and contribute to the visual quality of their surroundings.	✓	Signs will follow requirements of Chapter 8 of the Land Development Code.



#	Cornerstone 2020 Plan Element	Plan Element or Portion of Plan Element	Staff Finding	Staff Analysis
25	Community Form/Land Use Guideline 4: Open Space	A.2/3/7: The proposal provides open space that helps meet the needs of the community as a component of the development and provides for the continued maintenance of that open space.	NA	Open space not required for proposed use. Incorporates a playground area on the site.
26	Community Form/Land Use Guideline 4: Open Space	A.4: Open space design is consistent with the pattern of development in the Neighborhood Form District.	NA	Open space not required for proposed use.
27	Community Form/Land Use Guideline 4: Open Space	A.5: The proposal integrates natural features into the pattern of development.	✓	Tree canopy information needed to determine compliance.
28	Community Form/Land Use Guideline 5: Natural Areas and Scenic and Historic Resources	A.1: The proposal respects the natural features of the site through sensitive site design, avoids substantial changes to the topography and minimizes property damage and environmental degradation resulting from disturbance of natural systems.	✓	Tree canopy requirements are being met.
29	Community Form/Land Use Guideline 5: Natural Areas and Scenic and Historic Resources	A.2/4: The proposal includes the preservation, use or adaptive reuse of buildings, sites, districts and landscapes that are recognized as having historical or architectural value, and, if located within the impact area of these resources, is compatible in height, bulk, scale, architecture and placement.	✓	No historical resources located on site.
30	Community Form/Land Use Guideline 5: Natural Areas and Scenic and Historic Resources	A.6: Encourage development to avoid wet or highly permeable soils, severe, steep or unstable slopes with the potential for severe erosion.	✓	No hydric soils, severe, steep or unstable slopes are located on the site.
31	Marketplace Guideline 6: Economic Growth and Sustainability	A.3: Encourage redevelopment, reinvestment and rehabilitation in the downtown where it is consistent with the form district pattern.	NA	The proposal is not located in downtown.
32	Marketplace Guideline 6: Economic Growth and Sustainability	A.4: Encourage industries to locate in industrial subdivisions or adjacent to existing industry to take advantage of special infrastructure needs.	✓	The proposal is not for an industrial zone, but is located adjacent to the suburban workplace and industrial zones.

#	Cornerstone 2020 Plan Element	Plan Element or Portion of Plan Element	Staff Finding	Staff Analysis
33	Marketplace Guideline 6: Economic Growth and Sustainability	A.6: Locate retail commercial development in activity centers. Locate uses generating large amounts of traffic on a major arterial, at the intersection of two minor arterials or at locations with good access to a major arterial and where the proposed use will not adversely affect adjacent areas.	✓	The proposal is for commercial not located in a commercial area but C-1 uses could be supported by the industrial users of the workplace.
34	Marketplace Guideline 6: Economic Growth and Sustainability	A.8: Require industrial development with more than 100 employees to locate on or near an arterial street, preferably in close proximity to an expressway interchange. Require industrial development with less than 100 employees to locate on or near an arterial street.	✓	The proposal is for commercial not located in a commercial area but C-1 uses could be supported by the industrial users of the workplace.
35	Mobility/Transportation Guideline 7: Circulation	A.1/2: The proposal will contribute its proportional share of the cost of roadway improvements and other services and public facilities made necessary by the development through physical improvements to these facilities, contribution of money, or other means.	✓	Transportation planning is not requiring roadway improvements.
36	Mobility/Transportation Guideline 7: Circulation	A.3/4: The proposal promotes mass transit, bicycle and pedestrian use and provides amenities to support these modes of transportation.	✓	The site can be accessed by all form of transportation. Transit is not available.
37	Mobility/Transportation Guideline 7: Circulation	A.6: The proposal's transportation facilities are compatible with and support access to surrounding land uses, and contribute to the appropriate development of adjacent lands. The proposal includes at least one continuous roadway through the development, adequate street stubs, and relies on cul-de-sacs only as short side streets or where natural features limit development of "through" roads.	✓	Transportation facilities are suitable for the proposal and the size of the lot.
38	Mobility/Transportation Guideline 7: Circulation	A.9: The proposal includes the dedication of rights-of-way for street, transit corridors, bikeway and walkway facilities within or abutting the development.	✓	ROW will be dedicated.
39	Mobility/Transportation Guideline 7: Circulation	A.10: The proposal includes adequate parking spaces to support the use.	✓	The proposal has adequate parking to provide parking availability above the minimum required for the use.

#	Cornerstone 2020 Plan Element	Plan Element or Portion of Plan Element	Staff Finding	Staff Analysis
40	Mobility/Transportation Guideline 7: Circulation	A.13/16: The proposal provides for joint and cross access through the development and to connect to adjacent development sites.	NA	Cross access is not required.
41	Mobility/Transportation Guideline 8: Transportation Facility Design	A.8: Adequate stub streets are provided for future roadway connections that support and contribute to appropriate development of adjacent land.	✓	Stub roads are not required.
42	Mobility/Transportation Guideline 8: Transportation Facility Design	A.9: Avoid access to development through areas of significantly lower intensity or density if such access would create a significant nuisance.	✓	Access to the site is through an area of similar intensity and density.
43	Mobility/Transportation Guideline 8: Transportation Facility Design	A.11: The development provides for an appropriate functional hierarchy of streets and appropriate linkages between activity areas in and adjacent to the development site.	✓	The proposal provides the appropriate access.
44	Mobility/Transportation Guideline 9: Bicycle, Pedestrian and Transit	A.1/2: The proposal provides, where appropriate, for the movement of pedestrians, bicyclists and transit users around and through the development, provides bicycle and pedestrian connections to adjacent developments and to transit stops, and is appropriately located for its density and intensity.	✓	The site can be accessed by all form of transportation. Transit is not available.
45	Livability/Environment Guideline 10: Flooding and Stormwater	The proposal's drainage plans have been approved by MSD, and the proposal mitigates negative impacts to the floodplain and minimizes impervious area. Solid blue-line streams are protected through a vegetative buffer, and drainage designs are capable of accommodating upstream runoff assuming a fully-developed watershed. If streambank restoration or preservation is necessary, the proposal uses best management practices.	✓	MSD has no issues with the proposal.
46	Livability/Environment Guideline 12: Air Quality	The proposal has been reviewed by APCD and found to not have a negative impact on air quality.	✓	APCD has reviewed and preliminarily approved development proposal.
47	Livability/Environment Guideline 13: Landscape Character	A.3: The proposal includes additions and connections to a system of natural corridors that can provide habitat areas and allow for migration.	NA	No natural areas or corridors exist to make connections with on the site.

#	Cornerstone 2020 Plan Element	Plan Element or Portion of Plan Element	Staff Finding	Staff Analysis
48	Community Facilities Guideline 14: Infrastructure	A.2: The proposal is located in an area served by existing utilities or planned for utilities.	✓	The proposal is located in an area served by existing utilities.
49	Community Facilities Guideline 14: Infrastructure	A.3: The proposal has access to an adequate supply of potable water and water for fire-fighting purposes.	✓	The proposal has access to an adequate supply of potable water and water for fire-fighting purposes.
50	Community Facilities Guideline 14: Infrastructure	A.4: The proposal has adequate means of sewage treatment and disposal to protect public health and to protect water quality in lakes and streams.	✓	The Health department has no issues with the proposal.

#### 4. Proposed Binding Elements

1. The development shall be in accordance with the approved district development plan, all applicable sections of the Land Development Code (LDC) and agreed upon binding elements unless amended pursuant to the Land Development Code. Any changes/additions/alterations of any binding element(s) shall be submitted to the Planning Commission or the Planning Commission's designee for review and approval; any changes/additions/alterations not so referred shall not be valid.
2. No outdoor advertising signs, small freestanding signs, pennants, balloons, or banners shall be permitted on the site.
3. Construction fencing shall be erected when off-site trees or tree canopy exists within 3' of a common property line. Fencing shall be in place prior to any grading or construction to protect the existing root systems from compaction. The fencing shall enclose the entire area beneath the tree canopy and shall remain in place until all construction is completed. No parking, material storage or construction activities are permitted within the protected area.
4. Before any permit (including but not limited to building, parking lot, change of use, site disturbance) is requested:
  - a. The development plan must receive full construction approval from Develop Louisville, Louisville Metro Public Works and the Metropolitan Sewer District.
  - b. The property owner/developer must obtain approval of a detailed plan for screening (buffering/landscaping) as described in Chapter 10 prior to requesting a building permit. Such plan shall be implemented prior to occupancy of the site and shall be maintained thereafter.
5. A certificate of occupancy must be received from the appropriate code enforcement department prior to occupancy of the structure or land for the proposed use. All binding elements requiring action and approval must be implemented prior to requesting issuance of the certificate of occupancy, unless specifically waived by the Planning Commission.
6. There shall be no outdoor music (live, piped, radio or amplified) or outdoor entertainment or outdoor PA system audible beyond the property line.

7. The applicant, developer, or property owner shall provide copies of these binding elements to tenants, purchasers, contractors, subcontractors and other parties engaged in development of this site and shall advise them of the content of these binding elements. These binding elements shall run with the land and the owner of the property and occupant of the property shall at all times be responsible for compliance with these binding elements. At all times during development of the site, the applicant and developer, their heirs, successors; and assignees, contractors, subcontractors, and other parties engaged in development of the site, shall be responsible for compliance with these binding elements.