

**GENERAL NOTES:**

- 1) MSD WATER MANAGEMENT #5690.
- 2) ALL WORK PERFORMED ON THIS PROJECT SHALL CONFORM TO THE KENTUCKY TRANSPORTATION CABINET'S "STANDARD SPECIFICATIONS FOR ROAD AND BRIDGE CONSTRUCTION," LATEST EDITION, UNLESS OTHERWISE SPECIFIED.
- 3) IT IS THE CONTRACTOR'S RESPONSIBILITY TO OBTAIN ALL FEDERAL, STATE AND LOCAL PERMITS NECESSARY TO PERFORM AND COMPLETE THE PROJECT AS SHOWN ON THESE PLANS. CONSTRUCTION STAKING SHALL BE THE RESPONSIBILITY OF THE CONTRACTOR. ADDITIONAL INFORMATION STAKING THE PROJECT'S LINES AND GRADES AS SHOWN ON THESE PLANS WILL BE PROVIDED UPON REQUEST.
- 4) IT IS THE CONTRACTOR'S RESPONSIBILITY TO COORDINATE ALL CONSTRUCTION ACTIVITIES WITH THE UTILITY COMPANIES SUCH THAT ACCESS TO WORK AREAS OR SCHEDULE CONFLICTS DO NOT INTERRUPT OR DELAY THE PROJECT'S SCHEDULE.
- 5) THE HORIZONTAL AND VERTICAL LOCATIONS OF EXISTING UTILITIES SHOWN ARE APPROXIMATE. IT SHALL BE THE RESPONSIBILITY OF THE CONTRACTOR TO LOCATE AND VERIFY ALL UTILITIES PRIOR TO BEGINNING CONSTRUCTION AND TO COORDINATE ALL CONNECTIONS WITH UTILITY COMPANIES.
- 6) ALL STORM SEWER PIPE SHALL BE A MINIMUM OF 12" DIAMETER.
- 7) ALL CULVERTS UNDER PAVING HAVING LESS THAN 12" COVER SHALL BE CONCRETE ENCASED.
- 8) RING ALL CATCH BASINS WITH STONE BAGS DURING GRADING OPERATIONS.
- 9) ALL STORM DRAIN CONSTRUCTION SHALL BE IN ACCORDANCE WITH THE METROPOLITAN SEWER DISTRICT'S STANDARD SPECIFICATIONS.
- 10) DENSE-GRADED AGGREGATE BASE SHALL BE COMPACTED IN SEPARATE LAYERS.
- 11) FOR ASPHALT PARKING LOTS, CONTRACTOR SHALL RECEIVE APPROVAL FOR JOB MIX FORMULA.
- 12) ALL SUBGRADES SHALL BE COMPACTED TO 95% OF MAXIMUM DENSITY AS DETERMINED BY THE STANDARD PROCTOR. THE UPPER 12" OF FILL BENEATH PAVEMENTS SHALL BE COMPACTED TO 100%. MOISTURE CONTENT SHALL BE WITHIN +3% TO -1% OF OPTIMUM.
- 13) TACK COAT SHALL BE APPLIED AT THE RATE OF 0.1 GALS. PER SQ. YARD WITH INSTALLATION OF SURFACE ASPHALT WHEN FINAL PAVING HAS BEEN DELAYED FROM THE BINDER INSTALLATION.
- 14) THE CONTRACTOR SHALL SLOPE ALL FINISH GRADES TO PROVIDE POSITIVE DRAINAGE. FLAT AND PONDING AREAS WILL NOT BE ACCEPTABLE.
- 15) THE MINIMUM GRADE OF ALL STREETS SHALL BE 1% AND MAXIMUM SHALL BE 10%.
- 16) DIMENSIONS SHOWN HEREON ARE FROM THE EDGE OF GUTTERS OR WALLS UNLESS SHOWN OTHERWISE. ALL RADII SHOWN ARE ON FACE OF CURB.
- 17) SIDEWALKS SHALL BE A MINIMUM 5" THICK WITH 6" X 6" W.W.F. ON A 4" D.G.A. BASE. SIDEWALKS AT DRIVEWAYS SHALL HAVE A MINIMUM THICKNESS OF 6". A FINE BROOM FINISH SHALL BE PROVIDED WITH CONTROL JOINTS SPACED AT 5' INTERVALS AND EXPANSION JOINTS AT 25' INTERVALS, AT ALL BENDS AND WHERE ADJUTING RIGID STRUCTURES.
- 18) THE CONTRACTOR SHALL PROVIDE A COMPACTED DEPTH OF 6" TOPSOIL OVER ALL PERVIOUS AREAS ON THE PROJECT.
- 19) ALL HANDICAP SITE FEATURES SHALL BE CONSTRUCTED IN ACCORDANCE WITH FEDERAL REGULATIONS 28 CFR PART 36: ADA STANDARDS FOR ACCESSIBLE DESIGN.
- 20) THIS PROPERTY IS NOT LOCATED IN A 100 YEAR FLOOD HAZARD AREA. (FEMA MAP 21111C0049 E and 21111C0050 E)
- 21) SANITARY SEWER SERVICE TO BE PROVIDED BY A NEW PSC, SUBJECT TO FEES AND ANY APPLICABLE CHARGES.
- 22) DRAINAGE FACILITIES SHALL CONFORM TO MSD REQUIREMENTS.
- 23) COMPATIBLE UTILITIES SHALL BE PLACED IN A COMMON TRENCH UNLESS APPLICABLE AGENCIES REQUIRE OTHERWISE.
- 24) SITE LIGHTING SHALL NOT SHINE IN THE EYES OF DRIVERS AND SHALL BE DIRECTED DOWN AND AWAY FROM ANY RESIDENTIAL PROPERTIES.
- 25) ALL SIGNAGE SHALL COMPLY WITH LDC CHAPTER 8, SIGN REGULATIONS.
- 26) ALL SERVICE STRUCTURES, INCLUDING DUMPSTER SHALL BE SCREENED IN ACCORDANCE WITH LDC CHAPTER 10.
- 27) MITIGATION MEASURES FOR DUST CONTROL SHALL BE IN PLACE DURING CONSTRUCTION TO PREVENT FUGITIVE PARTICULATE EMISSIONS FROM REACHING EXISTING ROADS AND NEIGHBORING PROPERTIES.
- 28) ALL CONSTRUCTION AND SALES TRAILERS MUST BE PERMITTED BY THE DEPARTMENT OF PUBLIC HEALTH AND WELLNESS IN ACCORDANCE WITH CHAPTER 115 OF LOUISVILLE JEFFERSON COUNTY METRO ORDINANCES.
- 29) CONSTRUCTION PLANS ARE REQUIRED BY METRO PUBLIC WORKS PRIOR TO CONSTRUCTION APPROVAL.
- 30) DETENTION WILL BE PROVIDED IN THE EXISTING ONSITE BASIN. AS A PART OF THIS CONSTRUCTION IT SHALL BE EVALUATED AND REVISED AS NECESSARY TO MEET CURRENT MSD STANDARDS. POSTDEVELOPED PEAK FLOWS WILL BE LIMITED TO PREDEVELOPED PEAK FLOWS FOR THE 2,10,25, AND 100-YEAR STORMS OR TO THE CAPACITY OF THE DOWNSTREAM SYSTEM, WHICHEVER IS MORE RESTRICTIVE. DETENTION BASIN REDESIGN IS REQUIRED PRIOR TO CONSTRUCTION APPROVAL.
- 31) IN ACCORDANCE WITH CHAPTER 4.9 OF THE LDC, A KARST SURVEY WAS PERFORMED BY LIZ NEWCOMB ON MARCH 1, 2018 AND NO KARST FEATURES WERE FOUND.
- 32) CONSTRUCTION PLANS AND DOCUMENTS SHALL COMPLY WITH LOUISVILLE AND JEFFERSON COUNTY METROPOLITAN SEWER DISTRICT'S DESIGN MANUAL AND STANDARD SPECIFICATIONS AND OTHER LOCAL, STATE, AND FEDERAL ORDINANCES.
- 33) THE FINAL DESIGN OF THIS PROJECT MUST MEET ALL MSD WATER QUALITY REGULATIONS ESTABLISHED BY MSD. SITE LAYOUT MAY CHANGE AT THE DESIGN PHASE DUE TO PROPER SIZING OF GREEN BEST MGMT. PRACTICES.
- 34) MSD DRAINAGE BOND REQUIRED PRIOR TO CONSTRUCTION PLAN APPROVAL.

**UTILITY NOTE**

ALL UTILITIES ON THESE PLANS ARE APPROXIMATE. INDIVIDUAL SERVICE LINES ARE NOT SHOWN. THE CONTRACTOR OR SUBCONTRACTOR SHALL NOTIFY THE UTILITY PROTECTION CENTER KENTUCKY 811 (TOLL FREE PHONE NO. 1-800-752-8007 OR LOCAL NO. 502-268-5123) FORTY-EIGHT (48) HOURS IN ADVANCE OF ANY CONSTRUCTION ON THIS PROJECT. THIS NUMBER WAS ESTABLISHED TO PROVIDE ACCURATE LOCATIONS OF EXISTING BELOW GROUND UTILITIES (I.E. CABLES, ELECTRIC WIRES, GAS & WATER LINES). WHEN CONTACTING THE KENTUCKY 811 CALL CENTER, PLEASE STATE THE WORK TO BE DONE IS FOR A PROPOSED MSD SEWER OR DRAINAGE FACILITY. THE CONTRACTOR SHALL BE RESPONSIBLE FOR BECOMING FAMILIAR WITH ALL UTILITY REQUIREMENTS SET FORTH ON THE PLANS AND IN THE TECHNICAL SPECIFICATIONS & SPECIAL PROVISIONS.

**SITE DATA CHART**

EXISTING ZONE..... R4  
 EXISTING FORM DISTRICT..... NEIGHBORHOOD  
 EXISTING USE..... VACANT  
 PROPOSED USE..... PRESCHOOL BUILDING  
 PROPERTY AREA..... 64.7 AC  
 EXISTING BUILDING S.F. .... 160,000 S.F.  
 EXISTING CLASSROOMS..... 40 ELEMENTARY CLASSROOMS, 30 MIDDLE SCHOOL CLASSROOMS, & 43 HIGH SCHOOL CLASSROOMS  
 EXISTING AUDITORIUM..... 831 SEATS  
 PROPOSED BUILDING S.F. .... 20,250 S.F.  
 {8 ELEMENTARY CLASSROOMS, 750 SF ENTRANCE ADDITION, & 8,500 SF CAFETERIA ADDITION}  
 BUILDING HEIGHT..... 45 FT. MAX.  
 EXISTING PARKING..... 675 SPACES  
 REQUIRED PARKING..... 537 MINIMUM (2 PER ELEMENTARY & MIDDLE SCHOOL CLASSROOMS, 5 PER HIGH SCHOOL CLASSROOM, 1 PER 5 AUDITORIUM SEATS)  
 ..... 941 MAXIMUM (3 PER ELEMENTARY & MIDDLE SCHOOL CLASSROOMS, 10 PER HIGH SCHOOL CLASSROOM, 1 PER 3 AUDITORIUM SEATS)  
 PROPOSED PARKING..... 58, INCLUDING 4 HANDICAP  
 TOTAL PARKING..... 733 SPACES  
 PROVIDED BIKE PARKING..... 8 SHORT-TERM SPACES  
 PROPOSED VUA..... 29,146 S.F.  
 REQUIRED ILA..... 2,186 S.F. (7.5%)  
 PROVIDED ILA..... 2,470 S.F. (8.5%)

**INCREASE IN IMPERVIOUS AREA**

PREDEVELOPED IMPERVIOUS AREA = 666,293 SQ. FT.  
 DEVELOPED IMPERVIOUS AREA = 716,453 SQ. FT.  
 INCREASE IN IMPERVIOUS AREA = 50,160 SQ. FT.

**AREA OF DISTURBANCE 1.847 ACRES (80,476 SQ. FT.)**

**EROSION PREVENTION and SEDIMENT CONTROL:**

THE APPROVED EROSION PREVENTION AND SEDIMENT CONTROL (EPSC) PLAN SHALL BE IMPLEMENTED PRIOR TO ANY LAND-DISTURBING ACTIVITY ON THE CONSTRUCTION SITE. ANY MODIFICATIONS TO THE APPROVED EPSC PLAN MUST BE REVIEWED AND APPROVED BY MSD'S PRIVATE DEVELOPMENT REVIEW OFFICE. EPSC BMP'S SHALL BE INSTALLED PER THE PLAN AND MSD STANDARDS.

DETENTION BASINS, IF APPLICABLE, SHALL BE CONSTRUCTED FIRST AND SHALL PERFORM AS SEDIMENT BASINS DURING CONSTRUCTION UNTIL THE CONTRIBUTING DRAINAGE AREAS ARE SEEDDED AND STABILIZED. ACTIONS MUST BE TAKEN TO MINIMIZE THE TRACKING OF MUD AND SOIL FROM CONSTRUCTION AREAS ONTO PUBLIC ROADWAYS. SOILS TRACKED ONTO THE ROADWAY SHALL BE REMOVED DAILY.

SOIL STOCKPILES SHALL BE LOCATED AWAY FROM STREAMS, PONDS, SWALES, AND CATCH BASINS. STOCKPILES SHALL BE SEEDDED, MULCHED, AND ADEQUATELY CONTAINED THROUGH THE USE OF SILT FENCING. ALL STREAM CROSSINGS MUST UTILIZE LOW-WATER-CROSSING STRUCTURES PER MSD STANDARD DRAWING ER-02.

WHERE CONSTRUCTION OR LAND DISTURBANCE ACTIVITY WILL OR HAS TEMPORARILY CEASED ON ANY PORTION OF A SITE, TEMPORARY SITE STABILIZATION MEASURES SHALL BE REQUIRED AS SOON AS PRACTICABLE, BUT NO LATER THAN 14 CALENDAR DAYS AFTER THE ACTIVITY HAS CEASED.

SEDIMENT-LADEN GROUNDWATER ENCOUNTERED DURING TRENCHING, BORING OR OTHER EXCAVATION ACTIVITIES SHALL BE PUMPED TO A SEDIMENT TRAPPING DEVICE PRIOR TO BEING DISCHARGE INTO A STREAM, POND, SWALE OR CATCH BASIN.

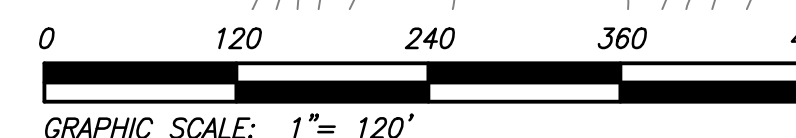
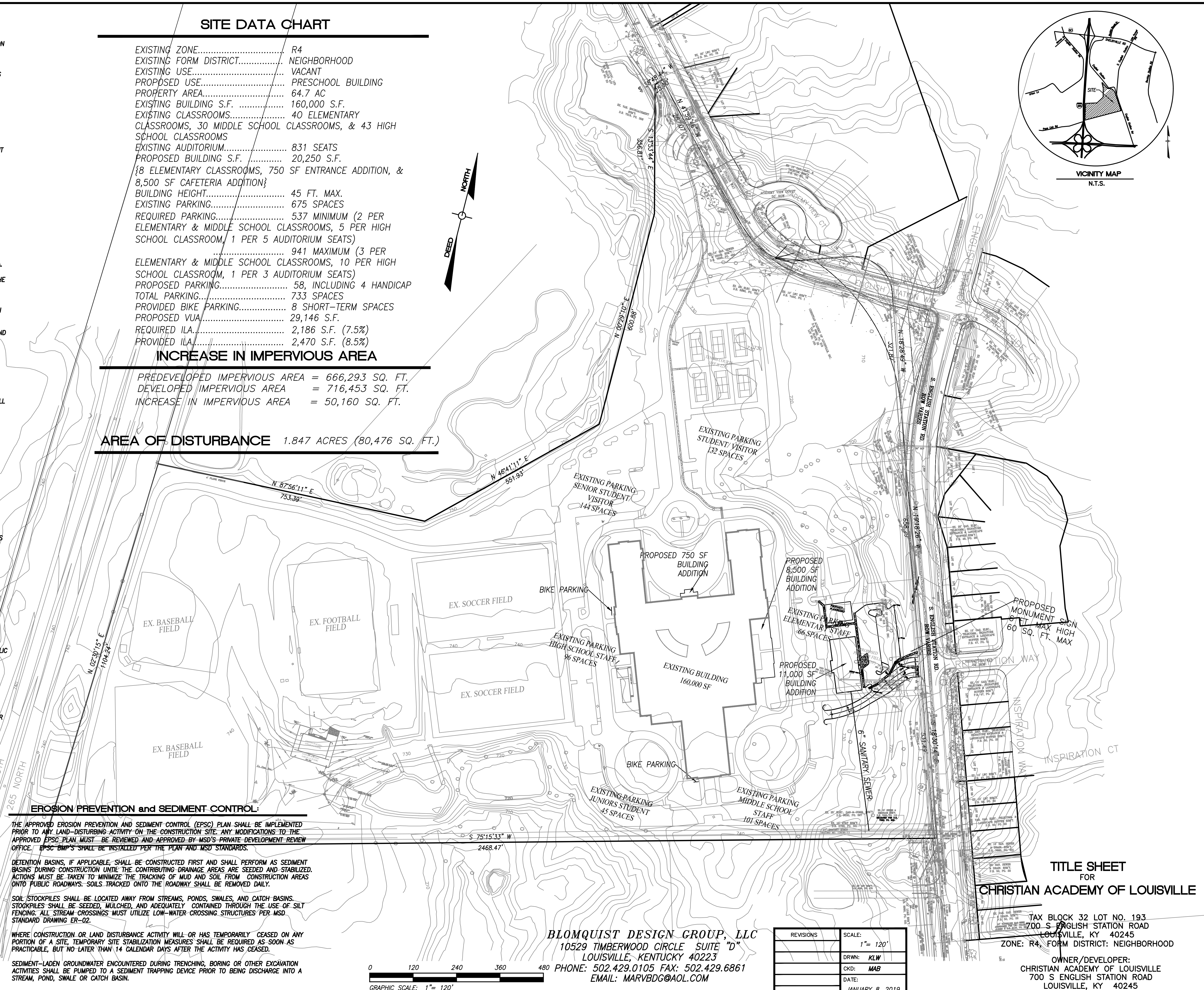
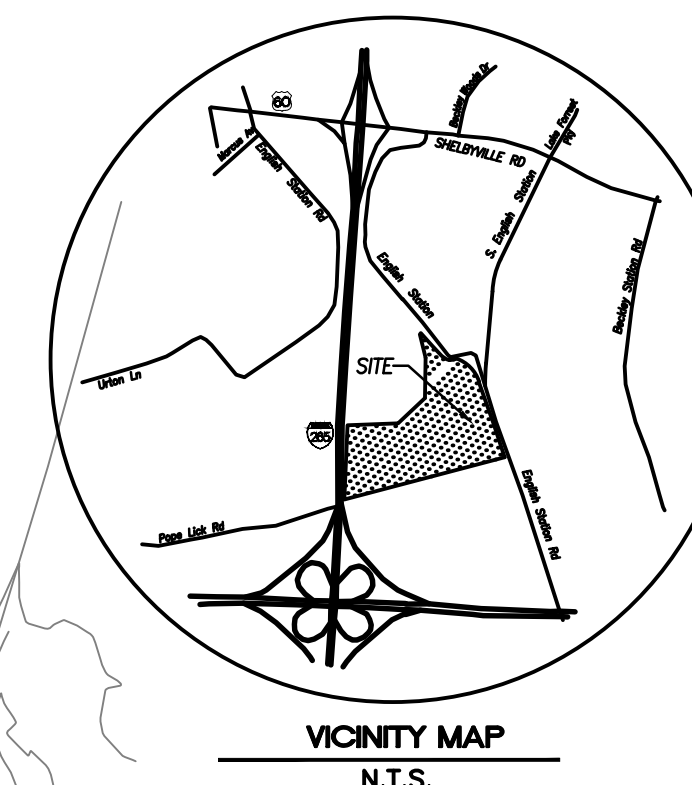
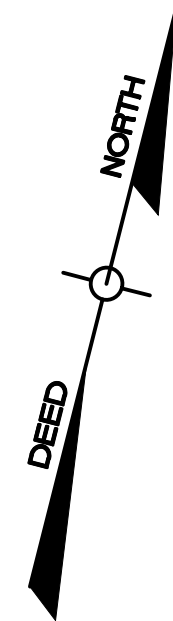

**BLOMQUIST DESIGN GROUP, LLC**  
 10529 TIMBERWOOD CIRCLE SUITE "D"  
 LOUISVILLE, KENTUCKY 40223  
 PHONE: 502.429.0105 FAX: 502.429.6861  
 EMAIL: MARVBDG@AOL.COM

REVISIONS	SCALE: 1" = 120'
DRWN: KLV	
CHKD: MAB	
DATE: JANUARY 8, 2019	

**TITLE SHEET FOR CHRISTIAN ACADEMY OF LOUISVILLE**

TAX BLOCK 32 LOT NO. 193  
 700 S ENGLISH STATION ROAD  
 LOUISVILLE, KY 40245  
 ZONE: R4, FORM DISTRICT: NEIGHBORHOOD  
 OWNER/DEVELOPER:  
 CHRISTIAN ACADEMY OF LOUISVILLE  
 700 S ENGLISH STATION ROAD  
 LOUISVILLE, KY 40245